

# PINE CREEK DRAINAGE BASIN EXISTING DRAINAGE FACILITY MAP

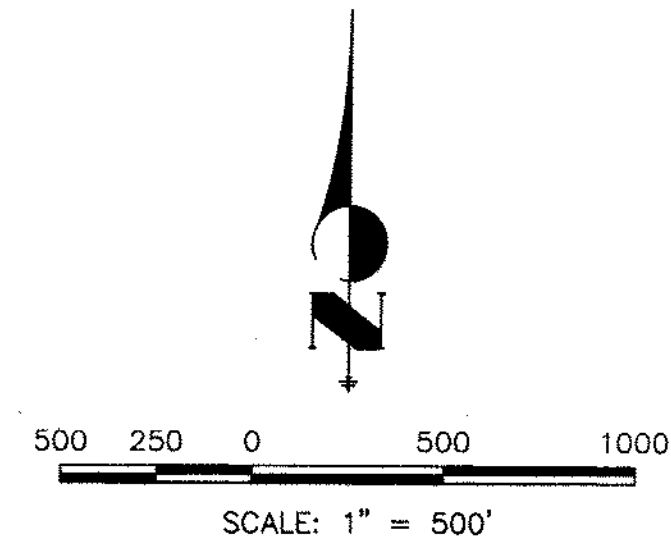

## LEGEND

- PINE CREEK DRAINAGE BASIN BOUNDARY
- SUB-BASIN BOUNDARY

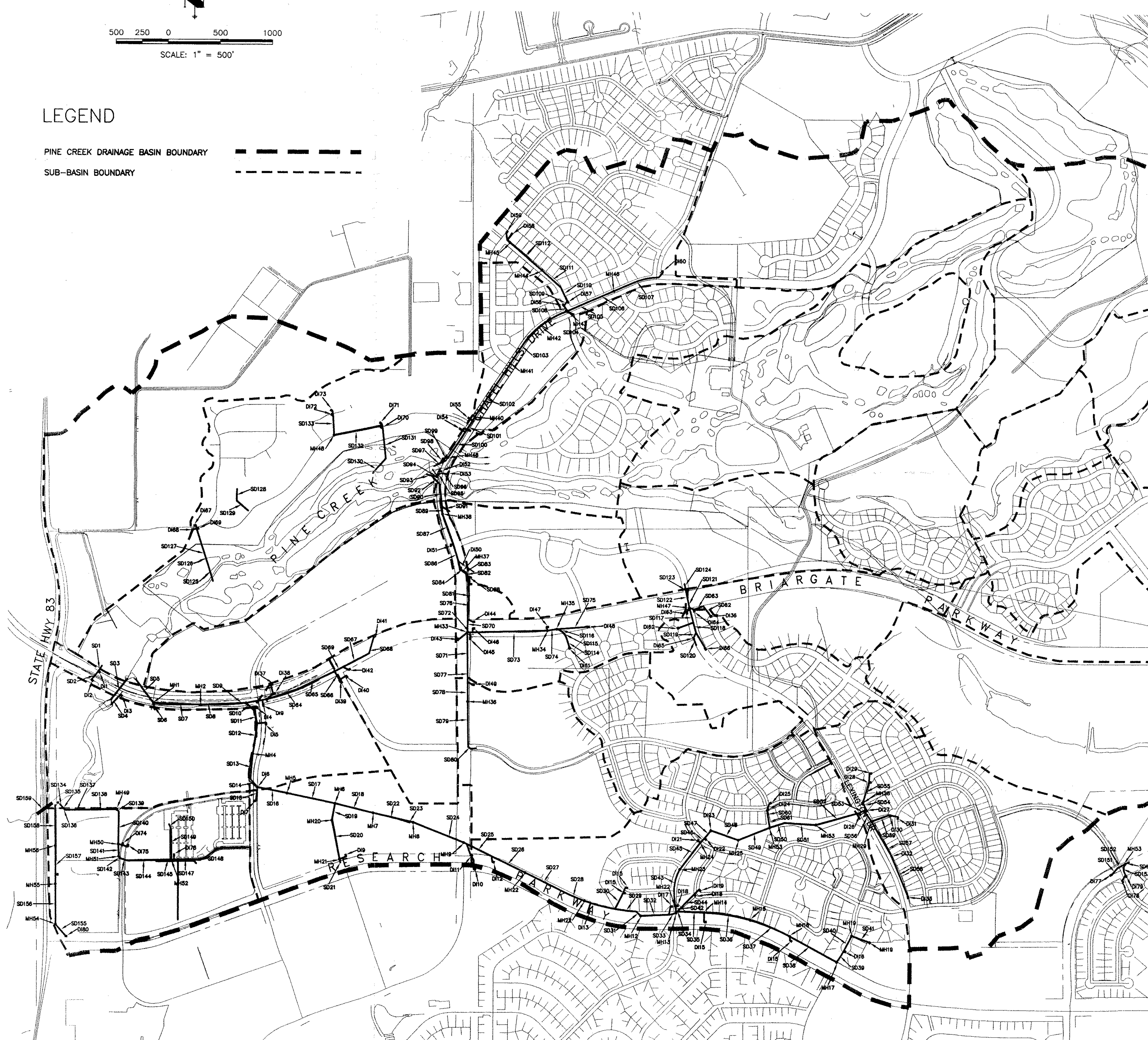

| DRAINAGE INLET DATA TABLE |                                  |  |
|---------------------------|----------------------------------|--|
| #                         | LENGTH, TYPE AND DEPTH           | CONNECTOR                                  |
| D11                       | 10' LONG, D-10-R, 12.3' DEEP     |  |
| D12                       | 20' LONG, D-10-R, 9.3' DEEP      |  |
| D13                       | 4' LONG, D-10-R, 3.5' DEEP       |  |
| D14                       | 4' LONG, D-10-R, 6.4' DEEP       | 24LF, 18" RCP @ 4.0%                       |
| D15                       | 4' LONG, D-10-R, 3.3' DEEP       | 30LF, 18" RCP @ 1.0%, 67LF 18" RCP @ 8.2%  |
| D16                       | 10' LONG, D-10-R, 6.2' DEEP      |  |
| D17                       | 10' LONG, D-10-R, 6.2' DEEP      |  |
| D18                       | 4' LONG, D-10-R, 3.5' DEEP       | 42LF, 8" PVC @ 9.1%                        |
| D19                       | 8' LONG, D-10-R, 5.2' DEEP       | 35LF, 18" RCP @ 1.0%                       |
| D20                       | 7' LONG, 7' DEEP                 | 155LF, 18" RCP @ 1%                        |
| D21                       | 7' LONG, 7' DEEP                 | 102LF, 24" RCP @ 1%                        |
| D22                       | 20' LONG, D-10-R, 3.5' DEEP      | 44LF, 18" RCP @ 10.5%                      |
| D23                       | 7' LONG, 7' DEEP                 | 60LF, 12" RCP @ 1.3%, 41LF 12" RCP @ 12.4% |
| D24                       | 20' LONG, D-10-R, 3.5' DEEP      | 69LF, 12" RCP @ 1%                         |
| D25                       | 20' LONG, D-10-R, 3.6' DEEP      | 12LF, 18" RCP @ 2.0%                       |
| D26                       | 4' LONG, D-10-R, 5.9' DEEP       | 53LF, 24" RCP @ 3.6%                       |
| D27                       | 8' LONG, D-10-R, 4.7' DEEP       | 3LF, 36" RCP @ 4.0%                        |
| D28                       | 4' LONG, D-10-R, 7' DEEP         | 49LF, 24" RCP @ 1.5%                       |
| D29                       | 12' LONG, D-10-R, 7' DEEP        | 379LF, 24" RCP @ 2.3%                      |
| D30                       | 10' LONG, D-10-R, 7' DEEP        | 42LF, 18" RCP @ 3.3%                       |
| D31                       | 12' LONG, D-10-R, 7' DEEP        |  |
| D32                       | 7' LONG, D-10-R, 6.4' DEEP       |  |
| D33                       | 4' LONG, D-10-R, 4.9' DEEP       | 59LF, 24" RCP @ 1.3%                       |
| D34                       | 4' LONG, D-10-R, 4.9' DEEP       |  |
| D35                       | 8' LONG, D-10-R, 7' DEEP         |  |
| D36                       | 4' LONG, D-10-R, 7' DEEP         | 89LF, 18" RCP @ 3.3%                       |
| D37                       | 4' LONG, D-10-R, 7' DEEP         |  |
| D38                       | 4' LONG, D-10-R, 3.8' DEEP       | 88LF, 24" RCP @ 2.0%                       |
| D39                       | 18' LONG, D-10-R, 7' DEEP        |  |
| D40                       | 8' LONG, D-10-R, 7' DEEP         |  |
| D41                       | 10' LONG, D-10-R, 6.5' DEEP      |  |
| D42                       | 15' LONG, D-10-R, 3.3' DEEP      | 35LF, 18" RCP @ 3.5%                       |
| D43                       | 20' LONG, D-10-R, 7' DEEP        | 113LF, 18" RCP @ 4.3%                      |
| D44                       | 20' LONG, D-10-R, 4.7' DEEP      | 52LF, 18" RCP @ 16.2%                      |
| D45                       | 5.25' RADIAL INLET, 7.6' DEEP    | 31LF, 30" RCP @ 14.4%                      |
| D46                       | 10' LONG, D-10-R, 6.9' DEEP      | 27LF, 18" RCP @ 15.0%                      |
| D47                       | 10' LONG, D-10-R, 4.3' DEEP      | 28LF, 18" RCP @ 5.6%                       |
| D48                       | 8' LONG, D-10-R, 6.2' DEEP       |  |
| D49                       | 16' LONG, D-10-R, 6.8' DEEP      | 18LF, 18" RCP @ 15.0%                      |
| D50                       | 10' LONG, D-10-R, 6.3' DEEP      | 11LF, 18" RCP TIE IN TO 54" RCP            |
| D51                       | 12' LONG, D-10-R, 6.8' DEEP      | 35LF, 18" RCP @ 18.1%                      |
| D52                       | 8' LONG, D-10-R, 6.9' DEEP       |  |
| D53                       | 24' LONG, D-10-R, 10.8' DEEP     |  |
| D54                       | 24' LONG, D-10-R, 3.0' DEEP      | 18LF, 24" RCP @ 8.5%                       |
| D55                       | 24' LONG, D-10-R, 3.0' DEEP      | 18LF, 24" RCP @ 17.5%                      |
| D56                       | 20' LONG, D-10-R, 5.8' DEEP      | 18LF, 42" RCP @ 2.9%                       |
| D57                       | 20' LONG, D-10-R, 4.3' DEEP      | 35LF, 30" RCP @ 1.0%                       |
| D58                       | 12' LONG, D-10-R, 4.2' DEEP      | 58LF, 24" RCP @ 1.0%                       |
| D59                       | 12' LONG, D-10-R, 3.7' DEEP      | 30LF, 18" RCP @ 2.5%                       |
| D60                       | 6' LONG, D-10-R, 2.4' DEEP       |  |
| D61                       | 4' LONG, D-10-R, 3.1' DEEP       |  |
| D62                       | 4' LONG, D-10-R, 5.0' DEEP       | 177LF, 18" RCP @ 2.3%                      |
| D63                       | 20' LONG, D-10-R, 4.2' DEEP      | 54LF, 24" RCP @ 1.2%                       |
| D64                       | 20' LONG, D-10-R, 4.5' DEEP      | 9LF, 24" RCP @ 11.6%                       |
| D65                       | 20' LONG, D-10-R, 2.2' DEEP      |  |
| D66                       | 20' LONG, D-10-R, 5.2' DEEP      | 134LF, 24" RCP @ 3.5%                      |
| D67                       | 6' LONG, D-10-R, 3.3' DEEP       | 36LF, 18" RCP @ 1.0%                       |
| D68                       | 8' LONG, D-10-R, 4.0' DEEP       |  |
| D69                       | 8' LONG, D-10-R, 4.0' DEEP       |  |
| D70                       | 5' LONG, D-10-R, 7' DEEP         |  |
| D71                       | 5' LONG, D-10-R, 7' DEEP         | 7LF, 18" RCP @ 1%                          |
| D72                       | 5' LONG, D-10-R, 7' DEEP         |  |
| D73                       | 5' LONG, D-10-R, 7' DEEP         | 4LF, 18" RCP @ 1%                          |
| D74                       | 18' LONG, D-10-R, 5.8' DEEP      | 30LF, 36" RCP @ 4.6%                       |
| D75                       | 18' LONG, D-10-R, 3.8' DEEP      | 41LF, 30" RCP @ 4.6%                       |
| D76                       | 7' LONG, 7' DEEP                 |  |
| D77                       | 5' LONG, D-10-R, 3.3' DEEP       |  |
| D78                       | 10' LONG, D-10-R, 3.7' DEEP      | 37LF, 18" RCP @ 2.0%                       |
| D79                       | 10' LONG, D-10-R, 3.3' DEEP      |  |
| D80                       | 7' LONG, 7' DEEP "EASTING INLET" |  |

| STORM DRAIN PIPE DATA TABLE |   |           |
|-----------------------------|---|-----------|
| #                           | LENGTH, DIAMETER, TYPE AND SLOPE              | CONNECTOR |
| SD1                         | 66LF, 36" RCP @ 5.1%                          |           |
| SD2                         | 108LF, 30" RCP @ 2.5%                         |           |
| SD3                         | 1' 10" x 18" CBS, 6" W/ 4.5"x12" OPENING      |           |
| SD4                         | 145LF, 54" RCP @ 12.0%                        |           |
| SD5                         | 290LF, 54" RCP @ 6.2%                         |           |
| SD6                         | 50LF, 42" RCP @ 2.0%                          |           |
| SD7                         | 441LF, 54" RCP @ 5.8%                         |           |
| SD8                         | 116LF, 54" RCP @ 5.5%                         |           |
| SD9                         | 328LF, 66" RCP @ 3.2%                         |           |
| SD10                        | 108LF, 66" RCP @ 5.1%                         |           |
| SD11                        | 85LF, 66" RCP @ 5.1%                          |           |
| SD12                        | 340LF, 66" RCP @ 1.1%                         |           |
| SD13                        | 256LF, 66" RCP @ 1.1%                         |           |
| SD14                        | 104LF, 66" RCP @ 2.0%                         |           |
| SD15                        | 123LF, 66" RCP @ 0.5%                         |           |
| SD16                        | 297LF, 48" RCP @ 4.7%                         |           |
| SD17                        | 479LF, 48" RCP @ 4.3%                         |           |
| SD18                        | 333LF, 48" RCP @ 4.4%                         |           |
| SD19                        | 148LF, 24" RCP @ 0.6%                         |           |
| SD20                        | 379LF, 24" RCP @ 2.3%                         |           |
| SD21                        | 554LF, 24" RCP @ 4.4%                         |           |
| SD22                        | 354LF, 48" RCP @ 4.4%                         |           |
| SD23                        | 8LF, 48" RCP @ 3.8%                           |           |
| SD24                        | 536LF, 54" RCP @ 2.3%                         |           |
| SD25                        | 514LF, 60" RCP @ 1.0%                         |           |
| SD26                        | 278LF, 60" RCP @ 1.0%                         |           |
| SD27                        | 281LF, 60" RCP @ 2.3%                         |           |
| SD28                        | 320LF, 60" RCP @ 1.0%                         |           |
| SD29                        | 153LF, 60" RCP @ 2.8%                         |           |
| SD30                        | 164LF, 24" RCP @ 6.4%                         |           |
| SD31                        | 78LF, 54" RCP @ 2.6%                          |           |
| SD32                        | 282LF, 54" RCP @ 2.0%                         |           |
| SD33                        | 421LF, 54" RCP @ 2.0%                         |           |
| SD34                        | 17LF, 36" RCP @ 3.2%                          |           |
| SD35                        | 242LF, 36" RCP @ 2.2%                         |           |
| SD36                        | 395LF, 36" RCP @ 4.4%                         |           |
| SD37                        | 470LF, 27" RCP @ 4.4%                         |           |
| SD38                        | 495LF, 24" RCP @ 2.2%                         |           |
| SD39                        | 131LF, 24" RCP @ 2.6%                         |           |
| SD40                        | 156LF, 24" RCP @ 1.6%                         |           |
| SD41                        | 189LF, 24" RCP @ 1.5%                         |           |
| SD42                        | 31LF, 54" RCP @ 2.0%                          |           |
| SD43                        | 342LF, 48" RCP @ 1.8%                         |           |
| SD44                        | 127LF, 24" RCP @ 3.4%                         |           |
| SD45                        | 338LF, 48" RCP @ 1.8%                         |           |
| SD46                        | 40LF, 48" RCP @ 2.0%                          |           |
| SD47                        | 62LF, 24" RCP @ 74.5' 36" 7.5' 48" W/ REDUCER |           |
| SD48                        | 157LF, 42" RCP @ 4.5%                         |           |
| SD49                        | 335LF, 36" RCP @ 4.5%                         |           |
| SD50                        | 151LF, 36" RCP @ 3.5%                         |           |
| SD51                        | 348LF, 36" RCP @ 1.0%                         |           |
| SD52                        | 452LF, 36" RCP @ 3.4%                         |           |
| SD53                        | 61LF, 36" RCP @ 1.5%                          |           |
| SD54                        | 77LF, 30" RCP @ 1.7%                          |           |
| SD55                        | 118LF, 24" RCP @ 8.2%                         |           |
| SD56                        | 108LF, 36" RCP @ 1.0%                         |           |
| SD57                        | 376LF, 30" RCP @ 0.9%                         |           |
| SD58                        | 419LF, 18" RCP @ 1.0%                         |           |
| SD59                        | 144LF, 24" RCP @ 7.5%                         |           |
| SD60                        | 41LF, 24" RCP @ 1.3%                          |           |
| SD61                        | 113LF, 24" RCP @ 7.2%                         |           |
| SD62                        | 167LF, 24" RCP @ 9.7%                         |           |
| SD63                        | 54LF, 24" RCP @ 0.8%                          |           |
| SD64                        | 321LF, 36" RCP @ 3.0%                         |           |
| SD65                        | 356LF, 36" RCP @ 5.1%                         |           |
| SD66                        | 58LF, 36" RCP @ 2.3%                          |           |
| SD67                        | 481LF, 18" RCP @ 4.7%                         |           |
| SD68                        | 61LF, 18" RCP @ 4.7%                          |           |
| SD69                        | 32LF, 18" RCP @ 7.7%                          |           |
| SD70                        | 128LF, 48" RCP @ 1.0%                         |           |
| SD71                        | 71LF, 48" RCP @ 1.0%                          |           |
| SD72                        | 32LF, 42" RCP @ 4.2%                          |           |
| SD73                        | 727LF, 30" RCP @ 4.2%                         |           |
| SD74                        | 104LF, 30" RCP @ 5.9%                         |           |
| SD75                        | 272LF, 18" RCP @ 3.5%                         |           |
| SD76                        | 62LF, 54" RCP @ 1.0%                          |           |
| SD77                        | 400LF, 48" RCP @ 2.0%                         |           |
| SD78                        | 200LF, 48" RCP @ 2.0%                         |           |
| SD79                        | 485LF, 48" RCP @ 2.0%                         |           |
| SD80                        | 15LF, 48" RCP @ 2.0%                          |           |
| SD81                        | 389LF, 54" RCP @ 5.0%                         |           |
| SD82                        | 8LF, 54" RCP @ 5.0%                           |           |
| SD83                        | 15LF, 54" RCP @ 4.5%                          |           |
| SD84                        | 60LF, 54" RCP @ 4.5%                          |           |
| SD85                        | 34LF, 54" RCP @ 4.5%                          |           |
| SD86                        | 256LF, 54" RCP @ 4.5%                         |           |
| SD87                        | 270LF, 54" RCP @ 4.5%                         |           |
| SD88                        | 38LF, 30" RCP @ 2.0%                          |           |
| SD89                        | 68LF, 54" RCP @ 2.4%                          |           |
| SD90                        | 207LF, 54" RCP @ 2.4%                         |           |
| SD91                        | 110LF, 18" RCP @ 2.0%                         |           |
| SD92                        | 130LF, 54" RCP @ 6.2%                         |           |
| SD93                        | 50LF, 48" ELLIPTICAL RCP @ 5%                 |           |
| SD94                        | 41LF, 48" RCP @ 11.5%                         |           |
| SD95                        | 49LF, 30" RCP @ 11.5%                         |           |
| SD96                        | 35LF, 30" RCP @ 2.0%                          |           |
| SD97                        | 128LF, 48" RCP @ 12.8%                        |           |
| SD98                        | 32LF, 42" RCP @ 12.8%                         |           |
| SD99                        | 56LF, 42" RCP @ 12.8%                         |           |
| SD100                       | 378LF, 42" RCP @ 2.9%                         |           |
| SD101                       | 188LF, 42" RCP @ 5.9%                         |           |
| SD102                       | 496LF, 42" RCP @ 6.4%                         |           |
| SD103                       | 398LF, 42" RCP @ 4.5%                         |           |
| SD104                       | 413LF, 42" RCP @ 9.7%                         |           |
| SD105                       | 78LF, 42" RCP @ 2.6%                          |           |
| SD106                       | 421LF, 18" RCP @ 5.4%                         |           |
| SD107                       | 470LF, 18" RCP @ 2.7%                         |           |
| SD108                       | 66LF, 42" RCP @ 2.9%                          |           |
| SD109                       | 55LF, 30" RCP @ 3.2%                          |           |
| SD110                       | 160LF, 30" RCP @ 1.1%                         |           |
| SD111                       | 211LF, 30" RCP @ 1.1%                         |           |
| SD112                       | 396LF, 30" RCP @ 1.0%                         |           |
| SD113                       | 33LF, 30" RCP @ 1.0%                          |           |
| SD114                       | 35LF, 18" RCP @ 2.0%                          |           |
| SD115                       | 142LF, 18" RCP @ 14.9%                        |           |
| SD116                       | 54LF, 18" RCP @ 2.1%                          |           |
| SD117                       | 89LF, 36" RCP @ 4.1%                          |           |
| SD118                       | 99LF, 36" RCP @ 4.1%                          |           |
| SD119                       | 58LF, 24" x 36" ELLIPTICAL RCP @ 3.0%         |           |
| SD120                       | 105LF, 30" RCP @ 1.5%                         |           |
| SD121                       | 50LF, 42" RCP @ 11.0%                         |           |
| SD122                       | 163LF, 42" RCP @ 3.6%                         |           |
| SD123                       | 28LF, 42" RCP @ 33.3%                         |           |
| SD124                       | 16LF, 42" RCP @ 1.0%                          |           |
| SD125                       | 200LF, 18" RCP @ 3.5%                         |           |
| SD126                       | 275LF, 18" RCP @ 8.0%                         |           |
| SD127                       | 262LF, 24" RCP @ 1%                           |           |
| SD128                       | 908LF, 15" RCP @ 1%                           |           |
| SD129                       | 1602LF, 15" RCP @ 1%                          |           |
| SD130                       | 2102LF, 24" RCP @ 1%                          |           |
| SD131                       | 3302LF, 30" RCP @ 3%                          |           |
| SD132                       | 4802LF, 24" RCP @ 1%                          |           |
| SD133                       | 2002LF, 24" RCP @ 1%                          |           |
| SD134                       | 141LF, 48" RCP @ 2.0%                         |           |
| SD135                       | 31LF, 48" RCP @ 3%                            |           |
| SD136                       | 30LF, 48" RCP @ 3.4%                          |           |
| SD137                       | 198LF, 48" RCP @ 3.4%                         |           |
| SD138                       | 297LF, 48" RCP @ 6.0%                         |           |
| SD139                       | 191LF, 48" RCP @ 3%                           |           |
| SD140                       | 308LF, 48" RCP @ 1.8%                         |           |
| SD141                       | 105LF, 36" RCP @ 1.5%                         |           |
| SD142                       | 34LF, 36" RCP @ 1.5%                          |           |
| SD143                       | 71LF, 36" RCP @ 1.5%                          |           |
| SD144                       | 350LF, 36" RCP @ 5.5%                         |           |
| SD145                       | 57LF, 36" RCP @ 27.1%                         |           |
| SD146                       | 6LF, 30" RCP @ 3.3%                           |           |
| SD147                       | 185LF, 30" RCP @ 3.3%                         |           |
| SD148                       | 61LF, 24" RCP @ 5.2%                          |           |
| SD149                       | 308LF, 12" RCP @ 1.0%                         |           |
| SD150                       | 15LF, 12" RCP @ 1.0%                          |           |
| SD151                       | 46LF, 18" RCP @ 4.0%                          |           |
| SD152                       | 64LF, 18" RCP @ 4.0%                          |           |
| SD153                       | 107LF, 24" RCP @ 3.5%                         |           |
| SD154                       | 19LF, 24" RCP @ 4.0%                          |           |
| SD155                       | 7LF, 24" RCP @ 1%                             |           |
| SD156                       | 436LF, 24" RCP @ 2.6%                         |           |
| SD157                       | 454LF, 1" RCP @ 1%                            |           |
| SD158                       | 122LF, 1" RCP @ 1%                            |           |
| SD159                       | 1723LF, 3" - 14, 10" CBS                      |           |

NOTE:  
THE INFORMATION CONTAINED ON THIS MAP WAS OBTAINED IN THE REVIEW OF DRAINAGE PLANS AND CONSTRUCTION PLANS. THE INFORMATION IS INTENDED TO DEMONSTRATE THE GENERAL EXTENT OF EXISTING DRAINAGE FACILITIES AND IS NOT INTENDED OR WARRANTED FOR ANY OTHER USE.

| MANHOLE DATA TABLE |      |       |
|--------------------|------|-------|
| #                  | TYPE | DEPTH |
| MH1                | I    | 11.1  |
| MH2                | I    | 10.4  |
| MH3                | I    | 10.7  |
| MH4                | I    | 15.4  |
| MH5                | I    | 8.4   |
| MH6                | I    | 9.4   |
| MH7                | I    | 6.0   |
| MH8                | I    | 7.8   |
| MH9                | I    | 7.2   |
| MH10               | I    | 11.9  |
| MH11               | I    | 9.4   |
| MH12               | I    | 14.9  |
| MH13               | I    | 8.0   |
| MH14               | I    | 8.2   |
| MH15               | I    | 3.8   |
| MH16               | I    | 5.5   |
| MH17               | I    | 7.6   |
| MH18               | I    | 5.0   |
| MH19               | I    | 4.4   |
| MH20               | I    | 7.2   |
| MH21               | I    | 5.0   |
| MH22               | I    | 6.9   |
| MH23               | I    | 7.8   |
| MH24               | I    | 6.3   |
| MH25               | I    | 6.3   |
| MH26               | I    | 6.8   |
| MH27               | I    | 6.8   |
| MH28               | I    | 3.8   |
| MH29               | I    | 4.6   |
| MH30               | I    | 7.4   |
| MH31               | I    | 8.3   |
| MH32               | I    | 6.3   |
| MH33               | I    | 12.2  |
| MH34               | I    | 7.1   |
| MH35               | I    | 4.9   |
| MH36               | II   | 10.6  |
| MH37               | II   | 11.9  |
| MH38               | II   | 14.6  |
| MH39               | II   | 9.0   |
| MH40               | II   | 2.0   |
| MH41               | II   | 7.2   |
| MH42               | II   | 6.5   |
| MH43               | II   | 10.1  |
| MH44               | II   | 6.3   |
| MH45               | II   | 5.0   |
| MH46               | II   | 5.2   |
| MH47               | II   | 6.2   |
| MH48               | II   | ?     |
| MH49               | II   | 8.7   |
| MH50               | II   | 8.6   |
| MH51               | II   | 7.9   |
| MH52               | II   | 10.2  |
| MH53               | II   | 3.4   |
| MH54               | II   | ?     |
| MH55               | II   | ?     |
| MH56               | II   | 9.0   |

PINE CREEK  
4/14/98  
**JR Engineering, Ltd.**  
4895 North 30th Street  
Colorado Springs, Colorado 80919  
(719) 589-2695 • FAX (719) 528-8813