

The maps and photographs included in this report were developed for purposes of the Colorado Springs Department of Utilities and are for internal use only. The Colorado Springs Department of Utilities makes no warranty, expressed or implied, as to the completeness, accuracy, or content of such products or any reproductions thereof. Any other use is not recommended and occurs at the risk of the user; such user is solely responsible and/or liable for the use of such products.

Original maps and photographs are the property of the Colorado Springs Department of Utilities. All rights are reserved. These maps and photographs or any associated records may not, wholly or in part, be reproduced, stored, or transmitted in any form or by any means, electronic, mechanical, photocopying, or otherwise, without the express prior written permission of the Colorado Springs Department of Utilities.

Regardless of the existence of purported copies of these official maps and photographs which may from time to time be made or published, there is only one set of official maps and photographs, which are those kept and maintained by the Colorado Springs Department of Utilities.

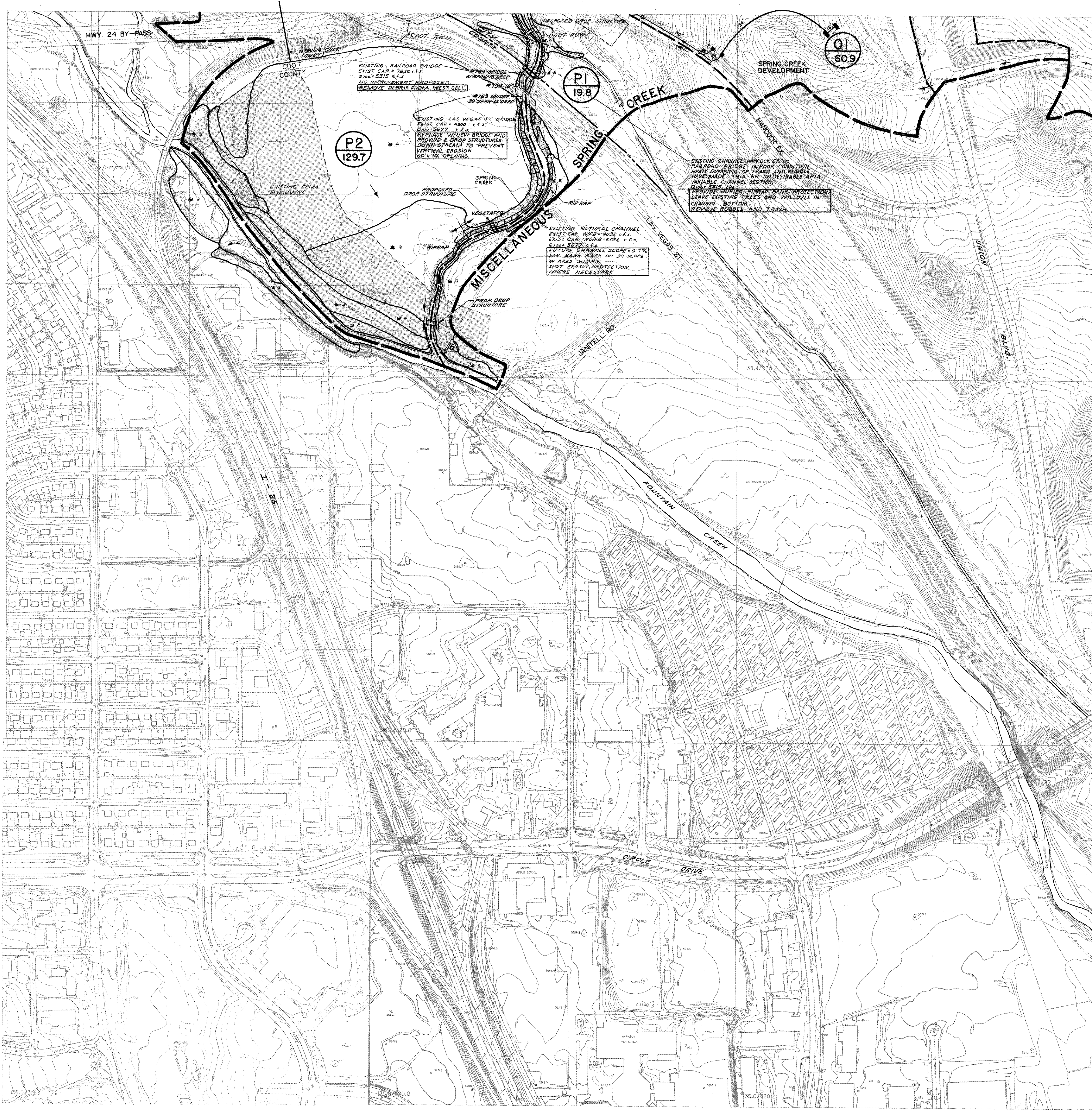

RATIONAL METHOD PEAK FLOWS				
DESIGN POINT	AREA (AC)	INTENSITY (IN/HR)	TC (MIN)	Q100 (CFS)
P1	12.4	6.4	19.8	101
P2	20.7	5.0	129.7	499

MAIN CHANNEL FLOWS FROM LARGER SUBBASIN COMPUTER MODEL (HEC-1)		
DESIGN POINT	LOCATION / DESCRIPTION	PEAK FLOW (CFS)
P1	CONFLUENCE WITH FOUNTAIN CREEK	5,077

SPRING CREEK DBPS COMPOSITION OF LARGER SUBBASINS	
OVERALL BASIN	CONTRIBUTING SUBBASINS
BASIN A	A1, A2, B1, B2, B3, B4, B5, C1, C2
BASIN B	D1, D2, E1, F6
BASIN C	F1, F2, F3, F4, F5, F7, F8
BASIN D	G1, G2, G3, G4, G5, G6
BASIN E	H1, H2
BASIN F	I1, J1, J2, J3, J4, J5, J6, J7, J8, J9, J10, J11, J12, J13, J14, J15, J16, J17, J18, J19, J20, J21, J22, J23, J24, J25, J26, J27, J28, J29, J30, J31, J32, J33, J34, J35, J36, J37, J38, J39, J40, J41, J42, J43, J44, J45, J46, J47, J48, J49, J50, J51, J52, J53, J54, J55, J56, J57, J58, J59, J60, J61, J62, J63, J64, J65, J66, J67, J68, J69, J70, J71, J72, J73, J74, J75, J76, J77, J78, J79, J80, J81, J82, J83, J84, J85, J86, J87, J88, J89, J90, J91, J92, J93, J94, J95, J96, J97, J98, J99, J100
BASIN G	K1, K2, K3, K4, K5, K6, K7, K8, K9, K10, K11, K12, K13, K14, K15, K16, K17, K18, K19, K20, K21, K22, K23, K24, K25, K26, K27, K28, K29, K30, K31, K32, K33, K34, K35, K36, K37, K38, K39, K40, K41, K42, K43, K44, K45, K46, K47, K48, K49, K50, K51, K52, K53, K54, K55, K56, K57, K58, K59, K60, K61, K62, K63, K64, K65, K66, K67, K68, K69, K70, K71, K72, K73, K74, K75, K76, K77, K78, K79, K80, K81, K82, K83, K84, K85, K86, K87, K88, K89, K90, K91, K92, K93, K94, K95, K96, K97, K98, K99, K100
BASIN H	L1, L2, L3, L4, L5, L6, L7, L8, L9, L10, L11, L12, L13, L14, L15, L16, L17, L18, L19, L20, L21, L22, L23, L24, L25, L26, L27, L28, L29, L30, L31, L32, L33, L34, L35, L36, L37, L38, L39, L40, L41, L42, L43, L44, L45, L46, L47, L48, L49, L50, L51, L52, L53, L54, L55, L56, L57, L58, L59, L60, L61, L62, L63, L64, L65, L66, L67, L68, L69, L70, L71, L72, L73, L74, L75, L76, L77, L78, L79, L80, L81, L82, L83, L84, L85, L86, L87, L88, L89, L90, L91, L92, L93, L94, L95, L96, L97, L98, L99, L100
BASIN I	M1, M2, M3, M4, M5, M6, M7, M8, M9, M10, M11, M12, M13, M14, M15, M16, M17, M18, M19, M20, M21, M22, M23, M24, M25, M26, M27, M28, M29, M30, M31, M32, M33, M34, M35, M36, M37, M38, M39, M40, M41, M42, M43, M44, M45, M46, M47, M48, M49, M50, M51, M52, M53, M54, M55, M56, M57, M58, M59, M60, M61, M62, M63, M64, M65, M66, M67, M68, M69, M70, M71, M72, M73, M74, M75, M76, M77, M78, M79, M80, M81, M82, M83, M84, M85, M86, M87, M88, M89, M90, M91, M92, M93, M94, M95, M96, M97, M98, M99, M100
BASIN J	N1, N2, N3, N4, N5, N6, N7, N8, N9, N10, N11, N12, N13, N14, N15, N16, N17, N18, N19, N20, N21, N22, N23, N24, N25, N26, N27, N28, N29, N30, N31, N32, N33, N34, N35, N36, N37, N38, N39, N40, N41, N42, N43, N44, N45, N46, N47, N48, N49, N50, N51, N52, N53, N54, N55, N56, N57, N58, N59, N60, N61, N62, N63, N64, N65, N66, N67, N68, N69, N70, N71, N72, N73, N74, N75, N76, N77, N78, N79, N80, N81, N82, N83, N84, N85, N86, N87, N88, N89, N90, N91, N92, N93, N94, N95, N96, N97, N98, N99, N100

NOTE: ALL PROPOSED INLETS ARE ASSUMED TO BE 12" D-10-R, UNLESS OTHERWISE NOTED.

LEGEND:

- * 1. STRUCTURAL FLOODWAY - concrete lined or rip-rap channel
- * 2. OPEN WATER - ponds and reservoirs (excludes flowing channel)
- * 3. MATURE RIPARIAN FOREST - cottonwood and willow along perennial drainages
- * 4. RIPARIAN GRASSLAND - grass and shrub depressions in the floodplains of perennial drainages
- * 5. HERBACEOUS WETLAND - low lying grassy and weedy areas along intermittent drainages
- * 6. EMERGENT WETLAND - emergent wetlands along ponds or stream channels

LEGEND:

- (A2/501) BASIN DESIGNATION
- (AC) BASIN AREA (AC)
- ▲ DESIGN POINT
- MAJOR BASIN BOUNDARY
- SUB-BASIN BOUNDARY
- CITY LIMITS
- BUBBLER (STRUCTURE NO.)
- EXISTING STORM SEWER
- PROPOSED STORM SEWER
- EXIST. CROSS CULVERT OR BRIDGE
- PROP. CROSS CULVERT OR BRIDGE
- EXIST. BANK LINING WITH NO CHANGE
- EXIST. BANK LINING INCREASE DEPTH

- PROPOSED BANK LINING
- PROPOSED DROP STRUCTURE
- 8 ENVIRONMENTAL CLASSIFICATION

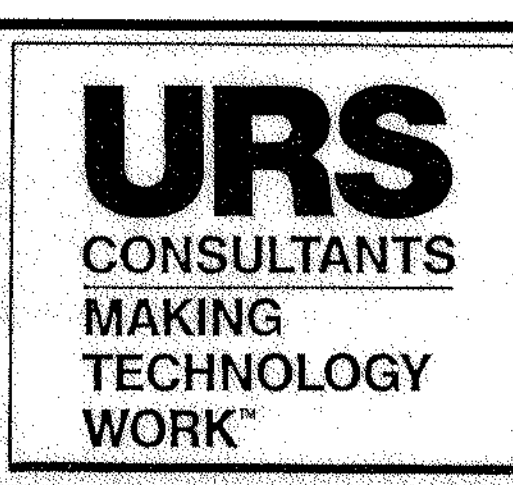
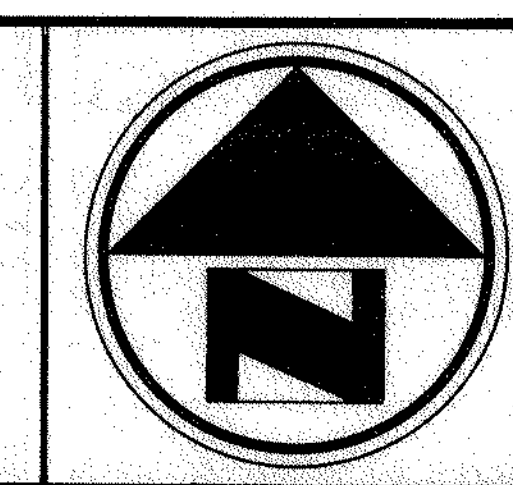
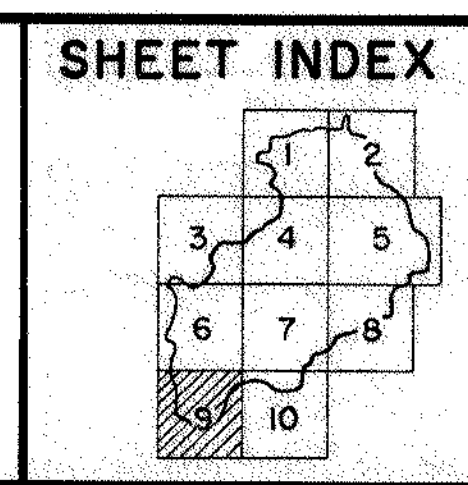

PROJECT:
SPRING CREEK DRAINAGE BASIN
PLANNING STUDY - DRAINAGE PLAN
 SCALE: 1" = 200'
 CONTOUR INTERVAL = 2'
 FIGURE 15 SHEET 9 OF 10