

AUSTIN BLUFFS BRIDGE AT COTTONWOOD CREEK

FINAL DRAINAGE REPORT

HEC-2 SECTIONS AND HEC-1 ANALYSIS POINTS

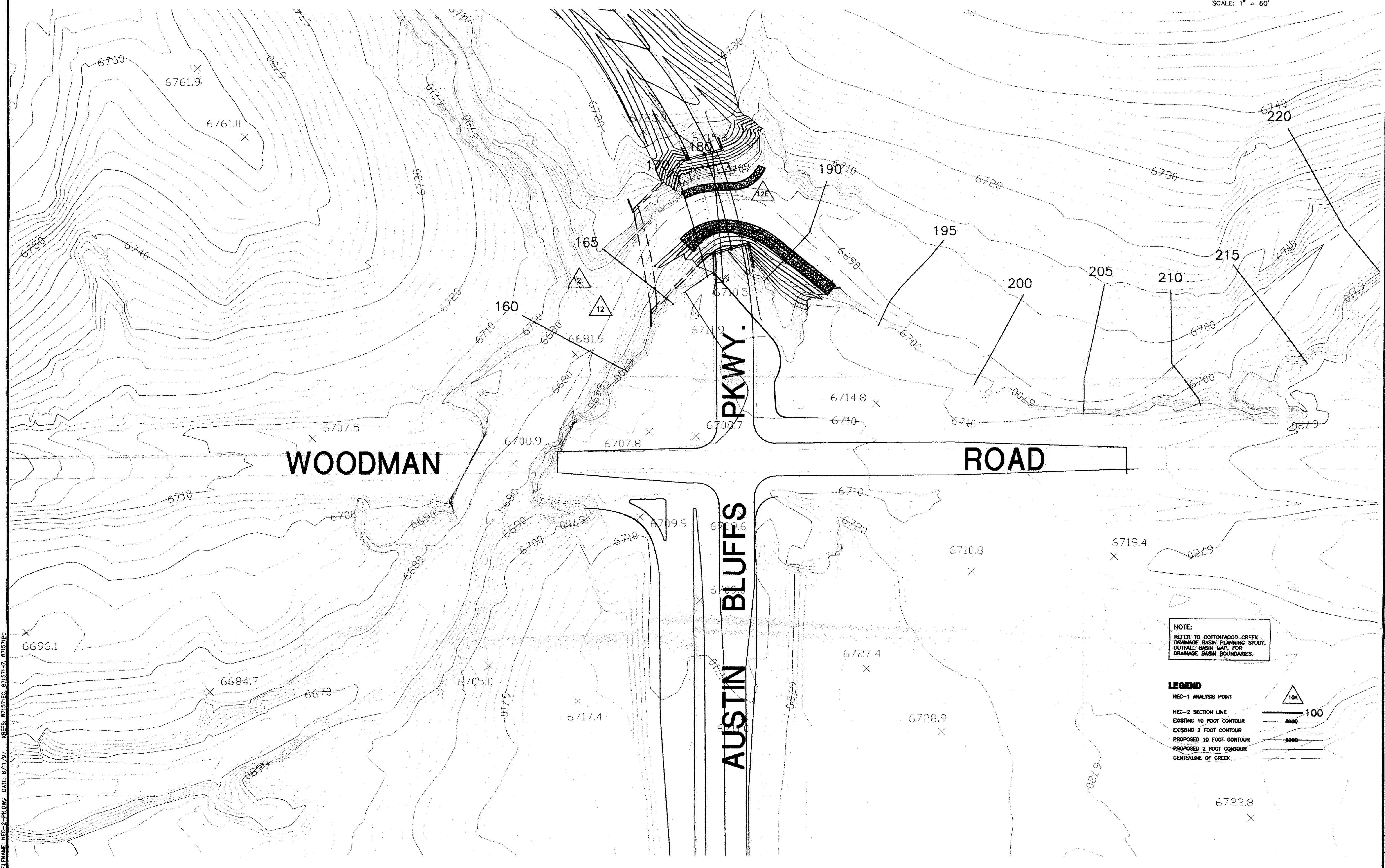
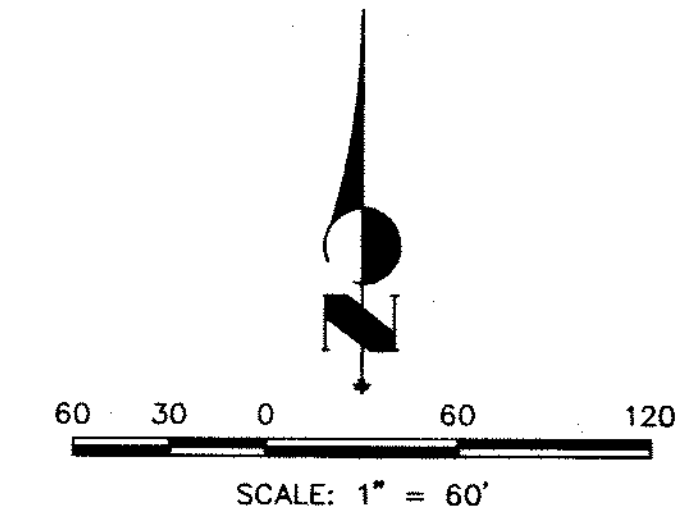

NOTE:
REFER TO COTTONWOOD CREEK
DRAINAGE BASIN PLANNING STUDY,
OUTFALL BASIN MAP, FOR
DRAINAGE BASIN BOUNDARIES.

LEGEND

HEC-1 ANALYSIS POINT	
HEC-2 SECTION LINE	
EXISTING 10 FOOT CONTOUR	
EXISTING 2 FOOT CONTOUR	
PROPOSED 10 FOOT CONTOUR	
PROPOSED 2 FOOT CONTOUR	
CENTERLINE OF CREEK	

FILENAME: HEC-2-PRO.DWG. DATE: 8/1/97. PLOTTED: 8/15/97. PLOTTER: HP-GL/2. PLOTTER: HP-GL/2.

<p>UNTIL SUCH TIME AS THESE DRAWINGS ARE APPROVED BY THE CITY ENGINEER, THE CITY ENGINEER'S APPROVAL DOES NOT CONSTITUTE AN ENDORSEMENT OR GUARANTEE OF THE ACCURACY OF THE INFORMATION OR THE PURPOSES DESIGNATED BY WRITTEN AUTHORIZATION.</p>	<p>48 HOURS BEFORE YOU DIG, CALL UTILITY LOCATORS 1-800-922-1987 CITY OF COLORADO SPRINGS DEPT. OF UTILITIES GAS, ELECTRIC, WATER AND WASTEWATER</p>
<p>JR Engineering, Ltd. 4635 North 30th Street Colorado Springs, Colorado 80919 (719) 598-8888 • FAX (719) 528-8613</p>	
<p>SCALE: 1"=60'</p>	<p>DATE: 4/29/97</p>
<p>DES. BY: VSF</p>	<p>CHK. BY: DFS</p>
<p>DWN. BY: DFS</p>	<p>NO.:</p>
<p>REVISION:</p>	<p>BY: DATE:</p>
<p>AUSTIN BLUFFS BRIDGE AT COTTONWOOD CREEK</p>	<p>HYDRAULIC/HYDROLOGIC ANALYSIS EXHIBIT</p>
<p>SHEET 1 OF 1</p>	<p>PROPOSED HEC-2 SECTIONS AND HEC-1 ANALYSIS POINTS</p>
<p>JOB NO. 8715.71</p>	