

AUSTIN BLUFFS PARKWAY (PILOT ROAD) PRELIMINARY/FINAL DRAINAGE PLAN

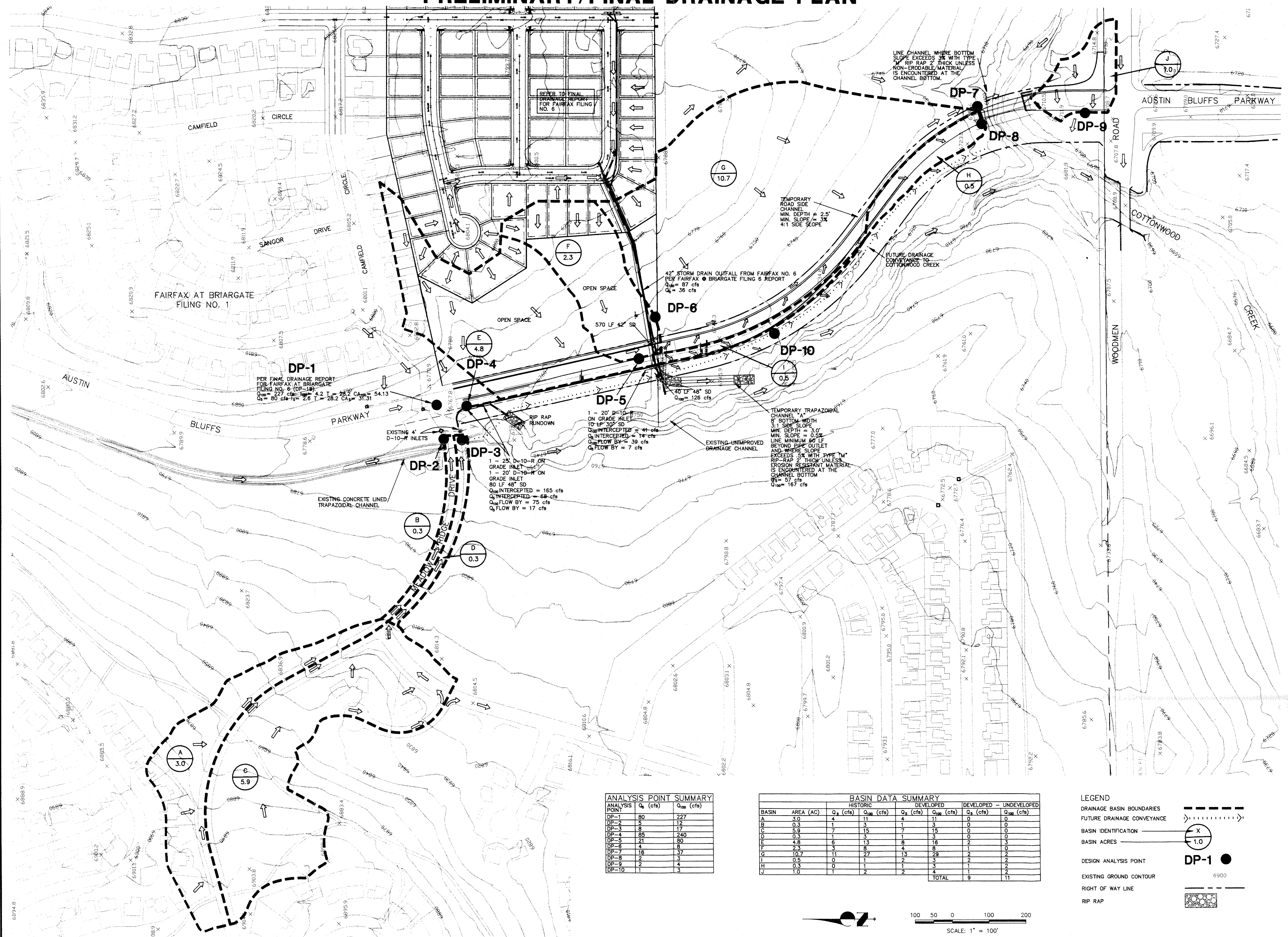

ANALYSIS POINT SUMMARY

ANALYSIS POINT	Q ₀ (cfs)	Q ₁₀₀ (cfs)
DP-1	80	227
DP-2	5	12
DP-3	8	17
DP-4	85	240
DP-5	21	80
DP-6	4	8
DP-7	16	37
DP-8	2	3
DP-9	2	4
DP-10	1	2

Basin Data Summary

Basin	Area (AC)	Historic		Developed		Undeveloped	
		Q _s (cfs)	Q ₁₀₀ (cfs)	Q _s (cfs)	Q ₁₀₀ (cfs)	Q _s (cfs)	Q ₁₀₀ (cfs)
A	3.0	4	11	4	11	0	0
B	0.3	1	3	1	3	0	0
C	5.9	7	15	7	15	0	0
D	0.3	1	3	1	3	0	0
E	4.8	6	13	6	13	2	3
F	2.3	3	8	4	8	1	2
G	10.7	11	27	13	29	2	2
H	0.5	0	1	2	3	2	2
I	0.3	0	1	1	3	1	2
J	1.0	1	2	2	4	1	2
TOTAL						9	11

- LEGEND**
- DRAINAGE BASIN BOUNDARIES
 - - - - - FUTURE DRAINAGE CONVEYANCE
 - (X)--- BASIN IDENTIFICATION
 - DP-1 BASIN ACRES
 - DESIGN ANALYSIS POINT
 - EXISTING GROUND CONTOUR
 - RIGHT OF WAY LINE
 - RIP RAP

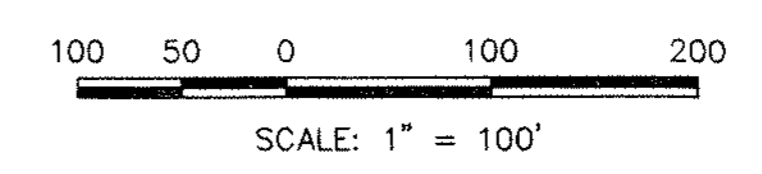

THIS PLAN IS AS SHOWN. THE APPLICABLE REVIEWING OFFICIALS HAVE REVIEWED THE PLAN FOR THE PURPOSES DESIGNATED BY THE CITY OF COLORADO SPRINGS. THE CITY OF COLORADO SPRINGS DEPT. OF UTILITIES GAS, ELECTRIC, WATER AND WASTEWATER.

48 HOURS BEFORE YOU DIG,
CALL UTILITY LOCATORS
1-800-922-1987
CITY OF COLORADO SPRINGS DEPT. OF UTILITIES
GAS, ELECTRIC, WATER AND WASTEWATER

JR Engineering, Ltd.
682 North 30th Street, Suite 100
Colorado Springs, Colorado 80910
(719) 588-5880 • FAX (719) 588-6813

SCALE	NO.	REVISION	DATE	BY	DATE
1"=100'			6/24/97	VSF	
				CHK BY	
				DWN BY	

AUSTIN BLUFFS PARK (PILOT ROAD)
FINAL DRAINAGE PLAN
SHEET 1 OF 1
JOB NO. 8715.71