

PATH: X:\871571\DRAWINGS\ROAD-PP\ FILENAME: 8715714 XREFS: 8715-EG1, 871571H2, 871571PC DATE: 5/02/97

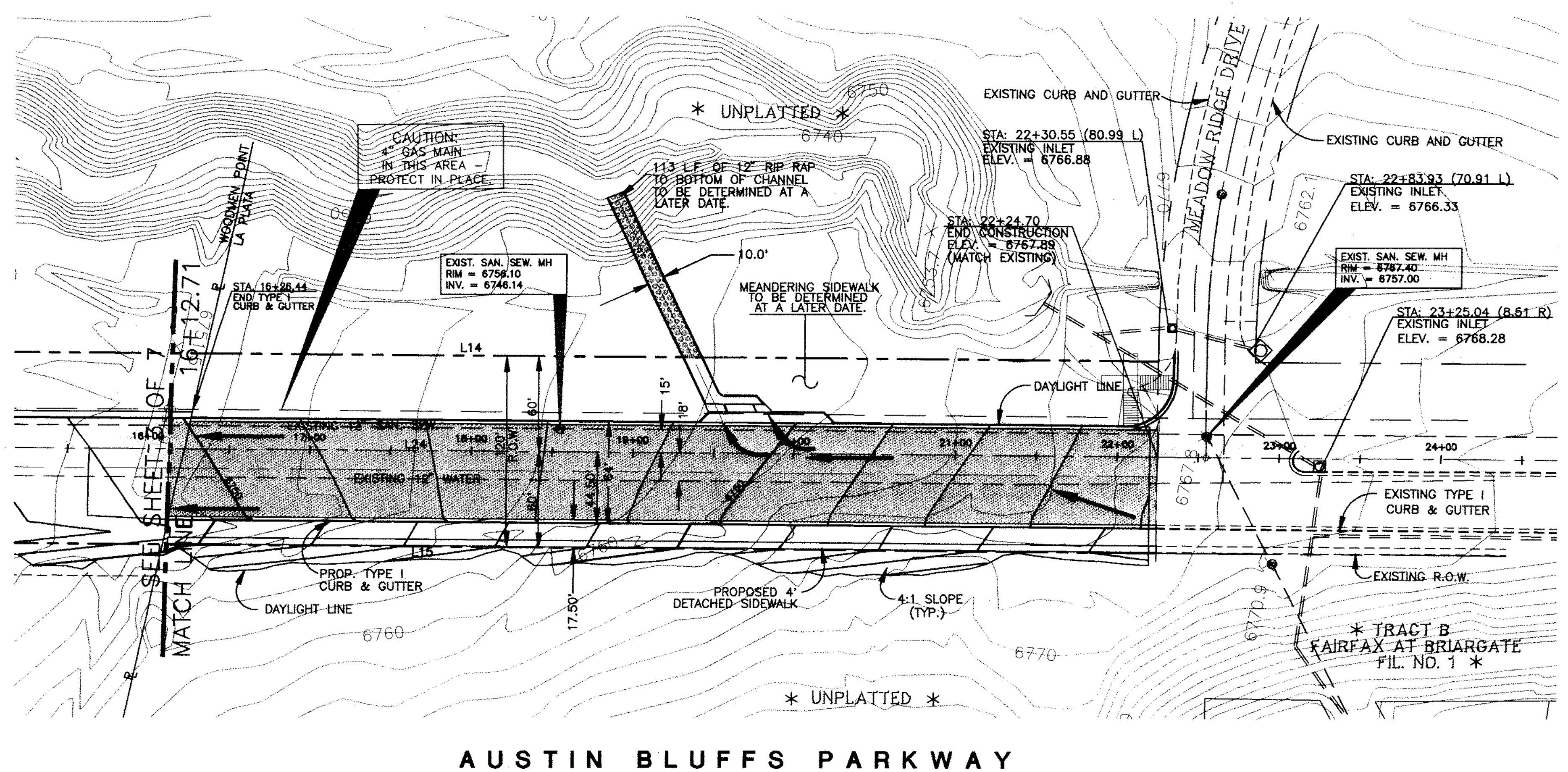

LINE DATA TABLE			
LINE	DIRECTION	DISTANCE	REMARKS
L14	N12°33'38\"W	611.99'	R.O.W.
L15	N12°33'38\"W	611.99'	R.O.W.
L24	N12°33'38\"W	611.99'	CENTERLINE

LEGEND
 FLOW DIRECTION
 6600 EXISTING GROUND CONTOUR
 6600 PROPOSED FINISHED CONTOUR

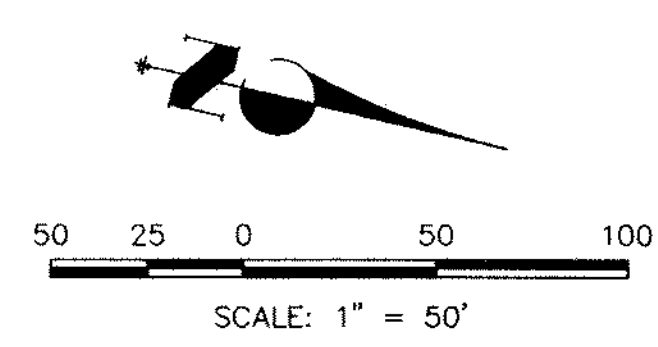

PREPARED UNDER MY DIRECT SUPERVISION FOR AND ON BEHALF OF JR ENGINEERING, LTD.

KYLE R. CAMPBELL, COLORADO P.E. #29794 DATE

THIS DRAWING IS INCOMPLETE WITHOUT SHEETS 1 THROUGH 7

<p>UNTIL SUCH TIME AS THESE PLANS ARE REVIEWED BY THE APPROPRIATE REVIEWING AGENCIES, OR ENGINEERING, LTD. APPROVES, THEIR USE ONLY FOR APPROVED PROJECTS AS AUTHORIZED BY WRITTEN AUTHORIZATION.</p>										
<p>48 HOURS BEFORE YOU DIG, CALL UTILITY LOCATORS 1-800-922-1987 CITY OF COLORADO SPRINGS DEPT. OF UTILITIES GAS, ELECTRIC, WATER AND WASTEWATER</p>										
<p>JR Engineering, Ltd. 4885 North 30th Street Colorado Springs, Colorado 80919 (719) 582-2565 • FAX (719) 528-6613</p>										
BY	DATE									
PAK	3/27/97									
BAP	5/29/97									
<p>REVISION</p> <table border="1"> <thead> <tr> <th>NO.</th> <th>REVISED PER CITY REVIEW</th> <th>REVISION</th> </tr> </thead> <tbody> <tr> <td>1</td> <td></td> <td></td> </tr> <tr> <td>2</td> <td></td> <td></td> </tr> </tbody> </table>		NO.	REVISED PER CITY REVIEW	REVISION	1			2		
NO.	REVISED PER CITY REVIEW	REVISION								
1										
2										
SCALE	1"=50'									
DATE	1/31/97									
DES. BY	PAK									
CHK. BY										
DWN. BY	MEM									
<p>AUSTIN BLUFFS PARKWAY (PILOT ROAD) GRADING AND EROSION CONTROL PLANS STA. 16+12.71 TO STA. 22+24.70 OVERLOT GRADING PLAN</p>										
<p>SHEET 4 OF 7</p>										
<p>JOB NO. 8715.71</p>										