

AREAS TRIBUTARY TO POND 96

VILLAGE 2 BASINS	DA (sq ft)	CN	Tc (hr)	Proposed Basin Runoff	
				Q10 (cfs)	Q100 (cfs)
1N	0.080	88	0.22	98	198
4N	0.051	77	0.38	27	72
17N	0.030	77	0.38	16	41
18N	0.093	83	0.29	64	165
19N	0.053	76	0.32	25	72
66	0.088	80	0.33	59	144
68	0.035	79	0.36	21	53
69	0.081	80	0.32	41	101
70	0.150	78	0.51	76	196
UPSTREAM BASINS (To Pond 95)					
3	0.063	83	0.31	53	120
67	0.093	81	0.39	64	163
72	0.112	76	0.47	49	133
73	0.067	94	0.24	115	203
87	0.128	81.9	0.87	14	61
88	0.280	85	0.60	37	199
89	0.096	85	0.49	13	55
90	0.090	88	0.28	95	192
DOWNSTREAM & OFFSITE BASINS					
2N	0.080	86	0.38	275	576
21	0.018	87	0.23	21	43
39	0.158	84	0.35	139	307
40	0.133	82	0.37	108	250
41	0.210	81	0.40	144	342
42	0.095	79	0.39	51	127
43	0.320	87	0.41	328	672
46	0.037	80	0.30	27	67
55	0.088	83	0.39	68	183
56	0.151	85	0.38	139	299
57	0.165	84	0.37	146	321
58	0.113	88	0.38	122	246
59	0.181	88	0.41	197	396
60	0.270	85	0.36	254	547
61	0.030	96	0.33	31	64
62	0.157	85	0.34	148	320
63	0.104	77	0.42	58	139
64	0.083	82	0.34	64	149
65	0.073	82	0.27	61	142

DESIGN POINT	DA (sq ft)	PROPOSED DESIGN POINT FLOWS	
		Q10 (cfs)	Q100 (cfs)
1	4,420	262	833
2	4,480	327	851
24	0,920	650	1,428
25	1,540	328	741
26	1,120	763	1,708
27	1,830	334	802
28	0,800	505	1,139
41	0,740	479	1,064
42	0,710	448	1,000
43	0,680	385	897
44	1,460	274	610
45	0,440	228	500
46	0,170	139	318
47	0,280	83	194
49	0,560	162	493
50	0,360	116	327
51	0,600	172	527
52	0,160	170	352
53	0,810	328	106
54	0,960	407	1,122
55	1,140	522	1,422
57	1,310	148	329
61	0,410	174	419
62	0,330	101	278
63	0,280	82	226
83	2,690	1,037	2,400
84	2,730	1,046	2,446
85	4,200	1,069	4,983
86	4,220	1,27	788
121	0,010	14	28
122	0,010	7	14
141	0,180	127	301
142	0,030	17	41

AREAS TRIBUTARY TO POND 89

DESIGN POINT	DA (sq ft)	PROPOSED DESIGN POINT FLOWS	
		Q10 (cfs)	Q100 (cfs)
53	1,58	154	608
54	0,49	63	262
42	1,88	962	2,054
69	1,71	165	632
73	3,65	1,099	2,495
88	3,73	1,127	2,550
67	4,45	1,622	3,336
65	4,53	1,656	3,444
Pond 97	4,53	1,012	1,490
85	0,67	277	657
43	0,63	345	777
3N	0,14	199	306
35	1,24	406	1,009
30	1,54	585	1,344
31	0,25	134	282
45	0,55	98	243
91	10,63	3,173	6,370
Pond 89	10,63	427	2,321

VILLAGE 2 BASINS	DA (sq ft)	CN	Tc (hr)	Proposed Basin Runoff	
				Q10 (cfs)	Q100 (cfs)
3N	0,14	90,0	0,50	159	306
20N	0,06	81,0	0,35	81	153
72	0,24	85,0	0,51	197	425
UPSTREAM BASINS (To Pond 97)					
5N	0,05	93,8	0,39	77	138
6N	0,04	84,0	0,33	65	116
7N	0,06	71,8	0,34	20	64
8N	0,08	83,0	0,35	65	148
73	0,08	84,0	0,40	68	149
74	0,15	90,0	0,33	195	374
75	0,13	87,0	0,37	136	280
82	0,24	85,0	1,12	22	92
83	0,35	87,0	1,34	37	135
84	0,19	89,0	0,60	186	364
85	0,27	89,0	0,72	235	463
86	0,33	77,0	0,71	128	336
91	0,41	89,0	0,54	423	832
92	0,42	83,0	0,74	249	569
93	0,24	89,0	0,86	41	141
94	0,43	85,0	1,27	37	151
95	0,11	85,0	0,98	11	46
97	0,07	69,0	0,58	15	52
98	0,14	69,0	0,60	29	101
99	0,44	69,0	1,15	63	213
DOWNSTREAM & OFFSITE BASINS					
4N	0,16	86,8	1,46	76	155
9N	0,05	87,3	1,46	24	50
10N	0,18	81,0	1,54	105	198
11N	0,1	85,1	0,88	62	130
12N	0,1	85,4	1,21	50	106
13N	0,18	87,0	0,67	146	298
14N	0,04	92,0	1,47	28	47
15N	0,06	85,0	0,91	36	77
16N	0,12	84,0	0,98	63	138
44	0,29	86,0	0,27	307	647
45	0,32	88,0	0,78	248	499
47	0,19	82,0	0,91	93	213
48	0,56	66,0	0,98	63	248
49	0,27	89,0	0,76	50	171
50	0,19	81,3	1,83	93	123
51	0,13	81,4	0,97	73	170
52	0,27	90,0	1,47	154	296
53	0,15	88,1	1,23	83	178
54	0,15	90,0	0,92	121	233
55	0,22	87,3	1,47	107	217
56	0,15	85,0	1,13	76	163
57	0,51	92,0	1,46	328	604
71	0,09	92,0	1,46	58	107
76	0,14	87,0	1,06	84	173
77	0,19	85,0	1,21	92	198
78	0,31	87,0	1,09	78	386
79	0,27	85,0	1,15	25	101
80	0,08	81,0	0,41	55	131
81	0,35	86,0	0,39	61	249
96	0,14	65,0	0,88	15	63

LEGEND

- 79 DRAINAGE BASIN ID
- ▲ DESIGN POINT ID
- [54] HYDRAULIC REACH ID
- 97 STORAGE AREA ID
- DRAINAGE BASIN DELINEATION
- HYDRAULIC REACH
- VILLAGE 2 DELINEATION
- POND 89 & POND 96 DELINEATIONS
- BANNING LEWIS RANCH

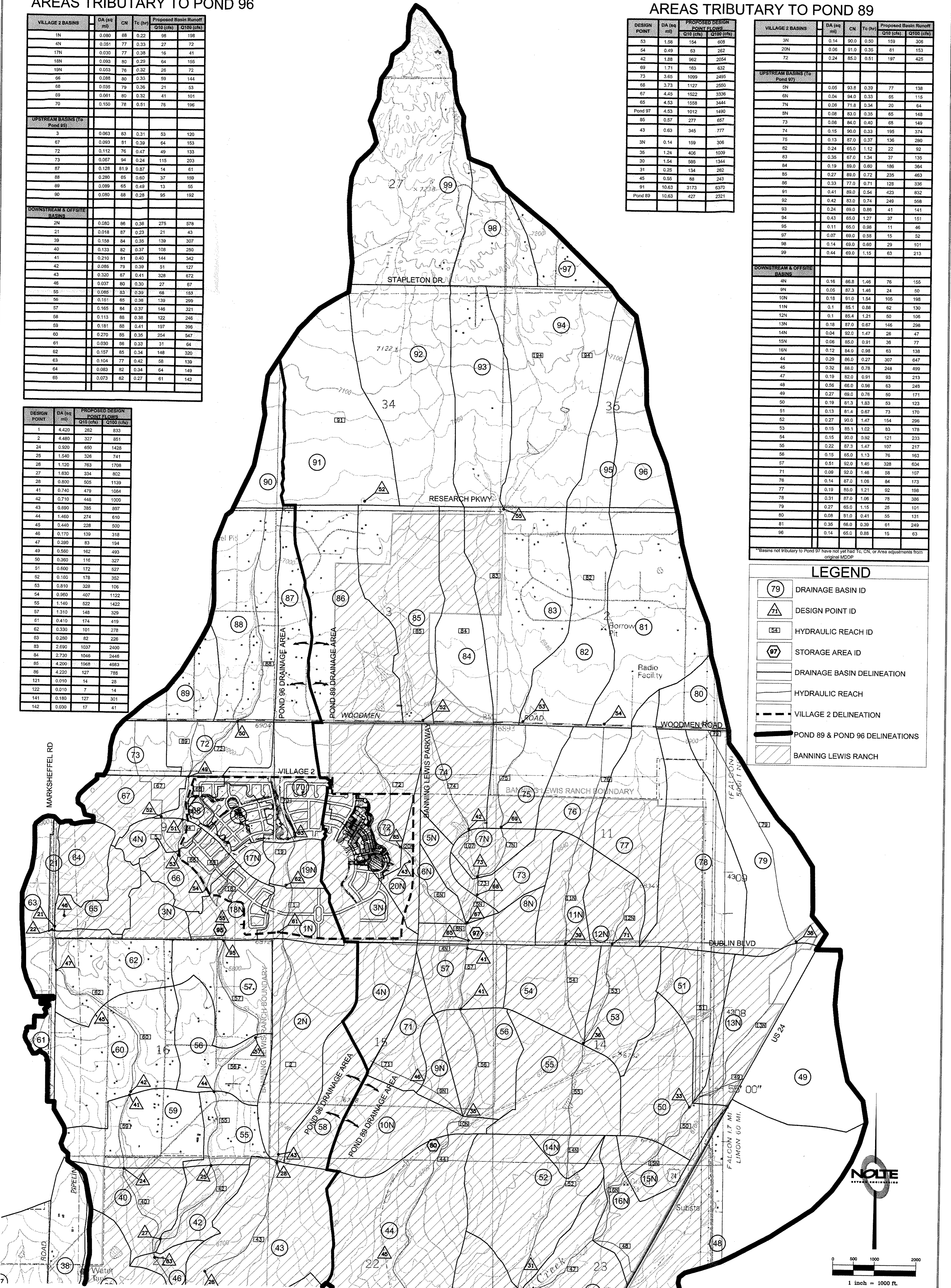

* REFERENCE BLR PHASE 1 & 2 MDDP FOR BASINS FURTHER DOWNSTREAM

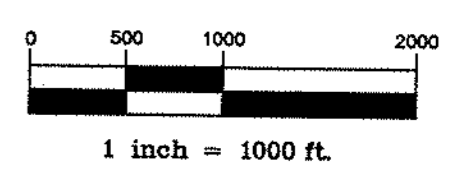

DRAINAGE BASIN ID			
NO.	BY	DATE	REVISIONS
1	JMH	04/05/2007	ADDED JS ENGINEERING NUMBERS
2	JMH	05/10/2007	CHANGES PER CITY REVIEW COMMENTS

CAUTION: The engineer preparing these plans will not be responsible for, or liable for, unauthorized changes to or uses of these plans. All changes to the plans must be in writing and must be approved by the preparer of these plans.

PRELIMINARY
NOT FOR CONSTRUCTION

NOLTE
BEYOND ENGINEERING

5225 N. ACADEMY BLVD., SUITE 304
 COLORADO SPRINGS, CO 80918
 719.268.8500 TEL. 719.268.9200 FAX
 WWW.NOLTE.COM

BANNING LEWIS RANCH
VILLAGE 2 MDDP
OFFSITE DRAINAGE BASIN MAP

PREPARED FOR: BANNING LEWIS RANCH DATE SUBMITTED: MAY 2007

SHEET NUMBER 1 OF 3 SHEETS CSB0802