

BENTLEY COMMONS DRAINAGE PLAN

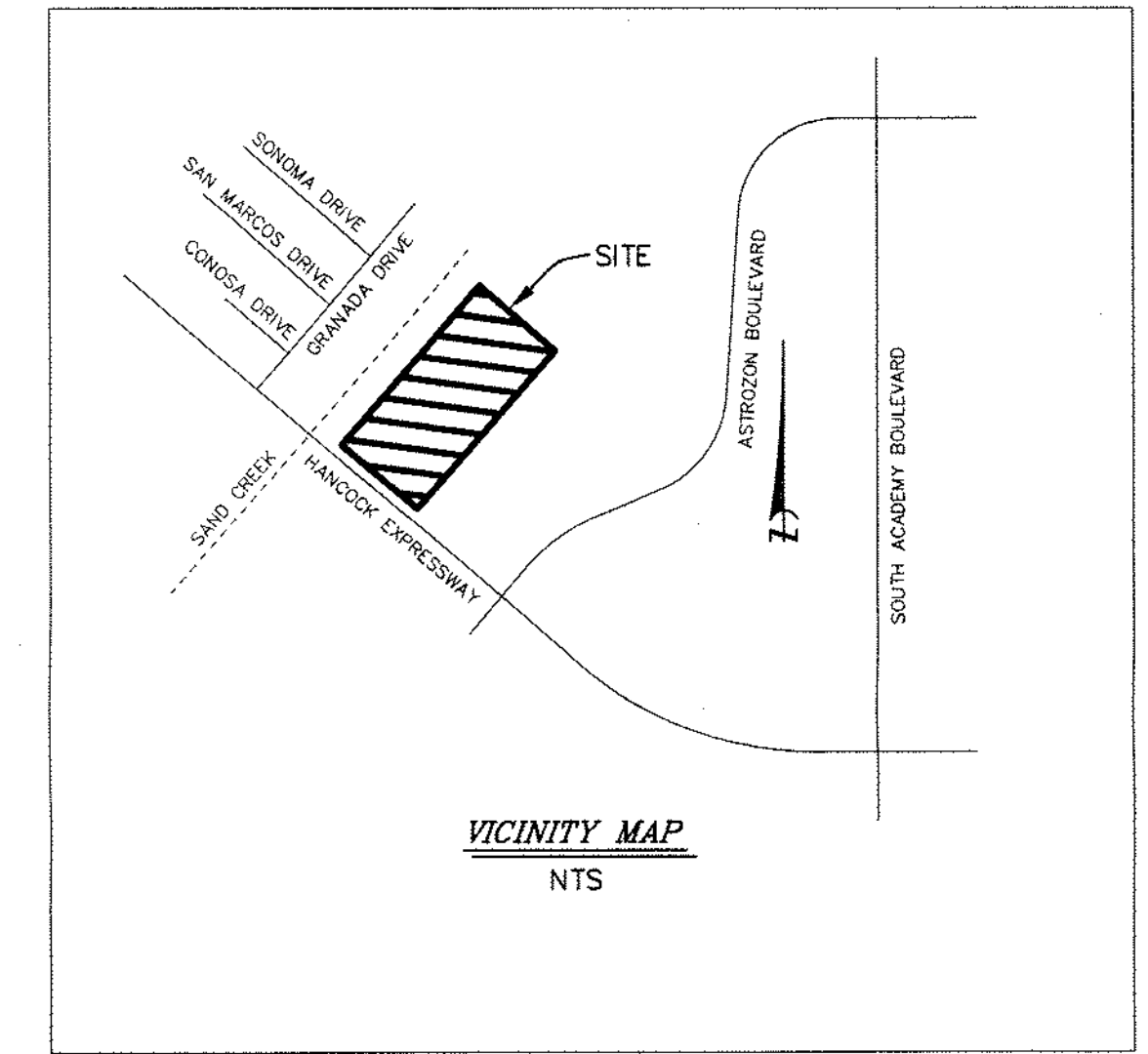

KEY:
 5884.0 TOW
 5884.0 BOW
 TOP OF PROPOSED RETAINING WALL ELEVATION
 BOTTOM OF PROPOSED RETAINING WALL ELEVATION

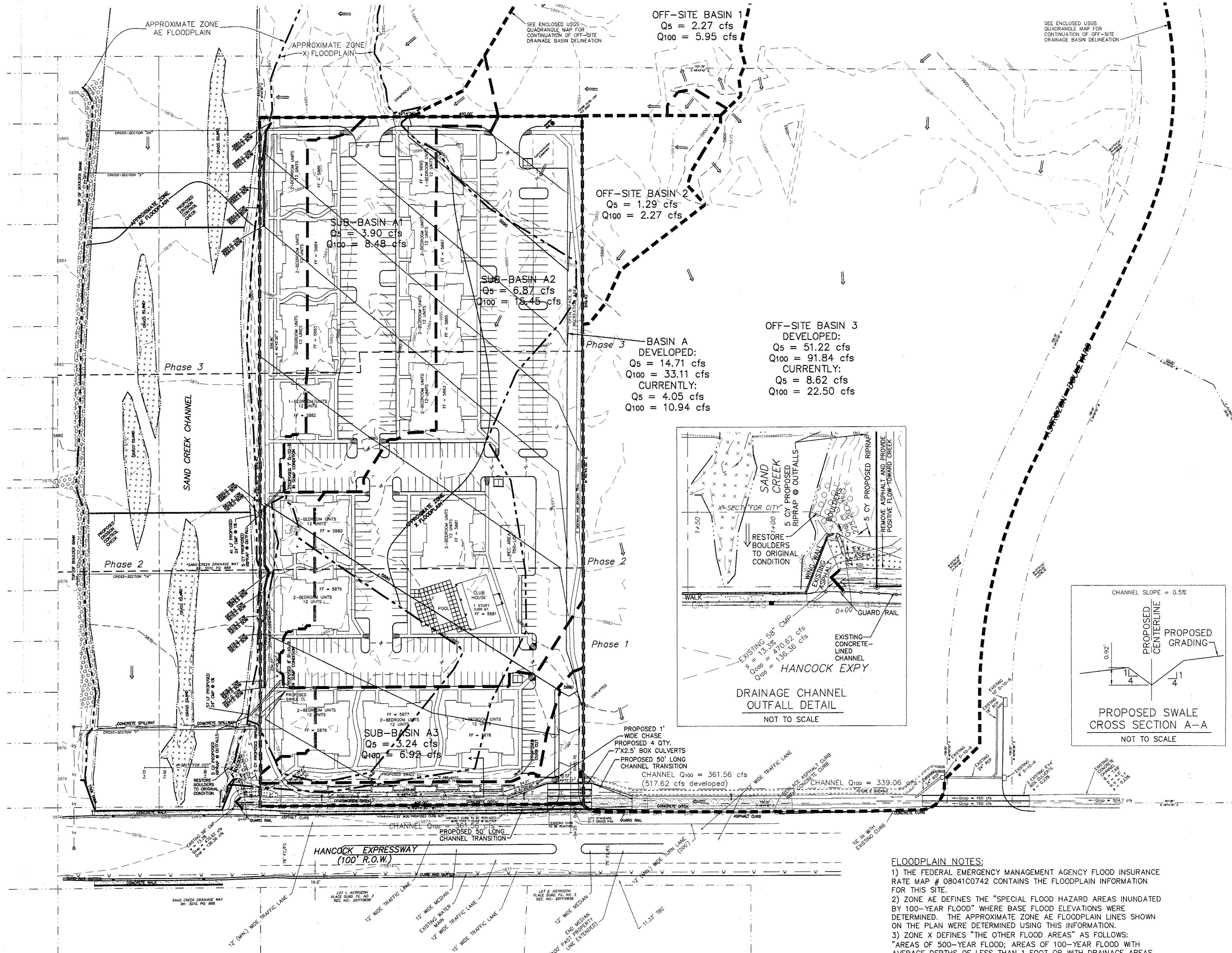
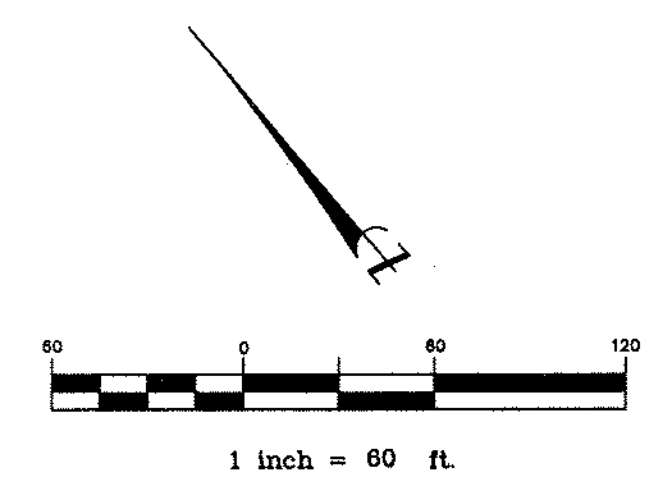

DRAINAGE PLAN LEGEND:

- DRAINAGE BASIN BOUNDARY
- DRAINAGE SUB-BASIN BOUNDARY
- FLOODPLAIN BOUNDARY
- ADJACENT PROPERTY BOUNDARY
- EXISTING CONTOUR
- EXISTING CONTOUR INDEX
- PROPOSED CONTOUR
- DRAINAGE FLOW DIRECTION
- REMOVE ASPHALT AND PROVIDE POSITIVE FLOW TOWARD CREEK

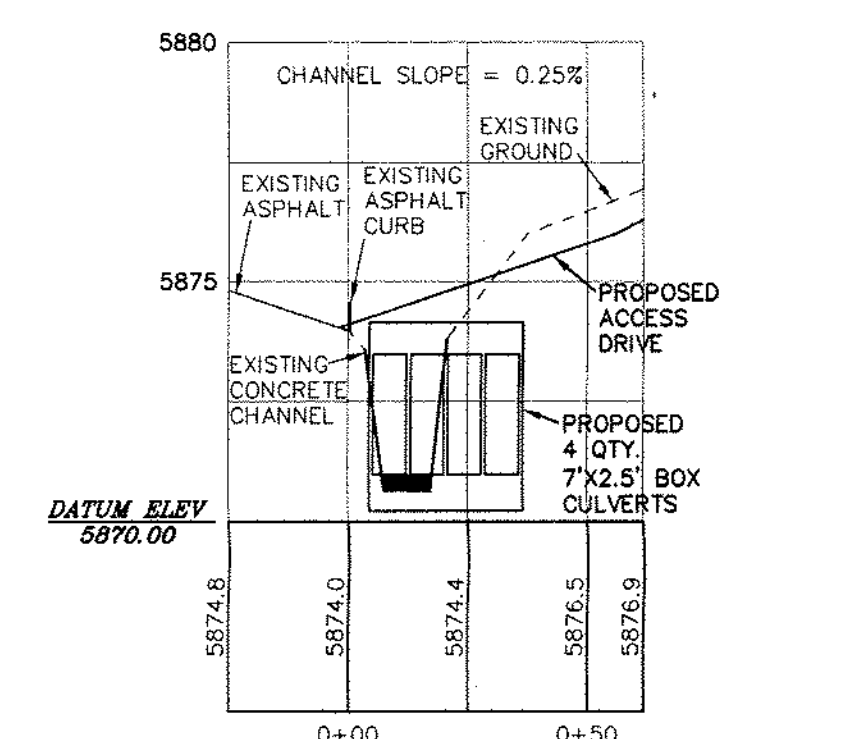
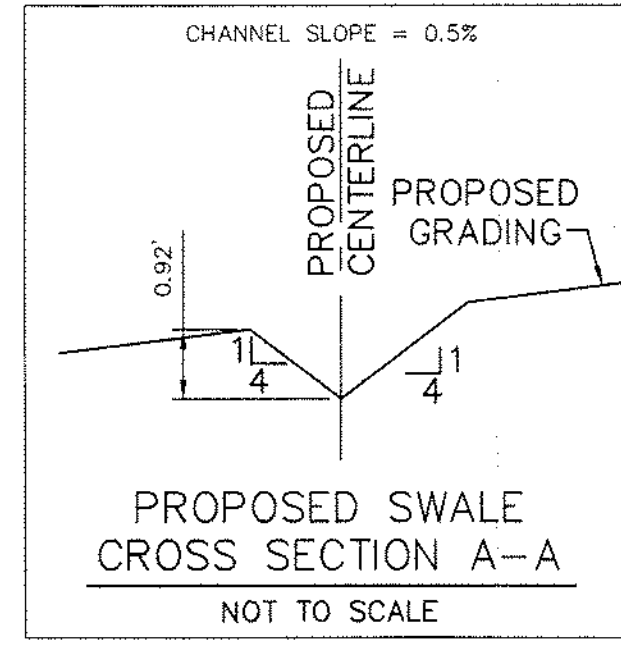
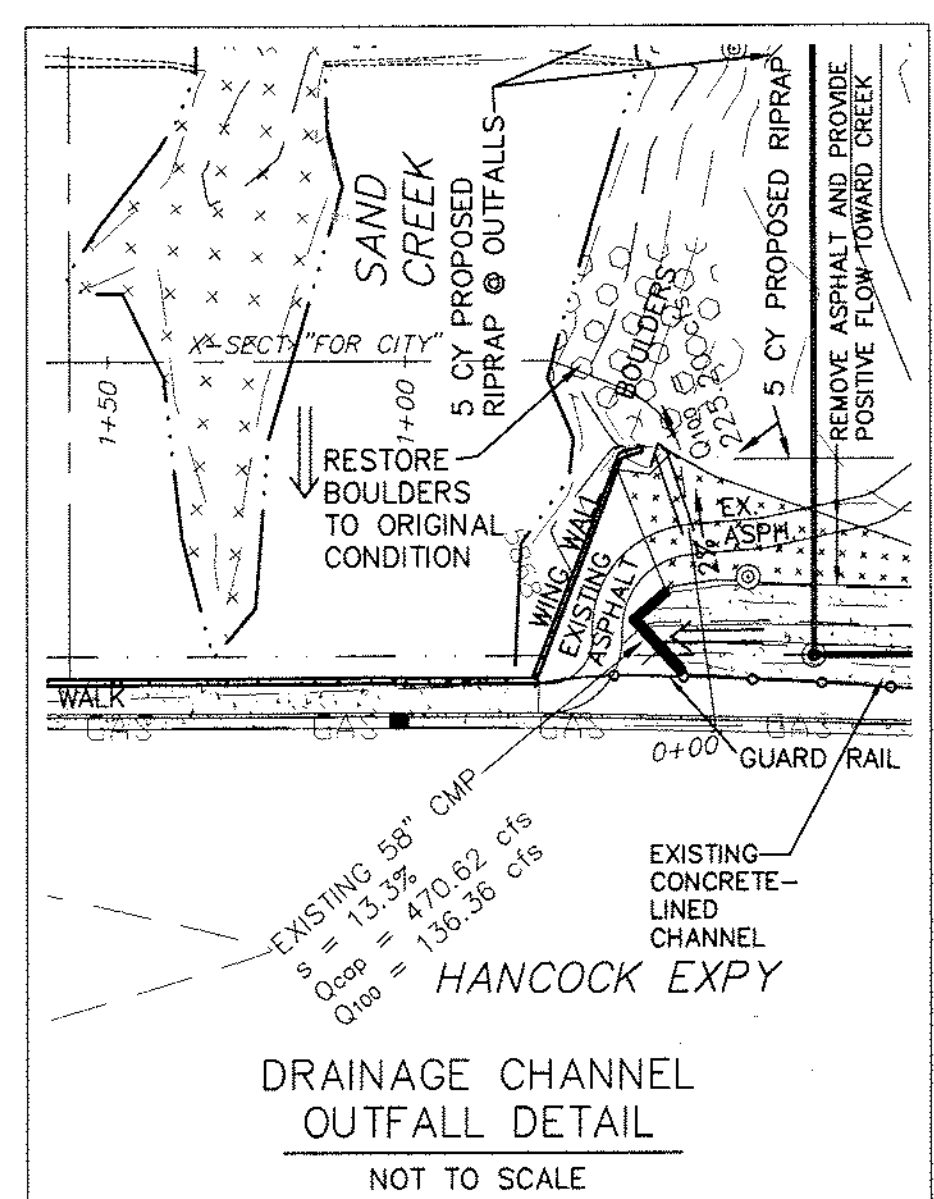

FLOODPLAIN NOTES:

- THE FEDERAL EMERGENCY MANAGEMENT AGENCY FLOOD INSURANCE RATE MAP # 08041C0742 CONTAINS THE FLOODPLAIN INFORMATION FOR THIS SITE.
- ZONE AE DEFINES THE "SPECIAL FLOOD HAZARD AREAS INUNDED BY 100-YEAR FLOOD" WHERE BASE FLOOD ELEVATIONS WERE DETERMINED. THE APPROXIMATE ZONE AE FLOODPLAIN LINES SHOWN ON THE PLAN WERE DETERMINED USING THIS INFORMATION.
- ZONE X DEFINES "THE OTHER FLOOD AREAS" AS FOLLOWS:
 "AREAS OF 500-YEAR FLOOD; AREAS OF 100-YEAR FLOOD WITH AVERAGE DEPTHS OF LESS THAN 1 FOOT OR WITH DRAINAGE AREAS LESS THAN 1 SQUARE MILE; AND AREAS PROTECTED BY LEVEES FROM 100-YEAR FLOOD."

REVISED: 01/14/03
 REVISED: 12/23/02
 REVISED: 11/05/02 GRADES
 REVISED: 09/18/02
 REVISED: 06/18/02

| | | |
|-----------------|---------------------|---|
| DRAWN BY: ACS | DATE: 4/25/02 | berge-brewer & associates, inc. 711 north cascade avenue colorado springs, colorado (719) 227-7181 |
| CHECKED BY: RGB | DRAWING NO.: A-3306 | |
| JOB NO.: 010367 | SHEET 1 OF 1 | |
| | | ENGINEERS PLANNERS SURVEYORS |