

# BLACK SQUIRREL BUSINESS PARK

CITY OF COLORADO SPRINGS, COUNTY OF EL PASO, STATE OF COLORADO

## MASTER DEVELOPMENT DRAINAGE PLAN

HISTORIC CONDITIONS  
APRIL 2001

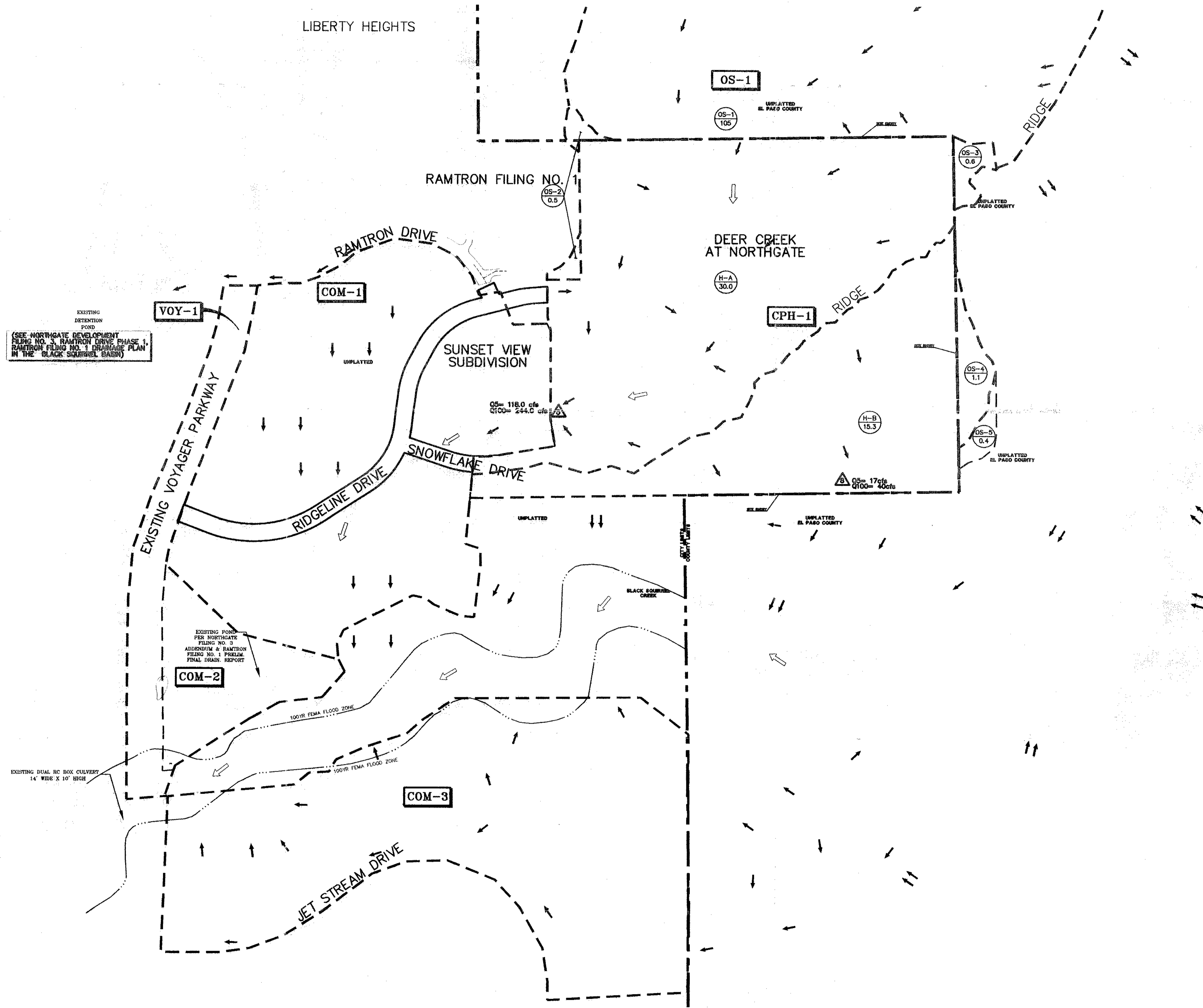

**DEER CREEK AT NORTHGATE**

BASIN SUMMARY			
BASIN	TOTAL AREA	Q5 (CFS)	Q100 (CFS)
H-A	10.2	24.0	58.0
H-B	4.4	15.0	36.0
OS-1*	105	**93.0	185.0
OS-2	0.5	1.0	1.0
OS-3	0.6	1.0	1.0
OS-4	1.1	1.0	2.0
OS-5	0.4	1.0	1.0

\* PER BLACK SQUIRREL CREEK DRAINAGE BASIN PLANNING STUDY BY URS, DATED JANUARY 1989.

\*\* REPRESENTS Q10

SCS BASIN SUMMARY-HISTORIC COND.			
BASIN	TOTAL AREA	Q10 (CFS)	Q100 (CFS)
VOY-1	5.8	3.6	10.1
COM-1	33.1	26.1	71.4
COM-2	5.7	3.3	9.3
COM-3	29	15	43.3
CPH-1	33.8	19.3	55
OS-1	105	65.3	185

TOTAL HISTORIC COMBINED FLOW	
EVENT	FLOW (CFS)
Q <sub>2</sub>	27
Q <sub>5</sub>	79
Q <sub>10</sub>	123
Q <sub>50</sub>	259
Q <sub>100</sub>	355

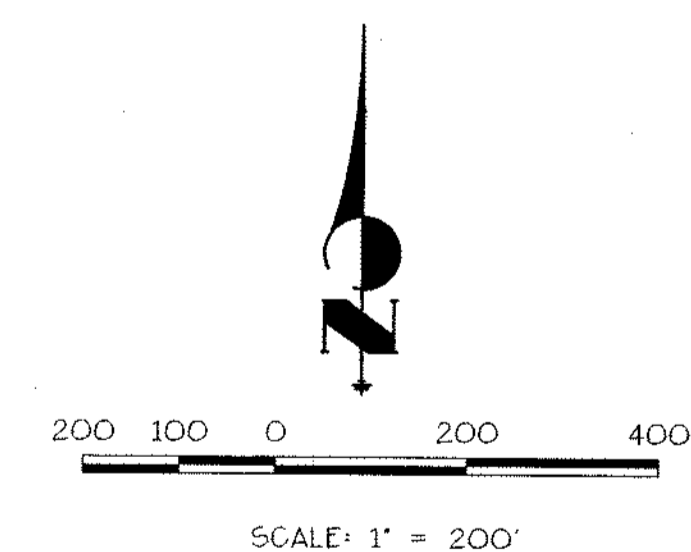

LEGEND	SYMBOL
EXISTING GROUND CONTOUR	6910
BASIN BOUNDARY	---
DESIGN POINT	△
BASIN IDENTIFIER	OS-2
AREA IN ACRES	0.5
DIRECTION OF FLOW	←

UNTIL SUCH TIME AS THESE DRAWINGS ARE APPROVED BY THE APPROPRIATE REVIEWING AGENCIES, JR ENGINEERING APPROVES THEIR USE ONLY FOR THE PURPOSES DESIGNATED BY WRITTEN AUTHORIZATION.

PREPARED FOR  
**PICOLAN, INC.**  
ATTN: STEVE SHARKEY  
90 S. CASCADE AVE., STE. 1300  
COLORADO SPRINGS, CO 80903  
(719) 381-8441

**J-R ENGINEERING**  
A Subsidiary of Westcon  
430 ArrowsWest Drive • Colorado Springs, CO 80907  
719-593-2593 • Fax: 719-528-6683  
www.jrengineering.com

No.	BY	DATE	REVIEW
1	M/S	03/11/01	PER CITY REVIEW

H-SCALE	V-SCALE	DATE	DESIGNED BY	DRAWN BY	CHECKED BY
1" = 200'	N/A	2/27/01	SKC	MSD	

**BLACK SQUIRREL BUSINESS PARK**

MASTER DEVELOPMENT DRAINAGE PLAN

HISTORIC CONDITIONS

SHEET 1 OF 2

JOB NO. 8896.43

X:\2880000\_011\2889643\Drawings\88964301.dwg Tue Apr 24 15:17:36 2001 J-R Engineering