

# BLACK SQUIRREL BUSINESS PARK

CITY OF COLORADO SPRINGS, COUNTY OF EL PASO, STATE OF COLORADO

## MASTER DEVELOPMENT DRAINAGE PLAN

DEVELOPED CONDITIONS

APRIL 2001

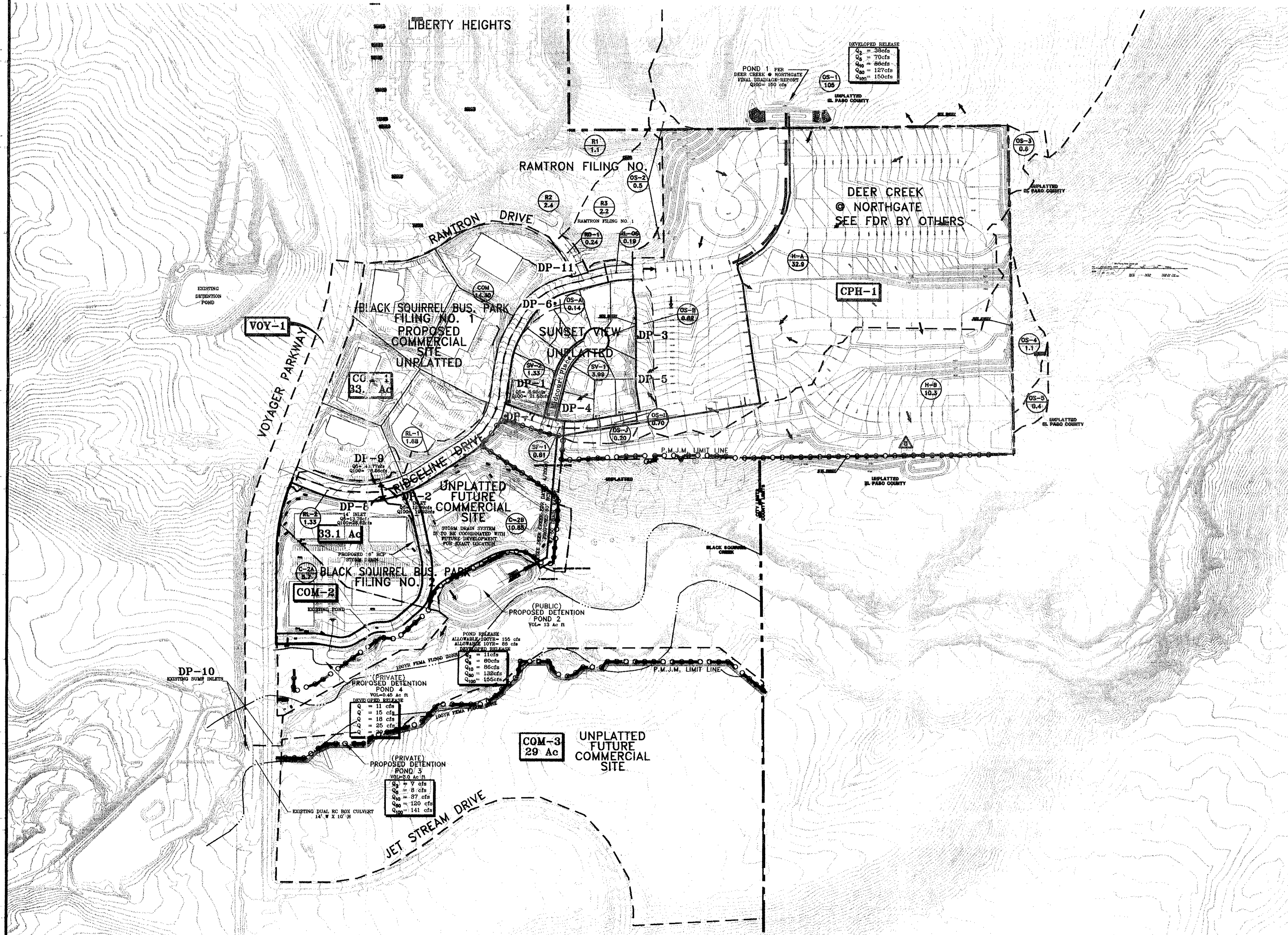

**SCS UNIT HYDROGRAPH SUMMARY**  
TOTAL COMBINED FLOW FROM POND 2, 3, 4 & VOY-1

EVENT	FLOW (cfs)
Q <sub>2</sub>	35
Q <sub>5</sub>	69
Q <sub>10</sub>	96
Q <sub>50</sub>	176
Q <sub>100</sub>	218

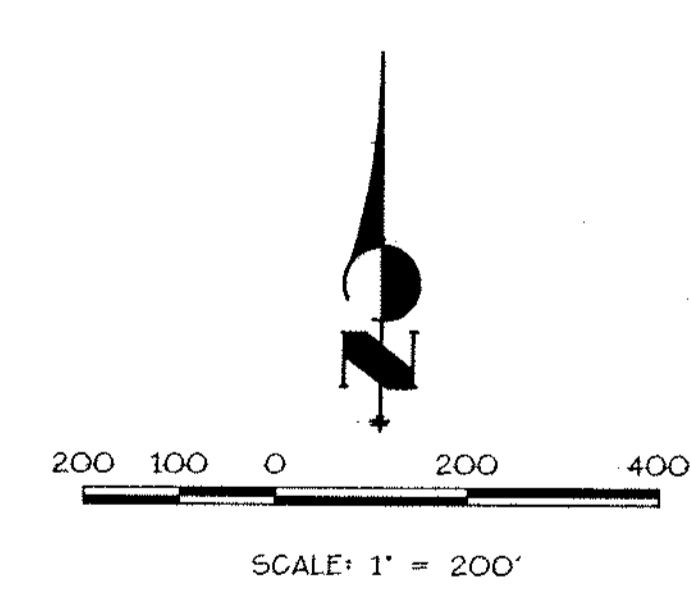

**LEGEND**

DESCRIPTION	SYMBOL
EXISTING GROUND CONTOUR	6910
BASIN BOUNDARY	---
DESIGN POINT	△ 8
BASIN IDENTIFIER	→ OS-2
AREA IN ACRES	→ (0.5)
DIRECTION OF FLOW	←

<p>UNPLATTED FUTURE COMMERCIAL SITE</p> <p>UNPLATTED FUTURE COMMERCIAL SITE</p> <p>UNPLATTED FUTURE COMMERCIAL SITE</p>	<p>LIBERTY HEIGHTS</p> <p>RAMTRON DRIVE</p> <p>VOYAGER PARKWAY</p> <p>MISELINE DRIVE</p> <p>JET STREAM DRIVE</p> <p>DEER CREEK @ NORTHGATE SEE FDR BY OTHERS</p> <p>CPH-1</p>	<p>DEVELOPED RELEASE</p> <p>Q<sub>2</sub> = 38cfs</p> <p>Q<sub>5</sub> = 70cfs</p> <p>Q<sub>10</sub> = 86cfs</p> <p>Q<sub>50</sub> = 127cfs</p> <p>Q<sub>100</sub> = 150cfs</p>
<p>BY DATE</p>		
<p>H-SCALE 1" = 200'</p> <p>V-SCALE N/A</p> <p>DATE 2/27/01</p> <p>DESIGNED BY SKC</p> <p>DRAWN BY MSD</p> <p>CHECKED BY</p>		
<p><b>BLACK SQUIRREL BUSINESS PARK</b></p> <p><b>MASTER DEVELOPMENT DRAINAGE PLAN</b></p> <p><b>DEVELOPED CONDITIONS</b></p>		
<p>SHEET 1 OF 1</p> <p>JOB NO. 8896.43</p>		
<p>PREPARED FOR: <b>PICOLAN, INC.</b> ATTN: STEVE SHARKEY 90 S. CASCADE AVE., STE 1300 COLORADO SPRINGS, CO 80903 (719) 381-8441</p> <p><b>JR ENGINEERING</b> A Subsidiary of Westcon 430 Arroyo West Drive • Colorado Springs, CO 80907 761-588-2888 • Fax: 761-588-8888 www.jrengineering.com</p>		

X:\2886000.dwg 11/28/00 08:11:28 AM 10/26/01 JRE Engineering