

PINE CREEK OUTFALL DRAINAGE BRIARGATE BUSINESS CAMPUS ALLOWABLE DEVELOPMENT LIMITS

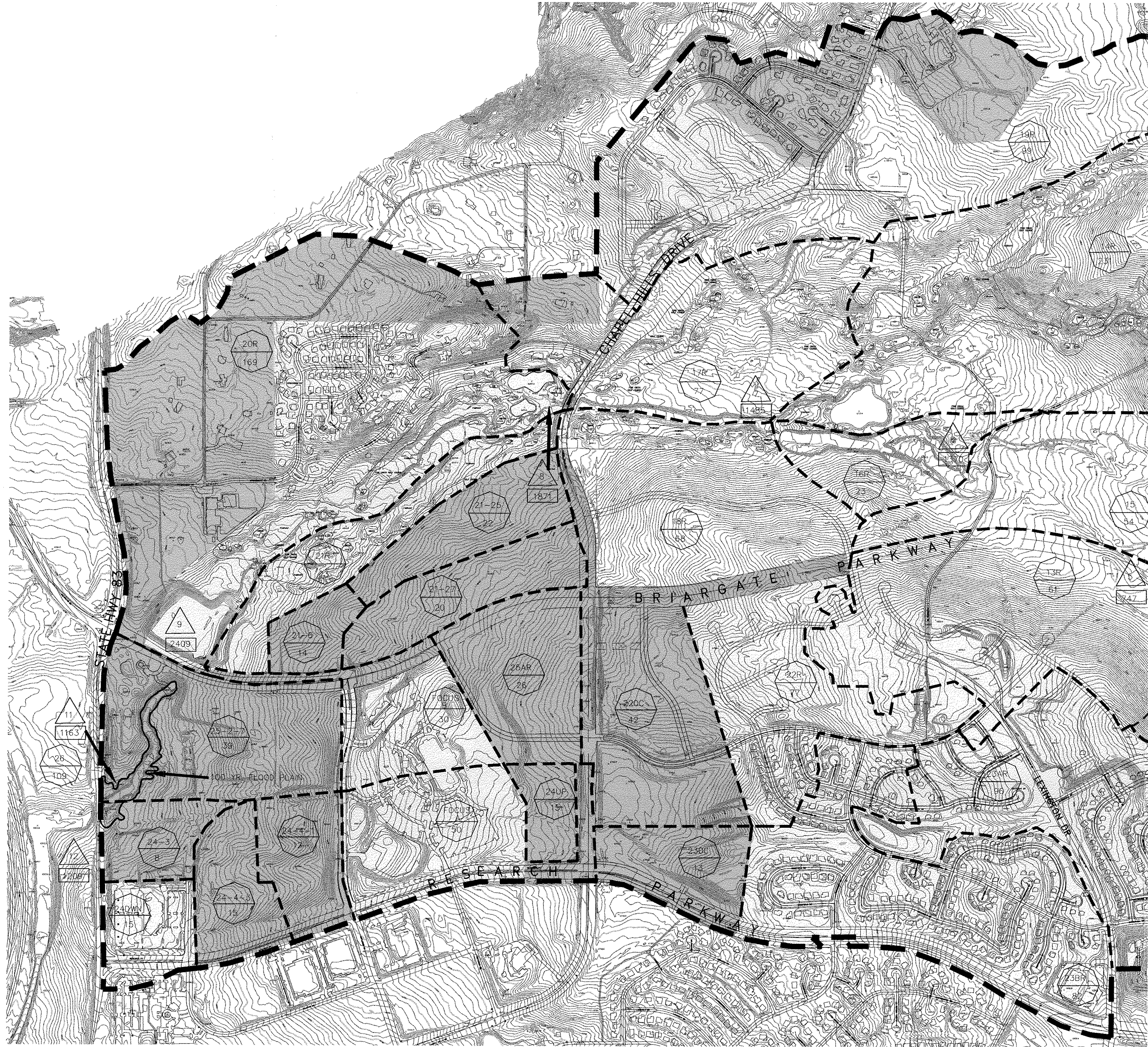

- ### LEGEND
- PINE CREEK DRAINAGE BASIN
 - SUB-BASIN BOUNDARY
 - SUMMARY POINT
 - 100 YR. FLOW AT SUMMARY PT.
 - BASIN IDENTIFICATION
 - BASIN ACRES
 - CURRENTLY DEVELOPED LAND
 - FUTURE DEVELOPMENT LIMITS
 - LAND OUTSIDE OF BRIARGATE

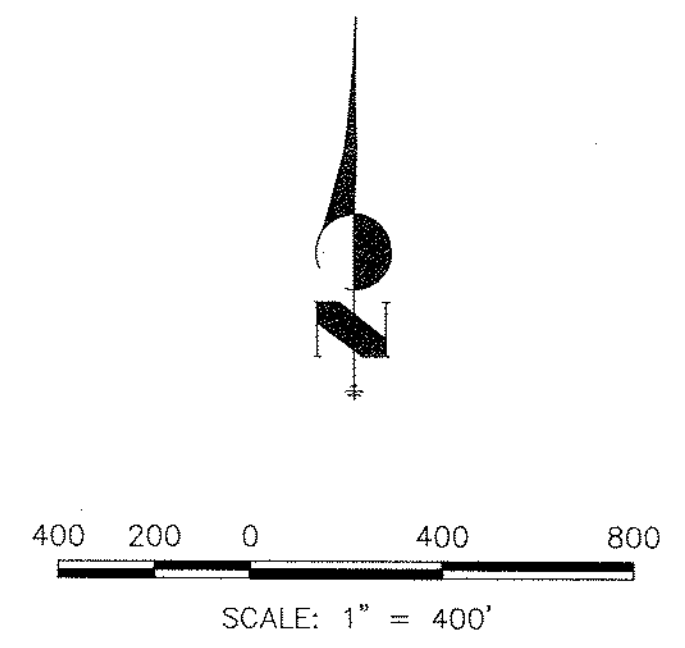

FILENAME: 871500R DATE: 8/7/98 XREFS: FMS-2A

<p>48 HOURS BEFORE YOU DIG, CALL UTILITY LOCATORS</p> <p>1-800-922-1987</p> <p><small>CITY OF COLORADO SPRINGS DEPT. OF UTILITIES GAS, ELECTRIC, WATER AND WASTE WATER</small></p>	UNTIL SUCH TIME AS THESE DRAWINGS ARE APPROVED BY THE APPROPRIATE REVIEWING AGENCIES, JR ENGINEERING, LTD. ASSUMES NO LIABILITY FOR THE PURPOSES DESIGNATED BY WRITTEN AUTHORIZATION.
	ENGINEERING, LTD. 4935 North 30th Street Colorado Springs, Colorado 80919 (719) 593-2583 • FAX (719) 528-6613
	JR
SCALE: 1"=400' DATE: 8/5/98 DES. BY: TAK CHK. BY: DWN. BY: MEM	NO.: BY: DATE REVISION:
BRIARGATE BUSINESS CAMPUS ALLOWABLE DEVELOPMENT LIMITS	SHEET 1 OF 1 JOB NO. 8715.10