

NOTE:
TOPOGRAPHY SHOWN DOES NOT REFLECT
CONSTRUCTION OF ACADEMY BLVD. / HIGHWAY IIS
INTERCHANGE

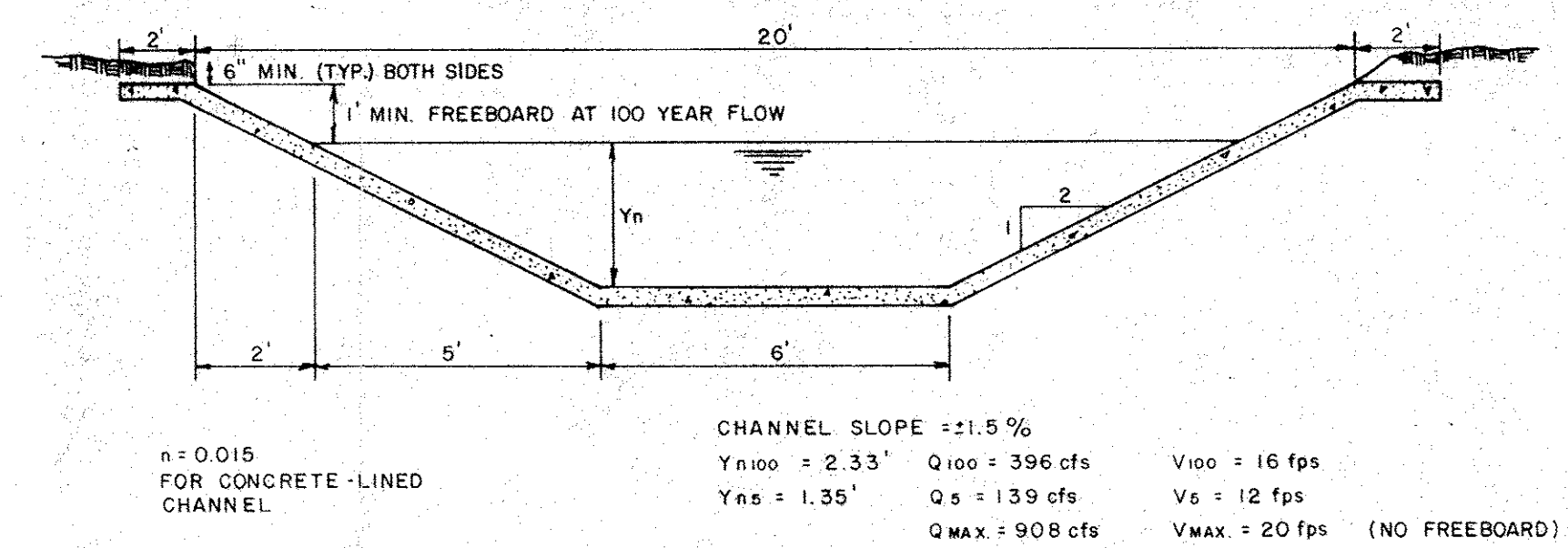

SCALE: 1" = 400'

NOTE: GATES LAND COMPANY SHALL CONSTRUCT AND MAINTAIN A SWALE TO CARRY THE FLOW TO CHEYENNE MEADOWS DRAINAGE CHANNEL UNTIL SUCH TIME AS PUBLIC IMPROVEMENTS HAVE BEEN CONSTRUCTED.

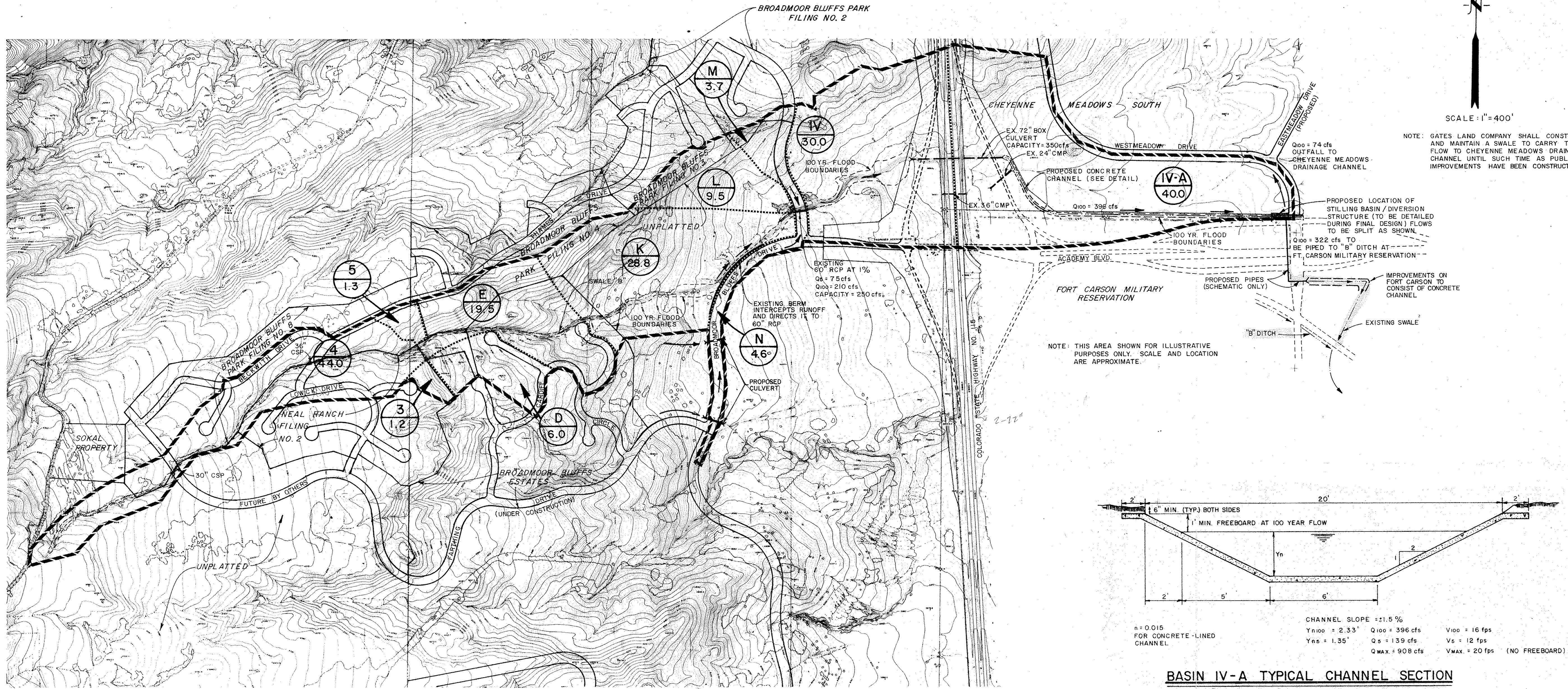

n = 0.015 FOR CONCRETE-LINED CHANNEL
CHANNEL SLOPE = 21.5%
Y₁₀₀ = 2.33' Q₁₀₀ = 396 cfs V₁₀₀ = 16 fps
Y₅₀ = 1.35' Q₅₀ = 139 cfs V₅₀ = 12 fps
Q_{MAX} = 908 cfs V_{MAX} = 20 fps (NO FREEBOARD)

BASIN IV-A TYPICAL CHANNEL SECTION

(PROPOSED)

NOTE: CONCRETE CHANNEL IS OUTSIDE OF CDH R.O.W.
GRASS CHANNEL IS PROPOSED WITHIN CDH R.O.W.

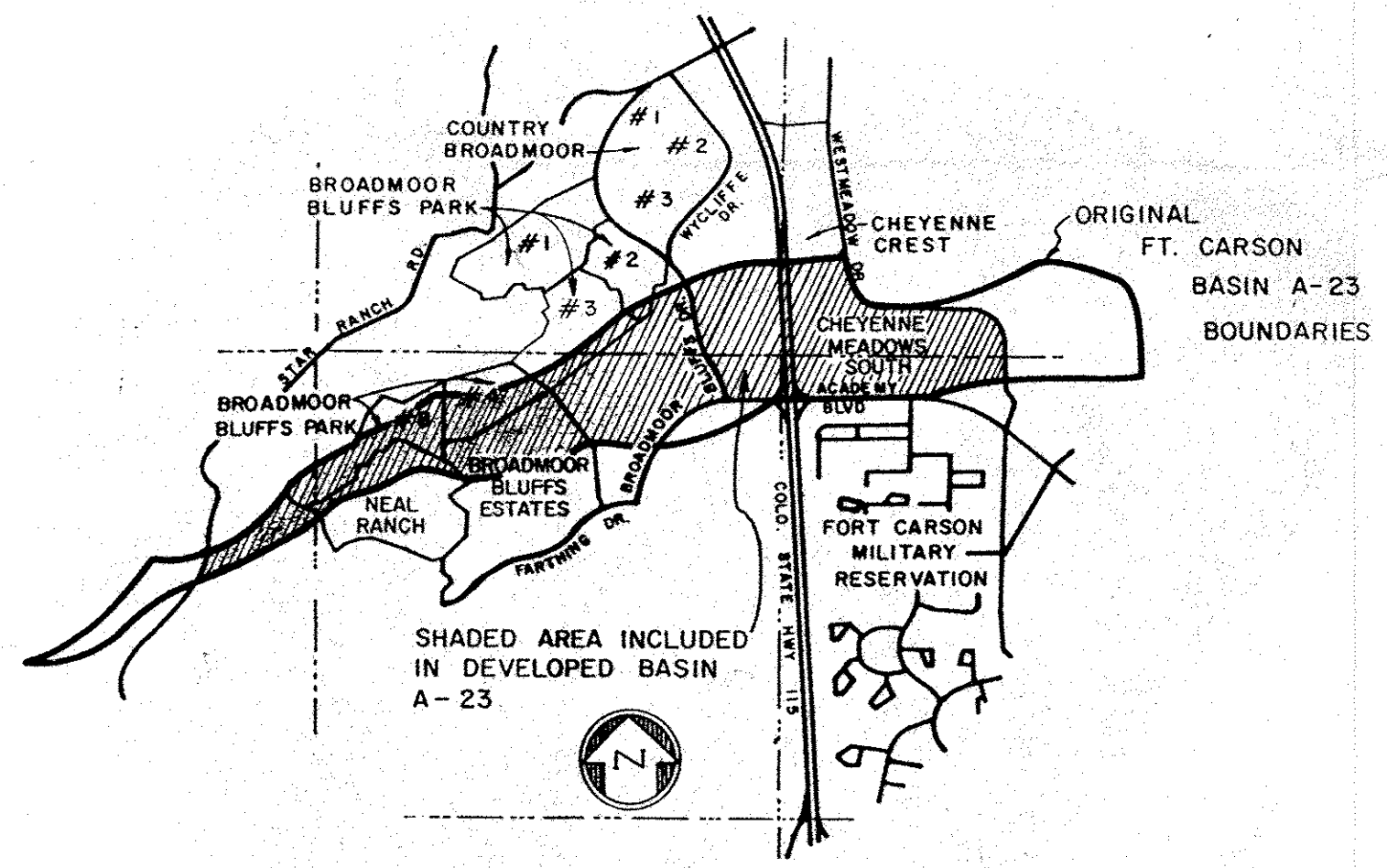

VICINITY MAP
SCALE: 1" = 2000'

LEGEND

- IV-A
40.0 SUB-BASIN DESIGNATION AREA IN ACRES
- 100 YEAR FLOOD PLAIN BOUNDARY
- BASIN A-23 BOUNDARY
- SUB-BASIN BOUNDARY
- DIRECTION OF FLOW

These detailed plans and specifications were prepared under my direction and supervision. Said detailed plans and specifications have been prepared according to the criteria established by the City for detailed drainage plans and specifications, and said detailed plans and specifications are in conformity with the master plan of the drainage basin. Said detailed drainage plans and specifications meet the purposes for which the particular drainage facility is designed. I accept responsibility for any errors or omissions in the preparation of the detailed drainage plans and specifications.

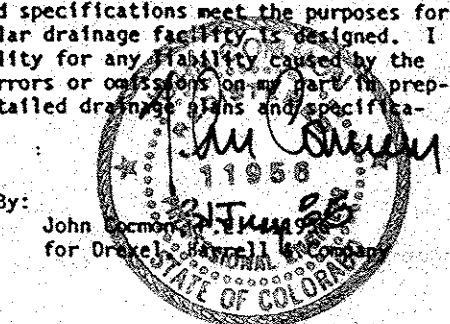

**MASTER DRAINAGE PLAN
BASIN A-23
CHEYENNE MOUNTAIN RANCH
COLORADO SPRINGS, COLORADO
FOR: GATES LAND CO.**

DREXEL, BARRELL & CO.			
1700 30TH STREET 3405 N. EL PASO STREET		BOULDER, COLORADO 80501 COLORADO SPRINGS, COLORADO 80907	
ENGINEERS — SURVEYORS		(303) 442-4314 (303) 631-9029	
Date	1 AUG 85	Designed by	CS E-2528
Scale	1" = 400'	Drawn by	DFW
Revisions - Date		Drawing No.	3D 544

CHK: 30 JULY 1985 RDB III