

DRAINAGE BASIN DATA

BASIN NO. (BASIN A)	BASIN NO.	ACRES	Q ₁₀	Q ₁₀₀
1A-1	11.2	27	56	
1A-2	21.6	44	49	
1A-3	19.4	31	55	
1A-4	24.6	54	60	DESIGN RATE
DP-2A (POND OUTFALL)	40.5	145	225	

BASIN NO. B (BASIN B)	BASIN NO.	ACRES	Q ₁₀	Q ₁₀₀
1B-1	13.0	21	38	
1B-2	6.3	9	17	
1B-3	24.9	46	63	
1B-4	1.7	3	6	
1B-5	7.5	14	26	
1B-6	2.2	5	9	
1B-7	4.9	11	19	
1B-8	2.4	5	10	
1B-9	1.9	4	7	
1B-10	11.6	23	41	
DP-6 (CREEK OUTFALL)	60.0	118	215	

BASIN NO. C (BASIN C)	BASIN NO.	ACRES	Q ₁₀	Q ₁₀₀
1C-1	158.6	107	191	
1C-2	23.1	66	116	
DP-1 (POND OUTFALL)	41.4	147	257	

- LEGEND**
- PROPOSED DESIGN BOUNDARY
 - BASIN DESIGNATION
 - AREA IN ACRES
 - SUBDIVISION BOUNDARY
 - AREA IN ACRES
 - DESIGN POINT
 - MAJOR BASIN BOUNDARY
 - SUB-BASIN BOUNDARY
 - PROPOSED SUBDIVISION BOUNDARY
- LAND USE DESIGNATIONS:**
- L - RESIDENTIAL LOW
 - LM - RESIDENTIAL LOW-MEDIUM
 - M - RESIDENTIAL MEDIUM
 - MH - RESIDENTIAL MEDIUM-HIGH
 - C - COMMERCIAL/VILLAGE CENTER
 - OP - OFFICE PARK/INDUSTRIAL

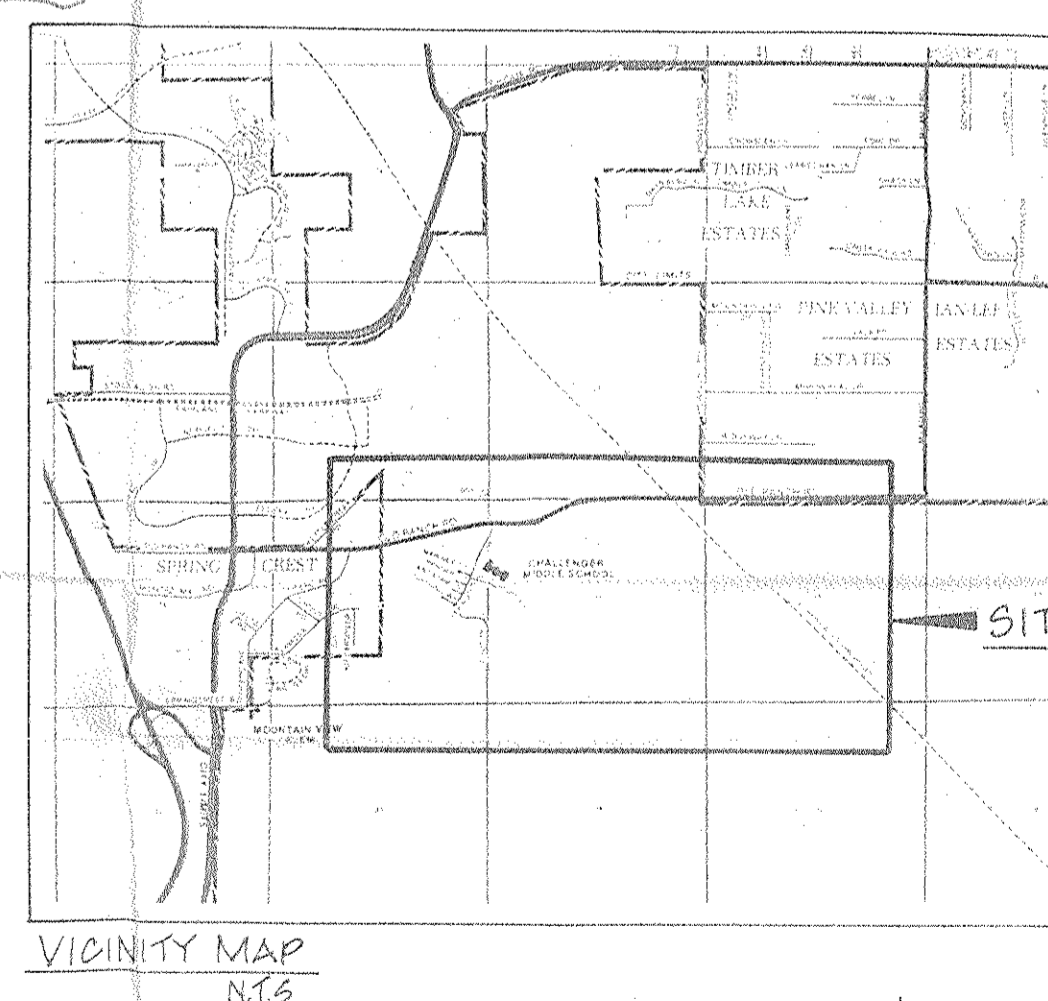

DATE: 11/24/92
 CHECK BY: [Signature]
 SCALE: 1" = 200'
 SHEET: 5 of 11
 PROJECT: MASTER DEVELOPMENT PLAN FOR CHARLES GREENS
 ENGINEER: J.R. ENGINEERING, L.P.
 6455 N. UNION BLVD. 5
 COLORADO SPRINGS, CO. 80920