

VICINITY MAP:  
N.T.S.

SUB-BASIN DATA SUMMARY  
EXISTING CONDITIONS

BASIN ID	AREA (AC)	PEAK RUNOFF Q(5) (CFS)	PEAK RUNOFF Q(100) (CFS)
CE1	44.00	5.3	37.8
CE2	60.99	8.7	60.3
CE3	67.86	7.5	53.5
CE4	26.96	4.2	28.8
A1	116.50	13.5	96.3
A2	70.40	9.5	67.6
A3	84.50	11.8	82.8
PE1	32.97	4.3	30.5
PE2	110.91	13.8	98.5
PE3	99.00	9.0	63.4
PE4	139.46	14.4	102.5
PE5	111.99	15.8	110.7
PE6	123.76	24.1	151.0
PE7	134.33	14.5	103.4
PE8	73.16	8.6	61.3

SUB-BASIN DATA SUMMARY  
EXISTING CONDITIONS

DESIGN POINT	PEAK RUNOFF Q(5) (CFS)	PEAK RUNOFF Q(100) (CFS)
C1	9.8	85.5
C2	16.2	138.0
C3	42.0	362.9
DPA	27.4	225.6
P1	13.9	119.0
P2	34.9	291.0
P3	9.0	63.4
P4	38.0	244.9
P5	45.7	304.2

- LEGEND**
- FILING LIMITS
  - - - DRAINAGE BASIN BOUNDARY
  - 6520 --- PROPOSED CONTOUR
  - 6520 --- EXISTING CONTOUR
  - PROPOSED STORM DRAIN PIPE
  - EXISTING STORM DRAIN PIPE
  - DRAINAGE CHANNEL
  - PROPOSED TYPE "R" INLET
  - PROPOSED TYPE I OR II MANHOLE
  - PROPOSED FLOW DIRECTION ARROW
  - DP --- DESIGN POINT
  - 0.0 --- 5-YEAR STORM EVENT PEAK FLOW (CFS)
  - 0.0 --- 100-YEAR STORM EVENT PEAK FLOW (CFS)
  - C-13 --- BASIN DESIGNATION
  - 84.5 --- "C" COEFFICIENT (100 YR)
  - BASIN AREA (ACRES)

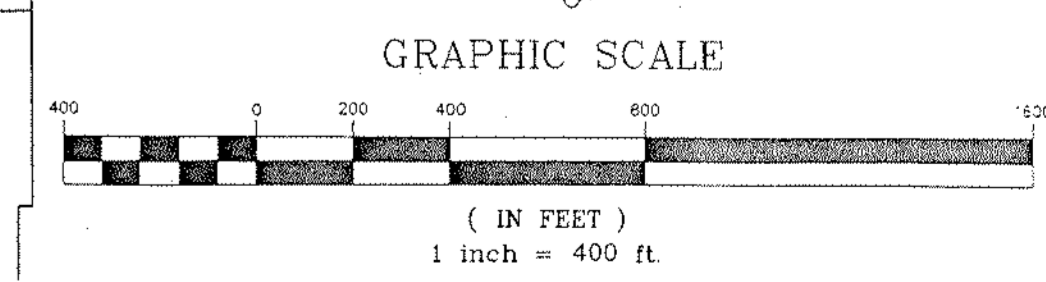
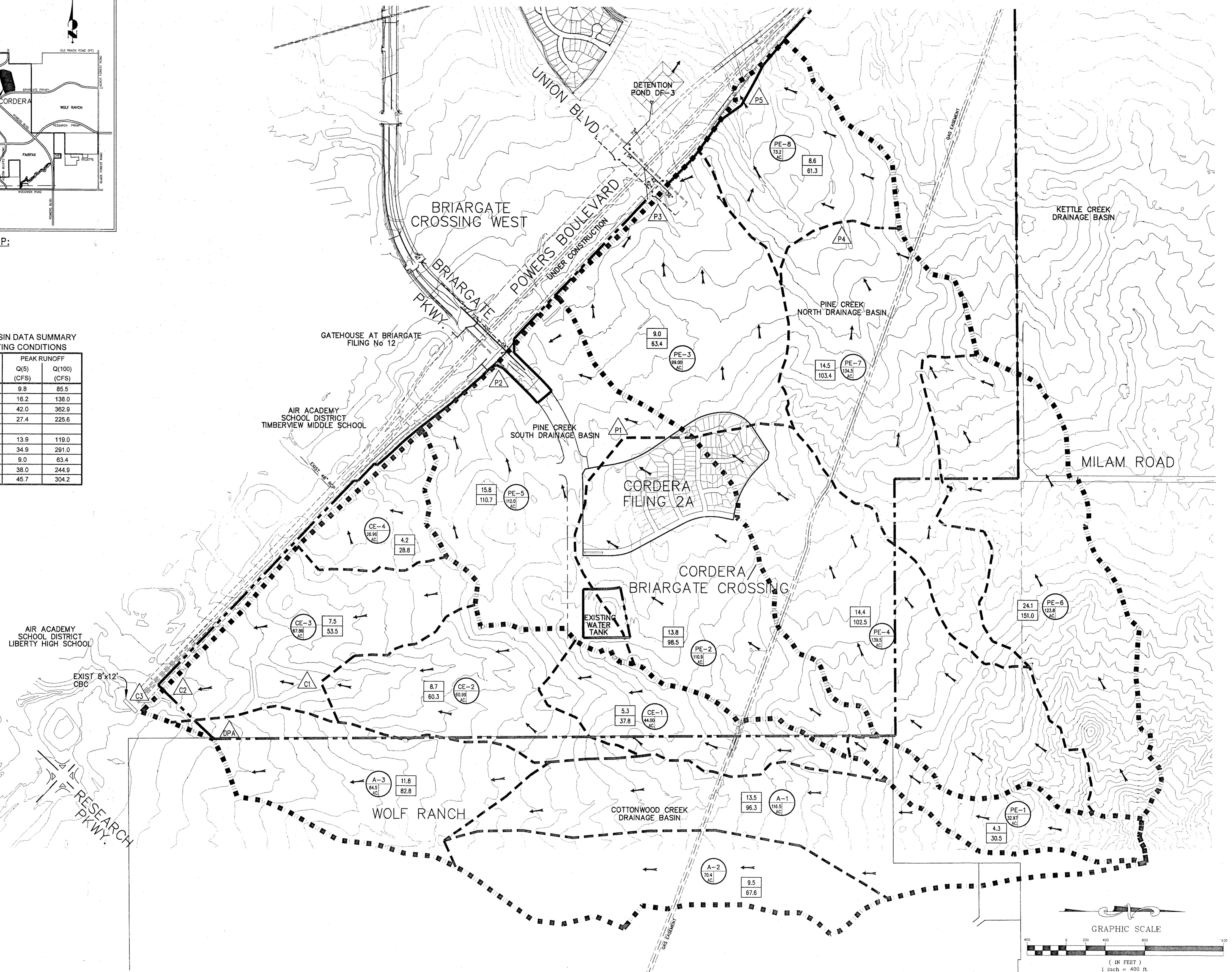

NO.	DATE	DESCRIPTION	BY
REVISIONS			
BENCHMARK DATA(ELEV.)			6975.68
(DATUM) ASSUMED			
(DESCRIPTION/LOCATION) OF BRIARGATE PKWY AND BRAINARD DR			

NAME: S:\04.104.022\DRAINAGE\DP01ex.dwg  
 PGP: Matrix.ctb  
 PLOT DATE: Mar 30, 2006 3:10pm

FOR AND ON BEHALF OF  
MATRIX DESIGN GROUP, INC.

**Matrix Design Group, Inc.**  
 Integrated Design Solutions 2925 Professional Place, Suite 202  
 Colorado Springs, CO 80904  
 Phone 719-575-0100  
 Fax 719-575-0208

**CORDERA FILING NO. 2A**  
**DRAINAGE REPORT**  
**HISTORIC CONDITIONS DRAINAGE MAP**

DESIGNED BY: RGG SCALE: 1"=400'  
 DRAWN BY: BPK HORIZ: N/A  
 CHECKED BY: DATE ISSUED: NOVEMBER 2005  
 SHEET NO. 1 OF 3 SHEETS

DP01