

VICINITY MAP:
N.T.S.

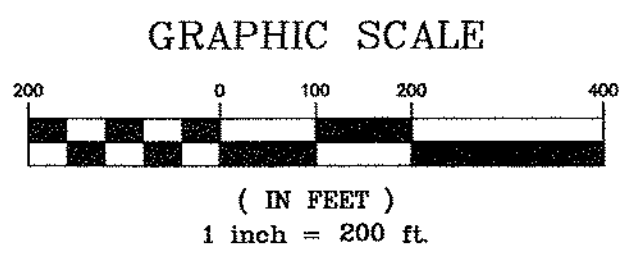
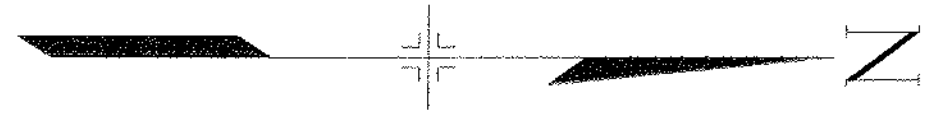

**SUB-BASIN DATA SUMMARY
DEVELOPED CONDITIONS**

BASIN ID	AREA (AC)	PEAK RUNOFF	
		Q(5) (CFS)	Q(100) (CFS)
CF1	30.73	26.3	78.3
CF2	32.28	25.7	77.8
CF3	14.57	13.2	39.0
CF4	12.17	4.6	19.8
CF5	11.13	9.6	28.6
CF6	16.02	29.2	64.0
CF7	23.97	39.7	88.7
CF8	30.25	54.4	119.7

**SUB-BASIN DATA SUMMARY
DEVELOPED CONDITIONS**

DESIGN POINT	PEAK RUNOFF	
	Q(5) (CFS)	Q(100) (CFS)
C1	51.6	155.8
C2	63.9	192.6
C3	68.1	212.1
C4	76.8	238.9
C5	98.7	290.9
C6	135.3	374.2
C8	183.3	487.0

DETENTION POND SUMMARY

WQ CAPTURE VOLUME	3.44 AC-FT
STORAGE VOLUME	15.30 AC-FT
Q(100) INFLOW	487.0 CFS
Q(100) OUTFLOW	128.2 CFS
Q(5) ELEVATION	6957.0 FT
Q(100) ELEVATION	6959.6 FT

- LEGEND**
- FILING LIMITS
 - DRAINAGE BASIN BOUNDARY
 - PROPOSED CONTOUR
 - EXISTING CONTOUR
 - PROPOSED STORM DRAIN PIPE
 - EXISTING STORM DRAIN PIPE
 - DRAINAGE CHANNEL
 - PROPOSED TYPE 'R' INLET
 - PROPOSED TYPE I OR II MANHOLE
 - PROPOSED FLOW DIRECTION ARROW
 - DESIGN POINT
 - BASIN DESIGNATION
 - BASIN AREA (ACRES)

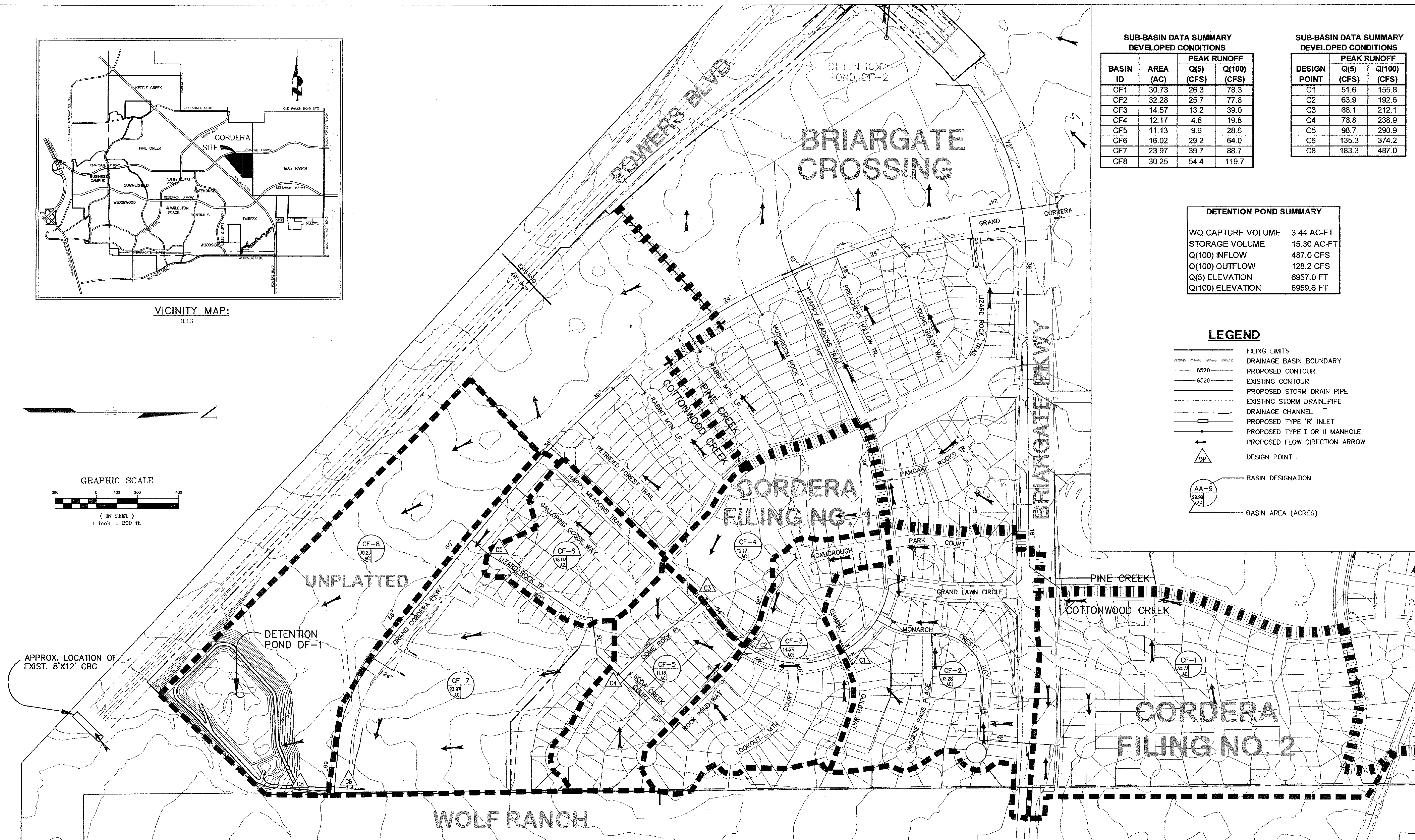

NO.	DATE	DESCRIPTION	BY
REVISIONS			
		BENCHMARK DATA(ELEV.)	6975.68
		(DATUM) ASSUMED	
		(DESCRIPTION/LOCATION) OF BRIARGATE PKWY AND BRAINARD DR	

NAME: S:\06.104.072\dwg\Drainage\DP01.dwg
 PCP: Matrix.ctb
 PLOT DATE: Mar 20, 2007 10:45am

THE NW SIDE OF FH #104 AT THE INT. OF BRIARGATE PKWY AND BRAINARD DR

FOR AND ON BEHALF OF
MATRIX DESIGN GROUP, INC.

Matrix Design Group, Inc.
 Integrated Design Solutions
 2435 Research Parkway, Suite 300
 Colorado Springs, CO 80920
 Phone 719-575-0100
 Fax 719-575-0208

DETENTION FACILITY 1
 DRAINAGE REPORT

FULLY DEVELOPED DRAINAGE MAP

DESIGNED BY:	ZDH	SCALE:	1"=200'	DATE ISSUED:	MAR 2007
DRAWN BY:	ZDH	HORIZ:	N/A	SHEET NO. 1 OF 1 SHEETS	
CHECKED BY:	ROG	VERT:	N/A		DP01