

# COTTONWOOD CREEK DRAINAGE PLAN THROUGH NOR'WOOD DEVELOPMENT

PREPARED FOR:  
NOR'WOOD DEVELOPMENT CORP.  
COLORADO SPRINGS, COLORADO

PREPARED BY:  
KLH ENGINEERING CONSULTANTS, INC.  
COLORADO SPRINGS, COLORADO

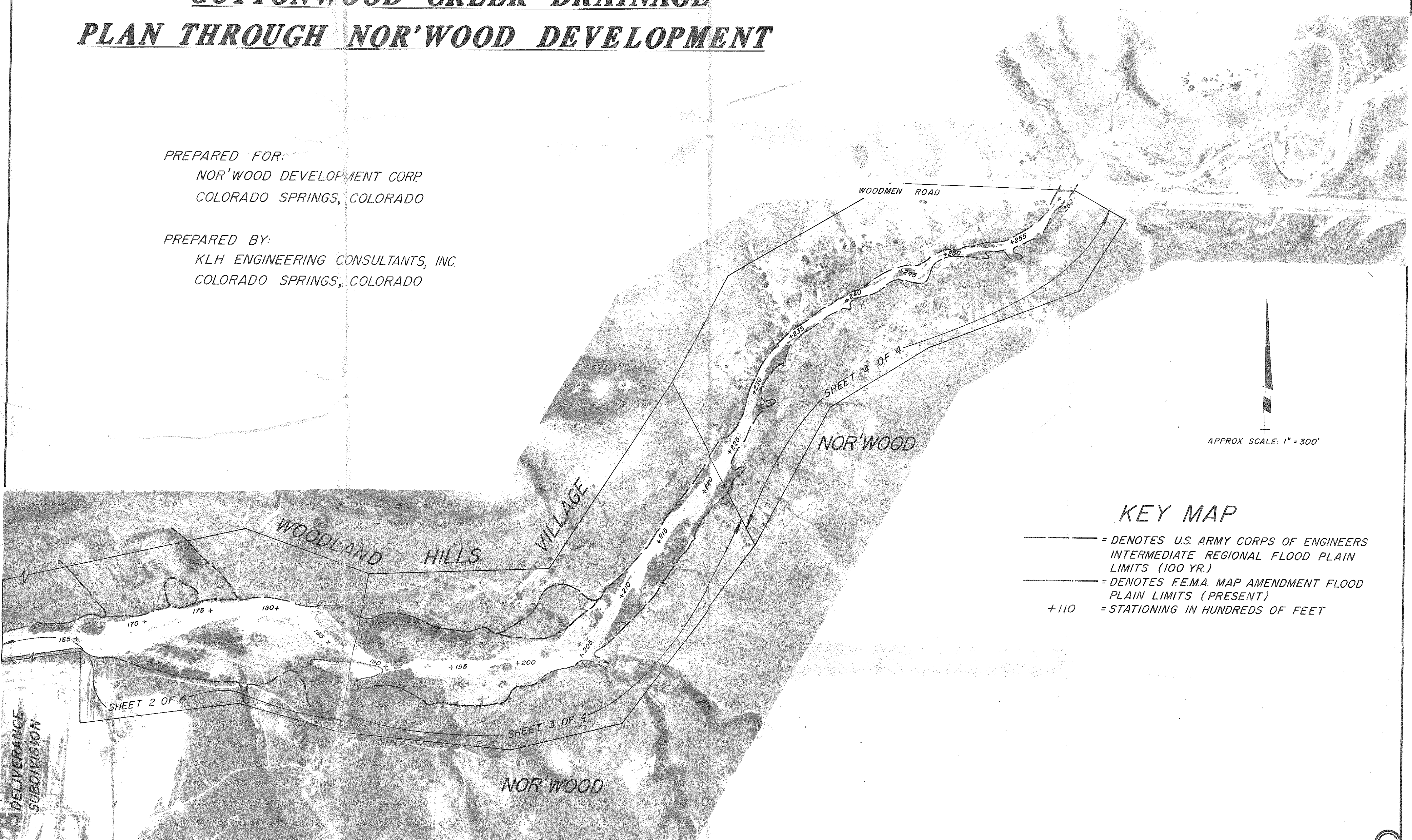

APPROX. SCALE: 1" = 300'

## KEY MAP

- = DENOTES U.S. ARMY CORPS OF ENGINEERS INTERMEDIATE REGIONAL FLOOD PLAIN LIMITS (100 YR.)
- = DENOTES F.E.M.A. MAP AMENDMENT FLOOD PLAIN LIMITS (PRESENT)
- +110 = STATIONING IN HUNDREDS OF FEET

DELIVERANCE SUBDIVISION

**MAINTENANCE RESPONSIBILITY**

ITEM NO.	IMPROVEMENT DESCRIPTION	PUBLIC OR PRIVATE *
1	Maintenance Road Crossing	Public
2	Exist. Conc. Lined Open Channel	Public
3	Exist. 30" R.C.P. Outfall	Public
4	Exist. 48" R.C.P. Outfall	Public
5	Exist. 48" R.C.P.	Public
6	Exist. Conc. Rect. Channel	Public
7	Phase I-A Rip-Rap and Levee	Public
8	Phase I-G Rip-Rap	Public
9	Phase I-C Rip-Rap	Public
10	Phase I-B Rip-Rap	Public
11	Proposed 24" R.C.P. Outfall	Public
12	Proposed 54" R.C.P. Outfall	Public
13	Dual 36" R.C.P. Culverts w/Flap Gates	Private

\* PRIVATE FACILITIES - denotes all facilities which shall be maintained by others (an entity other than the City of Colorado Springs Dept. of Public Works), including but not limited to ponds, pond outfall facilities, and other recreational structures.

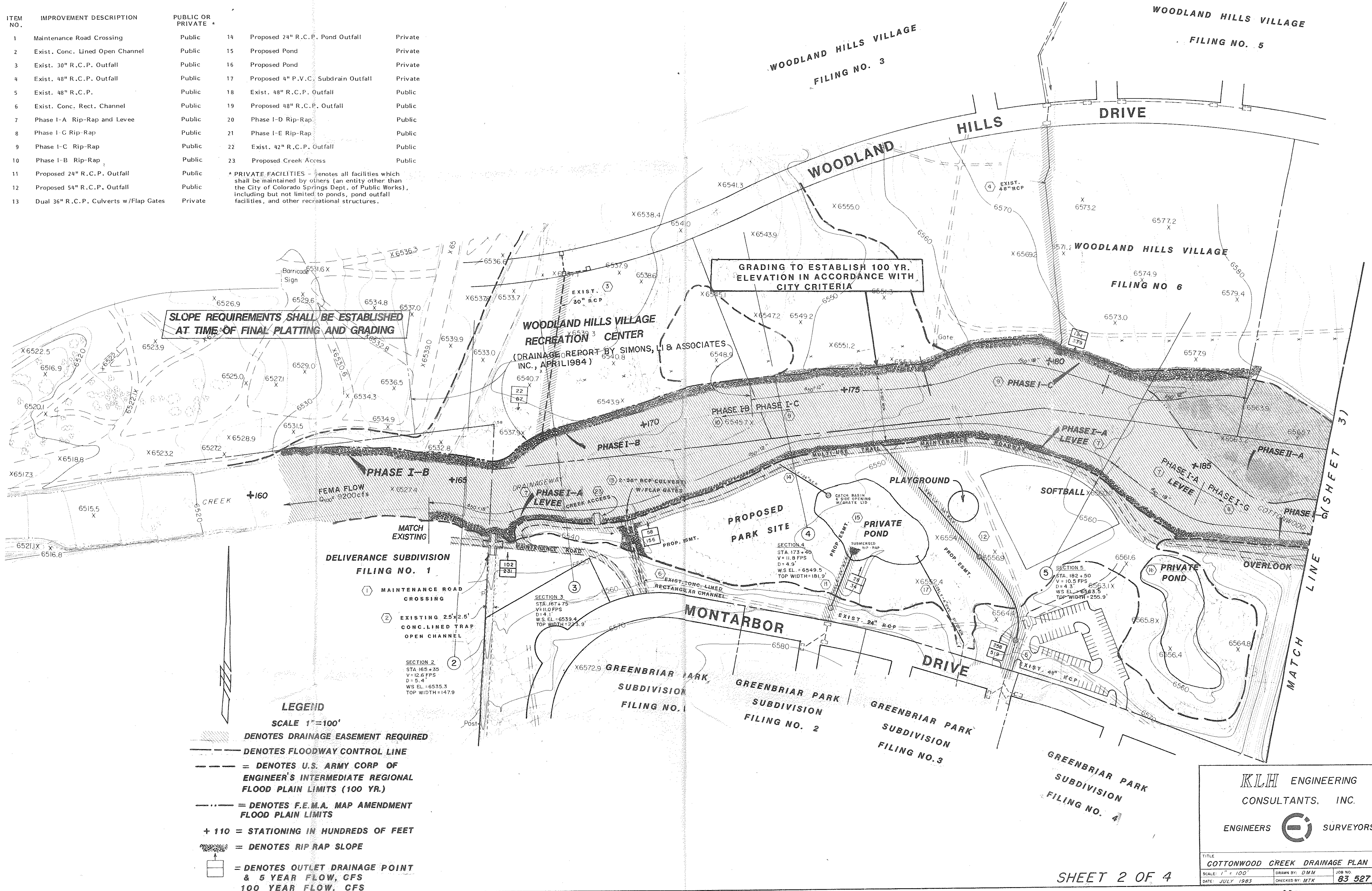

SLOPE REQUIREMENTS SHALL BE ESTABLISHED AT TIME OF FINAL PLATTING AND GRADING

GRADING TO ESTABLISH 100 YR. ELEVATION IN ACCORDANCE WITH CITY CRITERIA





- LEGEND**  
SCALE 1"=100'
- DENOTES DRAINAGE EASEMENT REQUIRED
  - - - DENOTES FLOODWAY CONTROL LINE
  - - - DENOTES U.S. ARMY CORP OF ENGINEER'S INTERMEDIATE REGIONAL FLOOD PLAIN LIMITS (100 YR.)
  - - - DENOTES F.E.M.A. MAP AMENDMENT FLOOD PLAIN LIMITS
  - + 110 = STATIONING IN HUNDREDS OF FEET
  - ▨ = DENOTES RIP RAP SLOPE
  - = DENOTES OUTLET DRAINAGE POINT & 5 YEAR FLOW, CFS 100 YEAR FLOW, CFS

**KLH ENGINEERING CONSULTANTS, INC.**  
ENGINEERS SURVEYORS

TITLE: COTTONWOOD CREEK DRAINAGE PLAN  
SCALE: 1" = 100' DRAWN BY: DMW JOB NO: 83 527 00  
DATE: JULY 1983 CHECKED BY: MTK

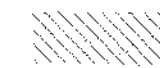
SCALE 1"=100'

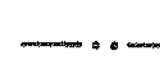
LEGEND

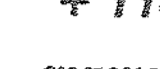
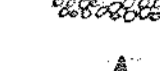
-  = DENOTES DRAINAGE EASEMENT REQUIRED
-  = DENOTES U.S. ARMY CORP OF ENGINEER'S INTERMEDIATE REGIONAL FLOOD PLAIN LIMITS (100 YR.)
-  = DENOTES F.E.M.A. MAP AMENDMENT FLOOD PLAIN LIMITS
-  + 110 = STATIONING IN HUNDREDS OF FEET
-  = DENOTES RIP RAP SLOPE
-  = DENOTES OUTLET DRAINAGE POINT & 5 YEAR FLOW, CFS
-  = DENOTES 100 YEAR FLOW, CFS

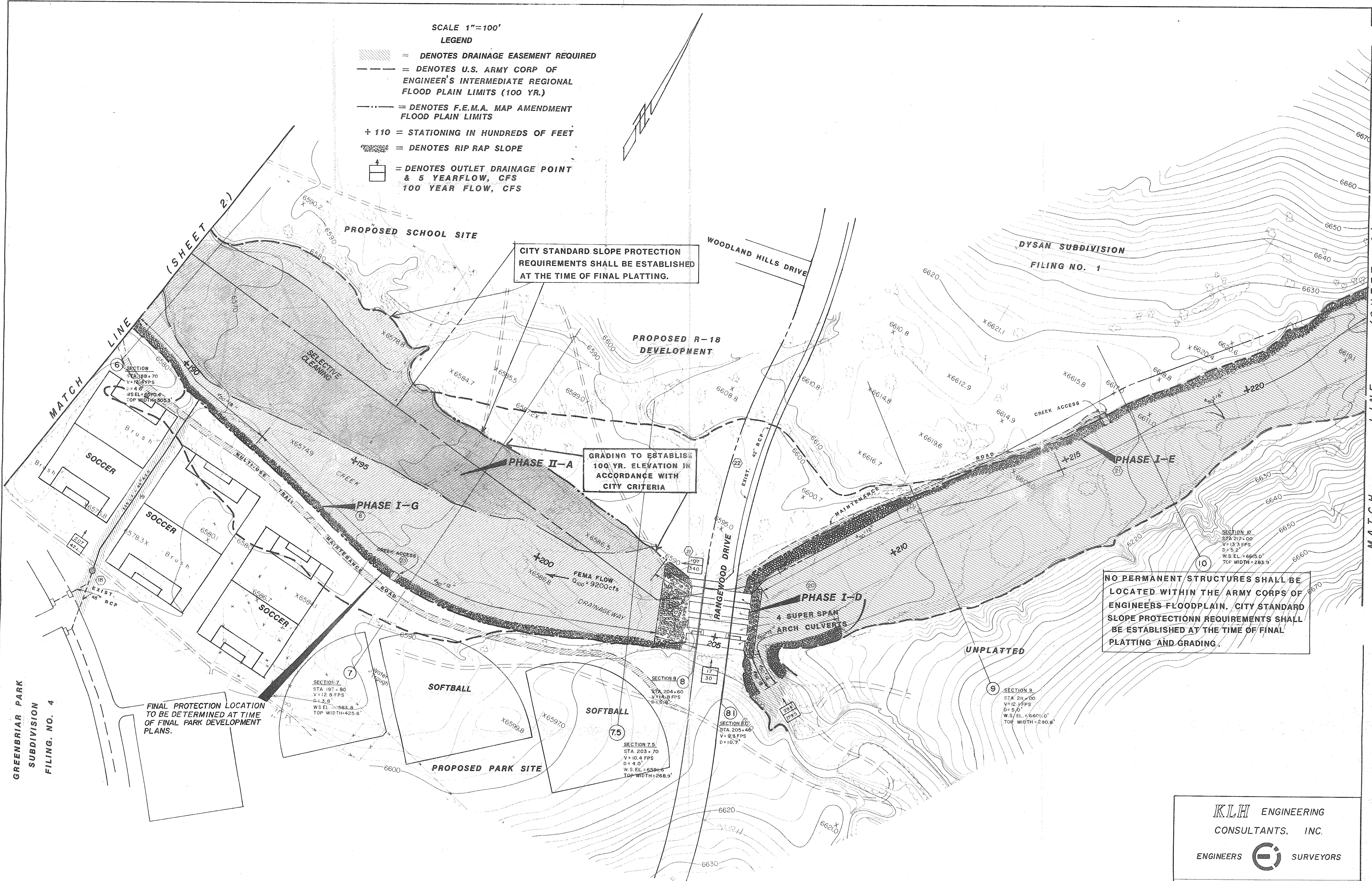

GREENBRIAR PARK SUBDIVISION FILING NO. 4

FINAL PROTECTION LOCATION TO BE DETERMINED AT TIME OF FINAL PARK DEVELOPMENT PLANS.

CITY STANDARD SLOPE PROTECTION REQUIREMENTS SHALL BE ESTABLISHED AT THE TIME OF FINAL PLATTING.

GRADING TO ESTABLISH 100 YR. ELEVATION IN ACCORDANCE WITH CITY CRITERIA

NO PERMANENT STRUCTURES SHALL BE LOCATED WITHIN THE U.S. ARMY CORPS OF ENGINEERS FLOODPLAIN. CITY STANDARD SLOPE PROTECTION REQUIREMENTS SHALL BE ESTABLISHED AT THE TIME OF FINAL PLATTING AND GRADING.

**KLH ENGINEERING CONSULTANTS, INC.**  
 ENGINEERS SURVEYORS

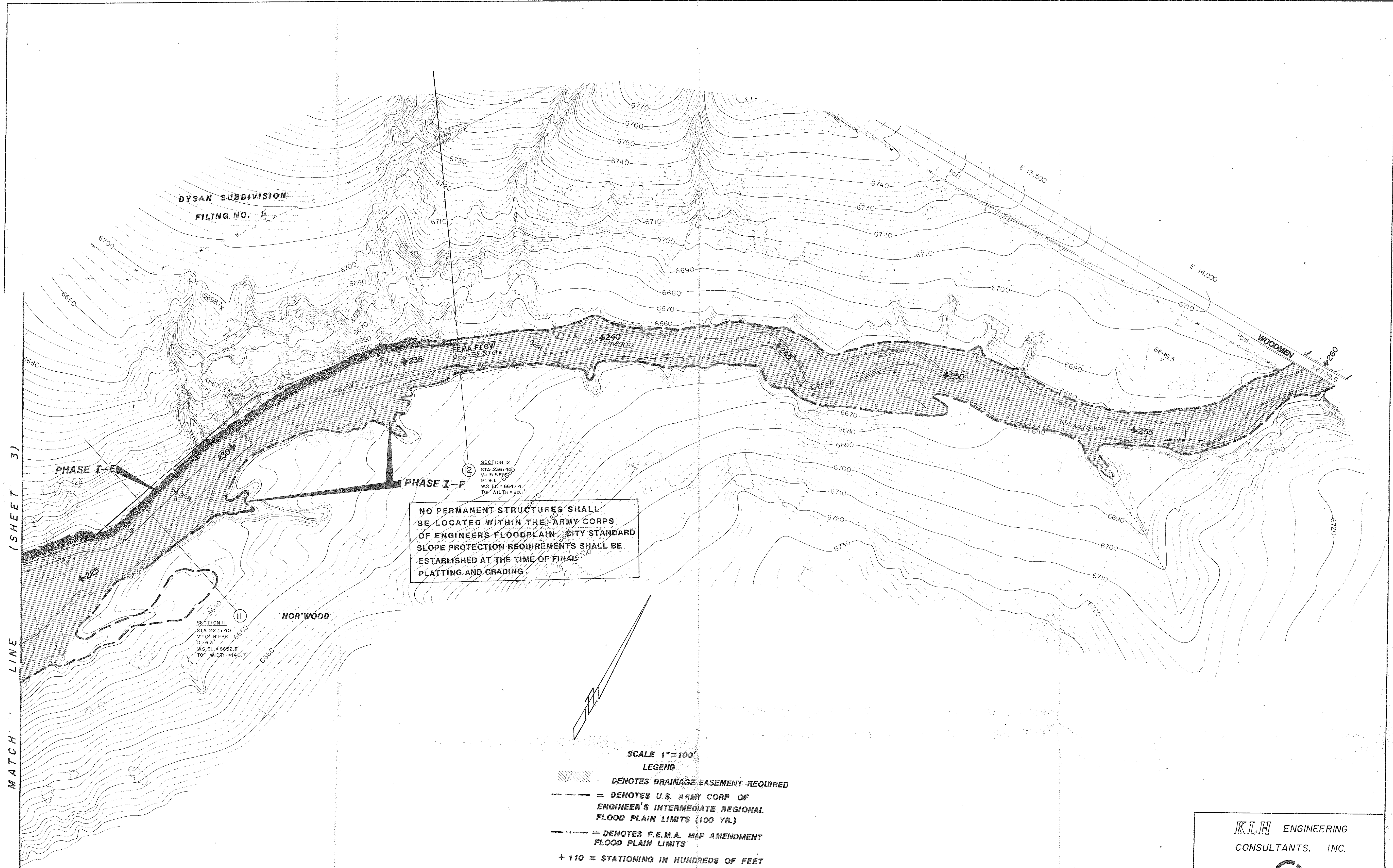

MATCH LINE (SHEET 3)

NO PERMANENT STRUCTURES SHALL BE LOCATED WITHIN THE ARMY CORPS OF ENGINEERS FLOODPLAIN. CITY STANDARD SLOPE PROTECTION REQUIREMENTS SHALL BE ESTABLISHED AT THE TIME OF FINAL PLATTING AND GRADING.

- SCALE 1"=100'  
LEGEND
- = DENOTES DRAINAGE EASEMENT REQUIRED
  - = DENOTES U.S. ARMY CORP OF ENGINEER'S INTERMEDIATE REGIONAL FLOOD PLAIN LIMITS (100 YR.)
  - = DENOTES F.E.M.A. MAP AMENDMENT FLOOD PLAIN LIMITS
  - + 110 = STATIONING IN HUNDREDS OF FEET
  - = DENOTES RIP RAP SLOPE
  - = DENOTES OUTLET DRAINAGE POINT & 5 YEAR FLOW, CFS  
100 YEAR FLOW, CFS

**KLH ENGINEERING**  
CONSULTANTS, INC.

ENGINEERS SURVEYORS