

CREEKSIDE AT ROCKRIMMON FILING NO. 1

CITY OF COLORADO SPRINGS, COUNTY OF EL PASO, STATE OF COLORADO

FINAL DRAINAGE PLAN

JULY 2008

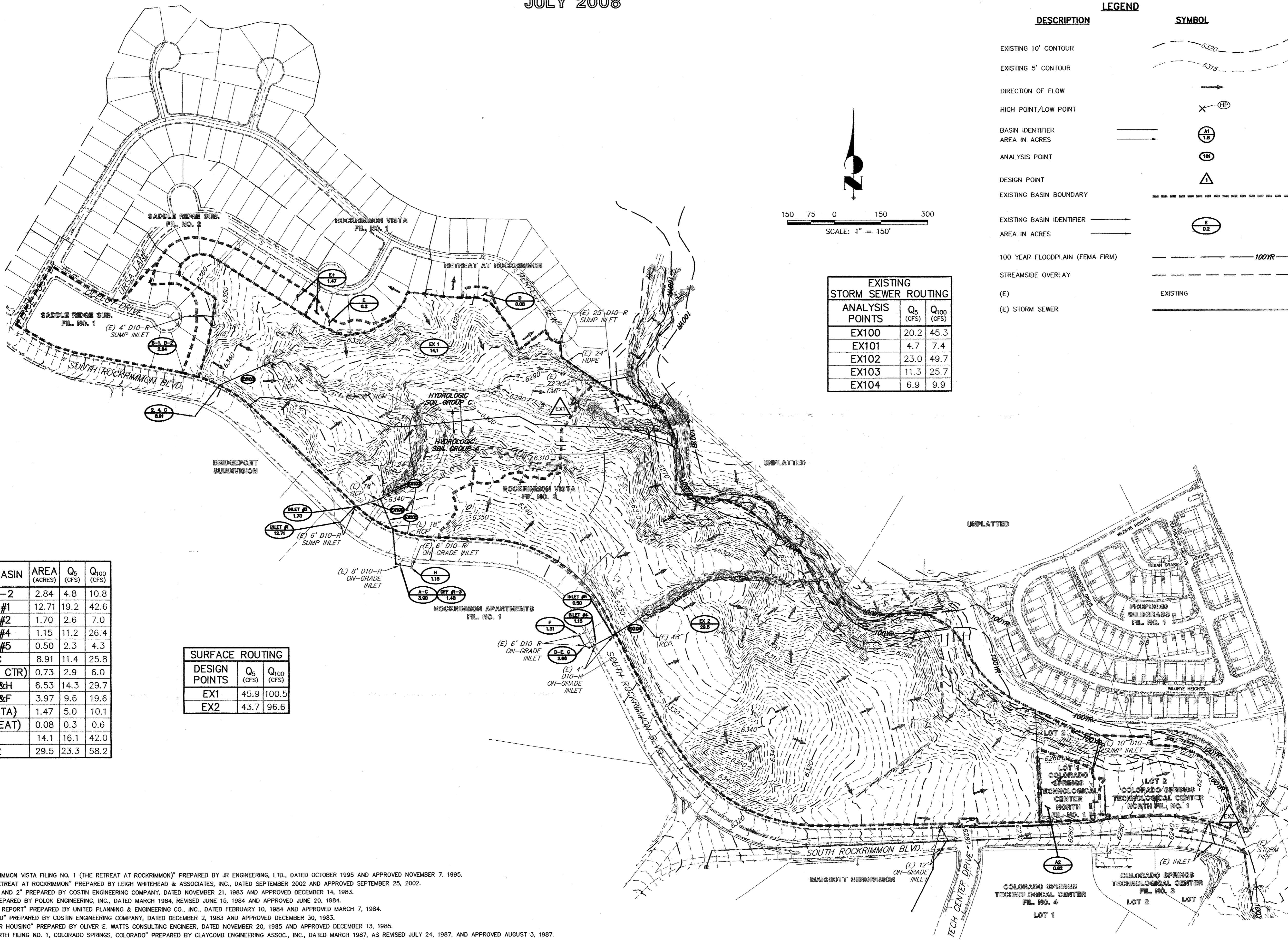

DESCRIPTION	SYMBOL
EXISTING 10' CONTOUR	
EXISTING 5' CONTOUR	
DIRECTION OF FLOW	
HIGH POINT/LOW POINT	
BASIN IDENTIFIER	
AREA IN ACRES	
ANALYSIS POINT	
DESIGN POINT	
EXISTING BASIN BOUNDARY	
EXISTING BASIN IDENTIFIER	
AREA IN ACRES	
100 YEAR FLOODPLAIN (FEMA FIRM)	
STREAMSIDE OVERLAY	
(E)	EXISTING
(E) STORM SEWER	

ANALYSIS POINTS	Q ₅ (CFS)	Q ₁₀₀ (CFS)
EX100	20.2	45.3
EX101	4.7	7.4
EX102	23.0	49.7
EX103	11.3	25.7
EX104	6.9	9.9

EXIST. BASIN	AREA (ACRES)	Q ₅ (CFS)	Q ₁₀₀ (CFS)
B-1, B-2	2.84	4.8	10.8
INLET #1	12.71	19.2	42.6
INLET #2	1.70	2.6	7.0
INLET #4	1.15	11.2	26.4
INLET #5	0.50	2.3	4.3
2,4,C	8.91	11.4	25.8
A2 (TECH CTR)	0.73	2.9	6.0
APT A&H	6.53	14.3	29.7
APT E&F	3.97	9.6	19.6
E+ (VISTA)	1.47	5.0	10.1
D (RETREAT)	0.08	0.3	0.6
EX 1	14.1	16.1	42.0
EX 2	29.5	23.3	58.2

DESIGN POINTS	Q ₅ (CFS)	Q ₁₀₀ (CFS)
EX1	45.9	100.5
EX2	43.7	96.6

- EXISTING BASIN REPORT REFERENCES:**
- "FINAL DRAINAGE REPORT ADDENDUM FOR ROCKRIMMON VISTA FILING NO. 1 (THE RETREAT AT ROCKRIMMON)" PREPARED BY JR ENGINEERING, LTD., DATED OCTOBER 1995 AND APPROVED NOVEMBER 7, 1995.
 - "FINAL DRAINAGE REPORT AND PLAN FOR THE RETREAT AT ROCKRIMMON" PREPARED BY LEIGH WHITEHEAD & ASSOCIATES, INC., DATED SEPTEMBER 2002 AND APPROVED SEPTEMBER 25, 2002.
 - "FINAL DRAINAGE STUDY, SADDLE RIDGE FILING 1 AND 2" PREPARED BY COSTIN ENGINEERING COMPANY, DATED NOVEMBER 21, 1983 AND APPROVED DECEMBER 14, 1983.
 - "BRIDGEPORT SUBDIVISION DRAINAGE REPORT" PREPARED BY POLK ENGINEERING, INC., DATED MARCH 1984, REVISED JUNE 15, 1984 AND APPROVED JUNE 20, 1984.
 - "ROCKRIMMON APARTMENTS DRAINAGE PLAN AND REPORT" PREPARED BY UNITED PLANNING & ENGINEERING CO., INC., DATED FEBRUARY 10, 1984 AND APPROVED MARCH 7, 1984.
 - "FINAL DRAINAGE STUDY, ROCKRIMMON BOULEVARD" PREPARED BY COSTIN ENGINEERING COMPANY, DATED DECEMBER 2, 1983 AND APPROVED DECEMBER 30, 1983.
 - "DRAINAGE PLAN AND REPORT, ROCKRIDGE SENIOR HOUSING" PREPARED BY OLIVER E. WATTS CONSULTING ENGINEER, DATED NOVEMBER 20, 1985 AND APPROVED DECEMBER 13, 1985.
 - "COLORADO SPRINGS TECHNOLOGICAL CENTER NORTH FILING NO. 1, COLORADO SPRINGS, COLORADO" PREPARED BY CLAYCOMB ENGINEERING ASSOC., INC., DATED MARCH 1987, AS REVISED JULY 24, 1987 AND APPROVED AUGUST 3, 1987.

UNTIL SUCH TIME AS THESE DRAWINGS ARE APPROVED BY THE APPROPRIATE REVIEWING AGENCIES, JR ENGINEERING APPROVES THEIR USE ONLY FOR THE PURPOSES AUTHORIZED BY WRITTEN AUTHORIZATION.

PREPARED FOR
HOUSING PARTNERS, INC.
1880 OFFICE CLUB POINT SUITE 2000
COLORADO SPRINGS, CO. 80920
719-665-6920

J.R. ENGINEERING
A Wehrman Company
4310 ArrowsWest Drive • Colorado Springs, CO 80907
719-665-6920 • Fax: 719-628-6616
www.jrengineering.com

BY	DATE	NO.	REVISION

H-SCALE 1"=150'
V-SCALE N/A
DATE 3/13/08
DESIGNED BY ACS
DRAWN BY ACS
CHECKED BY

CREEKSIDE AT ROCKRIMMON FILING NO. 1

FINAL DRAINAGE PLAN

EXISTING CONDITIONS

SHEET 1 OF 1
JOB NO. 29760.00