

# MASTER DRAINAGE PLAN AIRPORT OZ SUBDIVISION

PART OF THE SE1/4, SECTION 25, T.14S., R.66W. OF THE 6TH P.M.  
IN THE CITY OF COLORADO SPRINGS  
EL PASO COUNTY, COLORADO

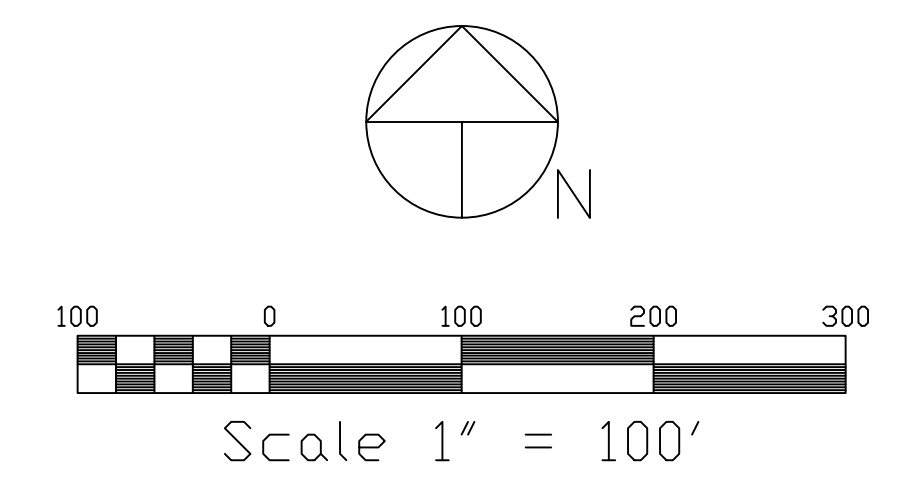

- LEGEND:**
- SET 2" AL. CAP, #9853 DN #5 REBAR
  - ◁ FOUND YELLOW #34964 CAP DN #4 REBAR
  - ◻ FOUND 2" AL. CAP, #23515 DN #5 REBAR+
  - FOUND CDDT 3-1/4" AL. CAP DN #5 REBAR
  - FOUND CDDT 3-1/4" AL. CAP MILE MARKER
  - ◆ FOUND ILLEG. ZAPPIT DN CONC. NAIL

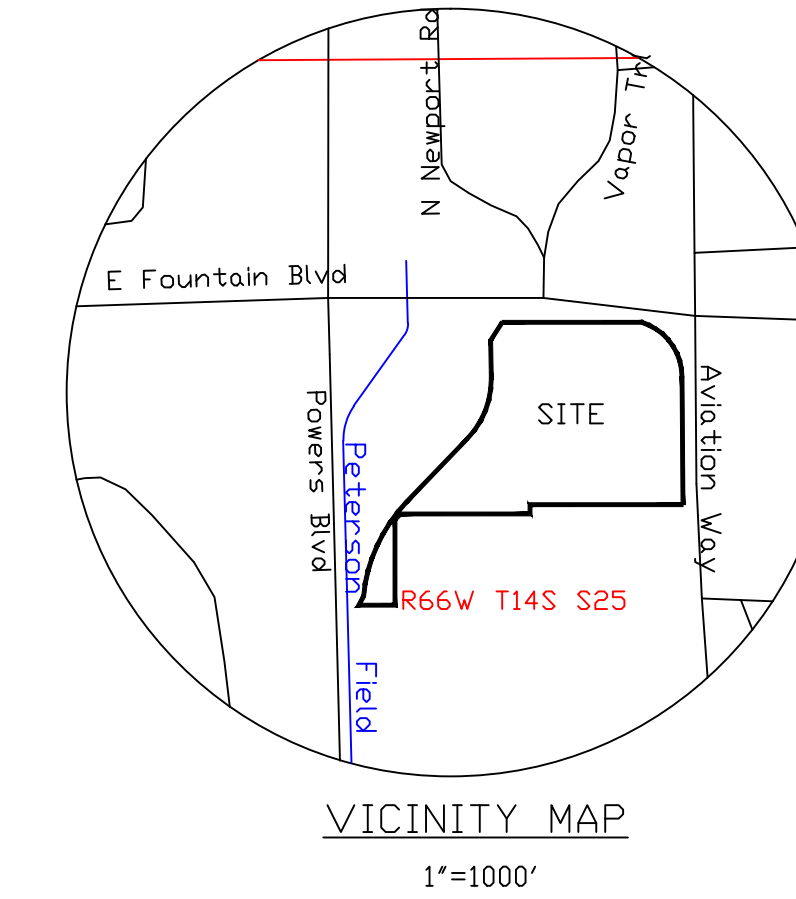
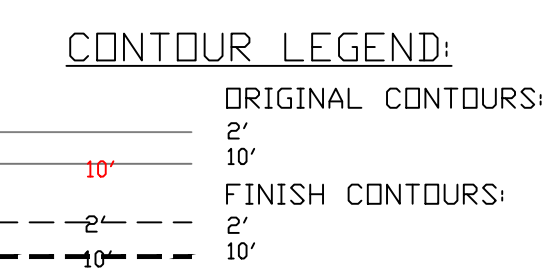

- LEGEND:**
- 8.3/14.9  
10.5/20.4  
RUNOFF IN CFS 5-YEAR/100-YEAR HISTORIC CONDITION  
DEVELOPED CONDITION
  - A LIMIT OF DRAINAGE BASIN AND DESIGNATION
  - EXISTING STORM SEWER AS LABELED
  - PROPOSED STORM SEWER AS LABELED
  - B LIMIT OF SOILS TYPE AND GROUP

BASIN	AREA AC.	RUNOFF - CFS	
		HISTORIC	DEVELOPED
01	1.42	1.4/4.2	1.4/4.2
A	3.13	0.71/5.2	5.5/14.2
B	2.40	0.50/3.8	4.9/10.8
C	11.23	2.0/14.1	13.5/26.8
D	1.16	N/A	N/A
E	6.18	0.7/6.4	7.4/16.5
H	1.19	0.3/1.9	2.2/4.5
ROUTING			
A+B	5.51	5/100 YR.	9.7/22.5
01-B	7.32		11.2/26.7
01-D	19.34		28.5/62.6
01-E	25.52		34.9/76.8
01-H	26.71		34.3/70.1
F	9.78	1.6/12.3	20.1/41.3
G	7.28	1.3/9.9	11.0/24.5
F+G	17.06		25.0/53.9
F-H	18.25		20.6/54.3

Prepared by the Office of:  
Oliver E. Watts, Consulting Engineer, Inc.  
614 Elkton Drive, Colorado Springs, CO 80907  
719-593-0173  
oliewatts@aol.com  
Celebrating over 41 years in business

City File No: AR FP 19-00506