

# EASTVIEW

CITY OF COLORADO SPRINGS, COUNTY OF EL PASO, STATE OF COLORADO

## MASTER DEVELOPMENT DRAINAGE PLAN

AUGUST 2004

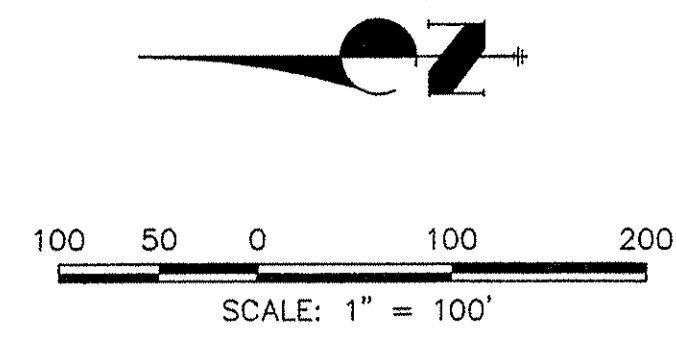

| DESCRIPTION                                   | SYMBOL |
|---|--------|
| EXISTING GRADE INDEX CONTOUR                  |        |
| EXISTING GRADE NOMINAL CONTOUR                |        |
| PROPOSED FINISH INDEX CONTOUR                 |        |
| PROPOSED FINISH NOMINAL CONTOUR               |        |
| PROPOSED OFFSITE FINISH INDEX CONTOUR         |        |
| PROPOSED OFFSITE FINISH NOMINAL CONTOUR       |        |
| PROPOSED STORM SEWER                          |        |
| FUTURE STORM SEWER                            |        |
| SITE BOUNDARY                                 |        |
| HIGH POINT ELEVATION                          |        |
| LOW POINT ELEVATION                           |        |
| DIRECTION OF FLOW WITH PERCENT GRADE          |        |
| PROPOSED BASIN BOUNDARY                       |        |
| PREVIOUSLY STUDIED DRAINAGE BASIN BOUNDARY    |        |
| MAJOR BASIN BOUNDARY LINE PER SAND CREEK DBPS |        |
| PROPOSED SWALE                                |        |
| PROPOSED FLOW DIRECTION                       |        |
| PROPOSED OFFSITE SWALE                        |        |
| PROPOSED OFFSITE FLOW DIRECTION               |        |
| NATURAL CONDITION FLOW DIRECTION              |        |
| BASIN IDENTIFIER                              |        |
| AREA IN ACRES                                 |        |
| OTHER FILING BASIN IDENTIFIER                 |        |
| AREA IN ACRES                                 |        |
| ANALYSIS POINT                                |        |
| STORM DRAIN DESIGN POINT                      |        |
| PROPOSED CROSSPAN                             |        |

| BASIN | AREA (ACRES) | Q <sub>5</sub> (CFS) | Q <sub>100</sub> (CFS) |
|-------|--------------|----------------------|------------------------|
| A     | 11.3         | 51.7                 | 97.1                   |
| B     | 4.6          | 8.6                  | 17.9                   |
| C     | 5.7          | 11.6                 | 24.2                   |
| D     | 6.7          | 12.9                 | 27.0                   |
| E     | 4.9          | 10.3                 | 21.5                   |
| F     | 2.9          | 5.4                  | 11.3                   |
| G     | 7.2          | 14.2                 | 29.7                   |
| H     | 5.3          | 8.9                  | 18.6                   |
| I     | 3.9          | 8.5                  | 17.8                   |
| J     | 8.0          | 12.9                 | 27.0                   |
| K     | 5.3          | 11.4                 | 23.8                   |
| L     | 3.5          | 7.9                  | 16.5                   |
| M     | 3.0          | 5.5                  | 11.5                   |
| O     | 2.0          | 4.4                  | 9.2                    |
| P     | 1.3          | 3.2                  | 6.7                    |
| Q     | 0.8          | 2.2                  | 4.6                    |
| R     | 0.5          | 2.1                  | 3.9                    |
| OS-A  | 8.3          | 7.9                  | 18.6                   |
| OS-B  | 1.8          | 7.5                  | 14.3                   |

| ANALYSIS POINTS | Q <sub>5</sub> (CFS) | Q <sub>100</sub> (CFS) |
|-----------------|----------------------|------------------------|
| AP-0            | 9                    | 17                     |
| AP-1            | 47                   | 92                     |
| AP-2            | 33                   | 40                     |
| AP-3            | 5                    | 11                     |
| AP-4            | 21                   | 45                     |
| AP-5            | 15                   | 32                     |
| AP-6            | 12                   | 25                     |
| AP-7            | 14                   | 30                     |
| AP-8            | 9                    | 19                     |
| AP-9            | 9                    | 18                     |
| AP-10           | 12                   | 25                     |
| AP-11           | 17                   | 39                     |
| AP-12           | 13                   | 27                     |
| AP-13           | 3                    | 10                     |
| AP-14           | -                    | -                      |

| STORM DRAIN | Q <sub>5</sub> (CFS) | Q <sub>100</sub> (CFS) |
|-------------|----------------------|------------------------|
| SD-1        | 39                   | 50                     |
| SD-2        | 51                   | 87                     |
| SD-3        | 51                   | 88                     |
| SD-4        | 21                   | 44                     |
| SD-5        | 24                   | 48                     |
| SD-6        | 32                   | 62                     |
| SD-7        | 42                   | 82                     |
| SD-8        | 13                   | 27                     |
| SD-9        | 54                   | 106                    |

THE LOCATIONS OF EXISTING ABOVE GROUND AND UNDERGROUND UTILITIES ARE SHOWN IN AN APPROXIMATE WAY ONLY. THE CONTRACTOR SHALL DETERMINE THE EXACT LOCATION OF ALL EXISTING UTILITIES BEFORE COMMENCING WORK. THE CONTRACTOR SHALL BE FULLY RESPONSIBLE FOR ANY AND ALL DAMAGES WHICH MIGHT BE CAUSED BY HIS FAILURE TO EXACTLY LOCATE AND PRESERVE ANY AND ALL ABOVE GROUND AND UNDERGROUND UTILITIES.

**48 HOURS BEFORE YOU DIG,**  
CALL UTILITY LOCATORS  
**1-800-922-1987**  
CITY OF COLORADO SPRINGS DEPT. OF UTILITIES  
GAS, ELECTRIC, WATER AND WASTEWATER

PREPARED UNDER MY DIRECT SUPERVISION FOR AND ON BEHALF OF JR ENGINEERING

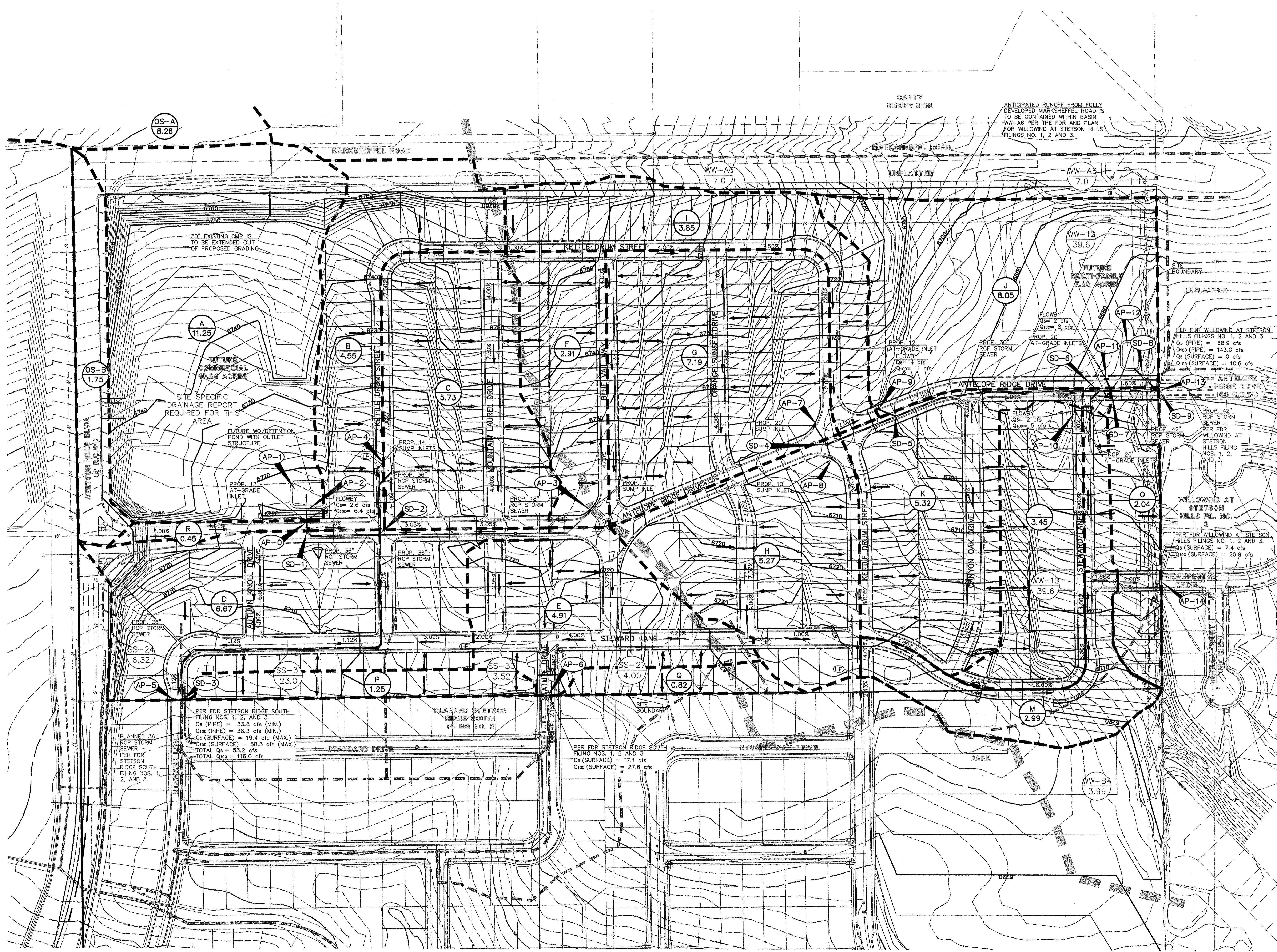

UNTIL SUCH TIME AS THESE DRAWINGS ARE APPROVED BY THE APPROPRIATE REVIEWING AGENCIES, THE ENGINEERING PROFESSIONAL SEAL DESIGNATED BY WRITTEN AUTHORIZATION.

PREPARED FOR  
**US HOME CORPORATION**  
7222 Commerce Center Drive  
Suite 118  
Colorado Springs, CO 80919  
Ph. (719) 593-8583  
Fax. (719) 593-0435

**JR ENGINEERING**  
A Western Company  
430 Arapahoe Drive • Colorado Springs, CO 80907  
719-593-2800 • Fax: 719-593-9800  
www.jr-engineering.com

| H-SCALE | V-SCALE | DATE     | DESIGNED BY | DRAWN BY | CHECKED BY |
|---------|---------|----------|-------------|----------|------------|
| 1"=100' | N/A     | 12/16/03 | DLM         | MAL      |            |

EASTVIEW  
MASTER DEVELOPMENT DRAINAGE PLAN