

Legal:  
 A portion of the Northwest 1/4 of Section 5 and the Northeast 1/4 of Section 6, all in Township 15 South, Range 66 West of the 6th R.M., El Paso County, Colorado. (See attached legal description.)

DATA:

|                     |           |
|---------------------|-----------|
| TOTAL UNITS/AC.     | 5.7       |
| P.U.D. 42 LOTS      | 175 - 49% |
| P.U.D. 81 LOTS      | 80 - 31%  |
| P.U.D. UNITS/AC.    | 7.7       |
| TOTAL P.U.D. LOTS   | 255       |
| R-2 LOTS            | 129       |
| R-2 UNITS/AC.       | 3.8       |
| L.F. R-2 ROADWAY    | 4640      |
| L.F. P.U.D. ROADWAY | 5680      |
| TOTAL ACRES P.U.D.  | 33.0      |
| TOTAL ACRES R-2     | 34.3      |
| TOTAL ACRES         | 67.3      |
| P.U.D. PARK AC.     | 3.0       |
| R-2 PARK AC.        | 2.1       |
| TOTAL LOTS          | 384       |

scale - 1" = 100' date Feb. 1972

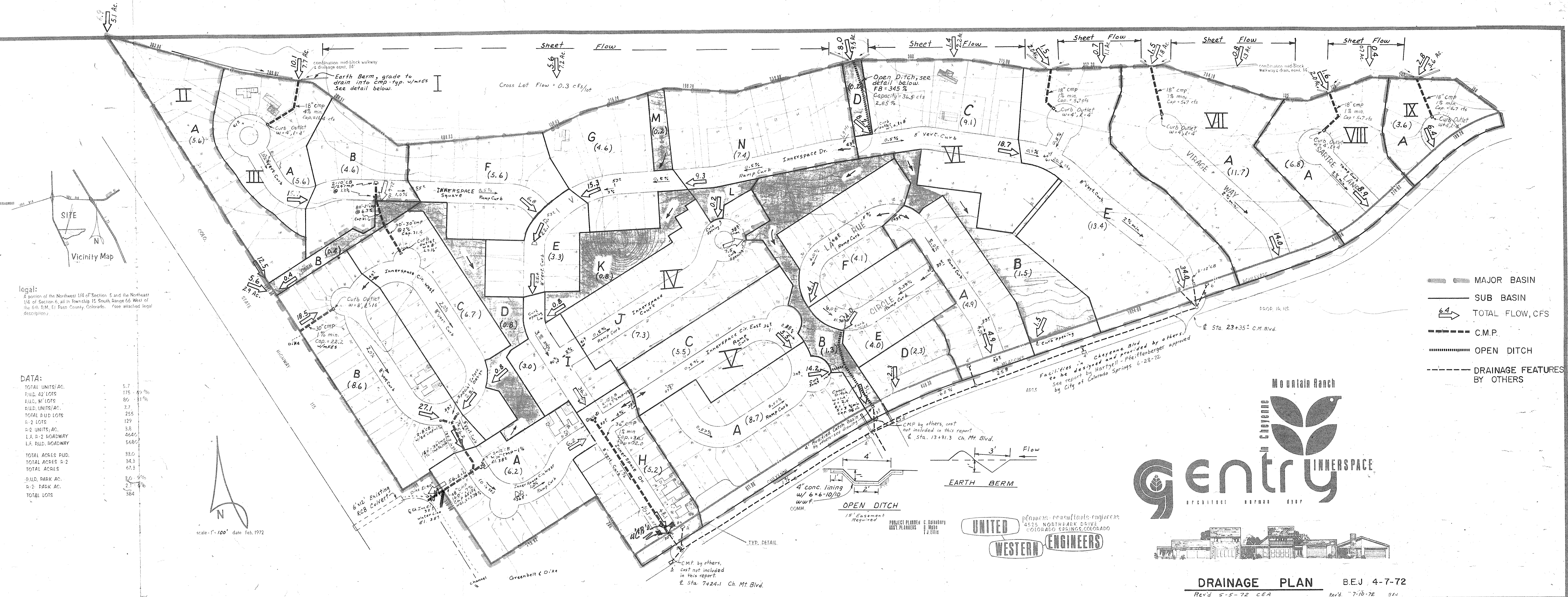

- MAJOR BASIN
- SUB BASIN
- TOTAL FLOW, CFS
- C.M.P.
- OPEN DITCH
- DRAINAGE FEATURES BY OTHERS

Mountain Ranch  
 Gentry INNSPACE  
 ARCHITECTS PLANNERS ENGINEERS

UNITED WESTERN ENGINEERS  
 PLANNERS-CONSULTANTS-ENGINEERS  
 4525 NORTH PARK DRIVE  
 COLORADO SPRINGS, COLORADO

DRAINAGE PLAN BEJ 4-7-72  
 Rev'd 5-5-72 CEA Rev'd 7-10-72 964