

GOLD HILL MESA MASTER DEVELOPMENT DRAINAGE PLAN

COLORADO SPRINGS, CO

DRAINAGE MAP

MAY 2018

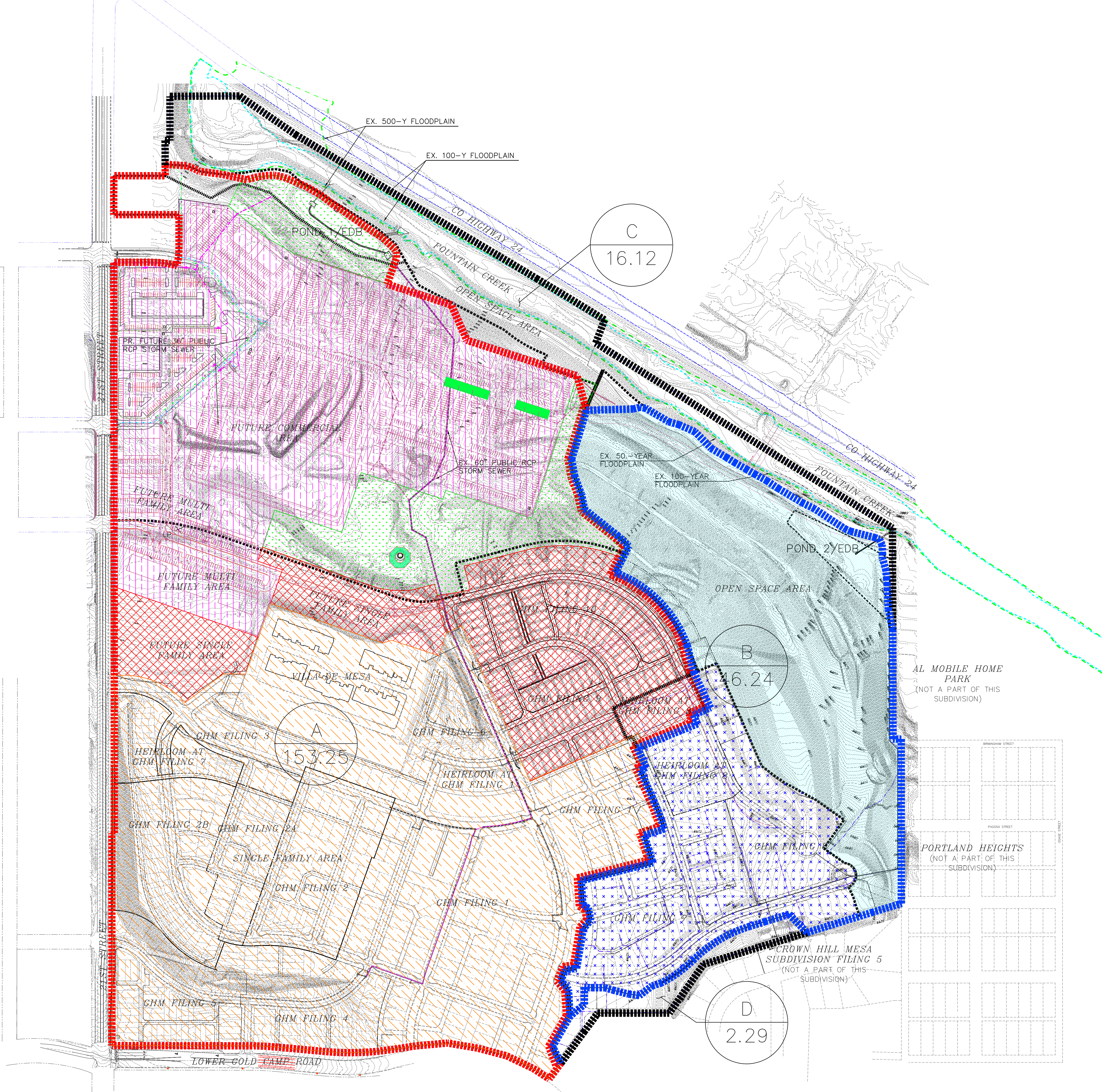

ULTIMATE LEGEND

- 10' EX CONTOUR -GB10-
- BASIN ID (A) 0.37
- ACREAGE (B) 16.24
- BASIN BOUNDARY
- BASIN TRIBUTARY TO POND 1
- BASIN TRIBUTARY TO POND 2
- POND 1 CURRENT OR FUTURE SINGLE FAMILY DEVELOPMENT W/ FULL SPECTRUM DETENTION & WATER QUALITY
- POND 1 EXISTING SINGLE FAMILY DEVELOPED W/ FULL SPECTRUM & WATER QUALITY
- POND 1 FUTURE COMMERCIAL AREA W/ FULL SPECTRUM DETENTION & WATER QUALITY
- POND 1 OPEN SPACE AREA W/ FULL SPECTRUM DETENTION & WATER QUALITY
- POND 2 CURRENT UNDEVELOPED AREA W/ FULL SPECTRUM DETENTION & WATER QUALITY
- POND 2 CURRENT DEVELOPMENT W/ FULL SPECTRUM DETENTION & WATER QUALITY

PROPOSED CONDITIONS

BASIN	ACRES	Q5 CFS	Q100 CFS
A	153.25	139	202
B	46.24	64	126
C	16.12	16	34
D	2.29	4	8

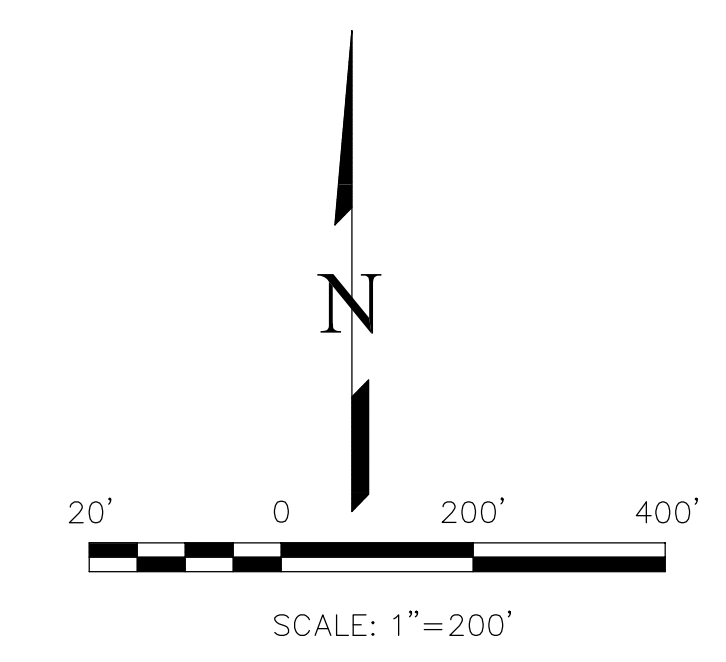

THIS DESIGN WAS PREPARED UNDER MY DIRECT SUPERVISION FOR AND ON BEHALF OF TERRA NOVA ENGINEERING, INC.

QUENTIN ARMIJO, PROFESSIONAL ENGINEER
COLORADO P.E. NO. 37170

NO.	DESCRIPTION	DATE

UNTIL SUCH TIME AS THESE CONDITIONS ARE APPROVED BY THE REVIEWING AGENCIES AND SURVEYING, INC. APPROVES THEIR USE ONLY DESIGNATED BY WRITTEN AUTHORIZATION.

PREPARED FOR:
GOLD HILL NEIGHBORHOOD, LLC
ATTN: STEPHANIE EDWARDS
142 S. RAVEN MINE DR.
COLORADO SPRINGS, CO 80904
719 633-2202

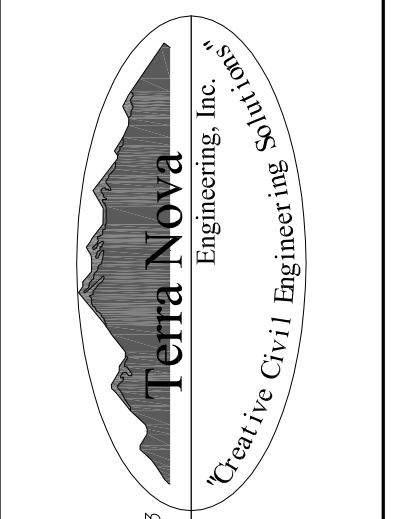

125 N. WINGBACH AVENUE
COLORADO SPRINGS, CO 80903
OFFICE: 719-635-6422
FAX: 719-635-6426
www.tneng.com

GOLD HILL MESA MASTER DEVELOPMENT DRAINAGE
DRAINAGE MAP

DESIGNED BY	QNA
DRAWN BY	QNA
CHECKED BY	
H-SCALE	1"=200'
V-SCALE	NA
JOB NO.	1713.00
DATE ISSUED	5/16/18
SHEET NO.	1 OF 1