

GOLD HILL MESA MASTER DEVELOPMENT DRAINAGE PLAN

COLORADO SPRINGS, CO

INTERIM DRAINAGE MAP

MAY 2018

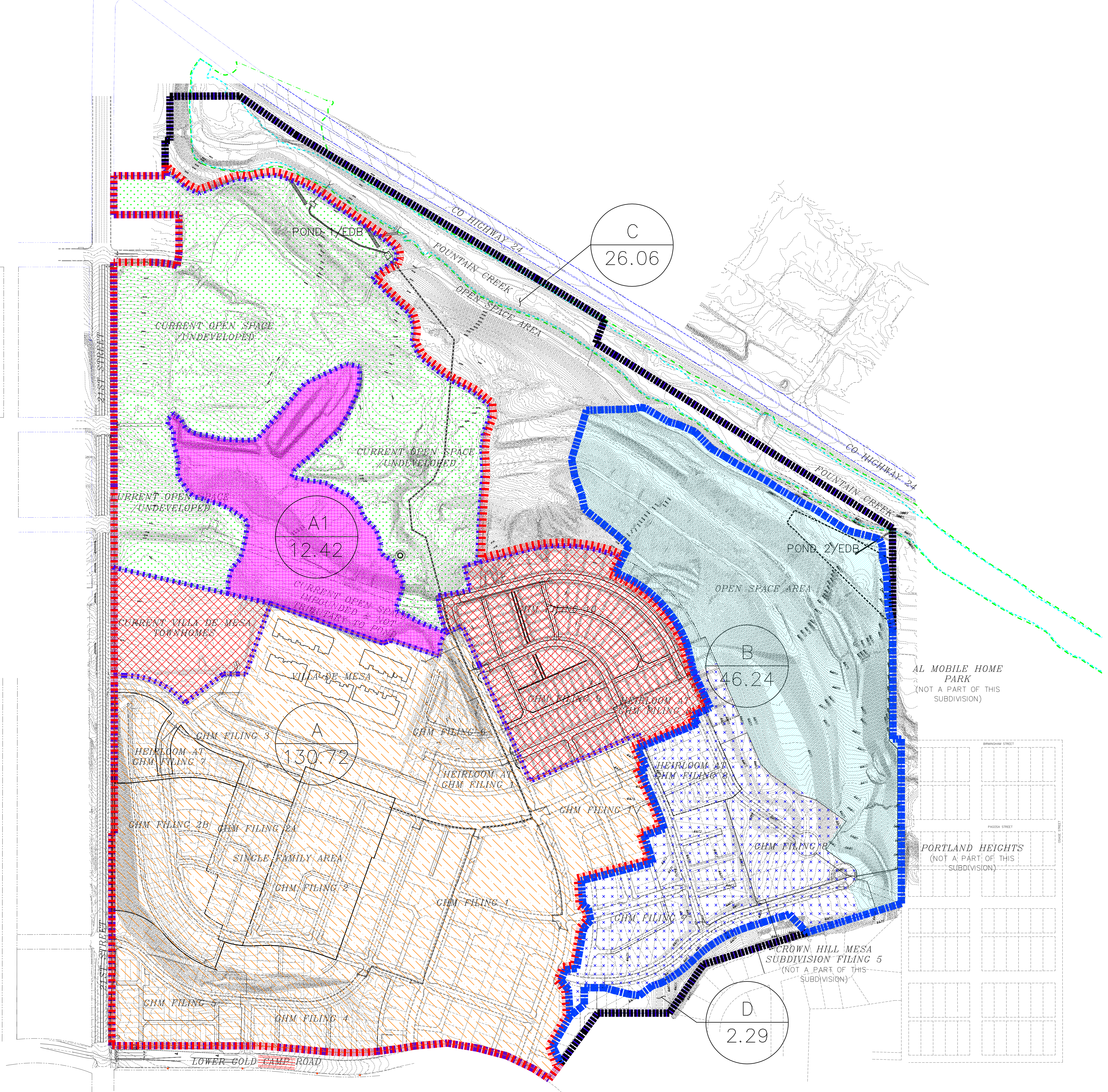

INTERIM LEGEND

- 10' EX CONTOUR
- BASIN ID
- ACREAGE
- BASIN BOUNDARY
- BASIN TRIBUTARY TO POND 1
- BASIN TRIBUTARY TO POND 2

- POND 1 CURRENT SINGLE FAMILY DEVELOPMENT TRIBUTARY W/ FULL SPECTRUM DETENTION & WATER QUALITY
- POND 1 EXISTING SINGLE FAMILY TRIBUTARY W/ WATER QUALITY
- POND 1 OPEN SPACE NOT TRIBUTARY DUE TO IMPOUNDMENT
- POND 1 OPEN SPACE AREA TRIBUTARY W/ WATER QUALITY
- POND 2 CURRENT UNDEVELOPED AREA W/ FULL SPECTRUM DETENTION & WATER QUALITY
- POND 2 CURRENT DEVELOPMENT W/ FULL SPECTRUM DETENTION & WATER QUALITY

PROPOSED CONDITIONS

BASIN	ACRES	Q5 CFS	Q100 CFS
A	130.72	116	202
A1	12.42	13	28
B	46.24	64	126
C	26.06	26	54
D	2.29	4	8

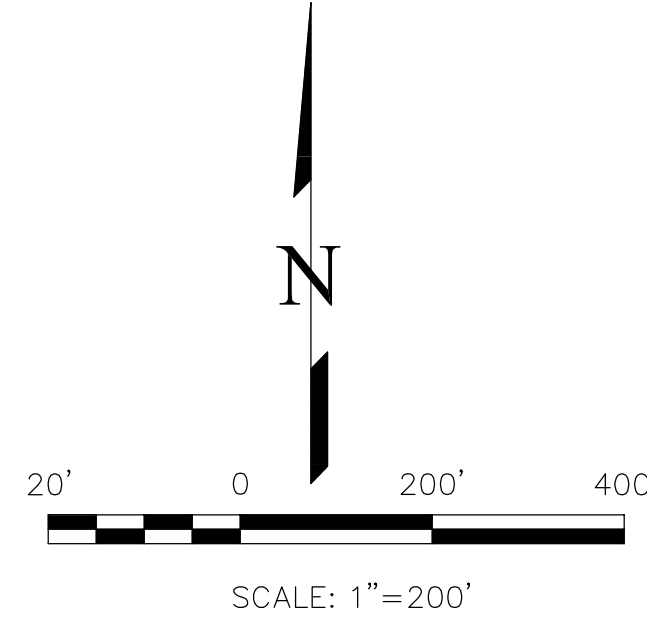

UNTIL SUCH TIME AS THESE REVISIONS ARE APPROVED BY THE REVIEWING AGENCIES AND SURVEYING, INC. APPROVES THEIR USE ONLY DESIGNATED BY WRITTEN AUTHORIZATION.

REVISIONS	NO.	DESCRIPTION	DATE

PREPARED FOR:
GOLD HILL NEIGHBORHOOD, LLC
 ATTN: STEPHANIE EDWARDS
 142 S. RAVEN MINE DR.
 COLORADO SPRINGS, CO 80904
 719 633-2202

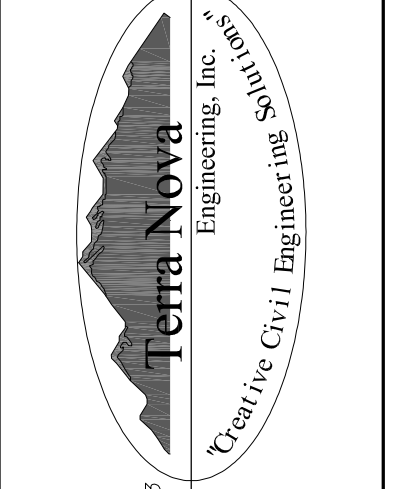

125 N. WINGBACH AVENUE
 COLORADO SPRINGS, CO 80903
 OFFICE: 719-635-6422
 FAX: 719-635-6426
 www.tneng.com

GOLD HILL MESA MASTER DEVELOPMENT DRAINAGE

INTERIM DRAINAGE MAP

THIS DESIGN WAS PREPARED UNDER MY DIRECT SUPERVISION FOR AND ON BEHALF OF TERRA NOVA ENGINEERING, INC.

DESIGNED BY	QNA
DRAWN BY	QNA
CHECKED BY	
H-SCALE	1"=200'
V-SCALE	NA
JOB NO.	1713.00
DATE ISSUED	5/1/18
SHEET NO.	1 OF 1

QUENTIN ARMIJO, PROFESSIONAL ENGINEER
 COLORADO P.E. NO. 37170