

GOLD HILL MESA FILING NO. 9 & 10

COLORADO SPRINGS, CO

PROPOSED DRAINAGE MAP

MAY 2018

PIPE RUN SUMMARY

PIPE RUN	CONTRIBUTING DESIGN POINTS	AREA AC.	Q5 CFS	Q100 CFS	MIN. SLOPE	SIZE	TYPE	OWNER
1	FLOW SPLIT BETWEEN INLETS DP-1 & 2	1.89	6.7	13.2	2.00%	24"	RCP	PUBLIC
2	Total flow at DP-1 & 2	5.53	13.4	26.3	1.50%	30"	RCP	PUBLIC
EX4**	DP-EX4	1.80	11.0	22.2	2.00%	EX 18"	RCP	PUBLIC
3	DP 3	0.38	1.1	2.1	2.00%	EX 18"	RCP	PUBLIC
4	DP 4	2.06	4.9	8.6	48.74%	EX 18"	RCP	PUBLIC
5A	DP5A	3.16	6.9	10.7	2.14%	18"	RCP	PUBLIC
5	FLOW SPLIT BETWEEN INLETS DP-5 & 6	5.69	13.7	25.6	3.36%	24"	RCP	PUBLIC
6	TOTAL FLOW AT DP-5 & 6	11.39	20.4	40.4	1.00%	30"	RCP	PUBLIC

DESIGN POINT SUMMARY

DP	CONTRIBUTING BASINS	AREA AC.	Q5 CFS	Q100 CFS	INLET SIZE/TYPE	OWNER
1A*	OS-C, C & A3	2.04	5.3	10.4	NO INLET ST. CAP CHK	PUBLIC
1	A1, A2 & A3, OS-C, & C	5.06	12.2	23.9	12' D10-R SUMP	PUBLIC
2	B	5.53	1.5	3.0	12' D10-R SUMP	PUBLIC
1 & 2	FLOW SPLIT BETWEEN INLETS	3.78	6.7	13.2	NO INLET FLOW CHK	
EX4	OS-D & D	1.80	4.8	9.7	EX 5' D10-R SUMP	PUBLIC
3	E	0.38	1.1	2.1	EX 12' D10-R AT-GRADE	PUBLIC
4	OS-G1	2.06	4.9	9.6	EX 12' D10-R AT-GRADE	PUBLIC
5A*	OS-H & H1	3.16	7.1	13.7	12' D10-R AT-GRADE	PUBLIC
5B*	DP 5A FLOW BY, H2 & H3	5.69	6.0	14.4	NO INLET ST. CAP CHK	
5C*	DP-5B & H4	6.63	8.2	18.6	NO INLET ST. CAP CHK	
5	DP 3 & 4 FLOWBY, OS-G2, G, DP 5B & H5	9.47	9.1	21.2	12' D10-R SUMP	PUBLIC
6	OS-I & I	1.91	4.5	8.8	12' D10-R SUMP	PUBLIC
5 & 6	FLOW SPLIT BETWEEN INLETS	11.39	6.7	14.9	NO INLET FLOW CHK	

* Design Points were analyzed to check for street capacity conformance.

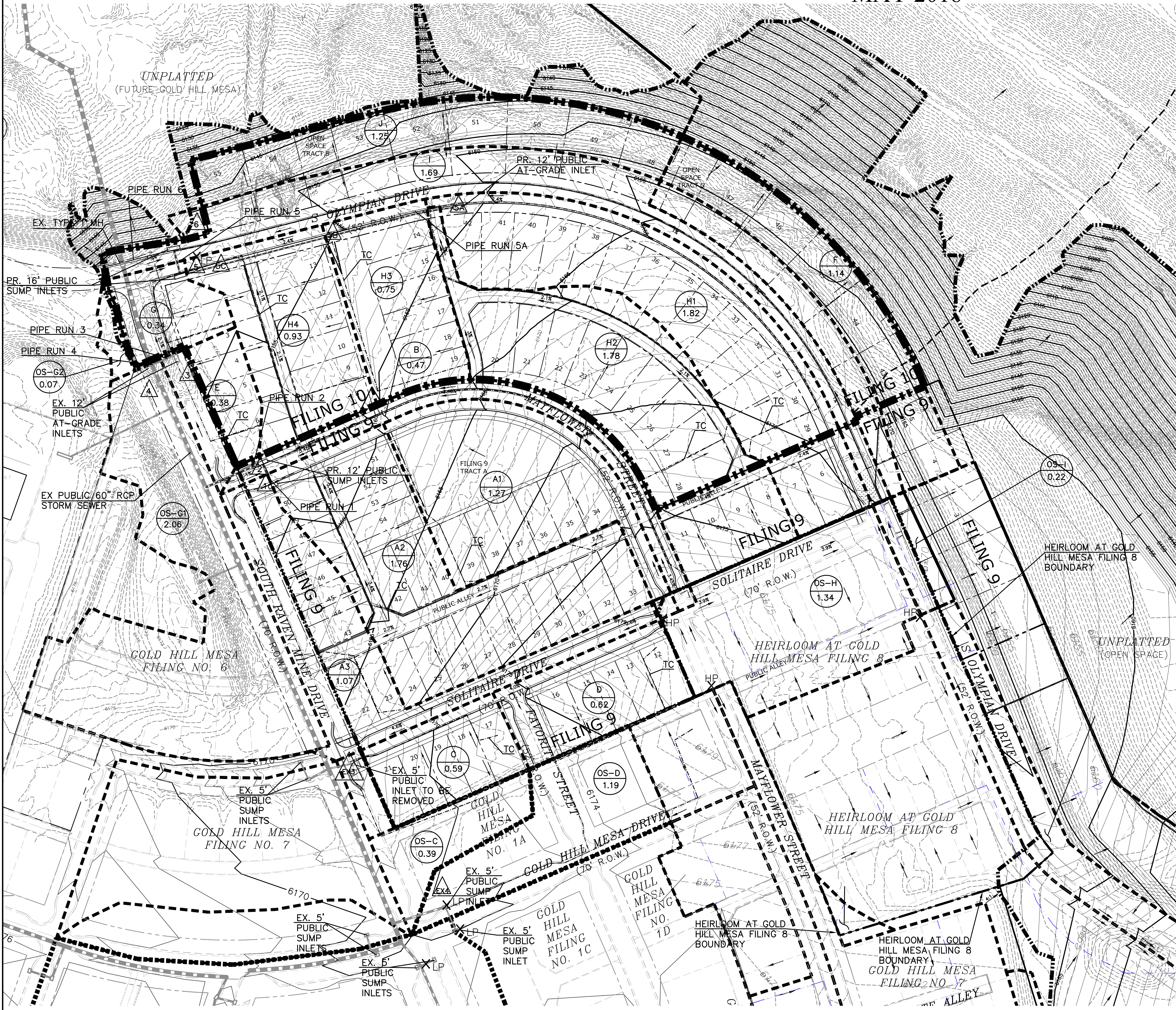

LEGEND

- 10' EX CONTOUR
- 2' EX CONTOUR
- 10' PROP. CONTOUR
- 2' PROP. CONTOUR
- PROPOSED FLOW DIRECTION
- BASIN BOUNDARY
- TIME OF CONCENTRATION
- BASIN ID
- ACREAGE
- DESIGN POINT

PROPOSED CONDITIONS

BASIN	ACRES	Q5 CFS	Q100 CFS
A1	1.27	2.4	4.7
A2	1.76	4.8	9.5
A3	1.07	2.8	5.4
B	0.47	1.5	3.0
OS-C	0.39	1.1	2.2
C	0.59	1.7	3.4
OS-D	1.19	2.8	5.4
D	0.62	1.4	2.8
E	0.38	1.1	2.1
F	1.14	3.8	7.7
OS-G1	2.06	4.9	9.6
OS-G2	0.07	0.1	0.2
G	0.34	0.8	1.6
OS-H	1.34	3.1	6.1
H1	1.82	4.2	8.2
H2	1.78	4.2	8.2
H3	0.75	1.9	3.7
H4	0.93	2.4	4.7
OS-I	0.22	0.6	1.2
I	1.69	4.0	7.8
J	1.25	4.1	8.4

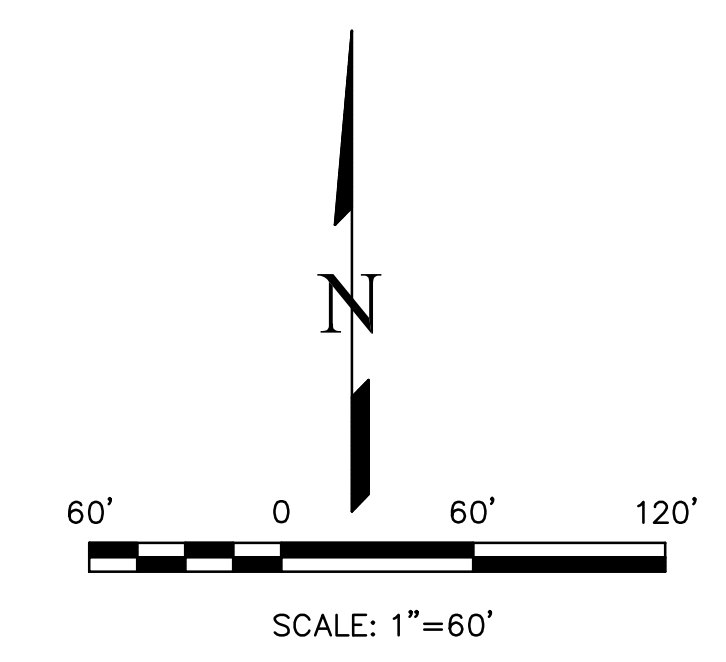

THIS DESIGN WAS PREPARED UNDER MY DIRECT SUPERVISION FOR AND ON BEHALF OF TERRA NOVA ENGINEERING, INC.

QUENTIN ARMIJO, PROFESSIONAL ENGINEER
COLORADO P.E. NO. 37170

REVISIONS	NO.	DESCRIPTION	DATE

UNTIL SUCH TIME AS THESE CONDITIONS ARE APPROVED BY THE APPROPRIATE REVIEWING AGENCIES AND SURVIVING INC. APPROVES THEIR USE ONLY DESIGNATED BY WRITTEN AUTHORIZATION.

PREPARED FOR:
GOLD HILL NEIGHBORHOOD, LLC
ATTN: BARRY BRINTON
142 S. RAVEN MINE DR.
COLORADO SPRINGS, CO 80904
719 499-3917

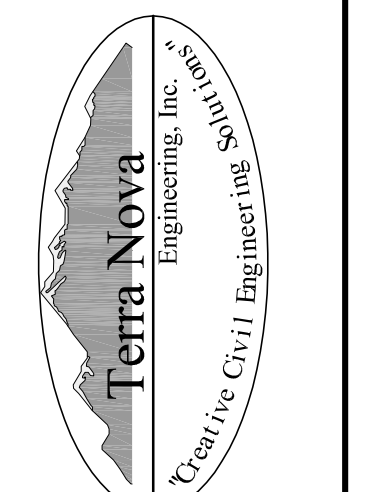

125 N. WILKINSON AVENUE
COLORADO SPRINGS, CO 80903
OFFICE: 719-635-4422
FAX: 719-635-6426
www.terranovae.com

GOLD HILL MESA FILING NO. 9 & 10
PROPOSED DRAINAGE MAP

DESIGNED BY: QNA
DRAWN BY: DLM
CHECKED BY: QNA
H-SCALE: 1"=60'
V-SCALE: NA
JOB NO. 1713.00
DATE ISSUED 5/16/18
SHEET NO. 1 OF 1