

Exist Planned Industrial Park

Kissing Camels Industrial Park

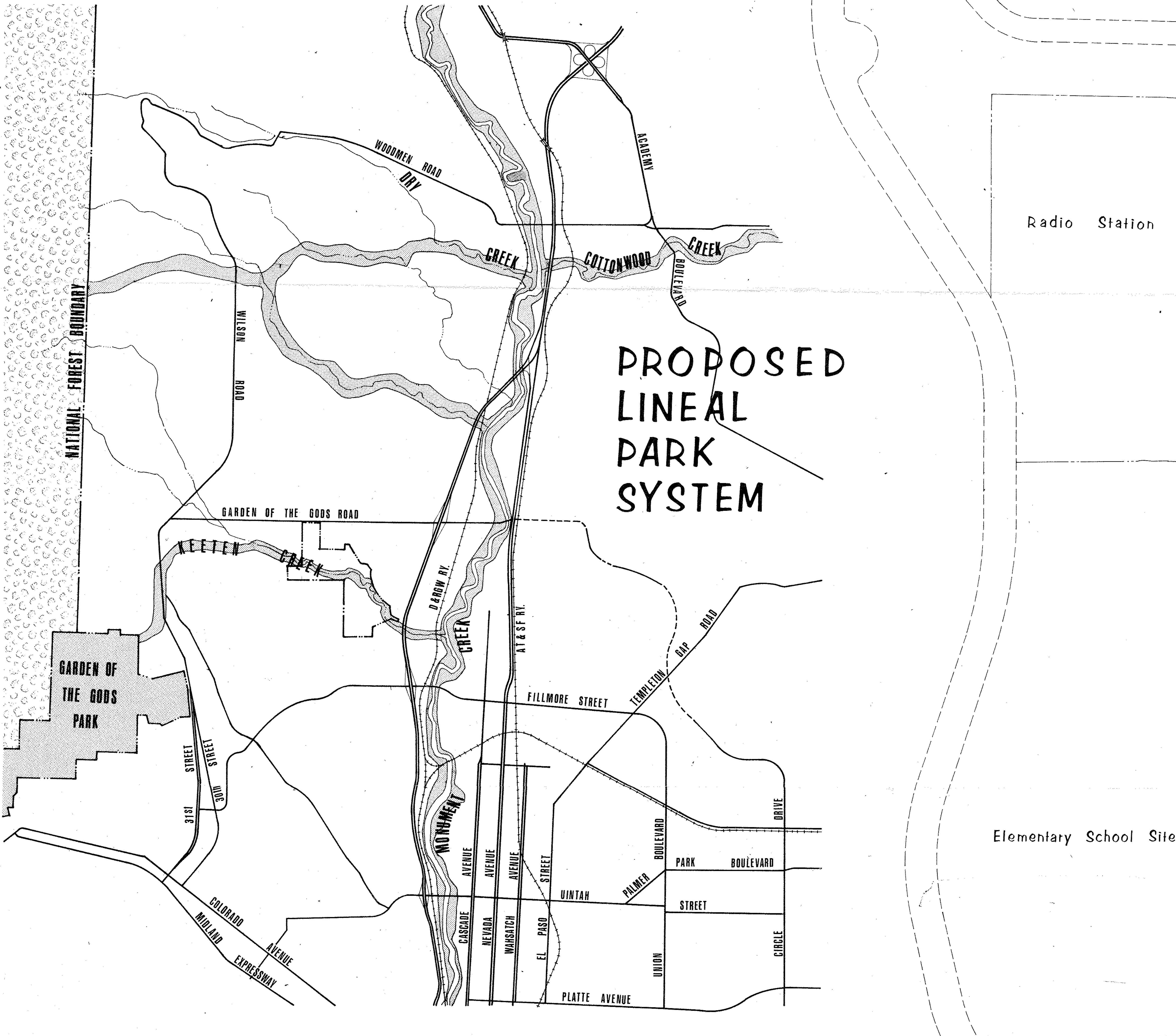
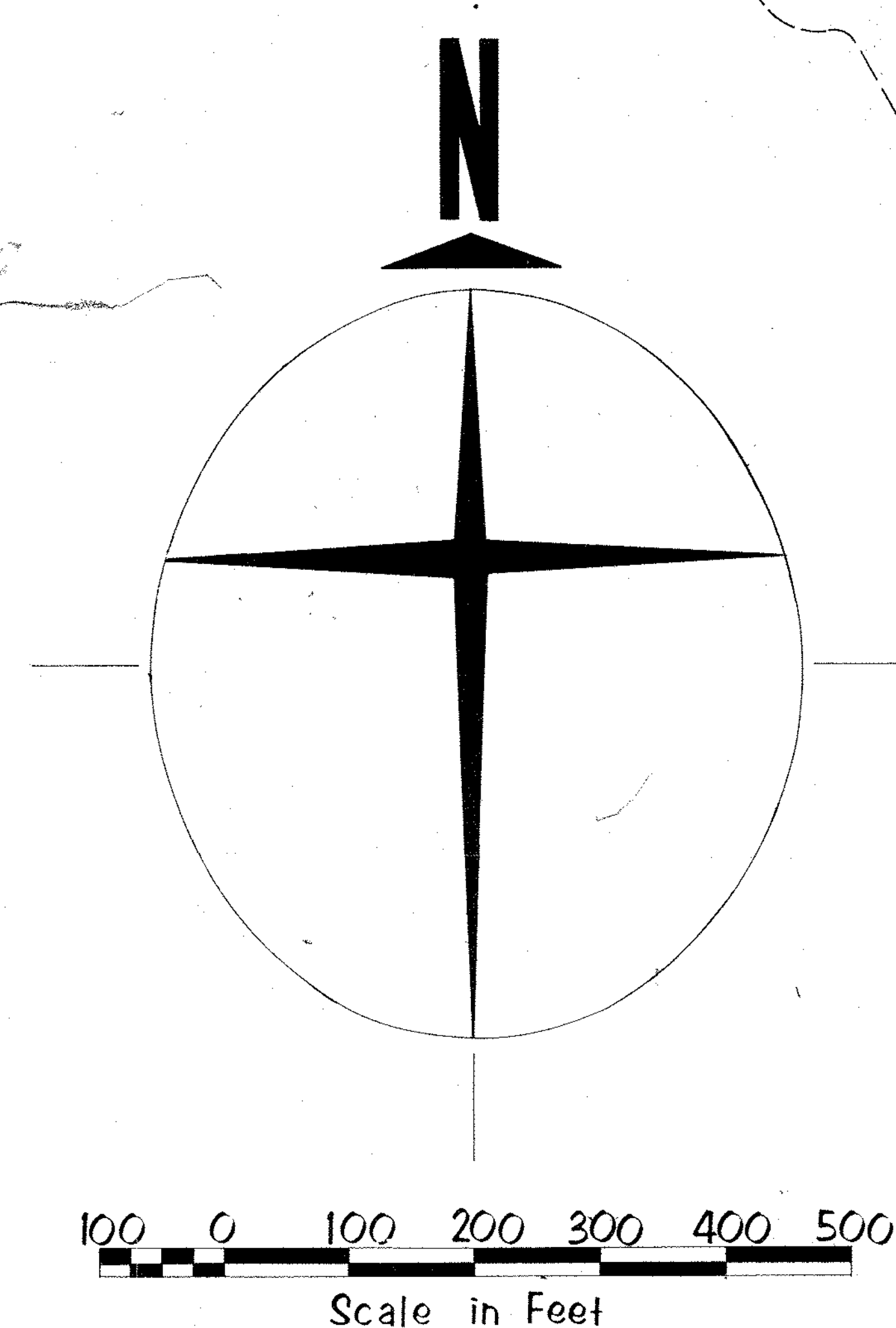
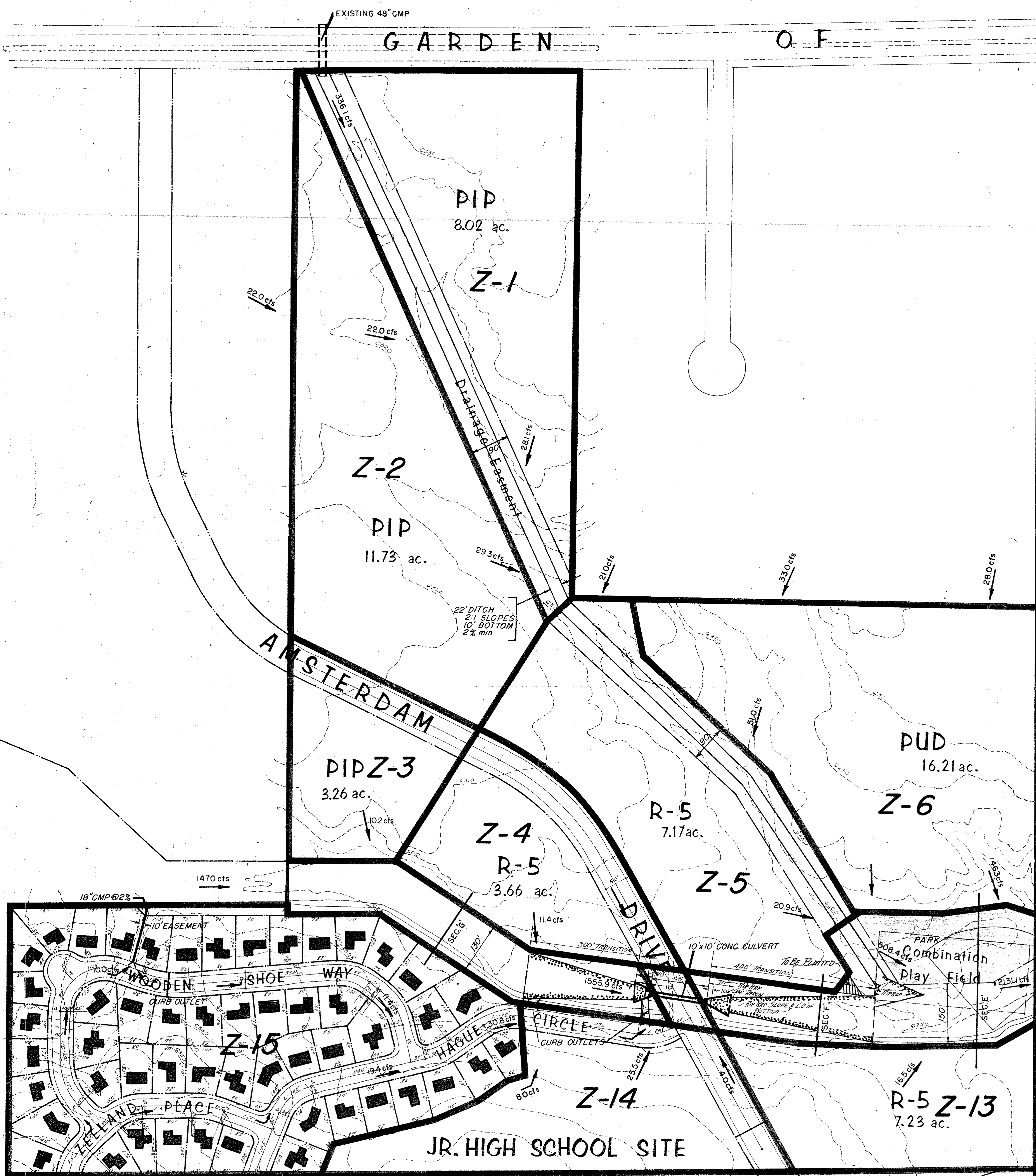

HOLLAND PARK DATA:

	ZONE	ACRES	DENSITY D.U./Acre	D.U.	PEOPLE PER D.U.	POPULATION
1. SINGLE FAMILY	R-2	69.69	3.6	248	3.6	893
2. TWO FAMILY	R-3	1.03	4.0	4	3.2	13
3. PLANNED UNIT DEVELOPMENT	PUD	16.21	20.0	320	2.7	864
4. MULTI-FAMILY	R-5	68.60	25.0	1715	2.7	4630
5. CONVENIENCE CENTER	PBC 1	4.52				
6. JUNIOR HIGH SCHOOL	Total Acres: 20	5.81				
7. CITY PARK	Total Acres: 7.71	4.40				
8. LINEAL PARK		30.89				
9. INDUSTRIAL	PIP 1	23.01				

TOTALS: 224.20 Acres 2287 D.U. 6400 PEOPLE

DRAINAGE PLAN

Sheet 2 of 2

HOLLAND PARK