

# THE HOMESTEAD PHASE III

**DATA:**

|                                     |             |      |
|-------------------------------------|-------------|------|
| SINGLE FAMILY                       | 895         | 60.  |
| DENSITY                             | 3.8 U./AC.  |      |
| MULTI-FAMILY                        |             | 45.  |
| 6-FLEXES                            | 10          |      |
| DENSITY                             | 13.0 U./AC. |      |
| R.O.W.                              |             | 48.1 |
| DENSITY                             | 80.0 U./AC. |      |
| M.H.R.                              | 95.6        |      |
| R.S.C.-1                            | 6.4         |      |
| R.S.C.-2                            | 17.5        |      |
| S.U.-1                              | 28.1        |      |
| R.S. SCHOOL                         | 10.2        |      |
| LINEAL PARK                         | 16.3        |      |
| CITY PARK                           | 7.3         |      |
| 60' R.O.W.                          | 10.6        |      |
| 100' R.O.W.                         | 8.2         |      |
| R.O.W. FOR POWERS BLVD. & INTERCHG. | 13.86       |      |
| TOTAL AREA OF SUB.                  | 287.6       |      |

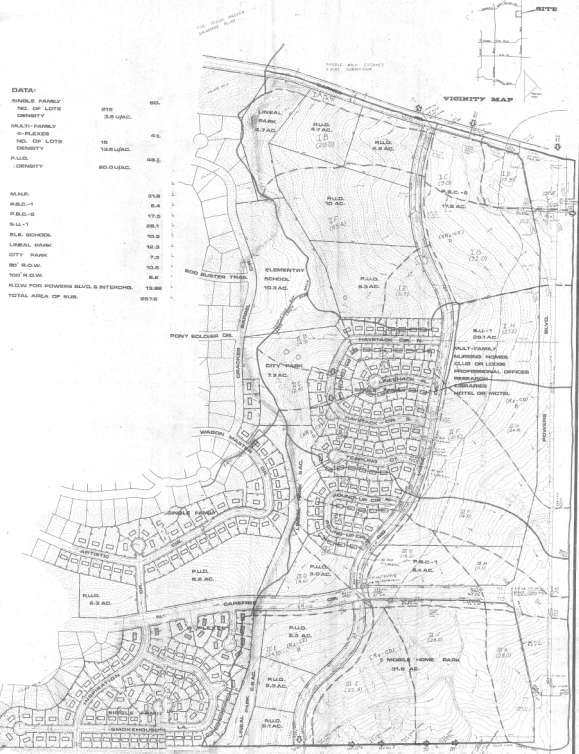
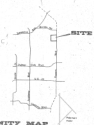

**DRAWING PLAN**  
 ---- EASE BOUNDARY  
 - - - - - EASE BOUNDARY  
 --- FLOW AND DIRECTION  
 - - - - - FLOW DIRECTION  
 (P-1) 80' BASH FLOW IN P.S.  
 (P-2) FLOW DIRECTION  
 - - - - - LEAD BRANCH CHANNEL  
 - - - - - FLOW  
 (P) DESIGN CONTROL POINT  
 (P-1) DESIGN CONTROL POINT  
 (P-2) DESIGN CONTROL POINT  
 (P-3) DESIGN CONTROL POINT  
 (P-4) DESIGN CONTROL POINT  
 (P-5) DESIGN CONTROL POINT

**OWNER:**  
 COL. TERRA INV. LTD.  
 8160 N. WINDY BLVD.  
 GOLD BEACH, OREG.

**LEGAL DESCRIPTION**  
 A PORTION OF THE S.1/2 OF SEC. 20  
 T.24N. R.12E. WM. CO. OREG. IN THE CITY OF  
 GOLD BEACH, OREG.

**AND R. SELIGMAN & ASSOCIATES INC.**  
 LAND DEVELOPMENT CONSULTANTS  
 SUITE C202 411 LAKEWOOD DR. S.E. S.C.

