

LEGEND

- CULVERT
- MAJOR 100 YEAR CAPACITY STORM SEWER
- DIRECTION OF FLOW
- BASIN DESIGNATION
Q10 (CFS) DEVELOPED
Q100 (CFS) DEVELOPED
- Q10 (CFS) DEVELOPED (HISTORIC)
SECTION NUMBER
Q100 (CFS) DEVELOPED (HISTORIC)
- BASIN DESIGNATION
BASIN BOUNDARY
- JUNCTION BOX

EXISTING 12' x 10' HIGH BOX CULVERT 1560 CFS CAPACITY
 PROPOSED 8' x 6' WIDE BOX CULVERT 581 CFS CAPACITY

EXISTING 12' x 13.1' HIGH WITH R=6' ARCH 1740 CFS CAPACITY

PROPOSED 8' x 5' WIDE BOX CULVERT 401 CFS CAPACITY

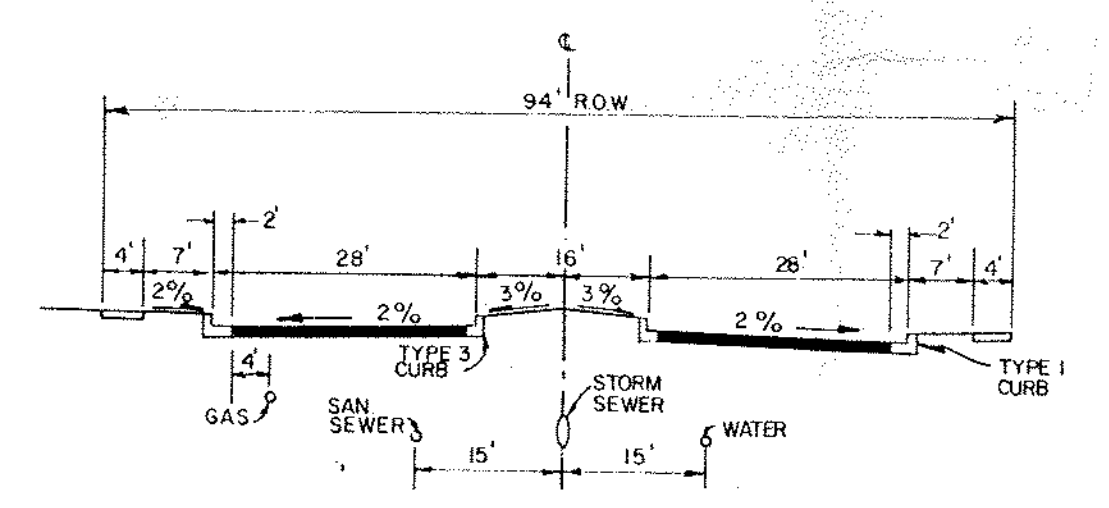

TYPICAL SECTION WITHOUT SPLIT GRADE (TYPE II MINOR ARTERIAL)
N.T.S.

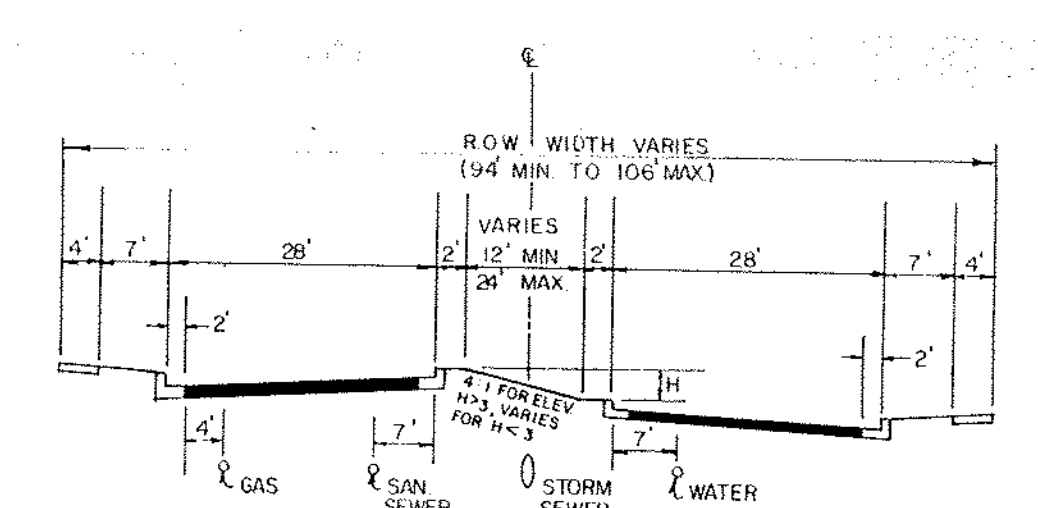

TYPICAL SECTION WITH SPLIT GRADE

**PRELIMINARY DRAINAGE PLAN
 MONTEBELLO DRIVE
 SANITARY SEWER S.I.D.
 COLORADO SPRINGS, COLORADO**

DREXEL, BARRELL & CO. ENGINEERS — SURVEYORS 1700 38TH STREET BOULDER, COLORADO 80501 (303) 442-4338 1405 N. EL PASO STREET COLORADO SPRINGS, COLORADO 80907 (303) 633-5029		Date	Designed by	Job No.
		26 MAY 1989	RM	E-3745 C
Scale	Drawn by	Checked by	Drawing No.	
1" = 50'	SBS		4D 032	
Revisions - Date	Checked by			

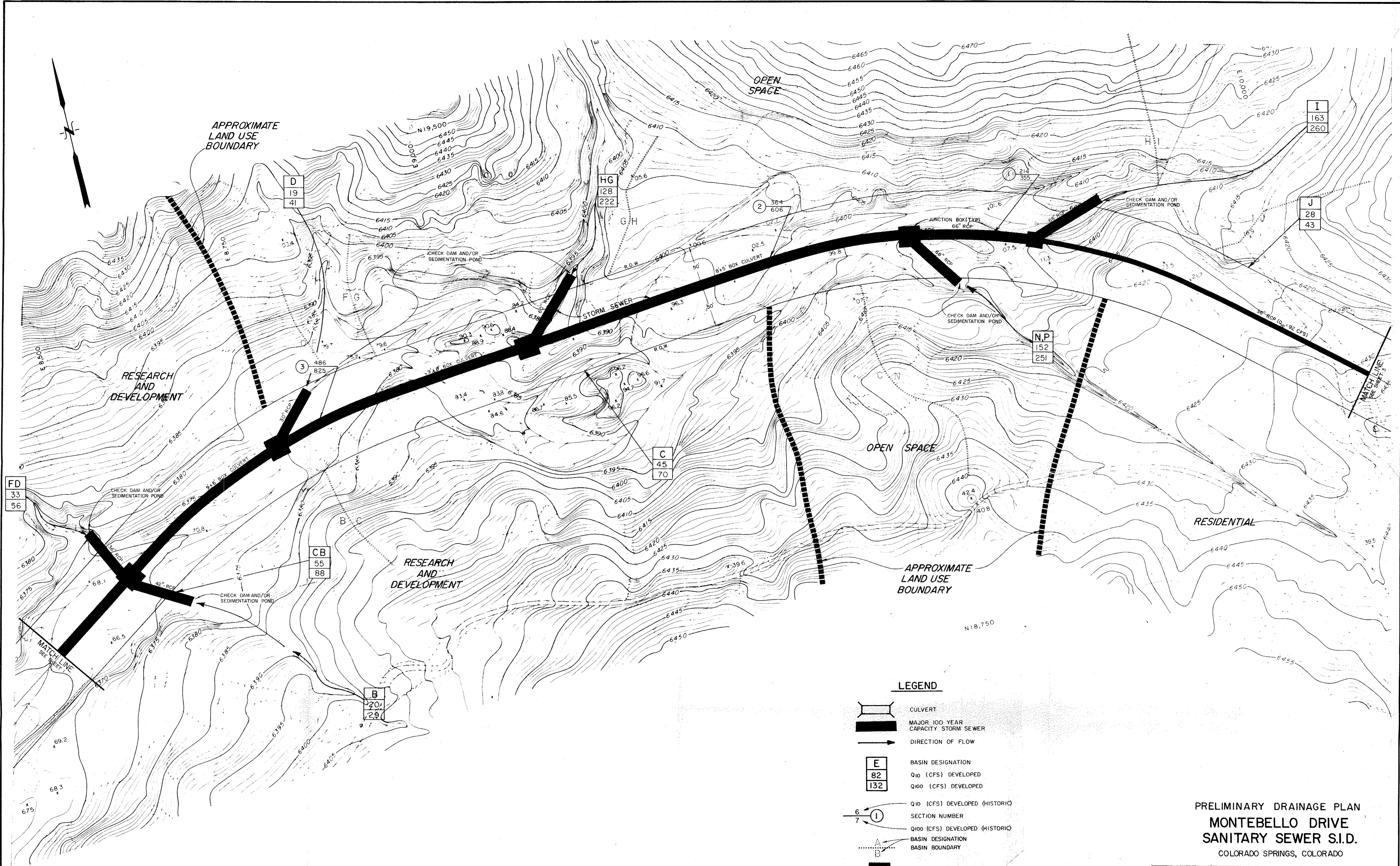

PRELIMINARY DRAINAGE PLAN
MONTEBELLO DRIVE
SANITARY SEWER S.I.D.
 COLORADO SPRINGS, COLORADO

DREXEL, BARRELL & CO. ENGINEERS SURVEYORS 1700 38TH STREET BOULDER, COLORADO 80501 (303) 442-4338 1405 N. EL PASO STREET COLORADO SPRINGS, COLORADO 80907 (303) 433-5029			
Date	26 MAY 1989	Designed by	Job No.
Scale	1" = 50'	Drawn by	E-3745 C
Checked by		Drawing No.	4D 032



LEGEND

- CULVERT
- MAJOR 100 YEAR CAPACITY STORM SEWER
- DIRECTION OF FLOW
- BASIN DESIGNATION
Q10 (CFS) DEVELOPED
Q100 (CFS) DEVELOPED
- Q10 (CFS) DEVELOPED (HISTORIC)
Q100 (CFS) DEVELOPED (HISTORIC)
- SECTION NUMBER
- BASIN BOUNDARY
- JUNCTION BOX

PRELIMINARY DRAINAGE PLAN
 MONTEBELLO DRIVE
 SANITARY SEWER S.I.D.
 COLORADO SPRINGS, COLORADO

Drexel Barrell <small>400 PEARL EAST CIRCLE, SUITE 114 BOULDER, COLORADO 80301 (303) 443-4338 740 WOOTEN ROAD #108 COLORADO SPRINGS, COLORADO 80915 (303) 591-5101</small>		Engineers/Surveyors Incorporated
Date 26 MAY 1989	Designed by RM	Job No. E-3745 C
Scale 1" = 50'	Checked by SDS	Drawing No. 4D 032
Revisions - Date		