

PREPARED FOR
 THE CITY OF COLORADO SPRINGS
 BY
**THE LINCOLN DeVORE
 TESTING LABORATORY**

COLORADO : COLORADO SPRINGS, PUEBLO, GLENWOOD SPRINGS,
 MONTROSE, GUNNISON, GRAND JUNCTION
 WYOMING : ROCK SPRINGS

AUGUST, 1977

MONTEBELLO SANITARY SEWER
 DISTRICT DRAINAGE BOUNDARY
 FOR FLOW TRIBUTARY TO NEVADA
 AVENUE BY DREXEL BARRELL

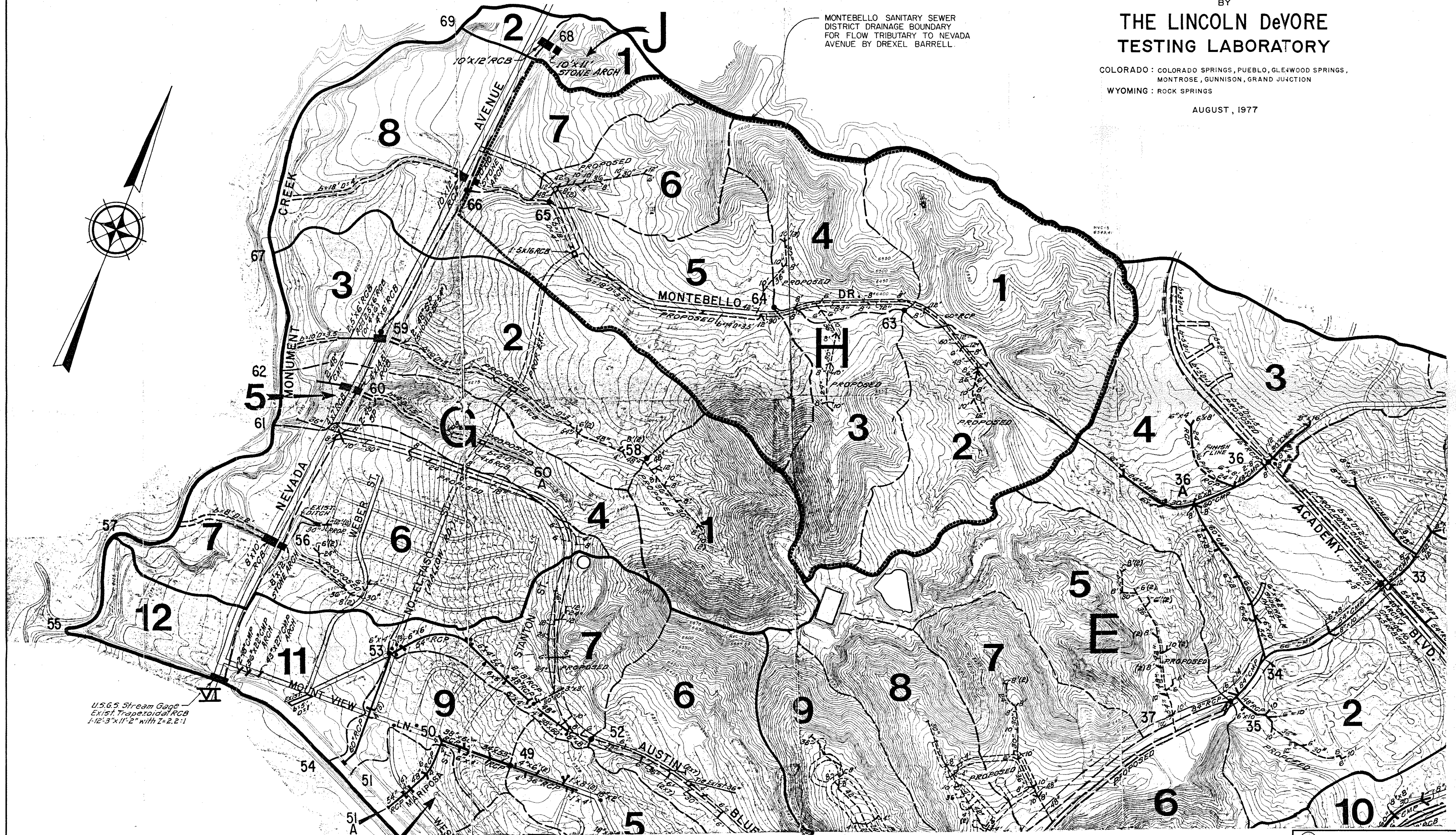

U.S.G.S Stream Gage
 Exist. Trapezoidal RCB
 1-12'3" x 11'-2" with I-2.2:1

DREXEL BARRELL & CO. ENGINEERS - SURVEYORS <small>100 10TH STREET 340 N. EL PASO STREET COLORADO SPRINGS, COLORADO 80901</small>		<small>DATE</small> 30 MAY 89	<small>PROJECT NO.</small> E-3745C
<small>SCALE</small> 1" = 500'		<small>DESIGNED BY</small> KA	<small>DRAWN BY</small> 4D065

TEMPLETON GAP MASTER DRAINAGE PLAN SEGMENT
 SHOWING
 MONTEBELLO SANITARY SEWER DISTRICT DRAINAGE BASIN