

**NEWPORT NORTH
MASTER DRAINAGE PLAN**

LEGEND

- IA — DRAINAGE BASIN LIMITS
- 25.2 — DRAINAGE BASIN NUMBER
- — RUNOFF IN C.F.S.
- — STORM SEWER - R.C.P. ALT. SHOWN
- — D-IOR CATCH BASIN " " "
- — BASIN I: R7, GROUP "A"
- — BASIN II: R5, GROUP "B"

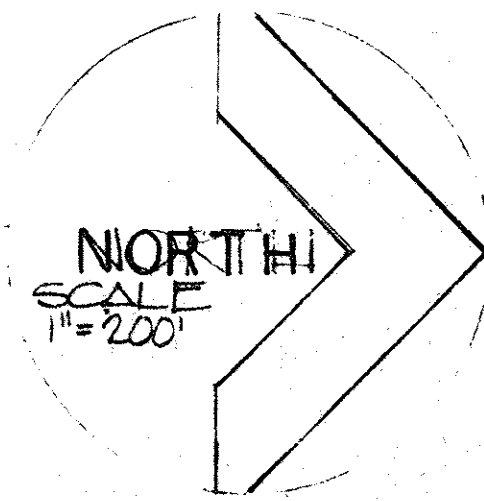

CONTOUR INT. : 2'

FOR OUTFALL POINTS SEE PIKES PEAK PANORAMA REPORT, COX II-2-71

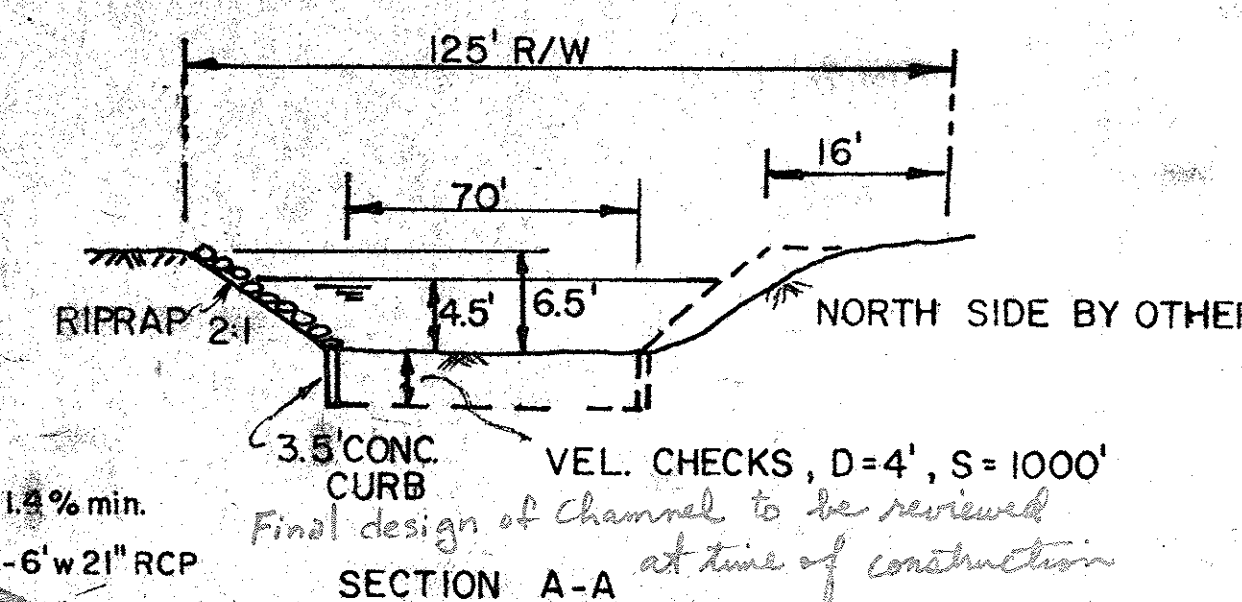
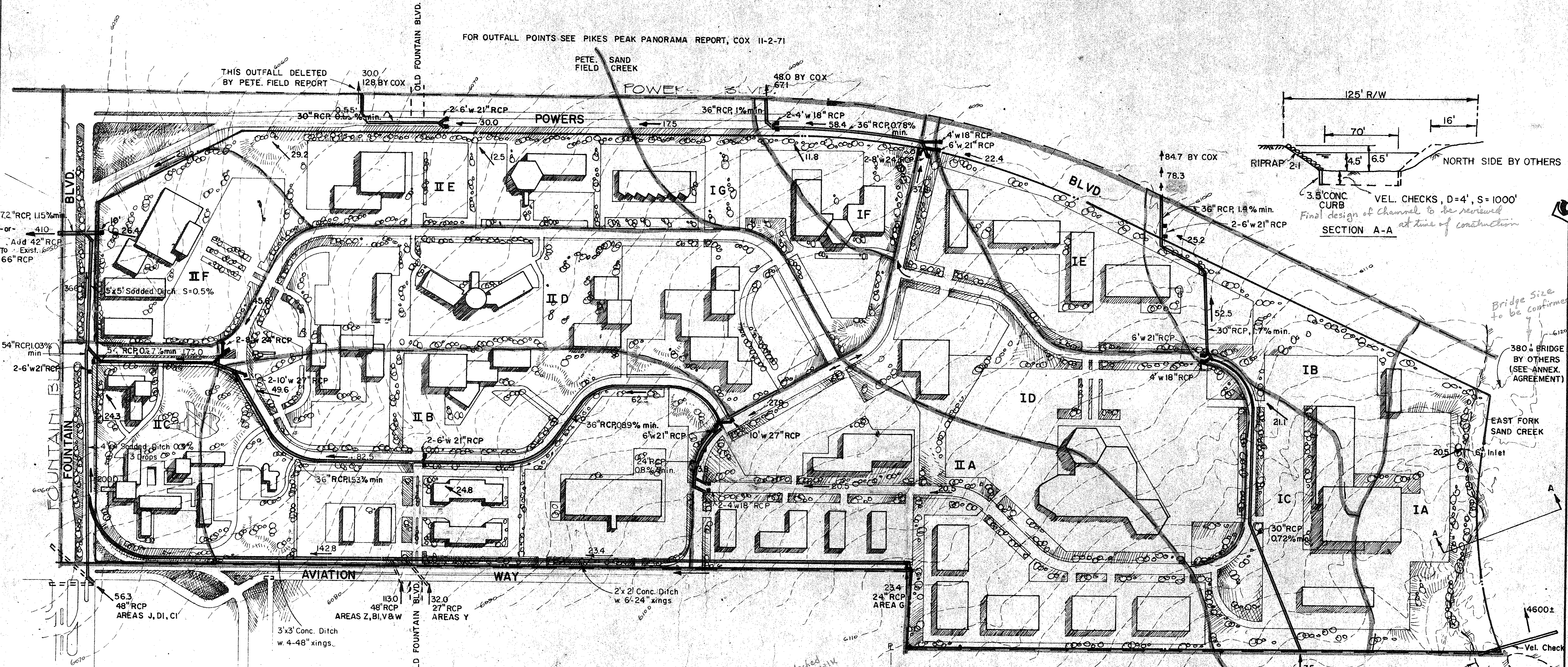

Bridge Size to be Confirmed
380± BRIDGE BY OTHERS (SEE ANNEX. AGREEMENT)

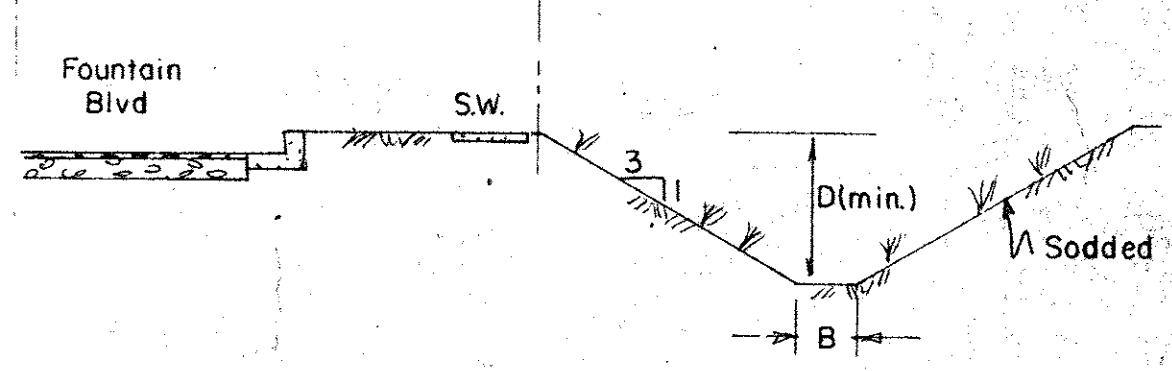

SODDED DITCH
Labled B x D

FOR INFLOWS SEE PETERSON FIELD REPORT R.K.HOOK JULY, 1973

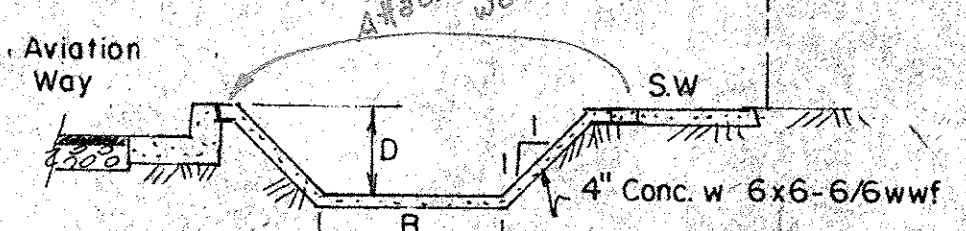

CONC. DITCH
Labled B x D

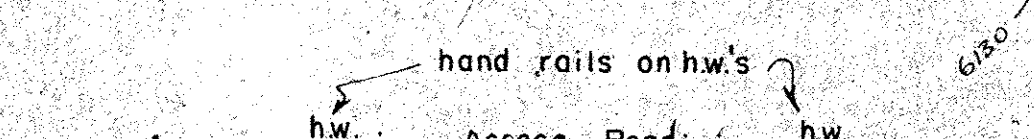

CONC. DITCH XING

Craddock
AT COLORADO SPRINGS

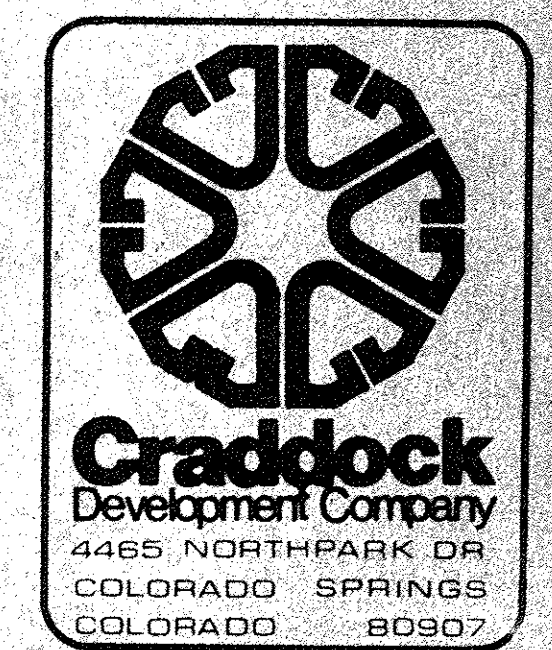

PROJECT
MASTER DRAINAGE

DATE
11-9-76
REV. 1, 2-8-77

SHEET
1
of
2

UNITED PLANNING & ENGINEERING CO.
76-1164

**NEWPORT SOUTH
MASTER DRAINAGE PLAN**

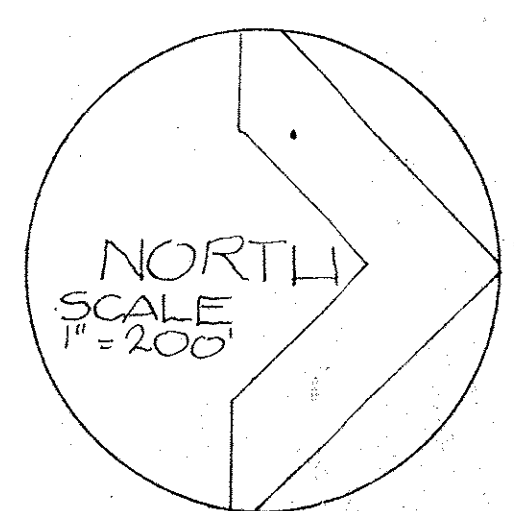

CONTOUR INTERVAL: 2'

LEGEND

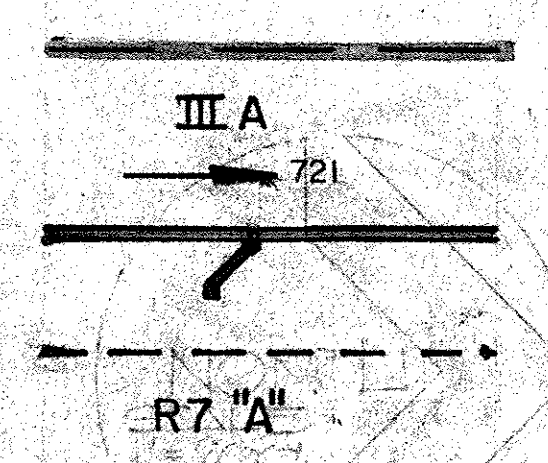

DRAINAGE BASIN BOUNDARY
DRAINAGE BASIN NUMBER
RUNOFF IN C.F.S.
STORM SEWER - R.C.P. - ALT. SHOWN
D-10R CATCH BASIN
SOIL TYPE BOUNDARY
SOIL TYPE & HYD. GROUP

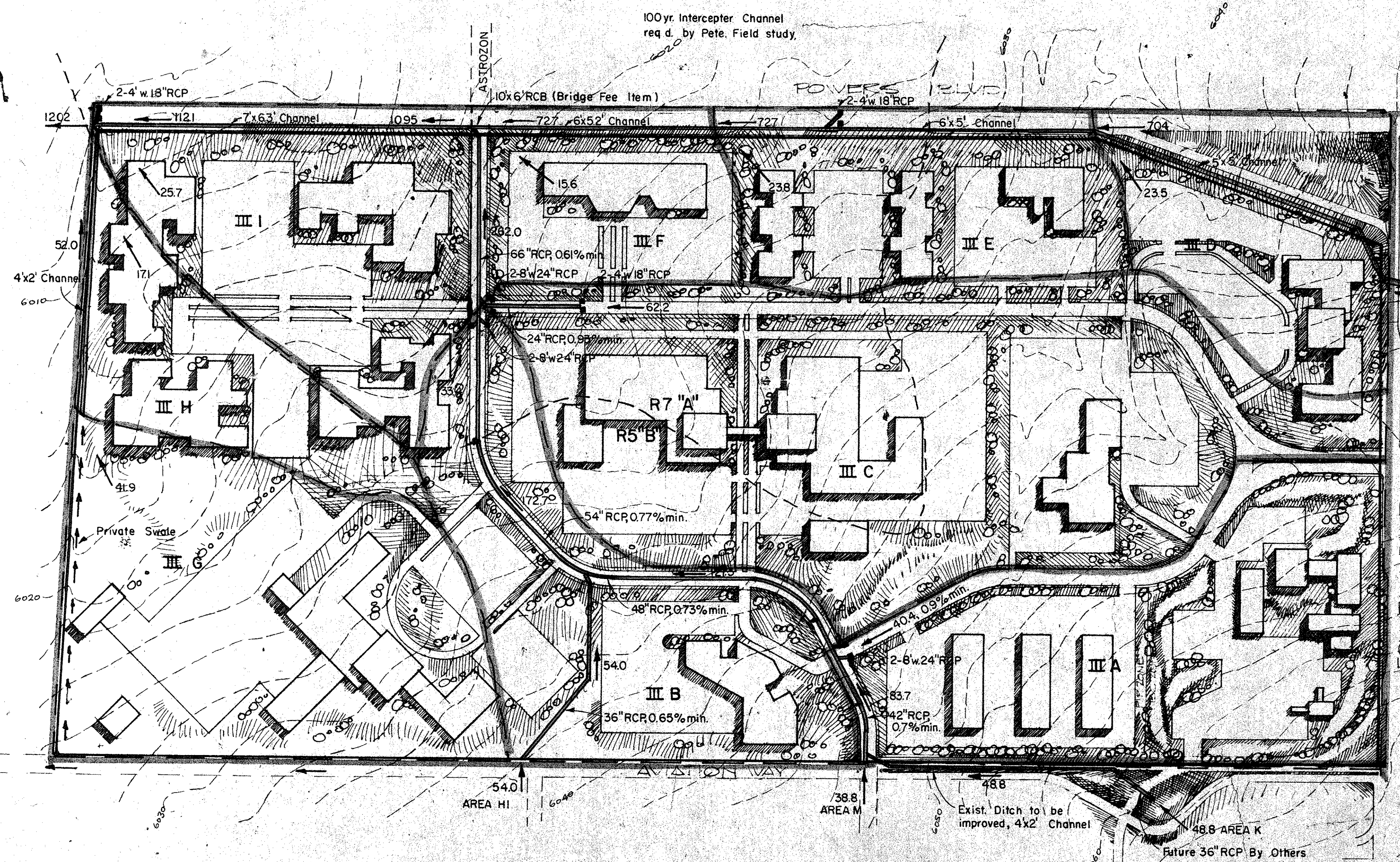

72" RCP (Bridge Fee)
or add 42" RCP
410 (50 yr)
63.4 (100 yr)

For Fountain Blvd. Storm Sewers
See NEWPORT NORTH Plan

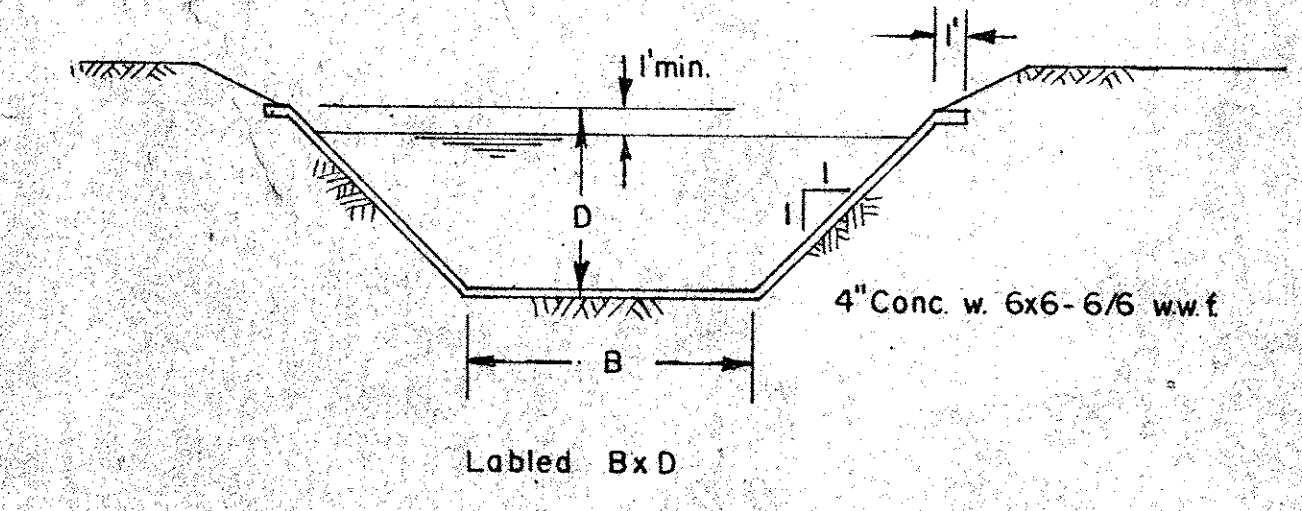

CHANNEL DETAIL

FOR INFLOWS SEE PETERSON FIELD STUDY
R. K. HOOK, JULY 1973

48.8 AREA K
Future 36" RCP By Others
AIR PORT PARKING
Exist. Ditch to be improved, 4x2' Channel

Craddock
AT COLORADO SPRINGS

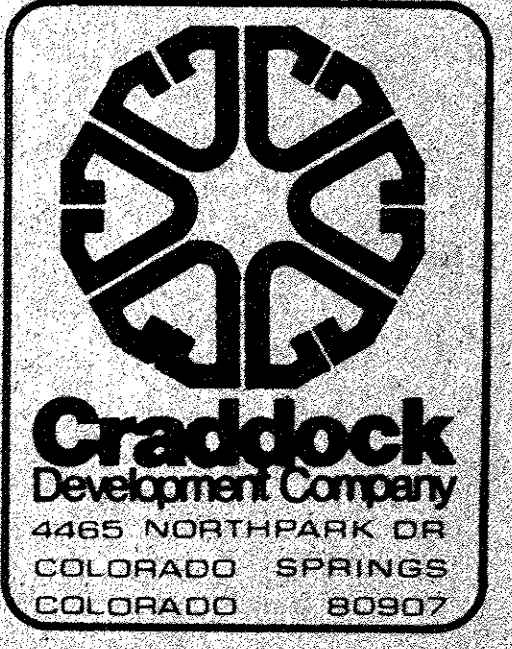

PROJECT
MASTER DRAINAGE

DATE
7-10-76
11-9-76
REV 1, 2-8-77

SHEET
2
OF
2

UNITED PLANNING & ENGR'G. CO.
76-1164