

MATCHLINE SEE AREA 2

NOTE:
 TOPOGRAPHY SHOWN ON THIS PLAN WAS
 TAKEN FROM FIMS DATA. DATE OF FLIGHT
 WAS 1989.
 POWERS BLVD. IMPROVEMENTS, FILING NO. 12
 DEVELOPMENT AND PROPOSED IMPROVEMENTS
 FOR FILINGS NO. 13 & NO. 14 WERE ADDED
 BASED ON AVAILABLE INFORMATION.

SCALE IN FEET: 1" = 100'

NO.	DATE	DESCRIPTION	BY
1	5/15/90	REVISIONS PER CITY OF COLORADO PER SPECIFICATIONS - RESPONSE TO INQUIRY ADDITIONAL SAND CREEK ACRES	KCH

THIS DOCUMENT IS THE EXCLUSIVE PROPERTY OF OBERING, WURTH & ASSOCIATES. ANY REPRODUCTION, MODIFICATION OR USE OF THIS DOCUMENT FOR OTHER THAN ITS ORIGINAL INTENT WITHOUT PRIOR CONSENT OF OBERING, WURTH & ASSOCIATES IS PROHIBITED.

ISSUED FOR
 FINAL
 APPROVAL
 8 AUG. 1997

PROJECT TITLE: MASTER DEVELOPMENT DRAINAGE PLAN

PREPARED BY: NEWPORT TECHNICAL CENTER

PREPARED BY: **Obering, Wirth & Associates**
 Consulting Civil Engineers
 Registered Land Surveyors
 1015 Elkton Drive
 Colorado Springs, Colorado
 Phone: (719) 531-6000

PROJECT NO.	N/A
SCALE:	1" = 100'
DATE:	AUG. 1997
DESIGNED BY:	KCH
DRAWN BY:	TLW/RGD
CHECKED BY:	RLC
PROJECT NO.:	96046
SHEET NO.:	1

PROJECT NAME: NEWPORT MDDP
 DRAWN BY: OBERING, WURTH & ASSOCIATES
 CHECKED BY: OBERING, WURTH & ASSOCIATES
 PROJECT NO.: 96046
 UPDATED VERSION: 08-08-97

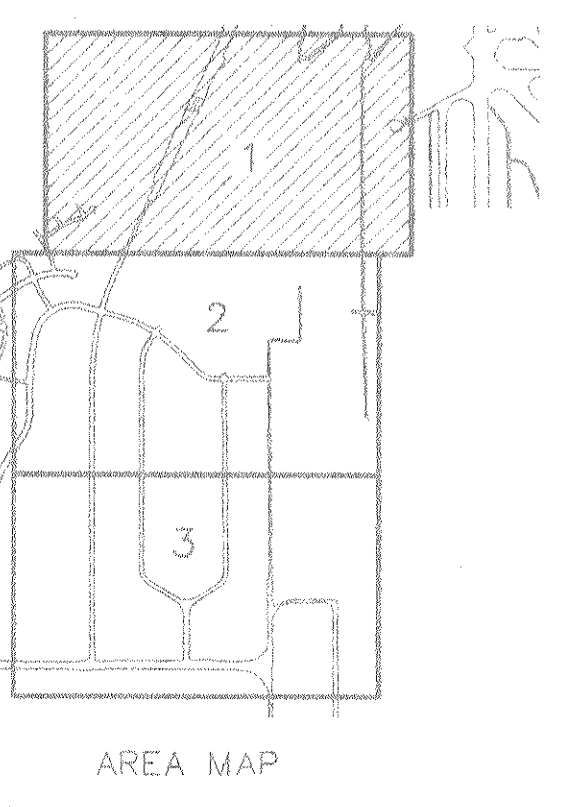

MATCHLINE SEE AREA 1



MATCHLINE SEE AREA 3

PROJECT NAME: NEWPORT MDCP
 DRAWN BY: OBERING, WURTH & ASSOC./RLC
 PROJECT NO.: 96046 UNREVISED VERSION: 08-08-97

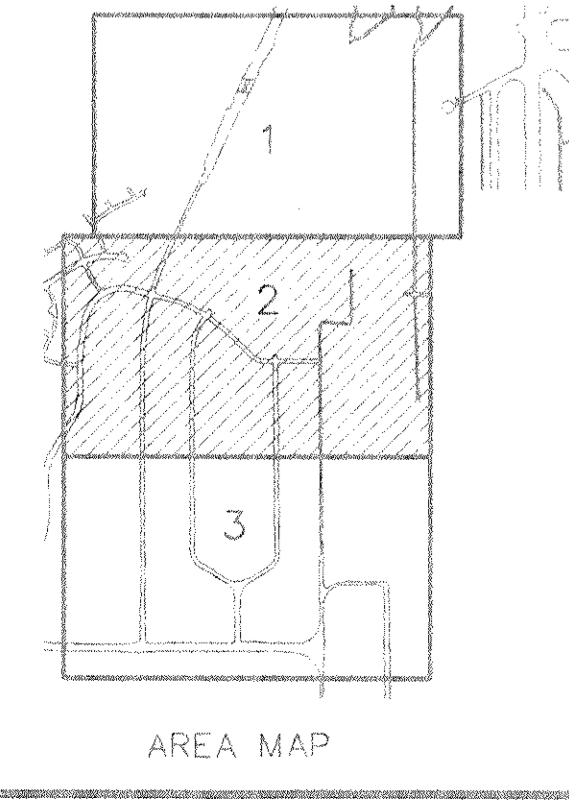

NOTE:
 TOPOGRAPHY SHOWN ON THIS PLAN WAS TAKEN FROM FIMS DATA. DATE OF FLIGHT WAS 1989.
 POWERS BLVD. IMPROVEMENTS, FILING NO. 12 DEVELOPMENT AND PROPOSED IMPROVEMENTS FOR FILINGS NO. 13 & NO. 14 WERE ADDED BASED ON AVAILABLE INFORMATION.

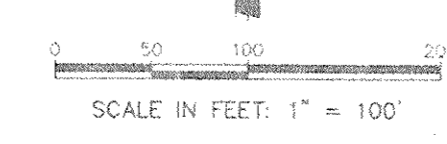

REVISIONS:	NO.	DATE	DESCRIPTION	BY
1	08/08/97		REVISED PER CITY OF COLORADO REQUIREMENTS - REVISIONS TO INCLUDE FUNCTIONAL STAMP, CREEK HOUSING	

THIS DOCUMENT IS THE EXCLUSIVE PROPERTY OF OBERING, WURTH & ASSOCIATES. ANY REPRODUCTION, MODIFICATION OR USE OF THIS DOCUMENT FOR OTHER THAN ITS ORIGINAL INTENT WITHOUT PRIOR CONSENT OF OBERING WURTH AND ASSOCIATES IS PROHIBITED.

ISSUED FOR FINAL APPROVAL
 8 AUG. 1997

MASTER DEVELOPMENT DRAINAGE PLAN		SHEET NO.: N/A SCALE: 1" = 100' DATE: AUG. 1997 DESIGNED BY: KSA CHECKED BY: T.W./RSD DRAWN BY: RLC
NEWPORT TECHNICAL CENTER		PROJECT NO.: 96046 SHEET NO.: 2
PREPARED BY: Obering, Wirth & Associates Consulting Civil Engineers Registered Land Surveyors 1015 Dixon Drive Colorado Springs, Colorado Phone (719) 531-6200		

