



UNTIL SUCH TIME AS THESE DRAWINGS ARE APPROVED BY THE APPROPRIATE REVIEWING AGENCIES, JR ENGINEERING APPROVES THEIR USE ONLY FOR THE PURPOSES DESIGNATED BY WRITTEN AUTHORIZATION.

PREPARED FOR
HIGH VALLEY LAND COMPANY
 1755 TELSTAR DR, SUITE 211
 COLORADO SPRINGS, CO 80920
 CONTACT:
 ANGELA ESSING
 AESSING@LAPLATACOMMUNITIES.COM

J-R ENGINEERING
 A Western Company
 Central 303-440-8888 • Colorado Springs 719-595-2593
 Fort Collins 970-491-8888 • www.jrengineering.com

| No. | REVISION | BY | DATE |
|-----|----------|----|------|
| | | | |
| | | | |
| | | | |
| | | | |
| | | | |
| | | | |
| | | | |
| | | | |
| | | | |

| H-Scale | V-Scale | DATE | DESIGNED BY | DRAWN BY | CHECKED BY |
|-----------|---------|---------|-------------|----------|------------|
| 1" = 300' | N/A | 5/28/14 | SMB | CEB | |

MASTER DEVELOPMENT DRAINAGE PLAN
NORTH FORK AT BRIARGATE
DRAINAGE EXHIBIT
HISTORIC CONDITION

SUB-BASIN DATA SUMMARY
HISTORIC CONDITION

| SUB BASIN ID | AREA (sq miles) | AREA (acres) | PERCENT IMPERVIOUS | TOTR TIME TO PEAK (MIN.) | Q2 (cfs) | Q5 (cfs) | Q10 (cfs) | Q25 (cfs) | Q50 (cfs) | Q100 (cfs) |
|--------------|-----------------|--------------|--------------------|--------------------------|----------|----------|-----------|-----------|-----------|------------|
| *OS1 | 0.021 | 13.3 | 31.3 | 34 | 39 | 6 | 11 | 15 | 25 | 31 |
| *OS2 | 0.027 | 17.2 | 6.3 | 42 | 49 | 1 | 5 | 7 | 17 | 21 |
| OS3 | 0.229 | 146.6 | 5.2 | 47 | 54 | 7 | 35 | 55 | 125 | 176 |
| OS4 | 0.020 | 12.9 | 6.0 | 39 | 45 | 1 | 4 | 6 | 14 | 17 |
| OS5 | 0.041 | 26.3 | 1.5 | 39 | 44 | 1 | 8 | 13 | 31 | 39 |
| *H1 | 0.053 | 33.6 | 10.0 | 34 | 38 | 5 | 20 | 29 | 59 | 73 |
| H2 | 0.079 | 50.8 | 1.5 | 49 | 58 | 1 | 9 | 15 | 36 | 45 |
| H3 | 0.276 | 177.2 | 1.2 | 51 | 59 | 2 | 32 | 54 | 131 | 165 |
| H4 | 0.017 | 11.0 | 1.5 | 36 | 40 | 1 | 5 | 7 | 16 | 20 |

NOTE: VALUES PRESENTED WITH RUNOFF SUMMARY WERE GENERATED USING THE COLORADO UNIT HYDROGRAPH PROCEDURE
 *SUBCATCHMENTS ANALYZED WITH THE "KETTLE CREEK DRAINAGE BASIN
 OLD RANCH ROAD MASTER DEVELOPMENT DRAINAGE PLAN", BY JR ENGINEERING, 2001.

DESIGN POINT DATA SUMMARY
HISTORIC CONDITION

| DESIGN POINT | WATERSHED AREA (acres) | AREA (sm) | Q2 (cfs) | Q5 (cfs) | Q10 (cfs) | Q25 (cfs) | Q50 (cfs) | Q100 (cfs) | POINT DESCRIPTION |
|--------------|------------------------|-----------|----------|----------|-----------|-----------|-----------|------------|---|
| 1 | 13.3 | 0.021 | 6 | 11 | 15 | 25 | 31 | 34 | OS1 RUNOFF INTO ORR |
| 2 | 17.2 | 0.027 | 1 | 5 | 7 | 17 | 21 | 23 | OS2 RUNOFF ACROSS HOWELLS |
| *3 | 64.1 | 0.100 | 11 | 33 | 47 | 95 | 117 | 130 | OS1, OS2, & H1 RUNOFF COMBINE AT EX. 48" CULVERT CROSSING |
| 3a | 64.1 | 0.100 | 11 | 33 | 47 | 95 | 117 | 130 | EX. 48" CULVERT CROSSING DISCHARGE |
| 4 | 146.6 | 0.229 | 7 | 35 | 55 | 125 | 155 | 176 | OS3 RUNOFF ACROSS HOWELLS |
| 5 | 197.4 | 0.308 | 6 | 40 | 65 | 456 | 196 | 223 | OS3 & H2 RUNOFF COMBINE, CONVEY NORTH ALONG POWERS FILL SLOPE |
| 6 | 12.5 | 0.020 | 1 | 4 | 6 | 14 | 17 | 19 | OS4 RUNOFF ACROSS HOWELLS |
| 7 | 439.7 | 0.687 | 7 | 69 | 119 | 303 | 385 | 445 | OS3, H2, OS4, H3, & OS5 RUNOFF COMBINE |
| 7a | 439.7 | 0.687 | 7 | 69 | 119 | 303 | 385 | 445 | DP 7 DISCHARGE |
| 8 | 11.0 | 0.017 | 1 | 5 | 7 | 16 | 20 | 23 | H4 RUNOFF CONVEYS NORTH, OFFSITE |

*DESIGN POINT EVALUATED WITH THE "KETTLE CREEK DRAINAGE BASIN
 OLD RANCH ROAD MASTER DEVELOPMENT DRAINAGE PLAN", BY JR ENGINEERING, 2001.

OFF SITE PROPERTY OWNER INFORMATION

| PROPERTY POINT | OWNERS NAME | SCHEDULE NUMBER |
|----------------|-------------------------------|-----------------|
| 1 | OLD RANCH ROAD PROPERTIES LLC | 6223000061 |
| 2 | OLD RANCH ROAD PROPERTIES LLC | 6223000059 |
| 3 | MONICA PHELAN | 6223000058 |
| 4 | CARALYN AND DORIS BARLOW | 6223000101 |
| 5 | LARRY AND MELISSA PAINTER | 6223000029 |
| 6 | ROCKFORD & MARGO MANNING | 6223000080 |
| 7 | 10975 HOWELLS RD LLC | 6223000116 |
| 8 | STEVEN AND THERESA MARKEL | 6223000026 |
| 9 | PETER AND ULLA BERGH | 6223000063 |
| 10 | CONLETH AND HELEN KENNEDY | 6223000095 |

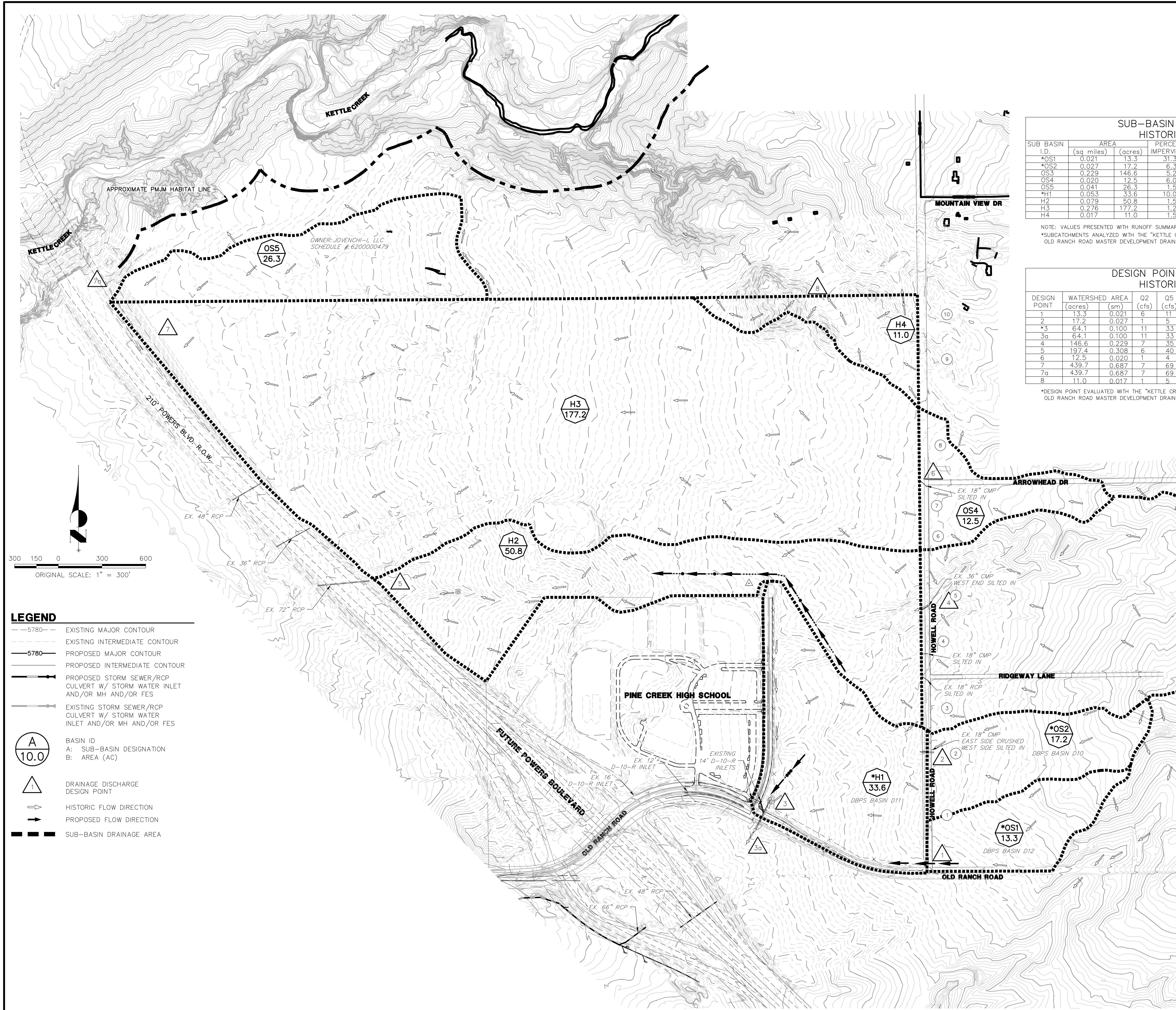

LEGEND

- 5780--- EXISTING MAJOR CONTOUR
- 5780--- EXISTING INTERMEDIATE CONTOUR
- 5780--- PROPOSED MAJOR CONTOUR
- 5780--- PROPOSED INTERMEDIATE CONTOUR
- PROPOSED STORM SEWER/RCP CULVERT W/ STORM WATER INLET AND/OR MH AND/OR FES
- EXISTING STORM SEWER/RCP CULVERT W/ STORM WATER INLET AND/OR MH AND/OR FES
- ⊙ A 10.0 ⊙ BASIN ID
A: SUB-BASIN DESIGNATION
B: AREA (AC)
- ⚠ DRAINAGE DISCHARGE DESIGN POINT
- HISTORIC FLOW DIRECTION
- PROPOSED FLOW DIRECTION
- SUB-BASIN DRAINAGE AREA

300 150 0 300 600
 ORIGINAL SCALE: 1" = 300'



Know what's below.
 Call before you dig.