

BASIN	AREA (AC)	Q5 (cfs)	Q100 (cfs)
E1	31.10	8.7	67.8
E2	1.37	0.3	2.7
E3	2.46	0.6	4.9
E4	10.98	2.9	22.3
E5	21.59	6.6	51.4
OS-1	4.56	8.0	19.0
OS-2	1.01	2.9	6.2

DP	AREA (AC)	Q5 (cfs)	Q100 (cfs)
DP-1	31.10	8.7	67.8
DP-2	1.37	0.3	2.7
DP-3	2.46	0.6	4.9
DP-4	10.98	2.9	22.3
DP-5	21.59	6.6	51.4
DP-6	4.56	8.0	19.0
DP-7	1.01	2.9	6.2

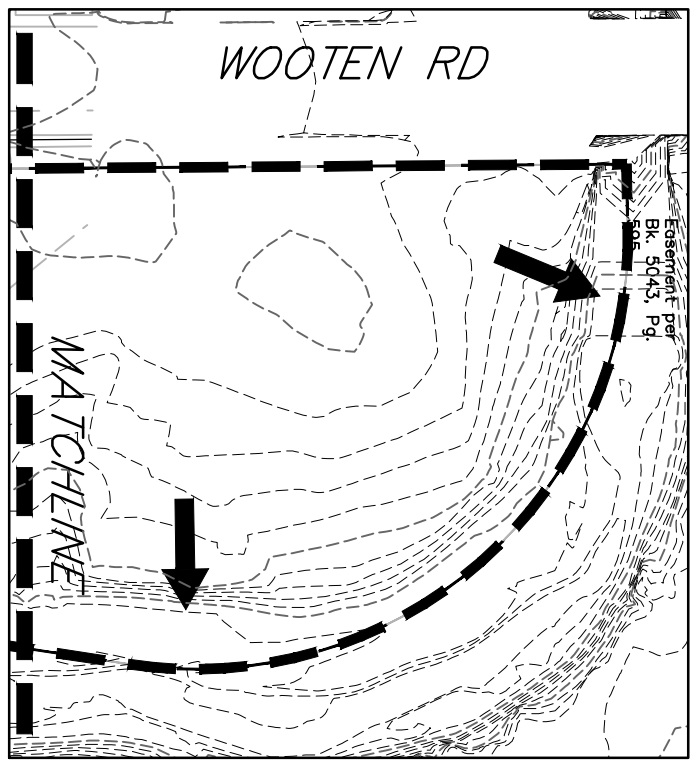
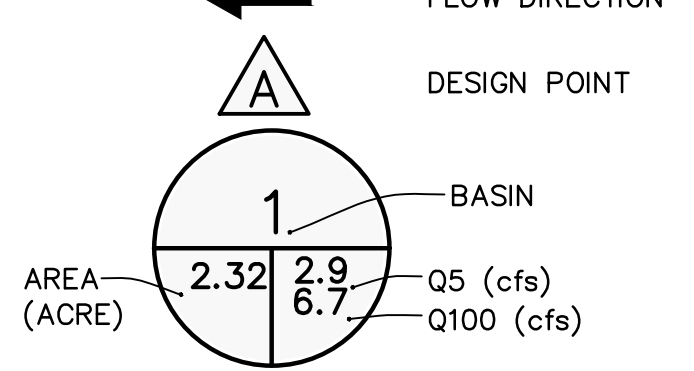

PREPARED BY:

DREXEL, BARRELL & CO.
 Engineers • Surveyors
 3 SOUTH 7TH STREET
 COLORADO SPRINGS, COLORADO 80905
 CONTACT: TIM D. MCCONNELL, P.E.
 (719) 266-0887
 BOULDER • COLORADO SPRINGS • GREELY

CLIENT:
PIKES PEAK HEIGHTS LLC.

SCHUCK COMMUNITIES
 CO/SCHUCK COMMUNITIES, INC.
 2 N. CASCADE AVE. #1250
 COLORADO SPRINGS CO, 80903
 (719) 533-4500
 CONTACT: DENNIS MINCHOW, PM
 dnm@schuckcommunities.com

DRAINAGE PLAN FOR
PIKES PEAK HEIGHTS
 COLORADO SPRINGS, COLORADO

ISSUE	DATE
INITIAL ISSUE	6-19-18
RESUBMITTAL	7-25-19
DESIGNED BY:	SBN
DRAWN BY:	SBN
CHECKED BY:	TDM
FILE NAME:	21150-01DR MAP

PREPARED UNDER MY DIRECT SUPERVISION FOR AND ON BEHALF OF DREXEL, BARRELL & CO.
 DRAWING SCALE:
 HORIZONTAL: 1" = 100'
 VERTICAL: N/A

EXISTING DRAINAGE PLAN
 PROJECT NO. 21102-02CSCV
 DRAWING NO.

EX1
 SHEET: 1 OF 2