

RIDGEVIEW SUBDIVISION EASTERLY PORTION

CITY OF COLORADO SPRINGS, COUNTY OF EL PASO, STATE OF COLORADO

MASTER DEVELOPMENT DRAINAGE PLAN AMENDMENT NO. II

DECEMBER 2002

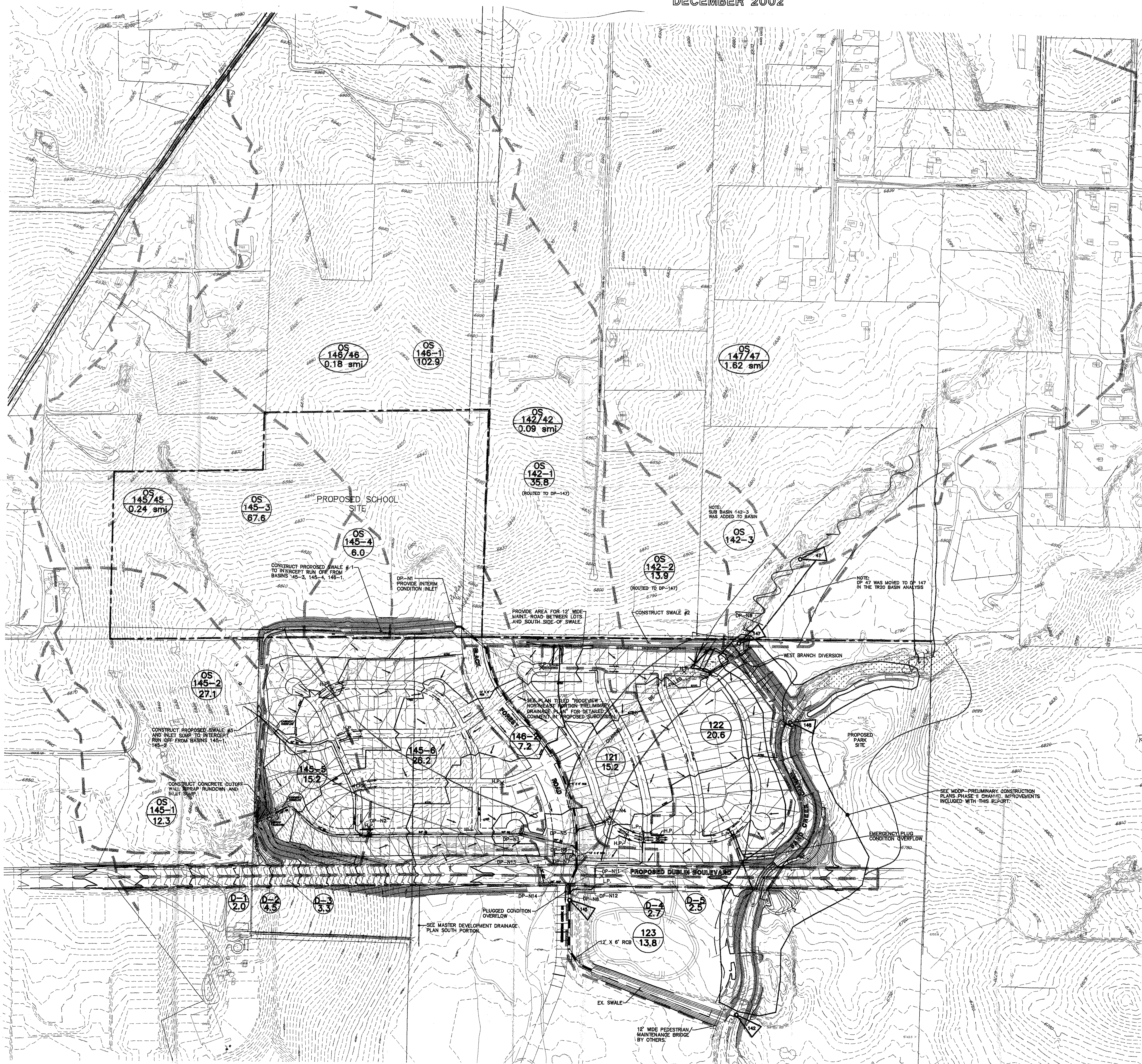

DBPS BASIN	SUB-BASIN	AREA	C _p	C _u	Q ₁₀₀	Q ₁₀
42	121	15.2	0.50	0.60	26	52
42	122	20.6	0.50	0.60	34	69
42	123	13.8	0.56	0.66	27	55
142	142-1	35.8	0.25	0.35	25	58
142	142-2	13.9	0.25	0.35	10	24
145	145-1	12.3	0.50	0.60	20	41
145	145-2	27.1	0.39	0.49	38	81
145	145-3	67.6	0.64	0.70	140	258
145	145-4	6.0	0.58	0.68	13	27
145	145-5	15.2	0.47	0.57	25	51
145	145-6	26.2	0.50	0.60	42	84
146	146-1	102.9	0.48	0.54	149	279
146	146-2	7.2	0.68	0.78	20	39
145	D-1	2.0	0.50	0.60	4	7
145	D-2	4.5	0.72	0.78	14	27
145	D-3	3.30	0.83	0.87	12	22
41/42	D-4	2.70	0.83	0.87	9	17
41/42	D-5	2.50	0.83	0.87	8	16

DESIGN POINT	TOTAL AREA (A ²)	DESIGN Q ₁₀ cfs	DESIGN Q ₁₀₀ cfs
DP-N1	178.5	290	537
DP-N2	54.6	82	170
DP-N3	80.8	115	235
DP-N4	7.6	13	26
DP-N5	164.1	269	536
DP-N6	264.9	395	751
DP-N7	272.1	408	774
DP-N8	294.7	450	851
DP-N9	49.7	57	117
DP-N10	7.6	13	26
DP-N11	10.3	20	39
DP-N12	12.8	27	50
DP-N13	6.5	18	34
DP-N14	9.8	29	55

⊕ COMPARED TO 853 cfs AT DP145 PREVIOUS MDDP (1999) TR 20 ANALYSIS
⊙ COMPARED TO 93 cfs PREVIOUS MDDP (1999)

ANALYSIS POINT	CONTRIBUTING AREA ACRES	M ²	PREDICTED PEAK FLOW RATES (cfs)			
			FULLY DEVELOPED Q ₁₀ cfs	FULLY DEVELOPED Q ₁₀₀ cfs	INTERIM Q ₁₀ cfs	INTERIM Q ₁₀₀ cfs
145	301	0.47	447	853	165	430
147	1,037	1.62	283	644	164	661
148	5,357	8.37	821	2,633	811	3,134
142	5,734	8.96	1,074	2,698	833	3,239

- LEGEND**
- EXISTING CONTOUR
 - PROPOSED CONTOUR
 - PROPOSED INLET LOCATION AND OUTFALL PIPE
 - BASIN BOUNDARY CURRENT MDDP
 - BASIN IDENTIFIER
 - AREA IN SQ. MILES
 - SUB-BASIN IDENTIFIER
 - SUB - AREA IN ACRES
 - DENOTES OFFSITE BASIN
 - SUB-BASIN IDENTIFIER
 - SUB - AREA IN ACRES
 - DIRECTION OF PROPOSED SURFACE DRAINAGE
 - HYDROLOGIC DESIGN POINT TR20 ANALYSIS
 - RATIONAL METHOD ROUTING DESIGN POINT

GENERAL NOTES:
FUTURE STORM DRAINS SHOWN ON THIS PLAN ARE ONLY INTENDED TO INDICATE GENERAL LOCATIONS AND APPROXIMATE SIZES OF FUTURE FACILITIES. ACTUAL STORM DRAIN SIZES AND LOCATIONS SHALL BE DETERMINED WITH MORE DETAILED ANALYSIS AT THE TIME OF DETAILED DESIGN OF THE FACILITIES. IT IS LIKELY THAT ADDITIONAL FACILITIES NOT SHOWN ON THIS PLAN WILL BE REQUIRED.
THE REQUIRED EASEMENTS FOR DRAINAGE FACILITIES SHALL BE INDICATED ON FINAL DRAINAGE PLANS WHEN THE EXACT ROUTINGS ARE KNOWN.

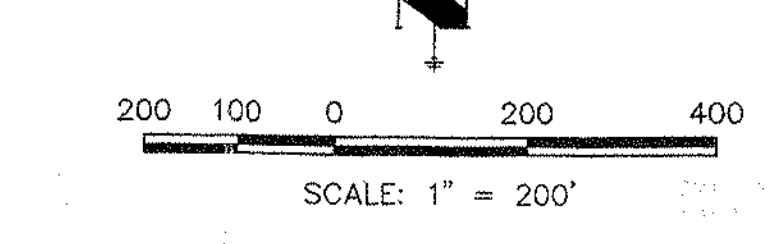

UNTIL SUCH TIME AS THESE DRAWINGS ARE APPROVED BY THE APPROPRIATE REVIEWING AGENCIES, J.R. ENGINEERING APPROVES THEIR USE ONLY FOR THE PURPOSES AUTHORIZATION.

PREPARED FOR
RIDGEVIEW DEVELOPMENT, LLC
102 S. TEJON STREET
SUITE 1100
COLORADO SPRINGS, CO 80903
719-578-3325

J.R. ENGINEERING
A Subsidiary of Westair
430 ArrowsWest Drive • Colorado Springs, CO 80907
719-583-5530 • Fax: 719-528-4683
www.jrengineering.com

BY	DATE	NO.	REVISION	H-SCALE	V-SCALE	DATE	DESIGNED BY	DRAWN BY	CHECKED BY
				1"=200'	N/A	12/23/02	JRB	JLH	

RIDGEVIEW MDD AMENDMENT NO. II

MASTER DEVELOPMENT DRAINAGE PLAN
NORTH PORTION

SHEET 1 OF 2

JOB NO. 29104.90