

# REIMBURSABLE COST AMENDMENT RIDGEVIEW AT STETSON HILLS

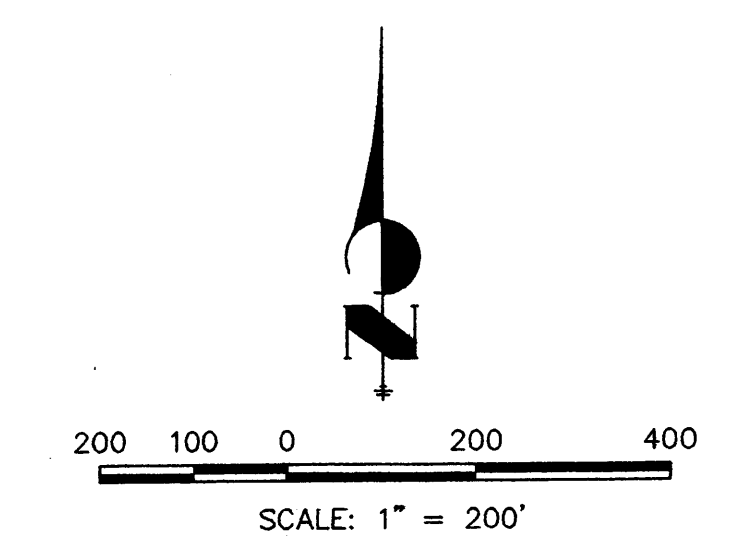
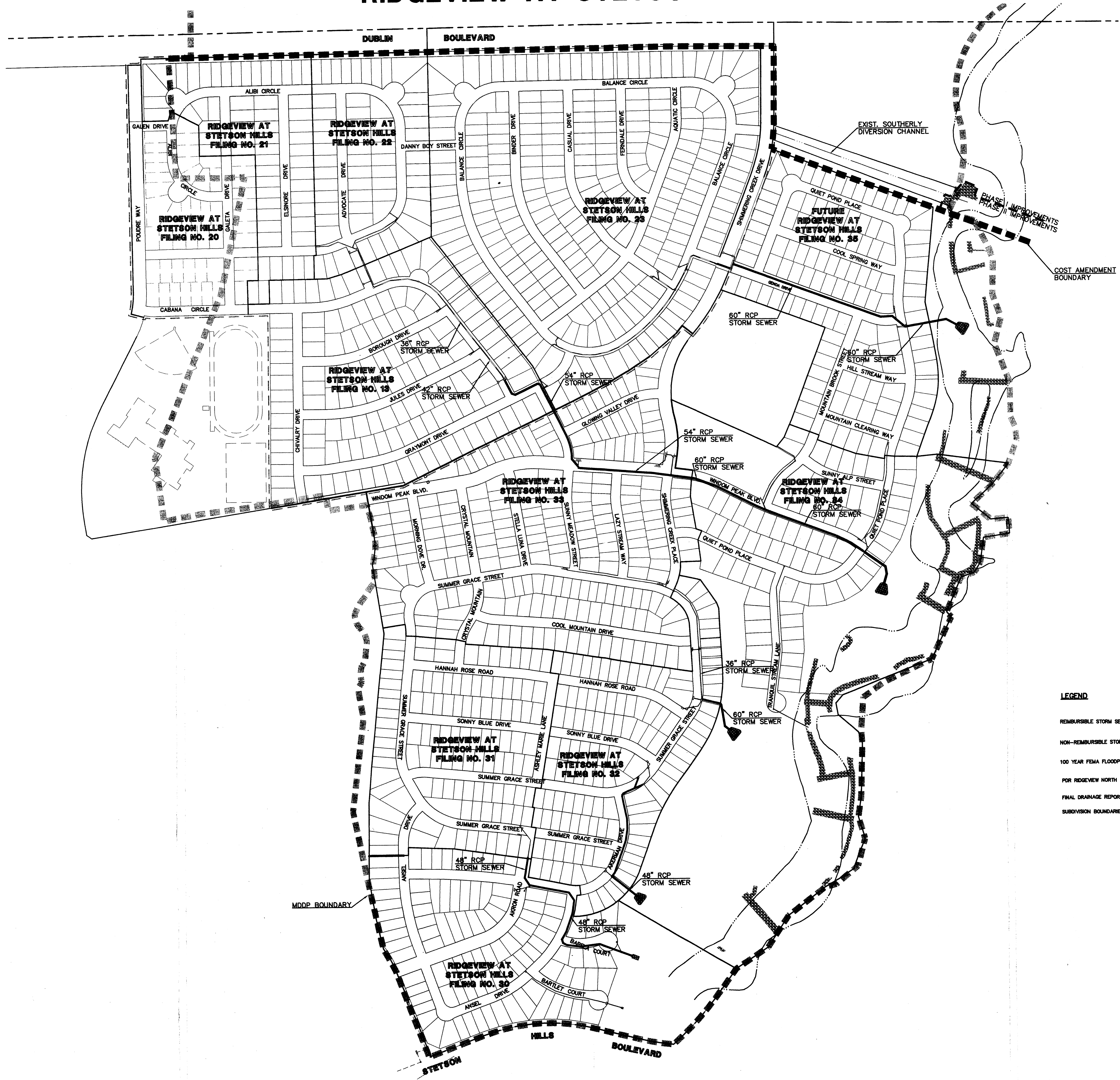

- LEGEND**
- REIMBURSABLE STORM SEWER
  - NON-REIMBURSABLE STORM SEWER
  - 100 YEAR FEMA FLOODPLAIN
  - FOR RIDGEVIEW NORTH BOUNDARY
  - FINAL DRAINAGE REPORT BOUNDARIES
  - SUBDIVISION BOUNDARIES

RIDGEVIEW AT STETSON HILLS  
REIMBURSABLE COST AMENDMENT  
JOB NO. 9104.90  
SHEET 1 OF 1

**J-R ENGINEERING**  
A Subsidiary of Wootton  
430 Arroyo West Drive • Colorado Springs, CO 80907  
719-539-2538 • Fax: 719-528-6653 • www.jrengineering.com