

# RIDGEVIEW SUBDIVISION (EASTERLY PORTION) CITY OF COLORADO SPRINGS, COUNTY OF EL PASO, STATE OF COLORADO MASTER DEVELOPMENT DRAINAGE PLAN

NOVEMBER 1999

BASIN	SUB-BASIN	AREA	C <sub>s</sub>	C <sub>100</sub>	Q <sub>5</sub>	Q <sub>100</sub>
127	127-A	16.8	0.60	0.70	33	66
127	127-B	6.7	0.60	0.70	14	28
127	127-C	7.7	0.60	0.70	15	30
127	127-D	3.0	0.60	0.70	6	13
127	127-E	12.6	0.60	0.70	24	48
126	126-A	14.4	0.60	0.70	29	57
126	126-B	11.9	0.53	0.62	20	39
126	126-C	9.3	0.53	0.62	19	38
126	126-D	3.8	0.25	0.35	3	8
128	128-A	6.8	0.60	0.70	14	28
143	143-A	65.2	0.60	0.70	120	234
143	143-B	11.5	0.60	0.70	23	44
143	143-C	57.4	0.56	0.69	98	203
143	143-D	5.2	0.60	0.70	11	21
143	143-E	7.2	0.60	0.70	15	30
143	143-F	13.8	0.60	0.70	23	44
124	124-A	15.2	0.60	0.70	31	60
125	125-A	20.3	0.60	0.70	40	79
140	140-A	170.6	0.50	0.60	211	414
140	140-B	5.5	0.90	0.90	22	39
140	140-C	19.3	0.60	0.70	37	72
139	139-A	57.6	0.60	0.70	96	184
139	139-B	5.4	0.90	0.90	24	43
139	139-C	15.8	0.65	0.75	37	73
139	139-D	4.6	0.75	0.85	18	37
139	139-E	9.4	0.60	0.70	22	43
137	137-A	15.6	0.60	0.70	30	58
137	137-B	15.7	0.60	0.70	30	59
137	137-C	12.1	0.60	0.70	24	47
137	137-D	5.3	0.90	0.90	23	41

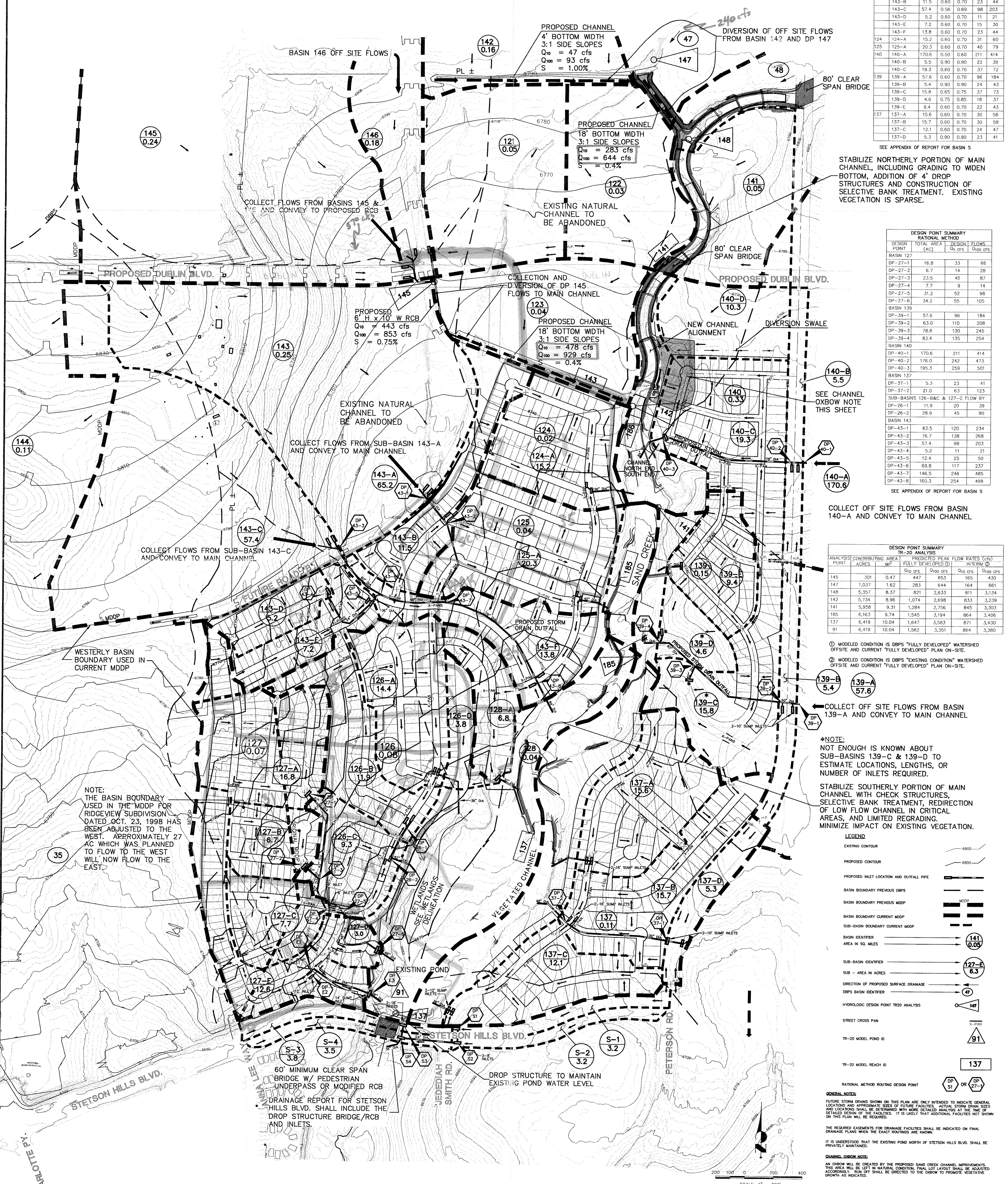

STABILIZE NORTHERLY PORTION OF MAIN CHANNEL, INCLUDING GRADING TO WIDEN BOTTOM, ADDITION OF 4' DROP STRUCTURES AND CONSTRUCTION OF SELECTIVE BANK TREATMENT. EXISTING VEGETATION IS SPARSE.

DESIGN POINT	TOTAL AREA (AC)	DESIGN Q <sub>5</sub> (cfs)	DESIGN Q <sub>100</sub> (cfs)
BASIN 127			
DP-27-1	16.8	33	66
DP-27-2	6.7	14	28
DP-27-3	23.5	45	87
DP-27-4	7.7	9	14
DP-27-5	31.2	52	98
DP-27-6	34.2	55	105
BASIN 139			
DP-39-1	57.6	96	184
DP-39-2	63.0	110	208
DP-39-3	78.8	130	245
DP-39-4	83.4	135	254
BASIN 140			
DP-40-1	170.6	211	414
DP-40-2	176.0	242	473
DP-40-3	195.3	259	501
BASIN 143			
DP-43-1	62.5	120	234
DP-43-2	76.7	138	268
DP-43-3	57.4	98	203
DP-43-4	5.2	11	21
DP-43-5	12.4	25	50
DP-43-6	69.8	117	237
DP-43-7	146.5	246	485
DP-43-8	160.3	254	498

ANALYSIS POINT	CONTRIBUTING AREA (AC)	PREDICTED PEAK FLOW RATES (cfs)				
		FULLY DEVELOPED	INTERFERED			
		Q <sub>5</sub> cfs	Q <sub>100</sub> cfs			
145	301	0.47	447	853	165	430
147	1,037	1.62	283	644	164	661
148	5,357	8.37	821	2,633	811	3,134
142	5,734	8.96	1,074	2,698	833	3,239
141	5,858	9.31	1,284	2,756	845	3,303
185	6,163	9.74	1,545	3,194	864	3,406
137	6,419	10.04	1,647	3,583	871	3,430
91	6,419	10.04	1,562	3,351	864	3,380

NOTE: THE BASIN BOUNDARY USED IN THE MDDP FOR RIDGEVIEW SUBDIVISION DATED OCT. 23, 1998 HAS BEEN ADJUSTED TO THE WEST. APPROXIMATELY 27 AC WHICH WAS PLANNED TO FLOW TO THE WEST WILL NOW FLOW TO THE EAST.

① MODELED CONDITION IS DBPS "FULLY DEVELOPED" WATERSHED OFFSITE AND CURRENT "FULLY DEVELOPED" PLAN ON-SITE.  
② MODELED CONDITION IS DBPS "EXISTING CONDITION" WATERSHED OFFSITE AND CURRENT "FULLY DEVELOPED" PLAN ON-SITE.

\*NOTE: NOT ENOUGH IS KNOWN ABOUT SUB-BASINS 139-C & 139-D TO ESTIMATE LOCATIONS, LENGTHS, OR NUMBER OF INLETS REQUIRED.

STABILIZE SOUTHERLY PORTION OF MAIN CHANNEL WITH CHECK STRUCTURES, SELECTIVE BANK TREATMENT, REDIRECTION OF LOW FLOW CHANNEL IN CRITICAL AREAS, AND LIMITED REGRADING. MINIMIZE IMPACT ON EXISTING VEGETATION.

- LEGEND**
- EXISTING CONTOUR
  - PROPOSED CONTOUR
  - PROPOSED INLET LOCATION AND OUTFALL PIPE
  - BASIN BOUNDARY PREVIOUS DBPS
  - BASIN BOUNDARY PREVIOUS MDDP
  - BASIN BOUNDARY CURRENT MDDP
  - SUB-BASIN BOUNDARY CURRENT MDDP
  - BASIN IDENTIFIER AREA IN SQ. MILES
  - SUB-BASIN IDENTIFIER
  - SUB - AREA IN ACRES
  - DIRECTION OF PROPOSED SURFACE DRAINAGE
  - DBPS BASIN IDENTIFIER
  - HYDROLOGIC DESIGN POINT TR-20 ANALYSIS
  - STREET CROSS PAN
  - TR-20 MODEL POND ID
  - TR-20 MODEL REACH ID
  - RATIONAL METHOD ROUTING DESIGN POINT

**GENERAL NOTES:**  
FUTURE STORM DRAINAGE SHOWN ON THIS PLAN ARE ONLY INTENDED TO INDICATE GENERAL LOCATIONS AND APPROXIMATE SIZES OF FUTURE FACILITIES. ACTUAL STORM DRAIN SIZES AND LOCATIONS SHALL BE DETERMINED WITH MORE DETAILED ANALYSIS AT THE TIME OF DETAILED DESIGN OF THE FACILITIES. IT IS UNLIKELY THAT ADDITIONAL FACILITIES NOT SHOWN ON THIS PLAN WILL BE REQUIRED.  
THE REQUIRED EASEMENTS FOR DRAINAGE FACILITIES SHALL BE INDICATED ON FINAL DRAINAGE PLANS WHEN THE EXACT ROUTINGS ARE KNOWN.  
IT IS UNDERSTOOD THAT THE EXISTING POND NORTH OF STETSON HILLS BLVD. SHALL BE PRIVATELY MAINTAINED.  
**CHANNEL OXBOW NOTE:**  
AN OXBOW WILL BE CREATED BY THE PROPOSED SAND CREEK CHANNEL IMPROVEMENTS. THIS AREA WILL BE LEFT IN NATURAL CONDITION. FINAL LOT LAYOUT SHALL BE ADJUSTED ACCORDINGLY. RUN OFF SHALL BE DIRECTED TO THE OXBOW TO PROMOTE VEGETATIVE GROWTH AS INDICATED.