

EXISTING DETENTION BASIN
 $Q_{100} \text{ IN} = 729 \text{ cfs}$ $Q_{100} \text{ OUT} = 168 \text{ cfs}$

NOTE: DP5B=DP9
 MESA BASIN DBPS

EAST FORK MESA BASIN
 100 YEAR FLOODPLAIN
 PER FIS

M17A
 24.7

M18A
 22.7

M17B
 19.5

M18B
 13.2

M14.1
 19.2

M18C
 20.1

M18D
 24.7

M14D
 6.7

WEST FORK MESA BASIN
 100 YEAR FLOODPLAIN
 PER FIS

SENTINEL RIDGE WEST AT
 GARDEN OF THE GODS
 CLUB FILING NO. 1

EXISTING DETENTION BASIN 14
 $Q_{100} \text{ IN} = 245 \text{ cfs}$ $Q_{100} \text{ OUT} = 143 \text{ cfs}$
 $Q_5 \text{ IN} = 54 \text{ cfs}$ $Q_5 \text{ OUT} = 51 \text{ cfs}$

M14C
 13.9

M14A
 20.2

LEGEND

- SUB-BASIN DESIGNATION
- SUB-BASIN AREA
- DESIGN POINT
- DRAINAGE BASIN BOUNDARY
- STREAM INVERT
- HEC-1 ROUTING ELEMENT

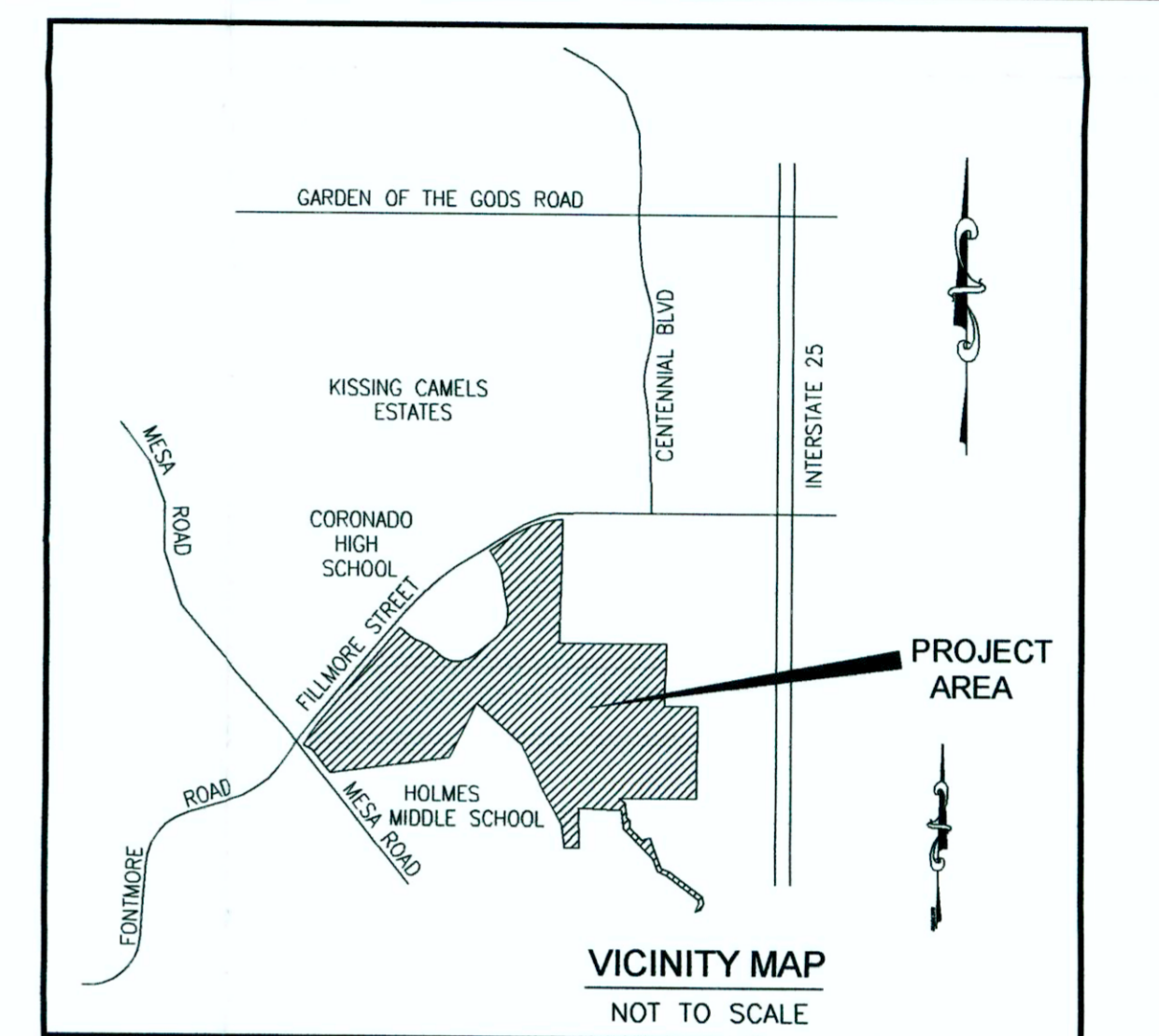

**DESIGN POINT DISCHARGES
 W/O PROPOSED DETENTION**

DESIGN POINT	5-YEAR FLOW	100-YEAR FLOW
5B	106	168
10	20	68
13	30	155
13.1	32	161
14 (1)	54	245
14.1	26	85
14.2	31	100
17.1	107	171
17.2	111	245
18.1 (2)	111	261
18.2	145	378

(1) DP 14=DP 26 DBPS
 (2) DP 18.1=DP 12 DBPS

SUB-BASIN DISCHARGES

BASIN	Q ₅	Q ₁₀₀
M14.1	12	30
M14A	1	13
M14C	7	31
M14D	6	19
M17A	40	91
M17B	24	64
M18A	1	6
M18B	1	12
M18C	18	53
M18D	28	78

Kiowa Engineering Corporation
 1604 South 21st Street
 Colorado Springs, Colorado 80904
 (719) 630-7342

**SENTINEL RIDGE
 MASTER DEVELOPMENT DRAINAGE PLAN
 SUB-BASIN MAP
 PROPOSED BASIN CONDITIONS
 COLORADO SPRINGS, COLORADO**

Project No.: 07028
 Date: SEPTEMBER 2008
 Design: RNW
 Drawn: MFA/JLN
 Check: RNW
 Revisions:

SHEET
EXH 2
 OF X SHEETS