



DESIGN POINT FLOW (CFS)

- ① Q5 = 12 CFS
Q100 = 30 CFS
- ② Q5 = 4 CFS
Q100 = 10 CFS

BASIN SUMMARY:

BASIN	Q(5)-CFS	Q(100)-CFS
EX-1	12	30
EX-2	4	10

LEGEND

DESCRIPTION	SYMBOL
EXISTING GROUND CONTOUR	6910
PROPOSED FINISHED CONTOUR	6910
BASIN BOUNDARY	---
DESIGN POINT	③
BASIN IDENTIFIER	EX-1
AREA IN ACRES	10.0
EXISTING DIRECTION OF FLOW	⇨
PROPOSED DIRECTION OF FLOW	➔
STORM SEWER	---
CROSS PAN	⊥

NOTES:

THIS MAP IS FOR DRAINAGE PURPOSES ONLY.
SEE GRADING PLAN FOR APPROPRIATE GRADING INFORMATION.

EXISTING CONDITIONS
SOARING EAGLES COMMERCIAL
JOB NO. 2259.00
JANUARY 2008
SHEET 1 OF 1

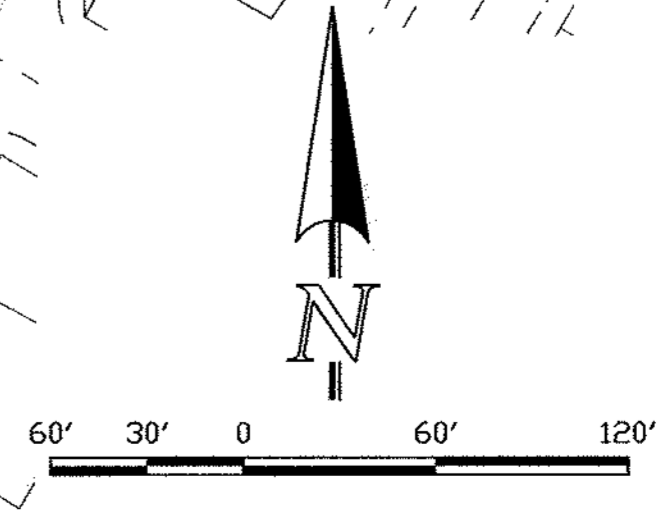

X:\225900\DRAWINGS\DEVELOPMENT\225900\EX-1.dwg, 2/9/2008 2:11:20 PM, CDES1080C.pcs