

# MASTER DEVELOPMENT DRAINAGE PLAN

## COUNTY OF EL PASO, STATE OF COLORADO

# SOUTH ACADEMY STATION

### DEVELOPED CONDITIONS

### DECEMBER 2007

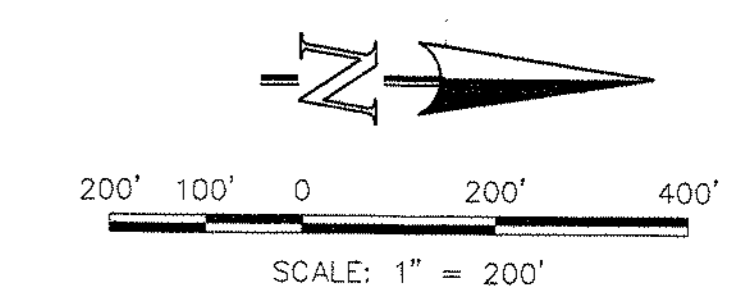
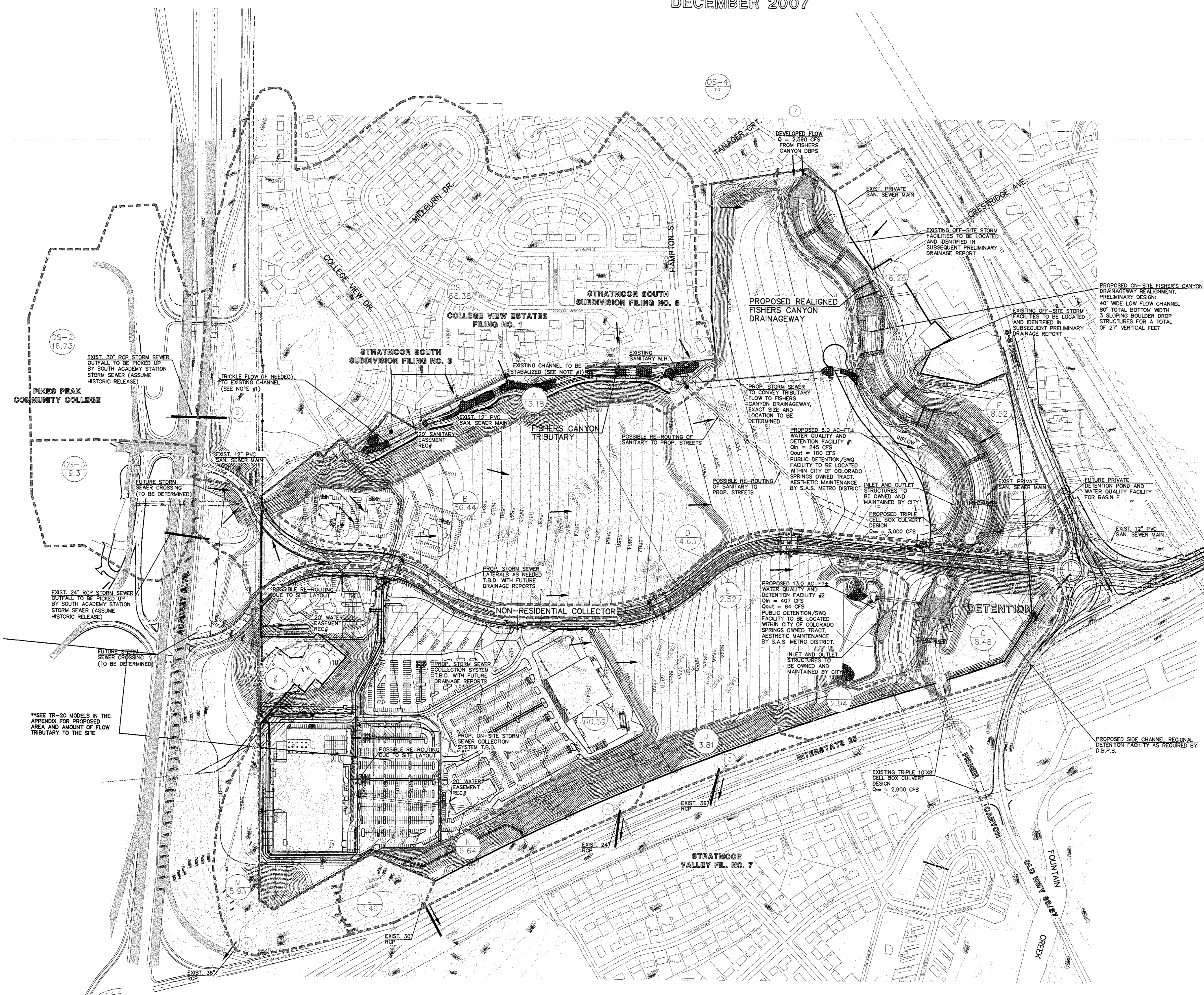
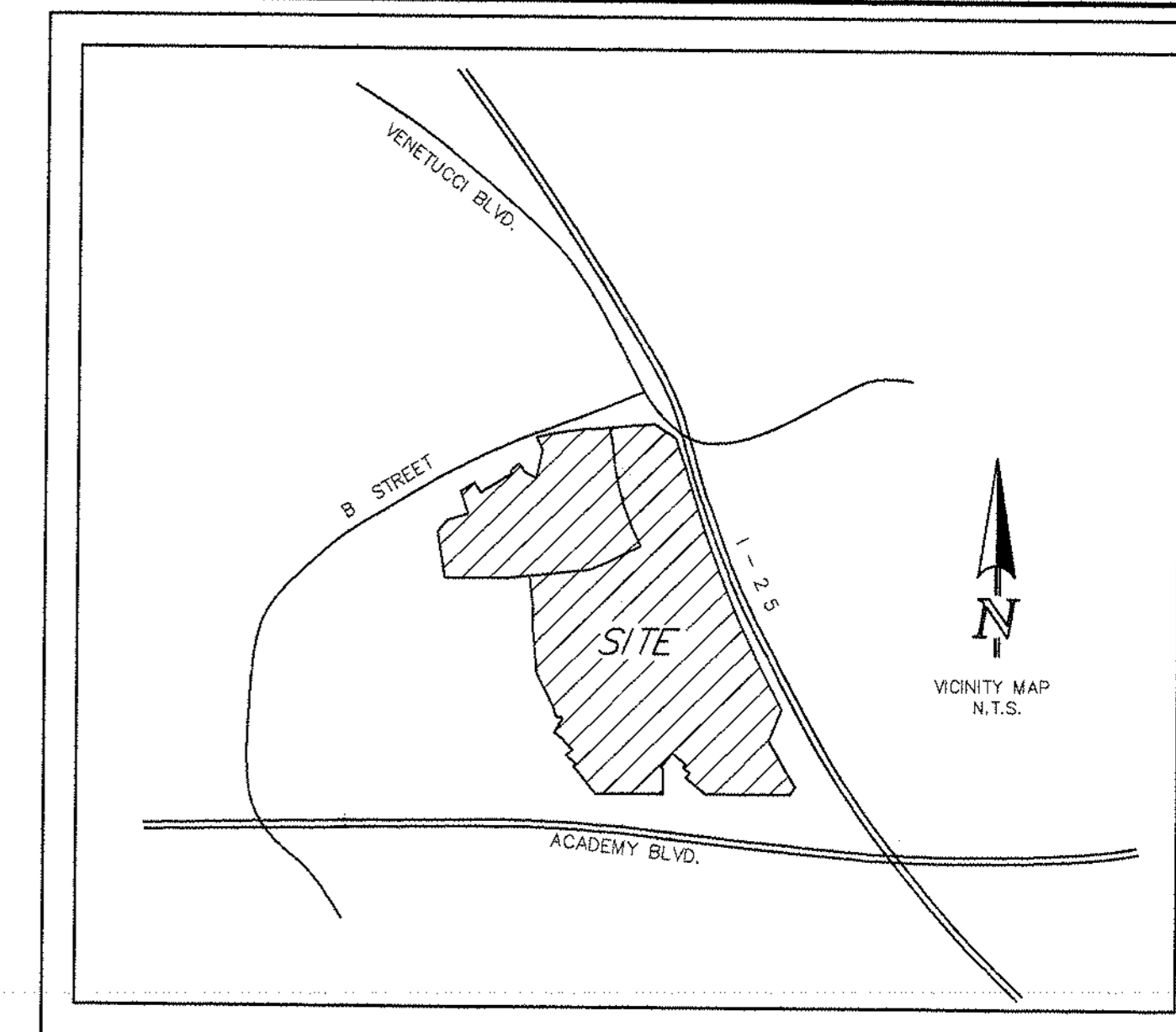

- EXISTING GROUND CONTOUR 5820
- PROPOSED FINISHED CONTOUR 5820
- SUBDIVISION BOUNDARY
- LOT LINE
- PROPOSED BASIN BOUNDARY
- PROP. DIRECTION OF DRAINAGE
- T.B.D. TO BE DETERMINED
- PROPOSED STORM SEWER
- PROPOSED STORM INLET
- BASIN IDENTIFIER D
- AREA IN ACRES 1.41
- DESIGN POINT I
- LOW POINT L.P.
- HIGH POINT H.P.

#### DEVELOPED AREA DRAINAGE

BASIN	Q(5) (cfs)	Q(100) (cfs)	OUTFALL
A	11	28	Fishers Canyon Tributary Channel
B	114	228	Detention & WQ Facility #1 - Fishers Canyon
C	43	84	Fishers Canyon Drainageway
D	15	24	Detention & WQ Facility #1 - Fishers Canyon
E	7	13	Detention & WQ Facility #1 - Fishers Canyon
F	27	52	Future Water Quality Pond - Fishers Canyon
G	9	21	Fishers Canyon Drainageway
H	166	317	Detention & WQ Facility #2 - Fishers Canyon
I	3	8	Fishers Canyon Drainageway
J	4	9	Exist. 36" RCP
K	6	15	Exist. 24" RCP
L	2	6	Exist. 30" RCP
M	8	14	Exist. 36" RCP
OS-1	128		Exist. Stratmoor South & College View Estates
OS-2	29		Existing 30" RCP
OS-3	16		Existing 24" RCP

#### DEVELOPED DESIGN POINT SUMMARY

Design Point(s)	Contributing Basins	Flow		Outfall
		Q(5)	Q(100)	
1	Basin B, Basin D & Basin E	125	245	Flow to Detention & Water Quality Facility Pond #1
1a	Detention & Water Quality Facility #1	51	100	To Fishers Canyon Drainageway
2	Basin H	165	317	Flow to Detention & Water Quality Facility Pond #2
2a	Detention & Water Quality Facility #2	33	64	To Fishers Canyon Drainageway
3	Basin J	4	9	Exist. 36" RCP to East
4	Basin K	4	15	Exist. 24" RCP to East
5	Basin L	2	6	Exist. 30" RCP to East
6	Basin M	6	14	Exist. 36" RCP to East
7	DBPS-DP6, SA, SE, 4A, 4B	2,866		Existing DBPS Design Point
7a	DBPS-DP6 C	2,866		Existing DBPS Design Point
8	DBPS-DP7a, DP-1a	3,014		Existing DBPS Design Point
9	DBPS-DP8, DP-2A, G, I	2,866		Existing DBPS Design Point
A	OS-3	16		Existing 24" RCP
B	OS-2	29		Existing 30" RCP
C	OS-1, DP-A, DP-B	187		Tributary Flow to Future Pipe

**NOTES:**

- FISHERS CANYON TRIBUTARY: IT IS PROPOSED THAT THE OFFSITE FLOWS FROM THE SOUTH OF ACADEMY BLVD. CONVEYED IN THE EXISTING 24" AND 30" DIAMETER RCP STORM SEWERS, BE CAPTURED AND CONVEYED TO FISHERS CANYON DRAINAGE WAY IN PROPOSED STORM SEWER. (SIZE TO BE DETERMINED.)
- FREQUENT FLOW - TRICKLE FLOW SHALL BE DIVERTED FROM THE PROPOSED STORM SEWER TO THE UPSTREAM END OF THE EXISTING TRIBUTARY CHANNEL TO PROMOTE GROWTH OF VEGETATION WHILE PROTECTING THE CHANNEL FROM EROSION PEAK FLOWS. TRIBUTARY CHANNEL IMPROVEMENTS ARE PROPOSED IN ACCORDANCE WITH THE INTENT OF THE D.B.P.S. TO INCLUDE SLOPING ROCK DROPS WITH DISPERSED POOLS IN THE STEEPER AREAS.
- IT IS PROPOSED FLOW IN THE TRIBUTARY CHANNEL AND THE PARALLEL STORM SEWER BE COMBINED IN A STORM MAIN AT THE APPROXIMATE LOCATION SHOWN ON THIS PLAN. THIS STORM MAIN SHALL DISCHARGE DIRECTLY INTO THE FISHERS CANYON DRAINAGEWAY.

48 HOURS BEFORE YOU DIG,  
CALL UTILITY LOCATORS  
**1-800-922-1987**  
CITY OF COLORADO SPRINGS DEPT. OF UTILITIES  
GAS, ELECTRIC, WATER AND WASTEWATER

THE LOCATIONS OF EXISTING UNDERGROUND UTILITIES ARE SHOWN IN AN APPROXIMATE WAY ONLY. THE CONTRACTOR SHALL DETERMINE THE EXACT LOCATION OF ALL EXISTING UTILITIES BEFORE COMMENCING WORK. THE CONTRACTOR SHALL BE FULLY RESPONSIBLE FOR ANY AND ALL DAMAGES WHICH MIGHT BE CAUSED BY HIS FAILURE TO EXACTLY LOCATE AND PRESERVE ANY AND ALL UNDERGROUND UTILITIES.

NO. REVISION	DATE	REVIEW:

PREPARED UNDER MY DIRECT SUPERVISION FOR AND ON BEHALF OF  
CLASSIC CONSULTING ENGINEERS AND SURVEYORS, LLC

KYLE R. CAMPBELL, COLORADO P.E. #29794 DATE

6385 Corporate Drive, Suite 101  
Colorado Springs, Colorado 80919  
(719)785-0790  
(719)785-0799 (Fax)

MASTER DEVELOPMENT DRAINAGE PLAN  
SOUTH ACADEMY STATION  
DEVELOPED CONDITIONS DRAINAGE MAP

DESIGNED BY: JWW SCALE: DATE: 12/04/07  
DRAWN BY: JWW (H) 1"= 200' SHEET 1 OF 1  
CHECKED BY: (V) 1"= N/A JOB NO. 2184.00

C:\3144\REVISIONS\REVISED\MASTER DEVELOPMENT DRAINAGE PLAN\OS-3.DWG