

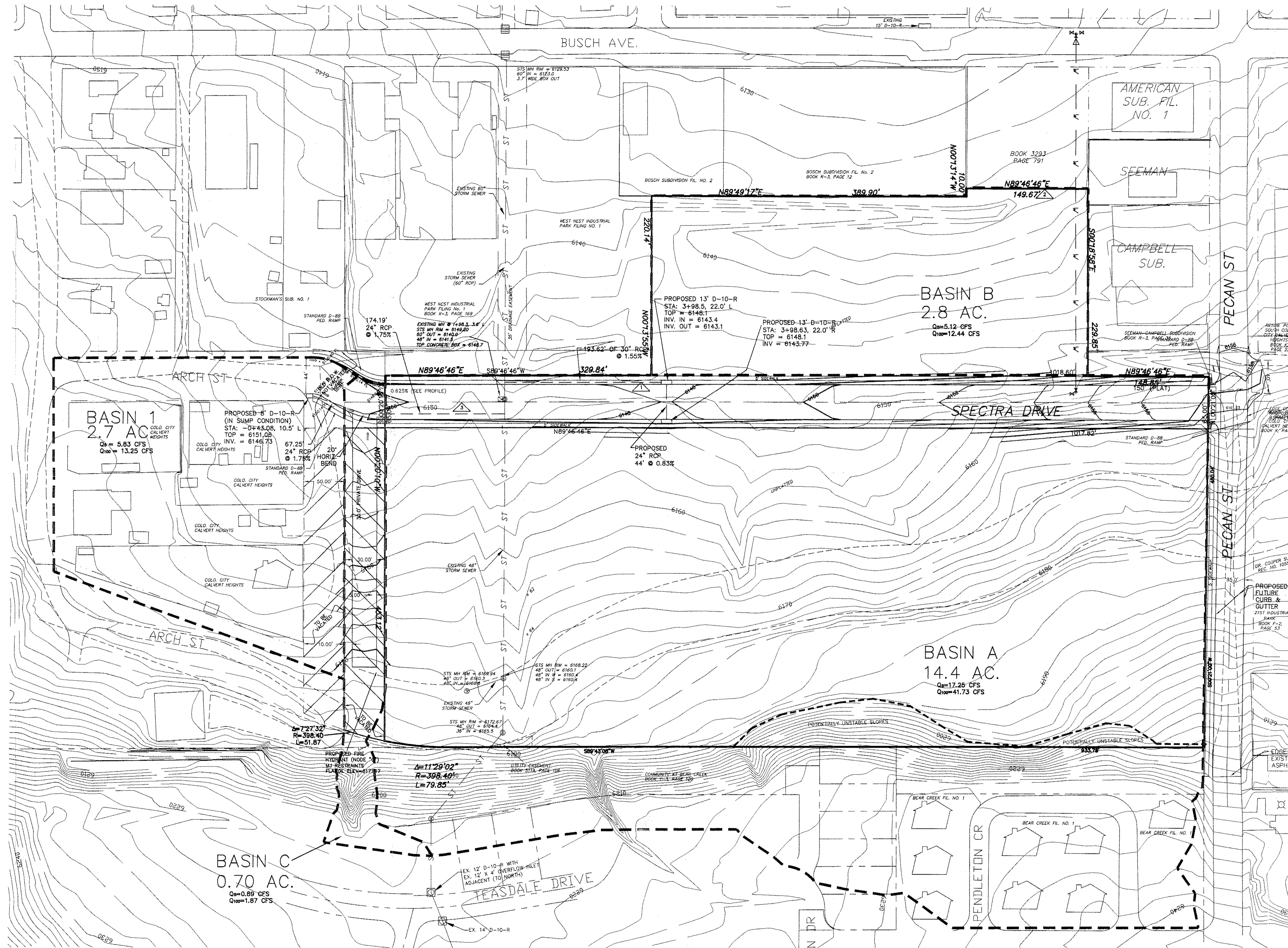



AMENDMENT TO BOTT AVENUE INDUSTRIAL PARK DRAINAGE PLAN





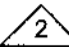

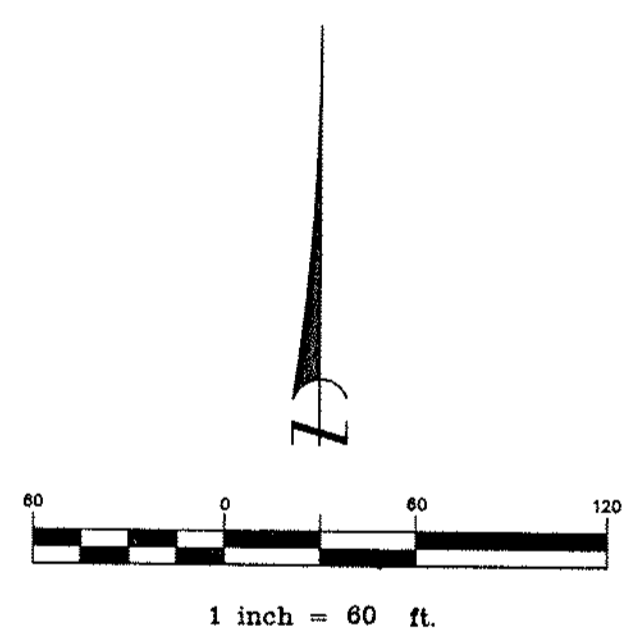
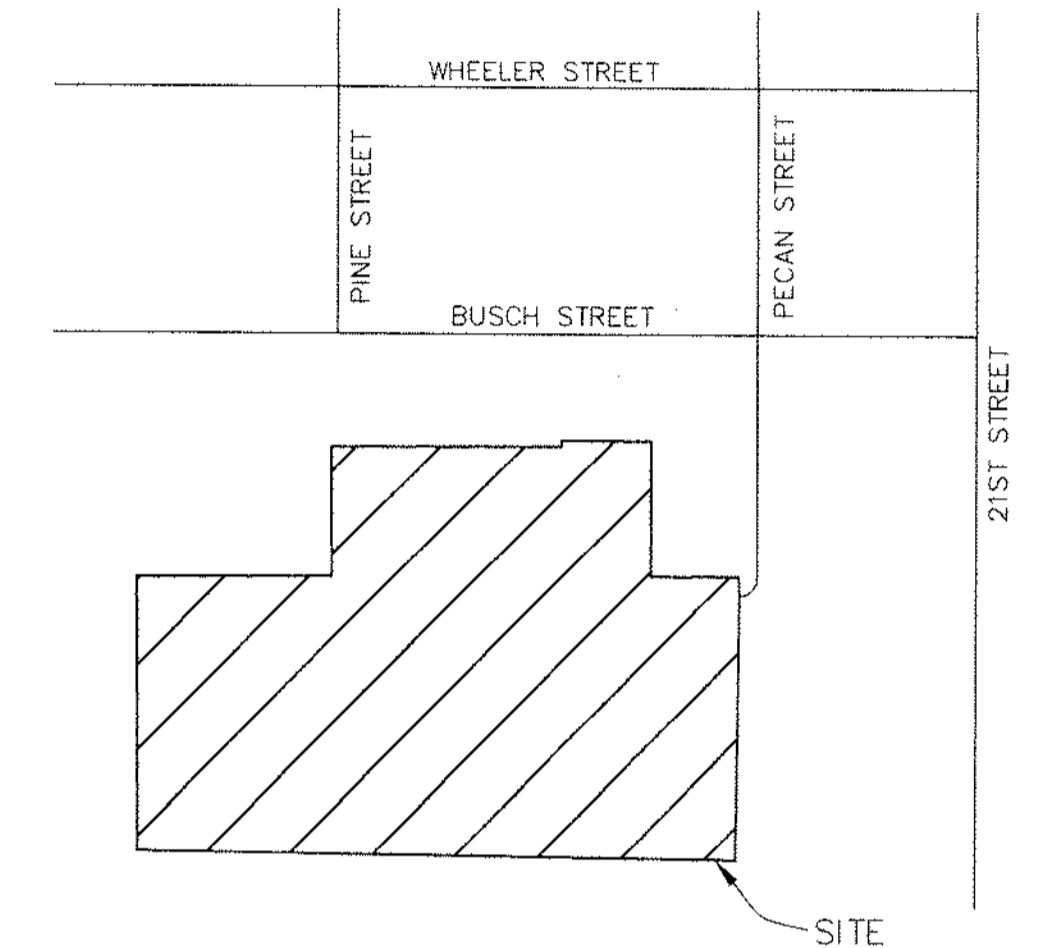

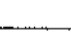
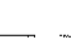

DRAINAGE BASIN DESIGN POINTS:

-  Q₁₀₀ = 43.60 cfs
-  Q₁₀₀ = 12.44 cfs
-  Q₁₀₀ = 13.25 cfs



LEGEND:

-  EXISTING WATER, VALVE AND HYDRANT
-  EXISTING STORM SEWER, MANHOLE
-  EXISTING SANITARY SEWER, MANHOLE
-  EXISTING CONTOUR
-  EXISTING CONTOUR, INDEX
-  PROPOSED CONTOUR
-  ORIGINAL PLAT BOUNDARY
-  ADJACENT RESIDENTIAL SUBDIVISIONS' BOUNDARY
-  DRAINAGE BASIN BOUNDARY
-  DRAINAGE BASIN DESIGN POINT