

SPRING CREEK DEVELOPMENT MDDP

CITY OF COLORADO SPRINGS, COUNTY OF EL PASO, STATE OF COLORADO

MASTER DEVELOPMENT DRAINAGE PLAN

DEVELOPED CONDITIONS
SEPTEMBER 2001

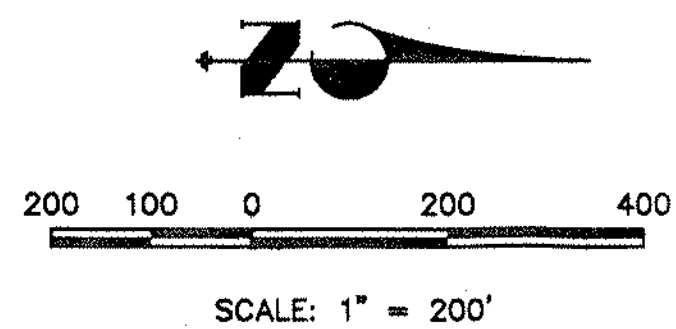

- LEGEND**
- E-C BASIN DESIGNATION
 - 6.33 AREA IN ACRES
 - BASIN BOUNDARY
 - MAJOR BASIN BOUNDARY
 - 4 DESIGN POINT SD = SURFACE DRAINAGE
IP = PROPOSED SUB-SURFACE
 - DIRECTION OF FLOW
 - EXISTING 2' CONTOUR LINE WITH ELEVATION
 - EXISTING 10' CONTOUR LINE WITH ELEVATION
 - PROPOSED STORM SEWER
 - EXISTING STORM SEWER

NOTE:
FOR SIZES OF EXISTING STORM INLETS
AND STORM SEWER, PLEASE REFER TO
EXISTING CONDITIONS DRAINAGE MAP.

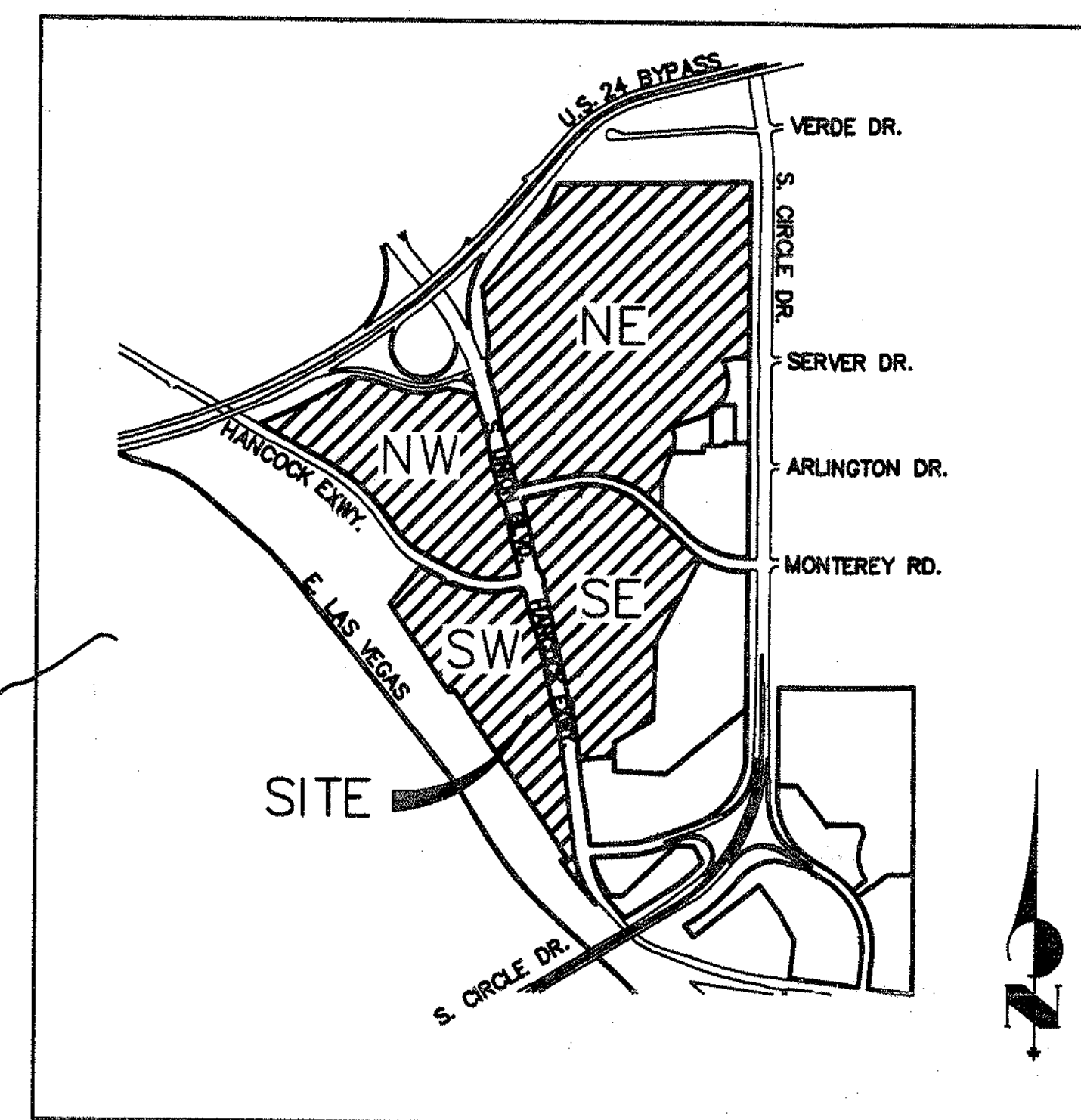

VICINITY MAP
NTS



Land Patterns, Inc.
Landscape Architect
1000 N. W. 10th St., Suite 100
Fort Lauderdale, FL 33304
Tel: 754-561-1111
Fax: 754-561-1112
www.landpatterns.com

J.R. ENGINEERING
A subsidiary of Land Patterns
487 Arapahoe Drive, Colorado Springs, CO 80907
Tel: 719-596-2559 Fax: 719-596-6888
www.jrengineering.com

MASTER DEVELOPED DRAINAGE PLAN
SPRING CREEK
CONTRACT NO. 01-0001
SC COLORADO HOLDINGS, LLC
(719) 471-0000

Sheet
MASTER DEVELOPED DRAINAGE PLAN

Reuse of Document
This document is the property of Land Patterns, Inc., Duany Planners-Architects & Company, and SC Colorado Holdings, LLC. The ideas and design incorporated in this document are instruments of professional service and shall not be used for any other project without written authorization from the above. © 2001 Land Patterns, Inc. All rights reserved.

Revisions	By
PER COMMENTS	MSD
PER COMMENTS	ACS
PER COMMENTS	ACS

Drawn by:
Checked by:
Date:
Scale:
Job No.: 29840.00

Sheet
1 of 1 sheets