

BASIN SUMMARY			
BASIN	TOTAL AREA	Q5 (CFS)	Q100 (CFS)
A	12.2	23	45
B	0.1	1	1
C1	3.4	7	13
C2	17.9	36	70
C3	3.5	7	15
D	5.2	17	31
E	24.4	48	95
F	6.8	9	19
G	0.2	1	1
H	0.2	1	1
OS-1*		82	148
OS-2	1.1	5	9
OS-3	1.4	6	11
OS-4	1.2	5	10
OS-5	1.1	5	9

POND SUMMARY	
TOTAL STORAGE	= 11.9 AC-FT
100-YR STORAGE	= 8.34 AC-FT
5-YR STORAGE	= 4.51 AC-FT
2-YR STORAGE	= 3.62 AC-FT
Q ₁₀₀ IN	= 221 CFS
Q ₅ IN	= 116 CFS
Q ₂ IN	= 85 CFS
Q ₁₀₀ OUT	= 13 CFS
Q ₅ OUT	= 7 CFS
Q ₂ OUT	= 4 CFS
100-YR HWL	= 6735.51
5-YR HWL	= 6731.12
2-YR HWL	= 6730.17
Q ₅ HISTORIC	= 42 CFS
Q ₁₀₀ HISTORIC	= 108 CFS

* INFORMATION BASED ON EQUIVALENT CA VALUES PER ADDENDUM NO. 1 TO NORTHGATE FILING NO. 5 VOYAGER AND BLACK SQUIRREL PARKWAYS PHASE 2B, LIBERTY HEIGHTS FILING NO. 1 PRELIMINARY/FINAL DRAINAGE REPORT, "NORTHGATE MASTER DEVELOPMENT DRAINAGE PLAN" AND "NORTHGATE FILING NO. 3 ADDENDUM AND RAMTRON FILING NO. 1 PRELIMINARY/FINAL DRAINAGE REPORT". SEE OFFSITE BASIN OS-1 PIPE AND SURFACE FLOW SHEET.

DESIGN POINT SUMMARY			
DESIGN POINT	Q5 (CFS)	Q100 (CFS)	
1	23	45	
2	23	45	
3	67	111	
4	25	47	
5A	29	55	
5B	36	70	
5C	7	15	
6*	69	114	
7	17	31	
8	61	119	
9	115	218	
10	1	1	

* DESIGN POINT 6'S BASINS OS-4 AND OS-5 ARE BASED ON THE CAPACITY OF THE TWO NEENAH INLETS IN VOYAGER PARKWAY (SEE NEENAH INLET CAPACITY CALCS. IN APPENDIX).

TRAILRIDGE SOUTH AT NORTHGATE

CITY OF COLORADO SPRINGS, COUNTY OF EL PASO, STATE OF COLORADO

MASTER DEVELOPMENT DRAINAGE PLAN

DEVELOPED CONDITIONS

REVISED JANUARY 2001 - MAY 2000

LEGEND

EXISTING GROUND CONTOUR	6910
PROPOSED FINISHED CONTOUR	6910
BASIN BOUNDARY	(Symbol: Triangle with 'A')
DESIGN POINT	(Symbol: Circle with 'A')
BASIN IDENTIFIER AREA IN ACRES	(Symbol: Circle with '10.1')
DIRECTION OF FLOW	(Symbol: Arrow)

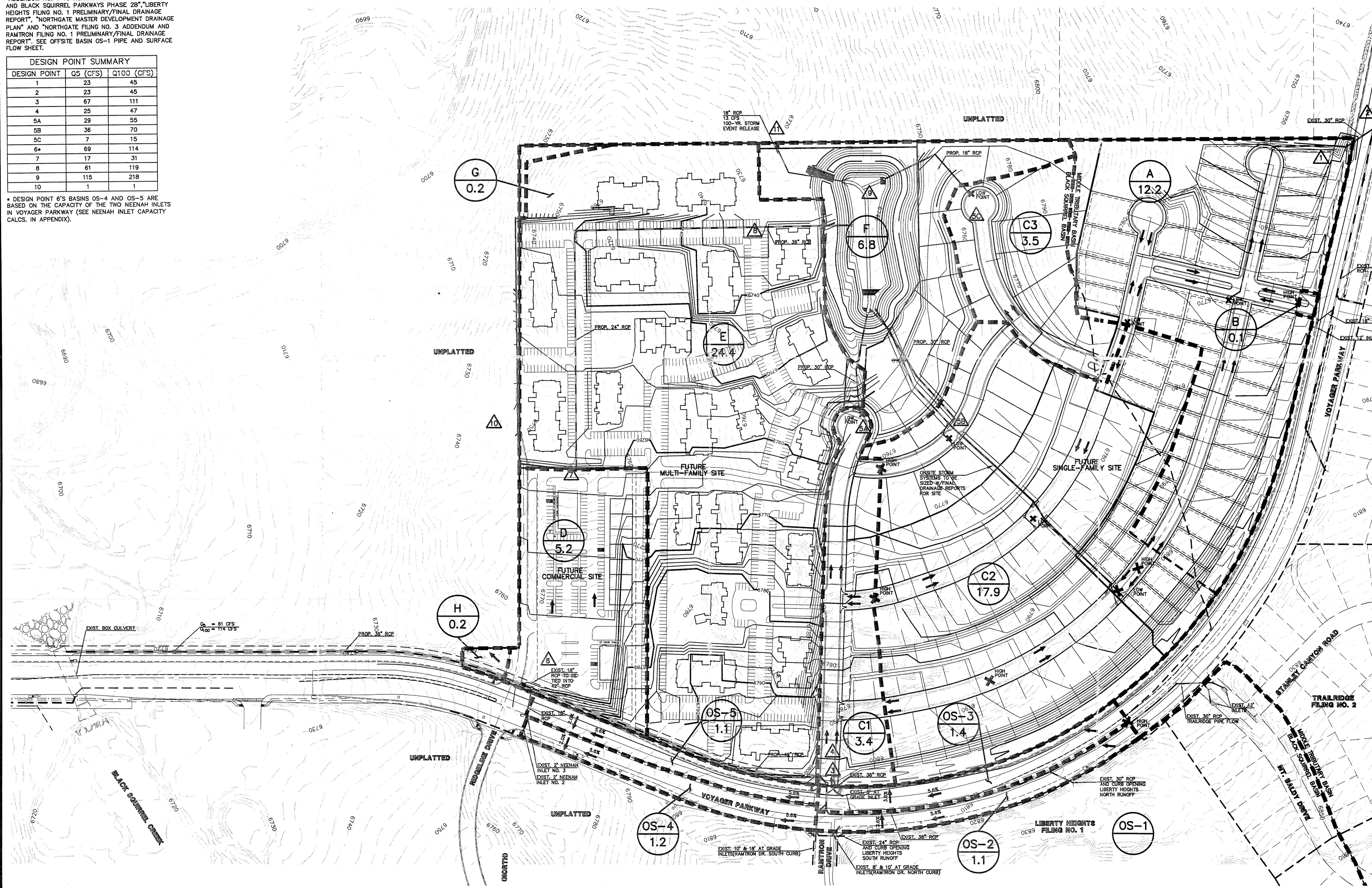
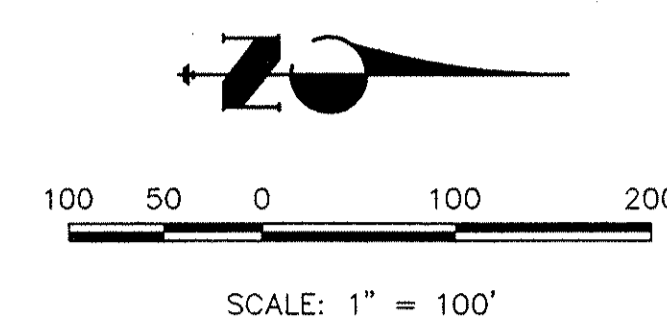

UNTIL SUCH TIME AS THESE DRAWINGS ARE APPROVED BY THE APPROPRIATE REVIEWING AGENCIES, OR ENGINEERING, FOR THE PURPOSES DESIGNATED BY WRITTEN AUTHORIZATION.

48 HOURS BEFORE YOU DIG,
CALL UTILITY LOCATORS

1-800-922-1987

CITY OF COLORADO SPRINGS DEPT. OF UTILITIES
GAS, ELECTRIC, WATER AND WASTEWATER

JR ENGINEERING
A Subsidiary of Westcon
430 Arapahoe Drive • Colorado Springs, CO 80907
761-550-2500 • Fax 761-551-6657
www.jrengineering.com

NO.	REVISION	BY	DATE
1	IN-HOUSE REVIEW - QUALITY CONTROL	ABE	03/13/01

SCALES:	PLAN: 1"=100'
	PROFILE: N/A
	DATE: 4/22/00
	DES. BY: QNA
	DWN. BY: DM
	CHK. BY:

TRAILRIDGE SOUTH AT NORTHGATE
MASTER DEVELOPMENT DRAINAGE PLAN
DEVELOPED CONDITIONS

SHEET 1 OF 1
JOB NO. 9128.10

XREFS: X:\2010000.dwg\12121210\Drawings\91281000.dwg F:\1 Mar 15 13:13:54 2001