

SEE EXHIBIT 'B' AND 'C' FOR DETAILED N'LY ANALYSIS

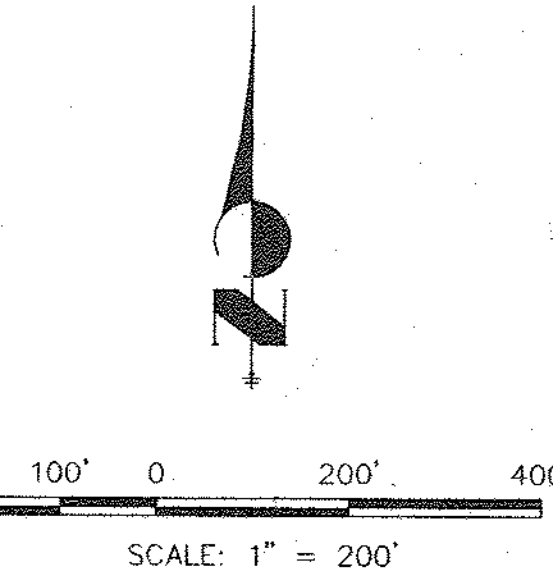
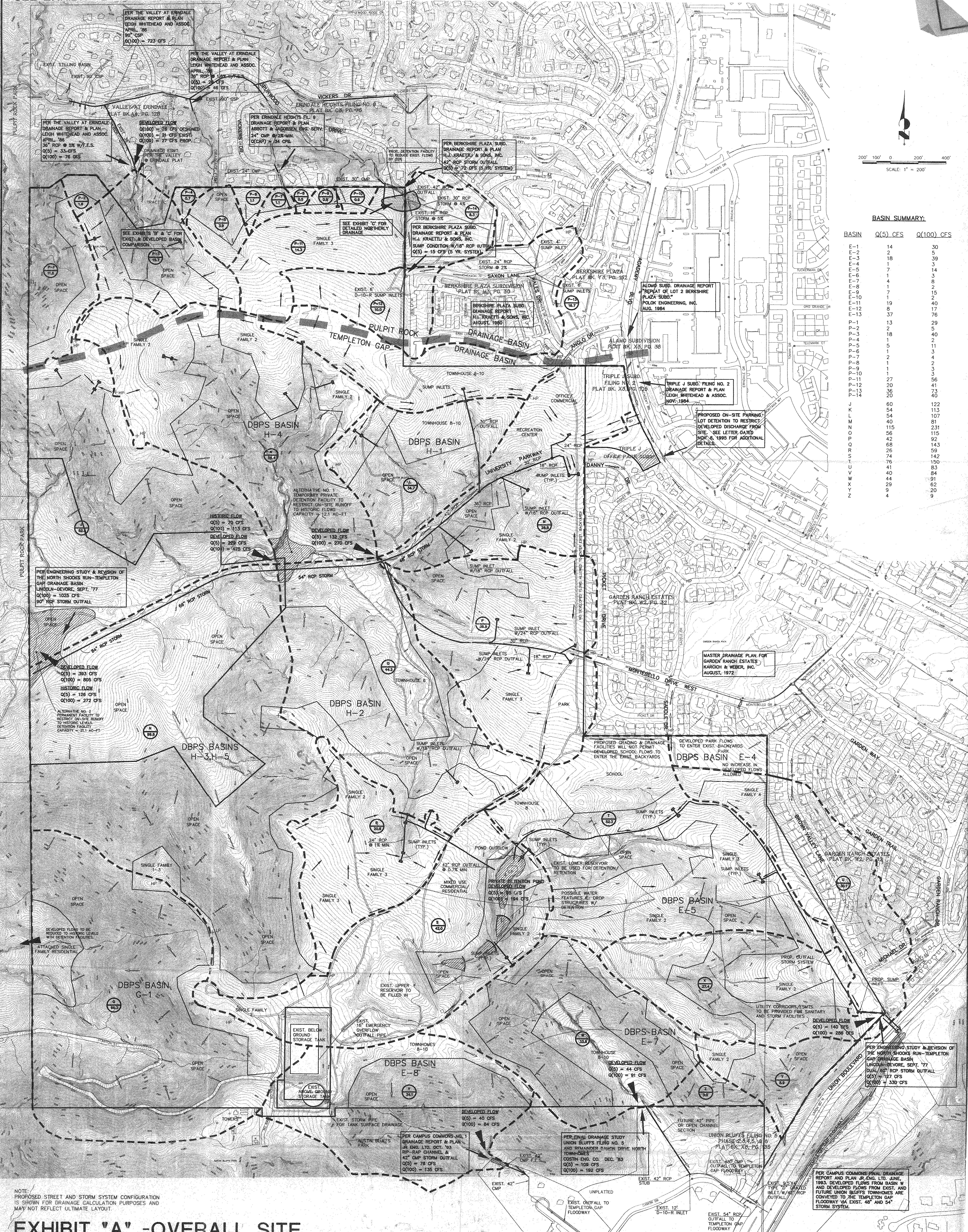

BASIN SUMMARY:

BASIN	Q(5) CFS	Q(100) CFS
E-1	14	30
E-2	23	5
E-3	18	39
E-4	1	3
E-5	7	14
E-6	1	3
E-7	4	8
E-8	1	2
E-9	7	15
E-10	1	4
E-11	19	40
E-12	8	17
E-13	37	76
P-1	13	29
P-2	2	5
P-3	18	40
P-4	1	2
P-5	5	11
P-6	1	3
P-7	2	4
P-8	1	2
P-9	1	3
P-10	1	3
P-11	27	56
P-12	20	41
P-13	36	73
P-14	20	40
J	60	122
K	54	113
L	50	107
M	115	231
N	56	115
O	42	92
P	68	143
R	26	59
S	74	142
T	76	150
U	41	83
V	40	84
W	44	91
X	29	62
Y	9	20
Z	4	9

NOTE: PROPOSED STREET AND STORM SYSTEM CONFIGURATION IS SHOWN FOR DRAINAGE CALCULATION PURPOSES AND MAY NOT REFLECT ULTIMATE LAYOUT.

EXHIBIT "A" - OVERALL SITE

NO.	REVISION	BY	DATE
1	REVISED PER CITY COMMENTS	MAW	2/20/96

JR Engineering, Ltd.
 4935 North 30th Street
 Colorado Springs, Colorado 80919
 (719) 593-2593 • FAX (719) 528-6613

48 HOURS BEFORE YOU DIG,
 CALL UTILITY LOCATORS
1-800-922-1987

CITY OF COLORADO SPRINGS DEPT. OF UTILITIES
 GAS, ELECTRIC, WATER AND WASTEWATER

UNLESS SHOWN AS THESE
 DRAWINGS ARE APPROVED BY
 THE APPROPRIATE REVIEWING
 AGENCIES, NO OTHER REVIEWED
 APPROVES THEIR USE ONLY FOR
 THE PURPOSES DESIGNATED BY
 WRITTEN AUTHORIZATION.