

UNIVERSITY PARK - EXISTING DRAINAGE CONDITIONS (N'LY) EXHIBIT 'B'

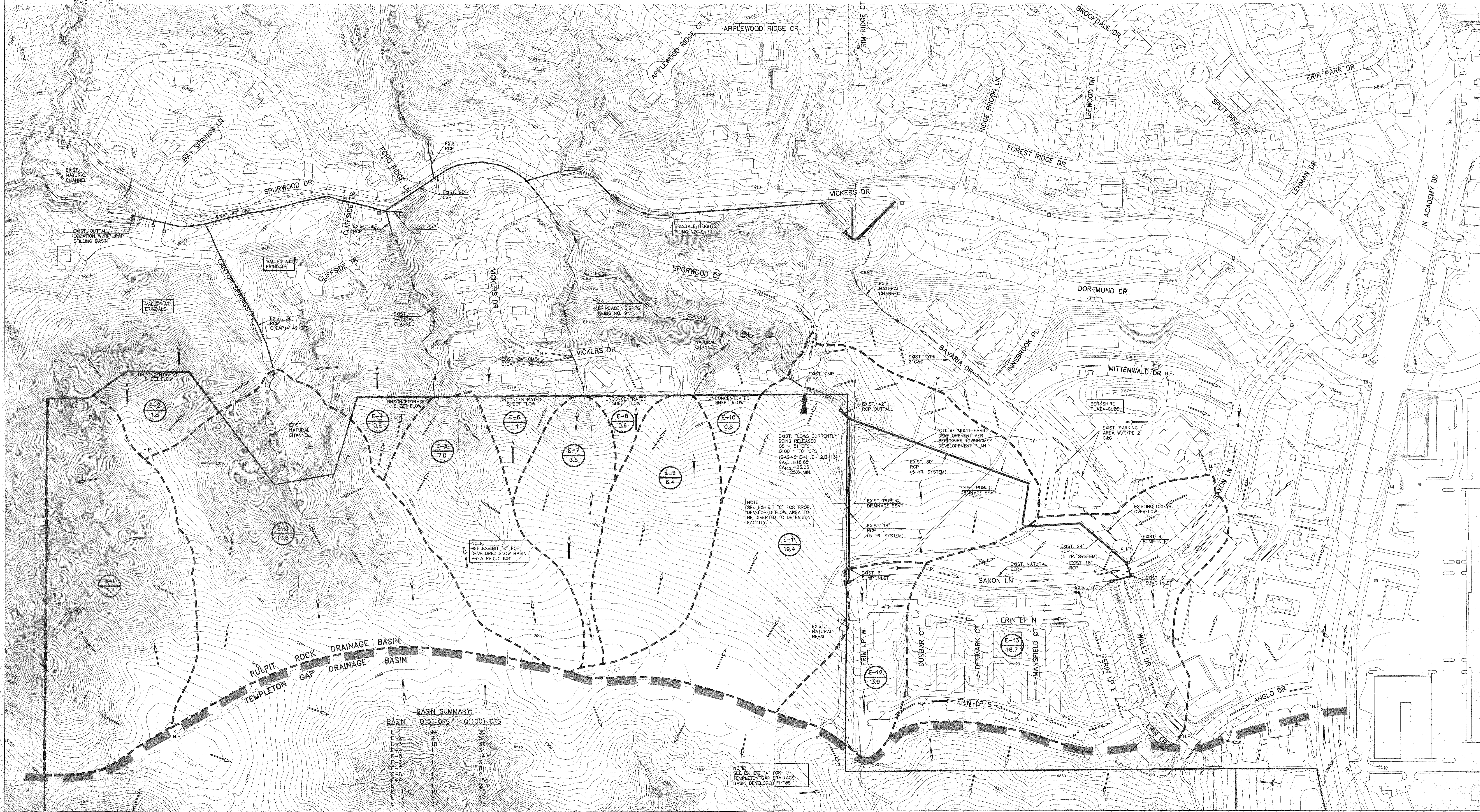
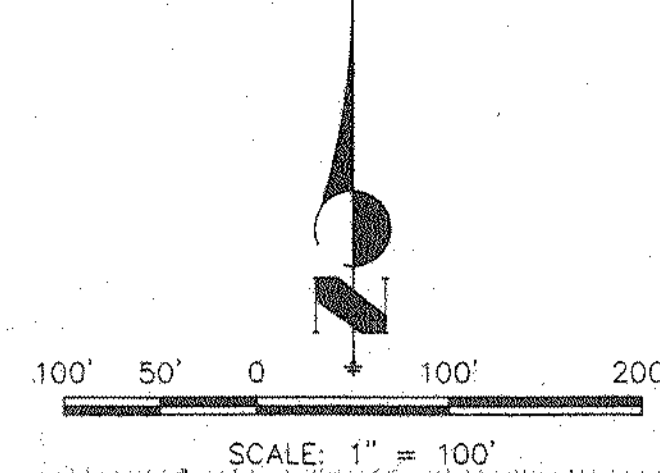

BASIN SUMMARY

BASIN	Q(5) CFS	Q(100) CFS
E-1	12.4	30
E-2	11.8	5
E-3	17.5	2
E-4	0.9	18
E-5	7.0	39
E-6	1.1	3
E-7	3.8	14
E-8	0.6	8
E-9	6.4	3
E-10	0.8	15
E-11	19.4	40
E-12	3.9	17
E-13	16.7	78
TOTAL	101	101