

X: 880000_011_889645 (Drainage) DMJM-DP2.dwg Mon May 01 17:02:53 2000

PATL 889645 (DRAWINGS) DMJM
FILENAME: Drain-DP2.dwg

XREFS:

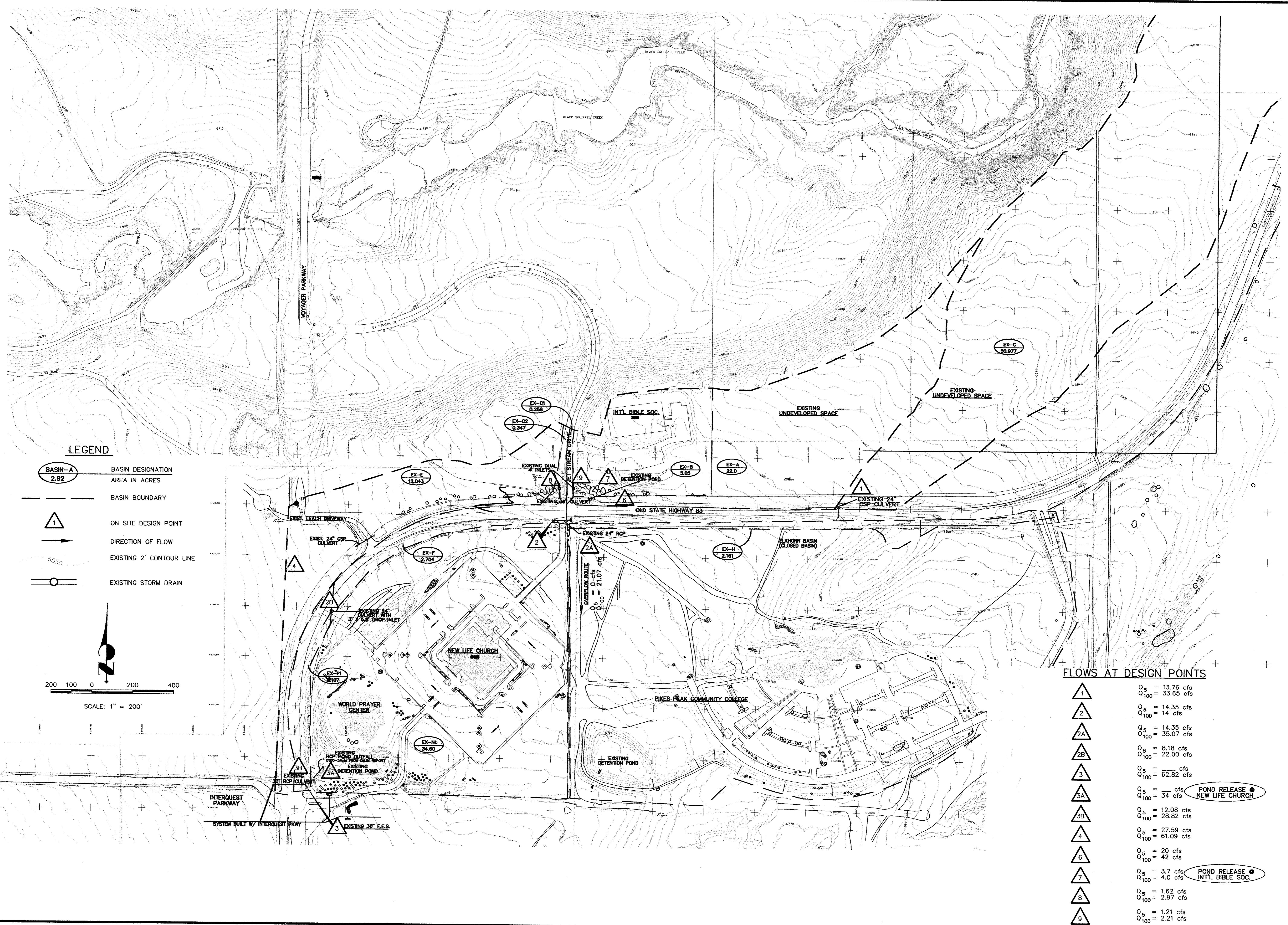

LEGEND

- BASIN-A
2.92 BASIN DESIGNATION
- BASIN AREA IN ACRES
- BASIN BOUNDARY
- ▲ ON SITE DESIGN POINT
- DIRECTION OF FLOW
- 6550 EXISTING 2' CONTOUR LINE
- EXISTING STORM DRAIN

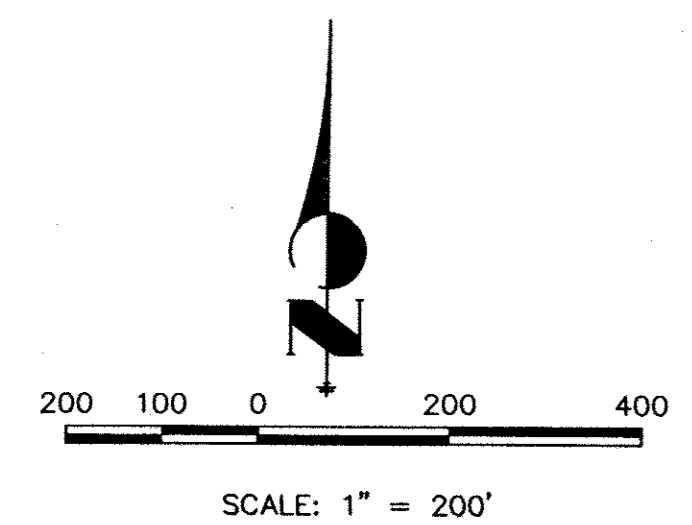

FLOWS AT DESIGN POINTS

▲ 1	$Q_5 = 13.76$ cfs $Q_{100} = 33.65$ cfs
▲ 2	$Q_5 = 14.35$ cfs $Q_{100} = 14$ cfs
▲ 2A	$Q_5 = 14.35$ cfs $Q_{100} = 35.07$ cfs
▲ 2B	$Q_5 = 8.18$ cfs $Q_{100} = 22.00$ cfs
▲ 3	$Q_5 = \frac{\quad}{\quad}$ cfs $Q_{100} = 62.82$ cfs
▲ 3A	$Q_5 = \frac{\quad}{\quad}$ cfs $Q_{100} = 34$ cfs
▲ 3B	$Q_5 = 12.08$ cfs $Q_{100} = 28.82$ cfs
▲ 4	$Q_5 = 27.59$ cfs $Q_{100} = 61.09$ cfs
▲ 6	$Q_5 = 20$ cfs $Q_{100} = 42$ cfs
▲ 7	$Q_5 = 3.7$ cfs $Q_{100} = 4.0$ cfs
▲ 8	$Q_5 = 1.62$ cfs $Q_{100} = 2.97$ cfs
▲ 9	$Q_5 = 1.21$ cfs $Q_{100} = 2.21$ cfs

● POND RELEASE ●
NEW LIFE CHURCH

● POND RELEASE ●
INT'L BIBLE SOC.

<p>JR Engineering, Ltd. 4310 Arroyo West Drive Colorado Springs, CO 80907-3449 (719) 583-6556 • FAX: (719) 583-8613</p>	
<p>48 HOURS BEFORE YOU DIG, CALL UTILITY LOCATORS 1-800-922-1987 CITY OF COLORADO SPRINGS DEPT. OF UTILITIES GAS, ELECTRIC, WATER AND WASTEWATER</p>	<p>UNTIL SUCH TIME AS THESE DRAWINGS ARE APPROVED BY THE APPROPRIATE REVIEWING AGENCY, THESE DRAWINGS DO NOT APPROVE THEIR USE ONLY FOR THE PURPOSES DESIGNATED BY WRITTEN AUTHORIZATION.</p>
<p>NO. _____</p> <p>PLAN: 1"=200'</p> <p>PROFILE: N/A</p> <p>DATE: 11/18/99</p> <p>DES. BY: SKC</p> <p>DWN. BY: SKC</p> <p>CHK. BY:</p>	<p>BY DATE</p> <p>REVISION</p>
<p>VOYAGER PARKWAY PHASE 3 DRAINAGE STUDY</p>	<p>EXISTING CONDITIONS</p>
<p>SHEET 1 OF 1</p>	<p>JOB NO. 889645</p>