

DESIGN POINT DISCHARGE SUMMARY w/DETENTION			
DESIGN POINT	AREA	Q _s (cfs)	Q ₁₀₀ (cfs)
A1	0.06	3	32
A3	0.38	155	509
A4	0.09	93	288
A5 (N)	0.64	254	865
A5 (OUT)	0.64	34	165
A6	0.46	200	632
A	0.85	34	166
A9	0.07	18	76
B	0.04	60	122
C3	0.05	33	100
C	0.16	114	328
D2 (N)	0.10	56	171
D2 (OUT)	0.10	10	103
E5	0.13	85	241
E2 (N)	0.18	116	336
E2 (OUT)	0.18	6	66

DESIGN POINT DISCHARGE SUMMARY w/DETENTION			
DESIGN POINT	AREA	Q _s (cfs)	Q ₁₀₀ (cfs)
F9	0.21	18	152
F10	0.06	6	48
F11	0.14	13	102
F12	0.43	24	236
F13	0.05	2	30
F14	0.25	45	210
F18 (N)	0.80	65	506
F18 (OUT)	0.80	26	141
F19 (N)	0.37	56	338
F19 (OUT)	0.37	20	89
F21	0.08	79	184
F23	0.05	16	69
F24	0.14	44	81
F25	0.34	66	303
F26	0.13	115	285
F27	1.37	111	295
F30	0.50	112	490
F28 (N)	2.15	231	983
F28 (OUT)	2.15	112	558
F	2.23	114	600

DESIGN POINT DISCHARGE SUMMARY w/DETENTION			
DESIGN POINT	AREA	Q _s (cfs)	Q ₁₀₀ (cfs)
G3	0.29	55	277
G (IN)	0.45	120	489
G (OUT)	0.45	11	140

DETENTION BASIN E/D DATA			
Q _s IN	Q _s OUT	Q ₁₀₀ IN	Q ₁₀₀ OUT
172 cfs	13 cfs	507 cfs	156 cfs (1)
VOL _s = 5.9 AC-FT			
VOL ₁₀₀ = 14.8 AC-FT			
WS _s = 54.3			
WS ₁₀₀ = 56.9			

(1) TOTAL OUTFLOW. OUTFLOW TO BE CONTROLLED TO EXISTING LEVELS AT DP E2 & DP D2

DETENTION BASIN DB18 DATA			
Q _s IN	Q _s OUT	Q ₁₀₀ IN	Q ₁₀₀ OUT
65 cfs	26 cfs	506 cfs	141 cfs
VOL _s = 2.4 AC-FT			
VOL ₁₀₀ = 11.8 AC-FT			
WS _s = 7142.7			
WS ₁₀₀ = 7146.8			

DETENTION BASIN DB19 DATA			
Q _s IN	Q _s OUT	Q ₁₀₀ IN	Q ₁₀₀ OUT
56 cfs	20 cfs	338 cfs	89 cfs
VOL _s = 1.6 AC-FT			
VOL ₁₀₀ = 9.3 AC-FT			
WS _s = 7142.4			
WS ₁₀₀ = 7145.5			

DETENTION BASIN DB28 DATA			
Q _s IN	Q _s OUT	Q ₁₀₀ IN	Q ₁₀₀ OUT
231 cfs	112 cfs	983 cfs	558 cfs
VOL _s = 6.7 AC-FT			
VOL ₁₀₀ = 26.0 AC-FT			
WS _s = 6966.2			
WS ₁₀₀ = 6973.5			

DETENTION BASIN A DATA			
Q _s IN	Q _s OUT	Q ₁₀₀ IN	Q ₁₀₀ OUT
254 cfs	34 cfs	865 cfs	165 cfs
VOL _s = 11 AC-FT			
VOL ₁₀₀ = 31.0 AC-FT			
WS _s = 3.9			
WS ₁₀₀ = 7.1			

DETENTION BASIN G DATA			
Q _s IN	Q _s OUT	Q ₁₀₀ IN	Q ₁₀₀ OUT
120 cfs	11 cfs	489 cfs	140 cfs
VOL _s = 6.1 AC-FT			
VOL ₁₀₀ = 17.8 AC-FT			
WS _s = 2.5			
WS ₁₀₀ = 6.2			

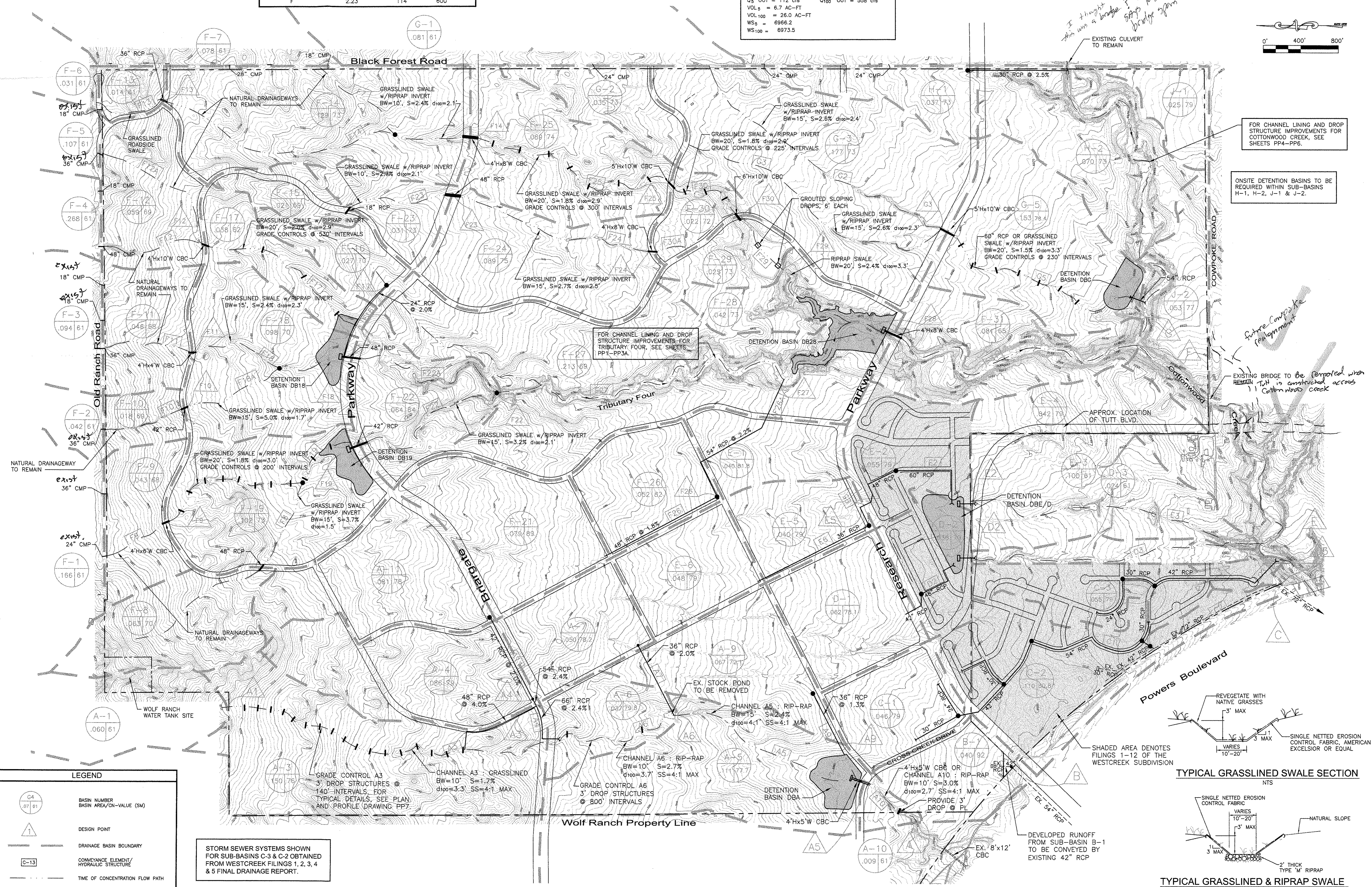
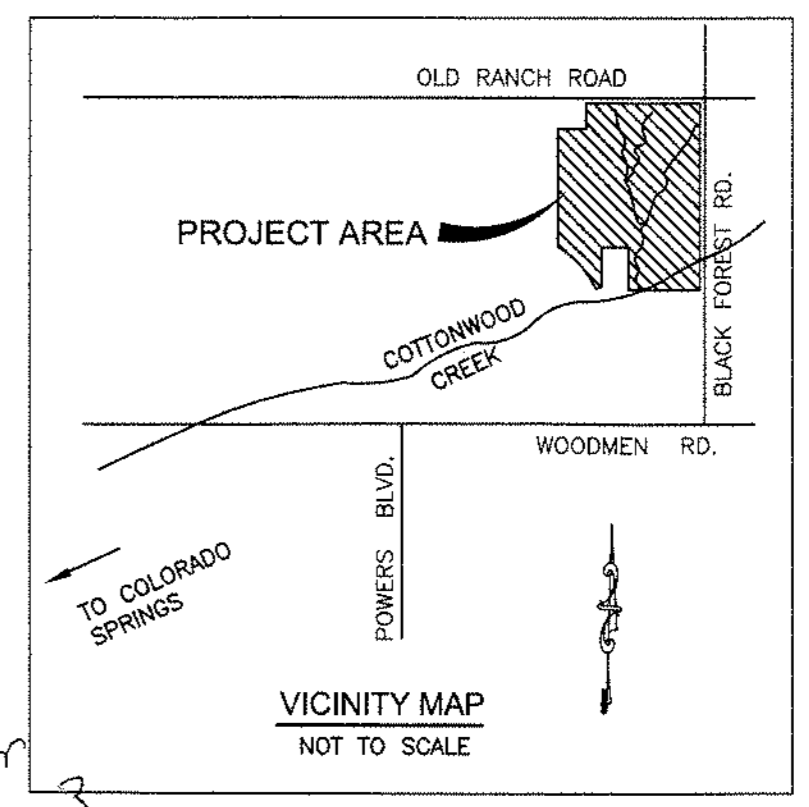

LEGEND	
	BASIN NUMBER
	BASIN AREA/VALUE (SM)
	DESIGN POINT
	DRAINAGE BASIN BOUNDARY
	CONVEYANCE ELEMENT/HYDRAULIC STRUCTURE
	TIME OF CONCENTRATION FLOW PATH

STORM SEWER SYSTEMS SHOWN FOR SUB-BASINS C-3 & C-2 OBTAINED FROM WESTCREEK FILINGS 1, 2, 3, 4 & 5 FINAL DRAINAGE REPORT.

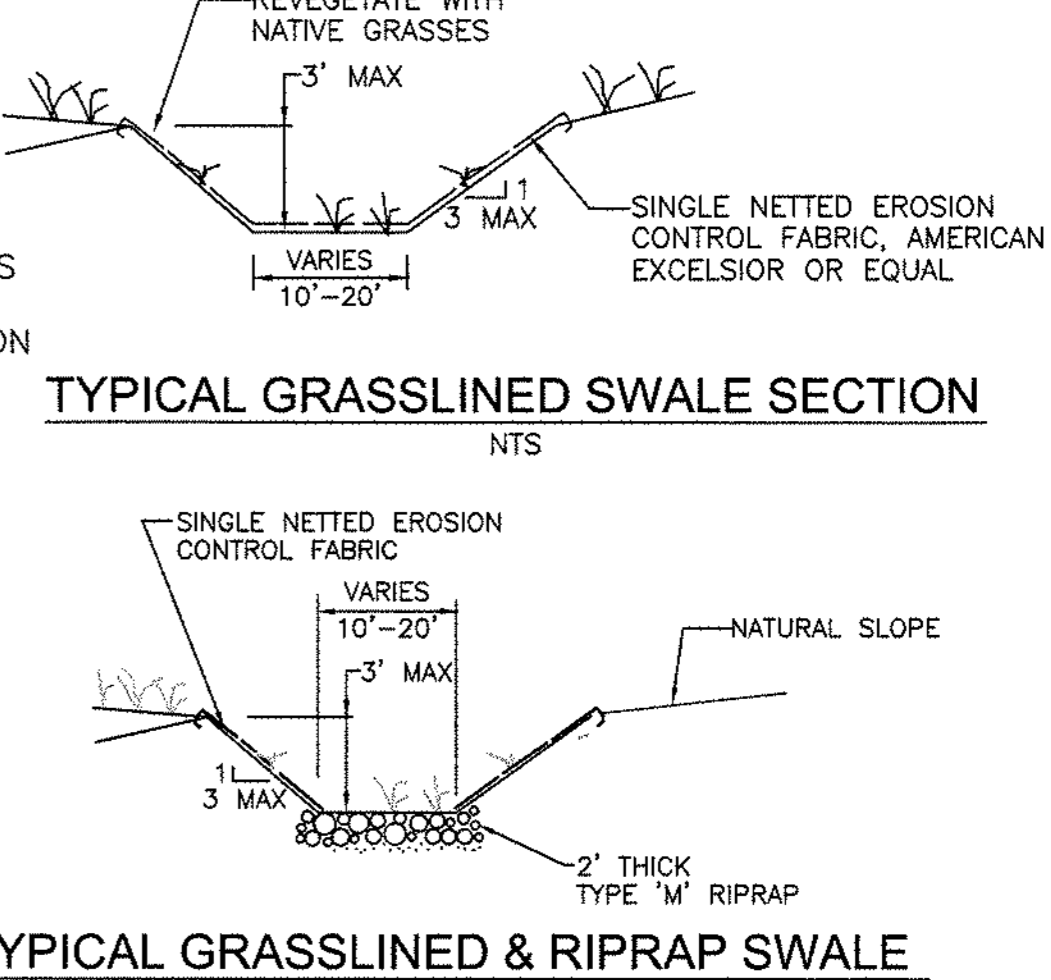

Kiowa Engineering Corporation
1604 South 21st Street
Colorado Springs, Colorado
80904 - 4208
(719) 630-7342

WOLF RANCH
MASTER DEVELOPMENT DRAINAGE PLAN
PROPOSED FACILITIES
COLORADO SPRINGS, COLORADO

Project No.:	03094
Date:	03/09/2004
Design:	RNW
Drawn:	JLN
Check:	RNW
Revisions:	

Fig. 6