

NOTE:
SCHEMATIC LOCATION & DEPICTION OF CHANNEL IMPROVEMENTS ARE
BASED ON RECOMMENDATIONS FROM THE SAND CREEK DRAINAGE BASIN
PLANNING STUDY.

THE BANK LINING, REGIONAL DETENTION POND, AND EXACT LOCATION OF
DROP STRUCTURES TO BE DETERMINED WITH SUBSEQUENT CHANNEL
IMPROVEMENT REPORT.

SUB BASIN DATA

Sub-Basin Data		Peak Runoff	
Basin	Area (ac)	Q(5)	Q(100)
SC	9.8	6.52	16.27
B	6.1	13.85	28.42
C	4.3	13.09	24.88
D	9.1	25.99	52.05
E	9.4	24.43	46.35
F	2.3	7.23	13.69
J	4.0	10.88	20.67
OS-3	0.0	6.78	12.09
OS-9	1.4	5.50	10.30
OS-10	1.2	8.23	14.66

SUMMARY RUNOFF TABLE

Design Point	Area (ac)	Q(5) (cfs)	Q(100) (cfs)	Description
1	8.75	21.57	38.65	Sub-basins OS-10 & B
1-A	2.61	8.23	14.66	Sub-basin OS-10
2	34.12	102.78	184.26	Shiloh Mesa MDDP DP 21
3	38.44	114.63	205.86	Sub-basin C & DP2
4	11.09	27.46	48.23	Sub-basin F & DP1
5	49.53	121.44	216.6	DF3 & DF4
6	27.03	92.17	157.9	Shiloh Mesa MDDP DP 30
7	36.41	100.51	178.95	Sub-basin E & DF6
8	13.09	40.83	72.7	Sub-basins J & D
9	49.5	137.94	245.67	DF7 & DF8

PROPOSED SHILOH MESA AT WOODMEN HEIGHTS DEVELOPMENT
(CURRENTLY UNDEVELOPED)
SCHEDULE NO. 5300000480

LEGEND

	EXISTING ELECTRIC		DRAINAGE BASIN BOUNDARY
	EXISTING FIBER OPTIC		PROPOSED CONTOUR
	EXISTING GAS		EXISTING CONTOUR
	EXISTING CULVERT		PROPOSED STORM
	PROPOSED EASEMENT		EXISTING STORM
	PROPOSED D10R INLET		PROPOSED MANHOLE
	PROPOSED FLOW DIRECTION ARROW		DESIGN POINT

GRAPHIC SCALE

(IN FEET)
1 inch = 100 ft.

DESIGN POINT

OS-3
1.99 AC. 0.38

BASIN DESIGNATION

"C" COEFFICIENT (100 YR)

BASIN AREA (ACRES)

Matrix Design Group, Inc.
Integrated Design Solutions

2435 Research Parkway, Suite 300
Colorado Springs, CO 80920
Phone 719-575-0100
Fax 719-575-0208

THE WOODMEN HEIGHTS
COMMERCIAL CENTER
MASTER DEVELOPMENT DRAINAGE PLAN

**DRAINAGE PLAN
PROPOSED CONDITIONS**

DESIGNED BY: RAE	SCALE: HORIZ: 1" = 100'	DATE ISSUED: FEBRUARY, 2009	DR02
DRAWN BY: RAE	VERT: N/A	MDG PROJECT NO: 06.052.018	
CHECKED BY: REP			

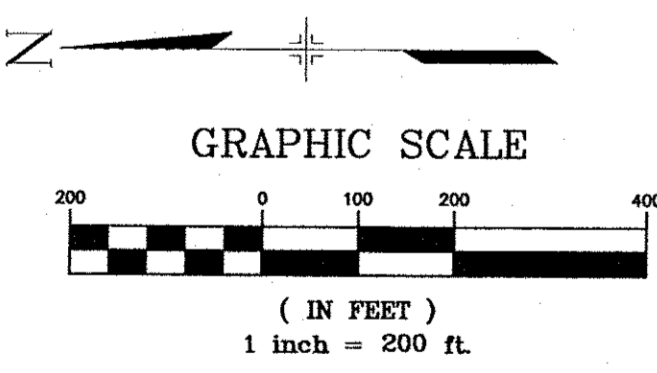
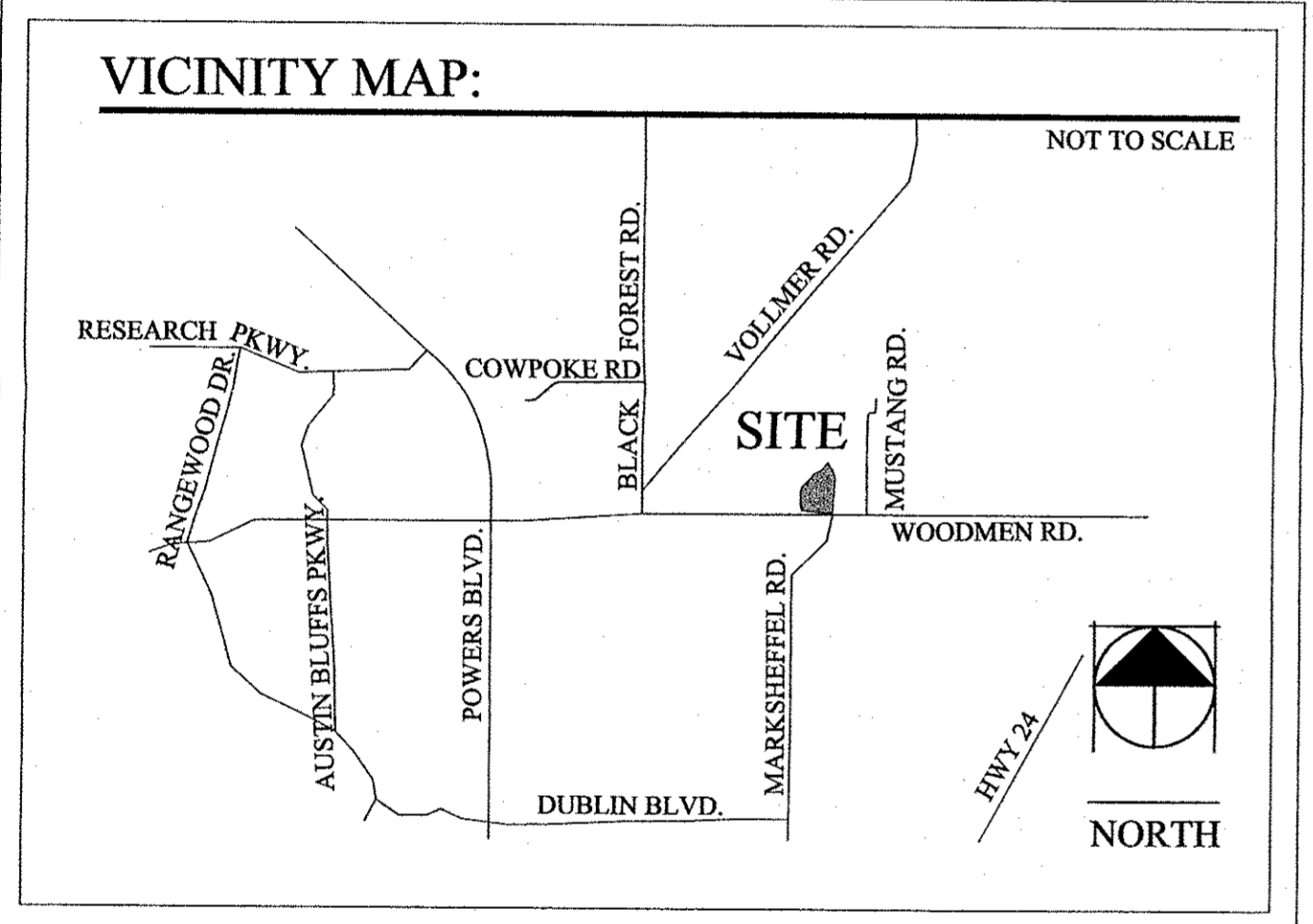
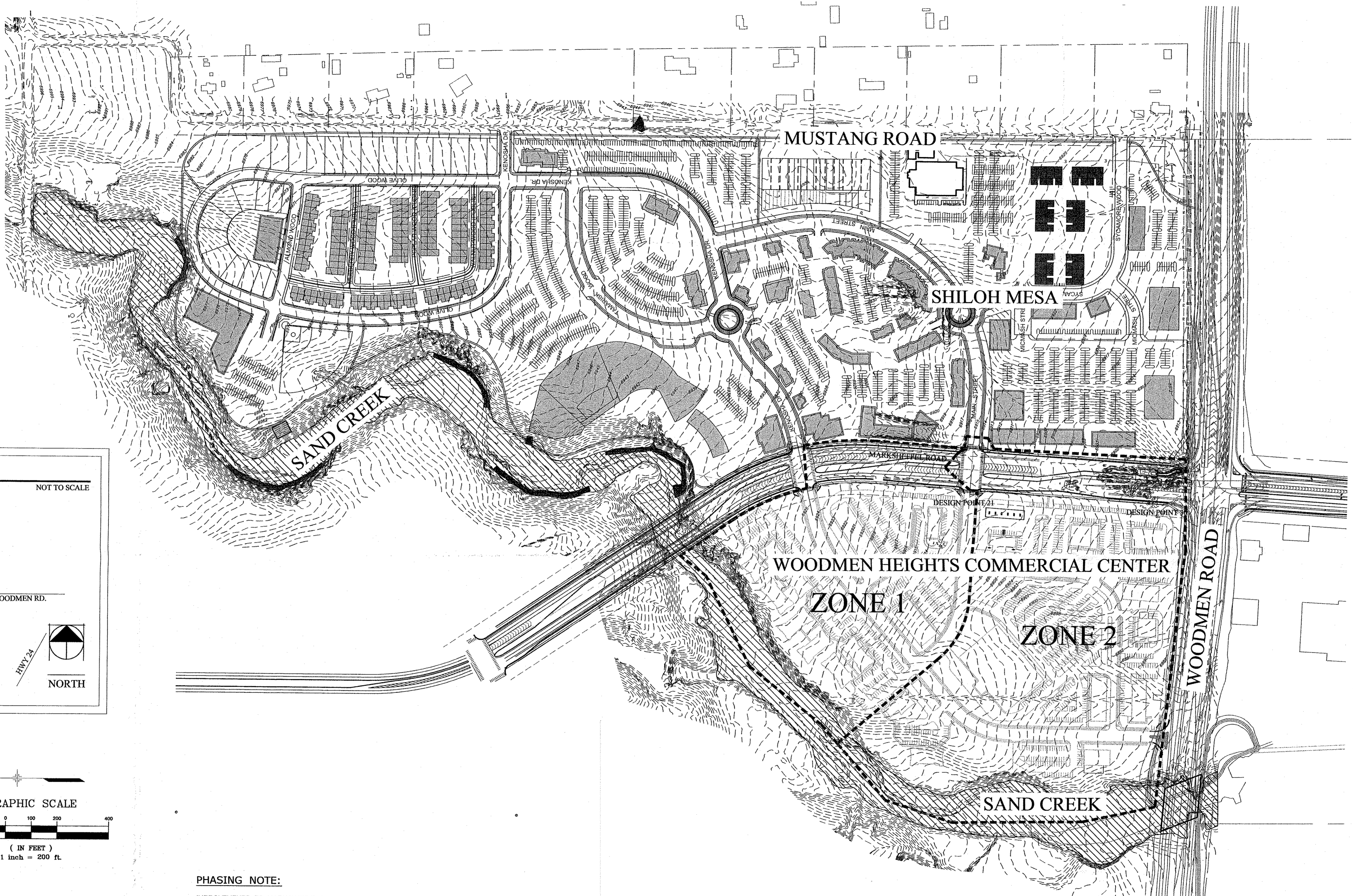

PHASING NOTE:

IMPROVEMENTS TO MARKSHEFFEL ROAD WILL BE COMPLETED AS FOLLOWS:

1. A PHASED 1/2 SECTION OF MARKSHEFFEL ROAD WILL BE CONSTRUCTED BETWEEN WOODMEN ROAD AND THE 1ST INTERSECTION NORTH OF WOODMEN ROAD AS PART OF PHASE 1 OF THE DEVELOPMENT.
2. PRIOR TO DEVELOPMENT WITHIN PHASE 3, MARKSHEFFEL ROAD WILL BE COMPLETED BETWEEN WOODMEN ROAD AND KENOSHA DRIVE AS A FOUR LANE DIVIDED ROADWAY PURSUANT TO THE APPROVED TYPICAL SECTION WITHIN THE SHILOH MESA CONCEPT PLAN.

WOODMEN ROAD IS CURRENTLY UNDER CONSTRUCTION AND, UPON COMPLETION, WILL CONSIST OF A FOUR LANE DIVIDED RURAL EXPRESSWAY. PRIOR TO THE COMPLETION OF DEVELOPMENT WITHIN PHASE 3, WOODMEN ROAD WILL BE WIDENED TO A SIX LANE RURAL EXPRESSWAY.

Matrix Design Group, Inc.
 Integrated Design Solutions
 2435 Research Parkway, Suite 300
 Colorado Springs, CO 80920
 Phone 719-575-0100
 Fax 719-575-0208

WOODMEN HEIGHTS COMMERCIAL CENTER			
MASTER DEVELOPMENT DRAINAGE PLAN			
PHASING PLAN PROPOSED CONDITIONS			
DESIGNED BY: BAS	SCALE	DATE ISSUED: FEBRUARY, 2009	
DRAWN BY: BAS	HORIZ: 1" = 100'	MDG PROJECT NO: 06.052.018	
CHECKED BY: EDL	VERT: N/A		
			DR03