

Master Development Drainage Plan Woodmen Meadows

A subdivision of a portion of the Northeast quarter of the Southeast quarter of Section 9, Township 13 South, Range 66 West of the 6th P.M., in the City of Colorado Springs, County of El Paso, State of Colorado.

LEGEND

| | |
|--|--|
| | MAJOR DRAINAGE BASIN BOUNDARY |
| | MINOR DRAINAGE BASIN BOUNDARY |
| | DRAINAGE BASIN DESIGNATION |
| | RUNOFF 10-YEAR 100-YEAR |
| | PROPOSED STORM SEWER SIZE & TYPE DESIGN RUNOFF-cfs/min. slope-% |
| | PROPOSED CATCH BASIN (D-10-R) SIZE INT. RUNOFF-cfs 10-YR STORM |
| | EXIST. STORM SEWER |
| | DIRECTION OF FLOW ARROWS |
| | PROPOSED BUILDINGS |
| | EXISTING CURB INLET |
| | PROPOSED ENERGY DISSIPATOR |
| | FEMA BASE FLOOD ELEVATION |

NOTES:

- 1) ALL PARKING AND DRIVES AS SHOWN ARE TO BE PAVED.
- 2) ALL FLOOR ELEVATIONS TO BE MINIMUM OF 1' ABOVE BASE REGULATORY FLOOD ELEVATION.
- 3) SOILS GROUPS C & D.
- 4) LAND USE - COMMERCIAL.
- 5) CURRENT CHANNEL TREATMENT CONCEPT IS RIP-RAP BANK LINING W/ CHANNEL CHECKS OR DROP STRUCTURES (4±)

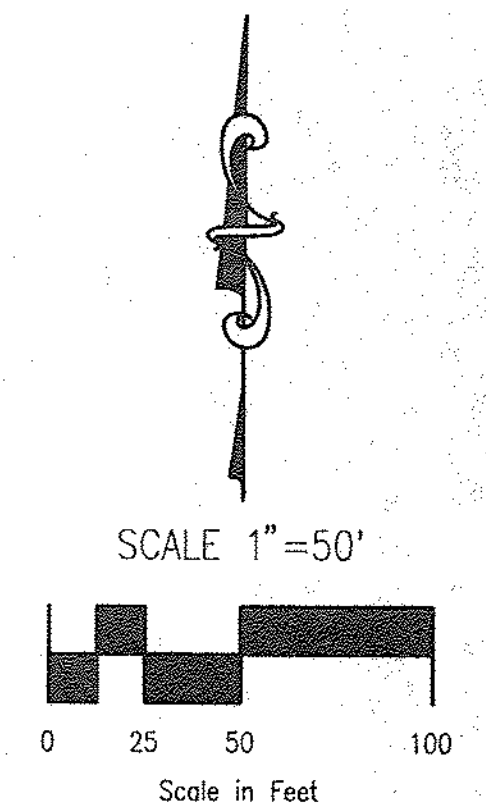
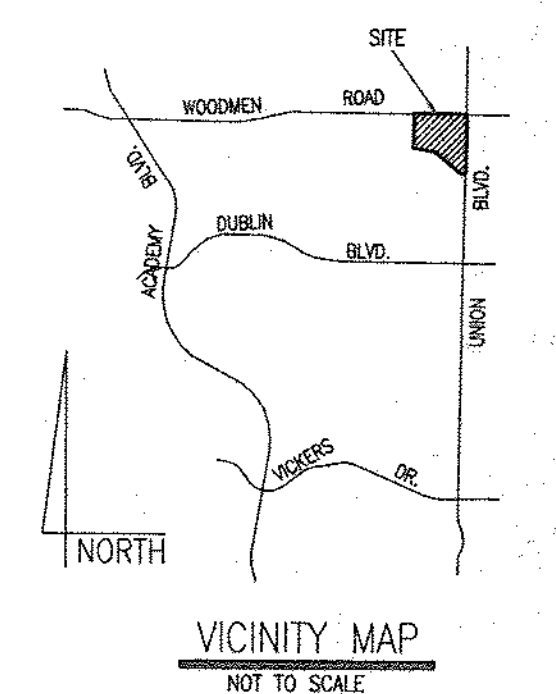

2 FOOT CONTOUR INTERVALS

PREPARED FOR: AFFILIATED FIRST NATIONAL BANK
COLORADO SPRINGS, COLORADO

KLH ENGINEERING, INC.
ENGINEERS / SURVEYORS / PLANNERS COLORADO SPRINGS, COLORADO

TITLE: **WOODMEN MEADOWS
MASTER DEVELOPMENT DRAINAGE PLAN**

SCALE: 1"=50' DRAWN BY: DBH 9053102
DATE: MAY 16, 91 CHECKED BY: JDR

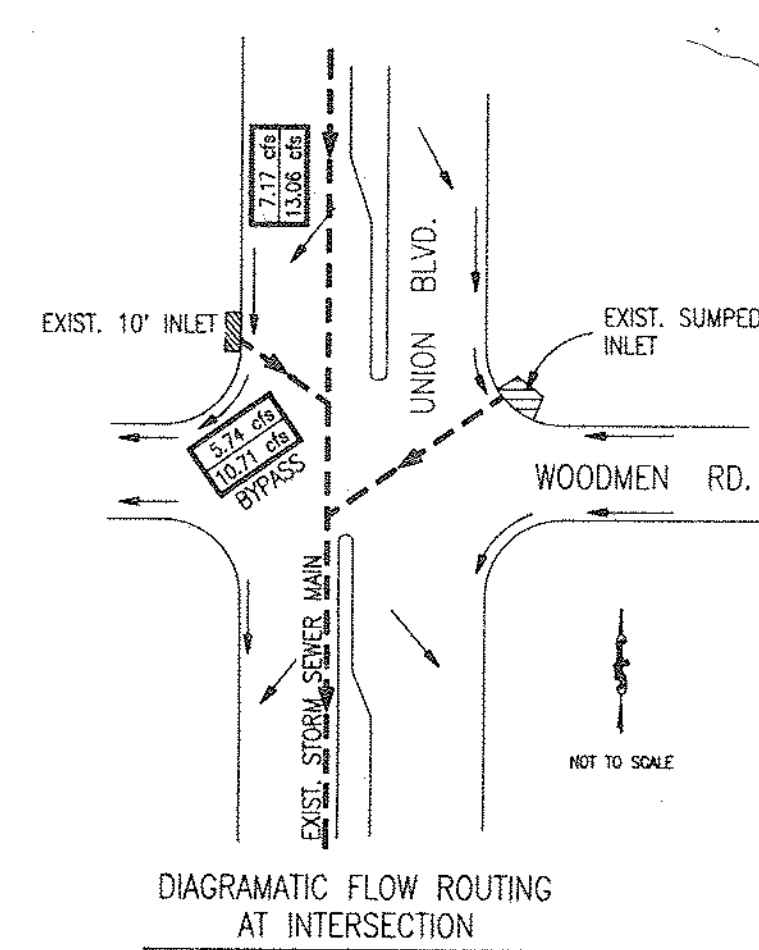
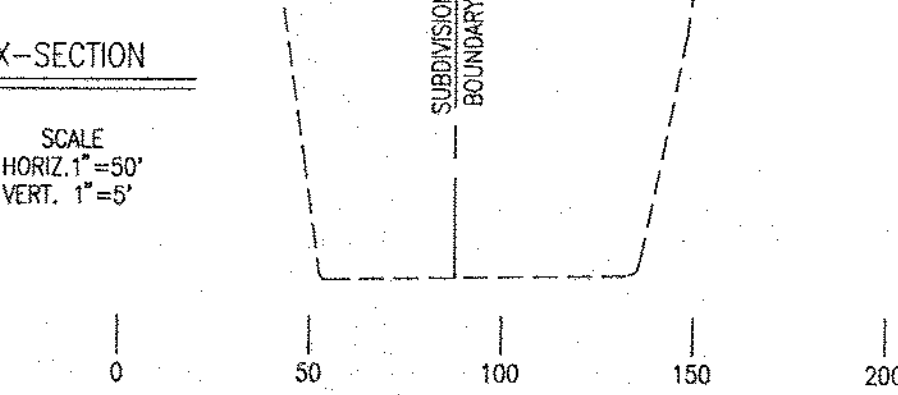
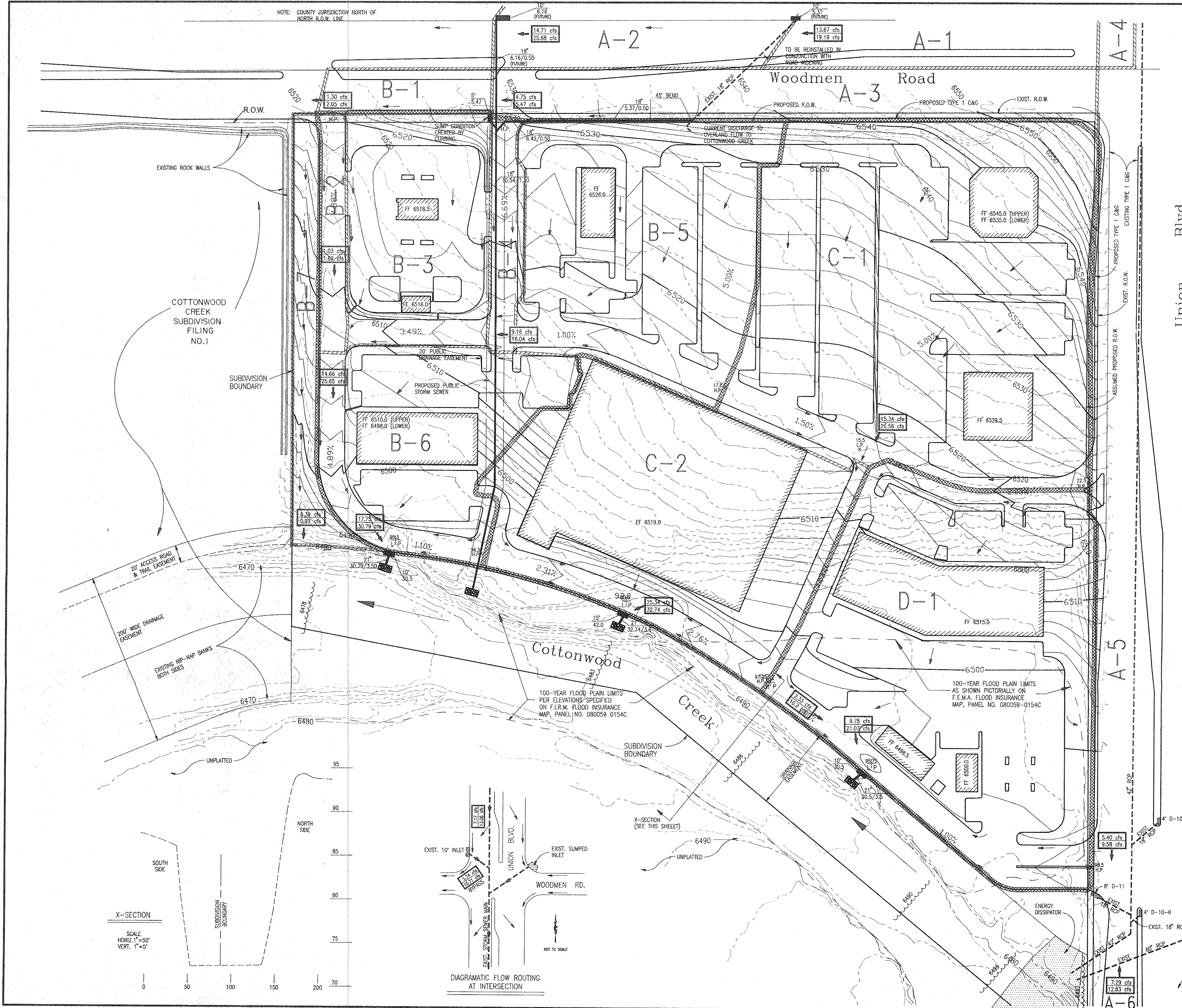

100-YEAR FLOOD PLAIN LIMITS
AS SHOWN PICTORIALLY ON
F.E.M.A. FLOOD INSURANCE
MAP, PANEL NO. 080059-0154C

100-YEAR FLOOD PLAIN LIMITS
AS SHOWN PICTORIALLY ON
F.E.M.A. FLOOD INSURANCE
MAP, PANEL NO. 080059-0154C

NOTE: COUNTY JURISDICTION NORTH OF
NORTH R.O.W. LINE